

Hardware Set Up Instruction Manual

Smart RGB 90 LEDs music activated strip light 10ft with remote

PRODUCT INFORMATION:

Product Name: Smart LED strip light

Description: Smart RGB 90 LEDs music activated strip light 10ft with remote

Driver Input: 100-240V 50/60Hz, 0.2A

Driver Output: 5V 2A

Power (LED Driver): 10W

INSTALLATION INSTRUCTION

Connect the strip light as shown in the image below. Use remote control and APP to adjust strip light functions.

PACKAGE CONTENTS

Part	Description	Quantity
1	Adaptor	1
2	10ft LED strip	1
3	Smart DC controller	1
4	USB cable	1
5	Remote with 1X CR2025 battery	1
6	Mounting clip	4
7	Mounting screw	8

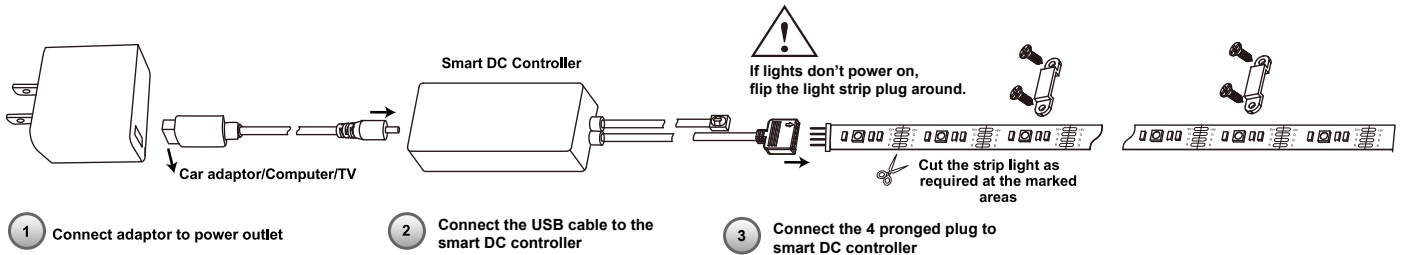

1 Connect adaptor to power outlet

2 Connect the USB cable to the smart DC controller

3 Connect the 4 pronged plug to smart DC controller

IMPORTANT: PLEASE READ THESE INSTRUCTIONS CAREFULLY PRIOR TO USE. PLEASE NOTE THAT THE LED STRIP CAN BE PLACED OUTDOORS BUT POWER PACK MUST BE PLUGGED INDOORS.

NON-REPLACEABLE LED: THE LIGHT SOURCE OF THIS LUMINAIRE IS NOT REPLACEABLE; WHEN THE LIGHT SOURCE REACHES ITS END OF LIFE THE WHOLE LUMINAIRE SHALL BE REPLACED

WARNING: Changes or modifications to this unit not expressly approved by the party responsible for compliance could forth the users authority to operate the equipment.

NOTE: This equipment has been a tested and found to comply with the limits for a Class B digital device, pursuant to Part 15 of the FCC rules. These limits are designed to provide reasonable protection against harmful interference in a residential installation. This equipment generates uses and can radiate radio frequency energy and if not installed and used in accordance with the instructions because harmful interference to radio communications.

However, there is no guarantee that interference will not occur in a particular situation. If this equipment does cause harmful interference to radio or television reception, which can be determined by turning the equipment off and on, the user is encouraged to try to correct the interference by one or more of the following measures:

- Re-orient or relocate the receiving antenna.
- Increase the separation between the equipment and receiver.
- Connect the equipment into an outlet on a circuit different from that to which the receiver is connected.

Consult the dealer or an experienced radio/TV technician for help."

Made in China
Printed in China

This is not a toy, for decorative use only

Charm Christmas Trees US LLC, 1155 Phoenixville pike suite 105 West Chester PA 19380, 1-833-386-0080

REMOTE CONTROL FUNCTIONS

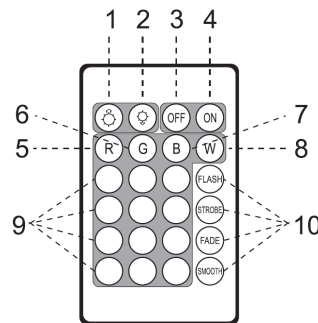

1. To increase LED brightness
2. To decrease LED Brightness
3. To turn strip lights OFF
4. To turn strip lights ON
5. For selecting red Color
6. For selecting green color
7. For selecting blue color
8. For selecting white color
9. For selecting pre-set colors
10. For FLASH/STROBE/FADE/SMOOTH

BATTERY USE AND DISPOSAL

1. For best results use a CR2025 Lithium Battery.
2. Install only new batteries in your product.
3. Failure to insert batteries in the correct polarity, as indicated in the battery compartment., may shorten the life of the batteries or cause the battery to leak.
4. Do not dispose of batteries in fire.
5. The CR2025 button battery and the battery tube are considered hazardous waste and should be disposed of properly at your local hazardous waste collection site for proper handling. Be sure the item holds no charge when disposing. Depending on your waste service provider you may be able to recycle your battery. Please check with your waste service provider, as well as your local and state guidelines.

To satisfy FCC RF exposure requirements, a separation distance of 20cm or more should be maintained between the antenna of this device and persons during device operation.

To ensure compliance, operations at closer than this distance is not recommended