

ENGINEER	DATE	CHANGE NUMBER	MODIFICATION	REVISION
RH	2016-05-05	CN5013439	FCC COMPLIANCE LABEL ADDED.	RO6

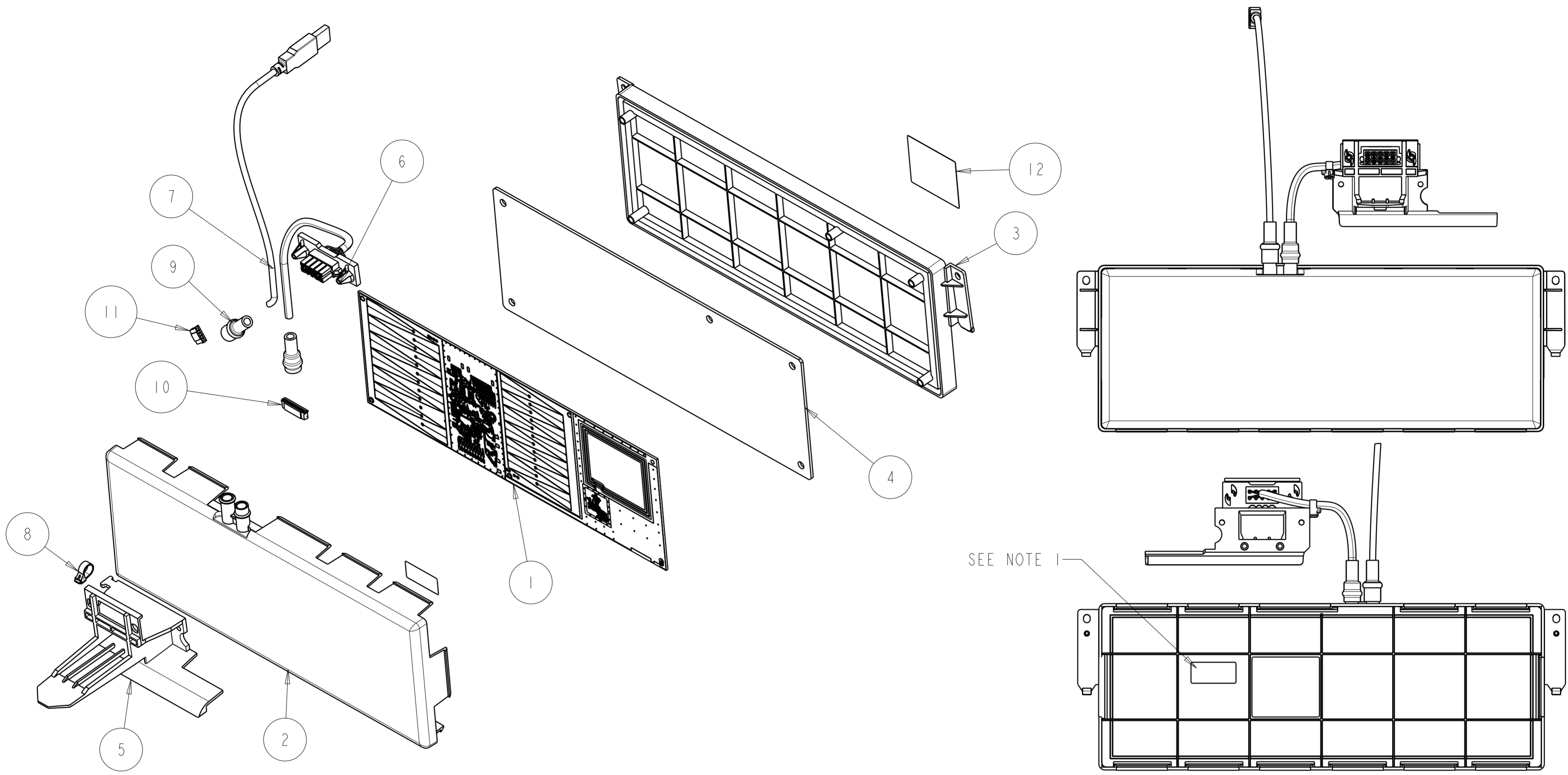

NOTES;
 1. REFER TO DOC-0010168 FOR LABEL CONTENT REQUIREMENT.

12	1	EPT024743	QMM-LSM APPROVALS LABEL FCC/IC
11	1	EPPO03610	PLUG 5 WAY JST PHR-5
10	1	EPT013187	PLUG 10 WAY JST PHR-10
9	2	EPT023098	LSM HEAT SHRINK SLEEVE
8	1	EPT006233	CABLE TIE (BLACK) 200 X 4.8MM
7	1	EPT014375	HARNESS ASSY - LSM MAIN PCB TO USB A
6	1	EPT014373	LSM MAIN PCB TO SUPPLEMENTARY MODULE CABLE
5	1	EPT012459	MODULE LATCH
4	1	EPT016334	LSM SEAL
3	1	EPT016333	LSM REAR COVER
2	1	EPT016332	LSM FRONT CASE
1	1	EPT013815	LSM MAIN PCB ASSEMBLY
ITEM	QTY	PART No.	DESCRIPTION

		ISO 128 	UNLESS OTHERWISE STATED DIMENSIONS IN mm GENERAL TOLERANCES TO ISO 2768 - MEDIUM GENERAL SURFACE FINISH: 1.6µm Rg TO ISO 1302 THIS PART/ASSEMBLY AND ITS COMPONENTS MUST COMPLY WITH CURRENT RoHS & REACH DIRECTIVES		CLEANLINESS DOMINO TS0049:CI	FINISH SEE NOTES
THIS DRAWING IS CONFIDENTIAL AND MUST NOT BE COPIED OR DISCLOSED WITHOUT THE WRITTEN CONSENT OF DOMINO UK LTD. CAMBRIDGE, ENGLAND		THE MASTER OF THIS DRAWING IS HELD IN THE PLM SYSTEM ALWAYS REFER TO PLM FOR THE CORRECT REVISION PAPER OR ELECTRONIC COPIES OF THIS DRAWING ARE UNCONTROLLED IF THIS DRAWING IS NOT WATERMARKED ITS CONTENTS SHALL NOT BE TRUSTED		MATERIAL SEE BOM		
DATE	DRAWN	APPROVAL IN PLM DATABASE	DESCRIPTION LSM ASSEMBLY			
05 May 2016	RH 33		SCALE	SHEET	MASS (g)	
			0.500	1 OF 1		
			EPT013423		A2	DO NOT SCALE