

CC30

User Manual



Federal Communication Commission Interference Statement



This device complies with Part 15 of the FCC Rules. Operation is subject to the following two conditions: (1) This device may not cause harmful interference, and (2) this device must accept any interference received, including interference that may cause undesired operation.

This equipment has been tested and found to comply with the limits for a Class B digital device, pursuant to Part 15 of the FCC Rules. These limits are designed to provide reasonable protection against harmful interference in a residential installation. This equipment generates uses and can radiate radio frequency energy and, if not installed and used in accordance with the instructions, may cause harmful interference to radio communications. However, there is no guarantee that interference will not occur in a particular installation. If this equipment does cause harmful interference to radio or television reception, which can be determined by turning the equipment off and on, the user is encouraged to try to correct the interference by one of the following measures:

- Reorient or relocate the receiving antenna.
- Increase the separation between the equipment and receiver.
- Connect the equipment into an outlet on a circuit different from that to which the receiver is connected.
- Consult the dealer or an experienced radio/TV technician for help.

FCC Caution: Any changes or modifications not expressly approved by the party responsible for compliance could void the user's authority to operate this equipment.

This transmitter must not be co-located or operating in conjunction with any other antenna or transmitter.

Radiation Exposure Statement:

This equipment complies with FCC radiation exposure limits set forth for an uncontrolled environment. This equipment should be installed and operated with minimum distance 20cm between the radiator & your body.

Europe – EU Declaration of Conformity



This device complies with the essential requirements of the R&TTE Directive 1999/5/EC. The following test methods have been applied in order to prove presumption of conformity with the essential requirements of the R&TTE Directive 1999/5/EC.

Industry Canada statement

This device complies with RSS-210 of the Industry Canada Rules. Operation is subject to the following two conditions: (1) This device may not cause harmful interference, and (2) this device must accept any interference received, including interference that may cause undesired operation.

Ce dispositif est conforme à la norme CNR-210 d'Industrie Canada applicable aux appareils radio exempts de licence. Son fonctionnement est sujet aux deux conditions suivantes: (1) le dispositif ne doit pas produire de brouillage préjudiciable, et (2) ce dispositif doit accepter tout brouillage reçu, y compris un brouillage susceptible de provoquer un fonctionnement indésirable.

Radiation Exposure Statement:

This equipment complies with IC radiation exposure limits set forth for an uncontrolled environment. This equipment should be installed and operated with minimum distance 20cm between the radiator & your body.

Déclaration d'exposition aux radiations: Cet équipement est conforme aux limites d'exposition aux rayonnements IC établies pour un environnement non contrôlé. Cet équipement doit être installé et utilisé avec un minimum de 20 cm de distance entre la source de rayonnement et votre corps.

低功率電波輻射性電機管理辦法

第十二條

經型式認證合格之低功率射頻電機，非經許可，公司、商號或使用者均不得擅自變更頻率、加大功率或變更原設計之特性及功能。

第十四條

低功率射頻電機之使用不得影響飛航安全及干擾合法通信；經發現有干擾現象時，應立即停用，並改善至無干擾時方得繼續使用。前項合法通信，指依電信法規定作業之無線電通信。

低功率射頻電機須忍受合法通信或工業、科學及醫療用電波輻射性電機設備之干擾。

この装置は、クラスB情報技術装置です。この装置は、家庭環境で使用することを 目的としていますが、この装置がラジオやテレビジョン受信機に近接して使用されると、受信障害を引き起こすことがあります。取扱説明書に従って正しい取り扱いをして下さい。VCCI-B

DISCLAIMER

No warranty or representation, either expressed or implied, is made with respect to the contents of this documentation, its quality, performance, merchantability, or fitness for a particular purpose. Information presented in this documentation has been carefully checked for reliability; however, no responsibility is assumed for inaccuracies. The information contained in this documentation is subject to change without notice.

In no event will AVer Information Inc. be liable for direct, indirect, special, incidental, or consequential damages arising out of the use or inability to use this product or documentation, even if advised of the possibility of such damages.

TRADEMARKS

“AVer” is a trademark owned by AVer Information Inc. Other trademarks used herein for description purpose only belong to each of their companies.

COPYRIGHT

©2016 AVer Information Inc. All rights reserved.

All rights of this object belong to AVer Information Inc. Reproduced or transmitted in any form or by any means without the prior written permission of AVer Information Inc. is prohibited. All information or specifications are subject to change without prior notice.

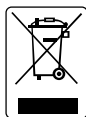

The mark of Crossed-out wheeled bin indicates that this product must not be disposed of with your other household waste. Instead, you need to dispose of the waste electrical and electronic equipment. For more information about where to drop off your waste equipment for recycling, please contact your household waste disposal service or the shop where you purchased the product.

CONTENTS

INTRODUCTION	1
Features	2
Camera	2
Wireless Microphone	2
CaptureShare	2
Package Contents	3
INSTALLATION	4
Getting Familiar with the CC30 HD Camera	4
Camera	4
Rear Panel	5
Microphone	6
Connections	7
Basic Installation Steps	8
Wireless microphone	10
Connection as a Conference Camera	10
Connect Camera to a computer or a laptop	10
Connect Speaker to Camera	11
Connection as a Lecture Capture Camera	12
Use the Kensington Lock	12
Connect HDMI to Lecture Recording System	12
Use AVer CC30 CaptureShare Software	12
DEPLOYMENT	13
Using the Camera	13
Wireless Microphone Connection	14
Web Video Conferencing	16
Lecture Capture	17

LMS/CMS	18
USE AVER CC30 CAPTURESHARE SOFTWARE	19
Before You Begin.....	19
Windows	19
Tool Bar	19
Overlaytool	24
Recording Interface	26
Basic image setting.....	31
Advanced image setting	32
Video output mode.....	33
Audio setting.....	34
Android	35
The Same Network	35
Connect to CaptureShare Software	35
SOFTWARE APPLICATIONS	41
Before You Begin.....	41
Making a Video Call.....	41
Skype	42
Google Hangouts.....	44
TROUBLESHOOTING	47
SPECIFICATIONS.....	50

INTRODUCTION

Thank you for choosing CC30 HD Camera. CC30 is a HD Camera set providing real-time video transmission with high resolution. Combined with 120-degree wide-angle lens design table to capture wider view and wireless movable wireless microphone allowing you can expand the scene size viewed and ensure the audio quality in a large-scale conference or classroom.

- CC30 HD Camera is designed easy to mount with multiple ways for more convenient and the build-in Kensington lock makes protects the camera from being stolen or moved, which is suitable to crowded place like a conference room or a classroom.
- Wireless Microphone is an echo canceling microphone. It provides longer distance voice-pickup design, mobility and free cabling arrangement for a crowded environment to capture more voice clearly.
- CaptureShare is a powerful application which can be used with your computer, laptop or even an android mobile phone to control CC30 HD Camera. CaptureShare provides various user-friendly functions from recording, screen shot or draw and highlighter on the screen. Combine CC30 HD Camera and CaptureShare to improve the quality of education or effectiveness of a conference.
- CC30 HD Camera is compatible with multiple video applications like Skype™ and Google Hangouts. You can use the device to make a high-quality video call for chatting or videoconference.

Features

Camera

- Simply Plug and Play
- Powerful 120° field of view with 8M pixel resolution
- Advanced Full HD 1080p image streaming via HDMI
- USB 2.0 UVC 1.1 supported
- Built-in microphone
- Compatible with Video application (Skype™, Skype for Business, Google Hangouts™, Zoom™, WebEx™, Adobe Connect™, WebRTC, YouTube™ and etc.)
- Mechanical privacy shutter
- Easy/multiple mounting design
- AEC, AGC, Noise-Reduction

Wireless Microphone

- Plug and Play wireless module
- 2.4GHz digital audio transmission
- Pairing free
- 10m transceiver distance
- Omnidirectional microphone
- Up to 8 hours talk time (Typical Zinc-carbon battery @ 25°C)

CaptureShare

- Desktop screen + dual USB video PIP recording
- Desktop screen annotation
- Live streaming upload to YouTube/Ustream/LiveHouse.in
- PC software Windows / MAC OSX supported
- Mobile APPs Android / iOS supported for recording/ePTZ control

Package Contents

The following items are included in the package. Please check if each item is available and confirm if there are damage before using.

[Note]

1. Do not disassemble or modify the items by yourself. Contact the dealer for help when the items is failed to work.
2. Store the items in a dry place away from moisture.

Camera Unit



Microphone

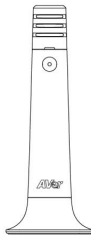

Receiver

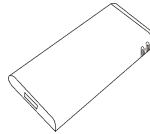

Mini Tripod

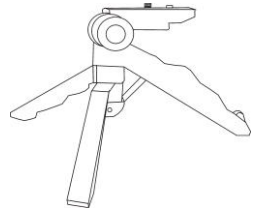

Power Adaptor



USB Cable



Battery



Manual

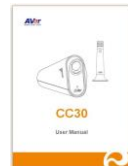

[Note] The power cord will vary depending on the standard power outlet of the country where it is sold.

INSTALLATION

Getting Familiar with the CC30 HD Camera

The main CC30 HD Camera set is including a camera and a microphone. Following shows the appearance of each item and how to connect the set.

Camera

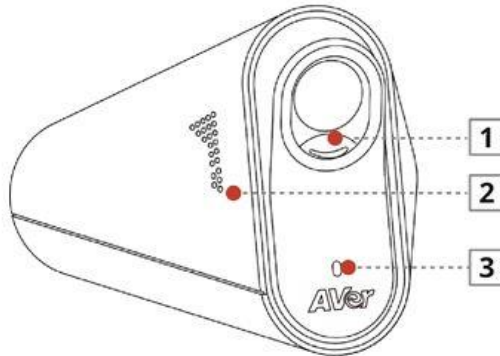

Name	Descriptions
1 Privacy Shutter	Protect the lens.
2 Built-in Microphone	Pick up the voice around of microphone
3 Camera Indicator	Show you the status of the camera. <ul style="list-style-type: none">● Wireless microphone connected (Solid green)● Wireless microphone disconnected (Blinking green)● Starting up (Blinking red)● Power off

Rear Panel

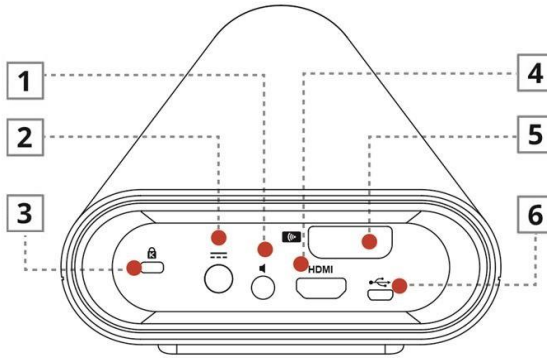

Name	Descriptions
1 Line Out	Connect the audio cable to a speaker. And connect the other end of the audio cable to the line out.
2 Power Jack	Connect the adapter to the power jack. And connect the other end of the power cord to a suitable power outlet.
3 Kensington Lock	Used to lock the camera to a stable object (desk or table legs) for protecting the camera from being stolen or moved.
4 HDMI Output	Connect an HDMI cable to HDMI output. And connect the other end of the HDMI cable to a lecture recording system.
5 Wireless Dongle	Used to connect the camera and the wireless microphone.
6 Micro USB	Connect the USB cable to the micro USB. And connect the other end of the USB cable to your laptop or computer.

Microphone

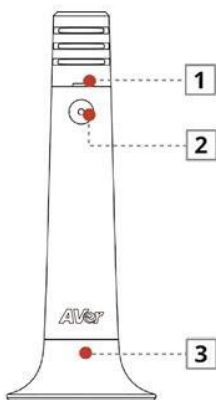

Name	Descriptions
1 MIC Battery Indicator	Show you the status of the MIC battery. <ul style="list-style-type: none">☀ Battery Low (Blinking red)● Battery Normal
2 MIC Power Switch (Indicator)	Press this button to turn on/off the wireless microphone. The indicator shows you the status of the MIC power. <ul style="list-style-type: none">● Wireless microphone connected (Solid green)☀ Out of range (Blinking green)● Power Off
3 MIC Battery Cover (MIC Stand)	Used as a wireless microphone stand to place the wireless microphone on a flat firmly. Simultaneously used as a battery cover.

Connections

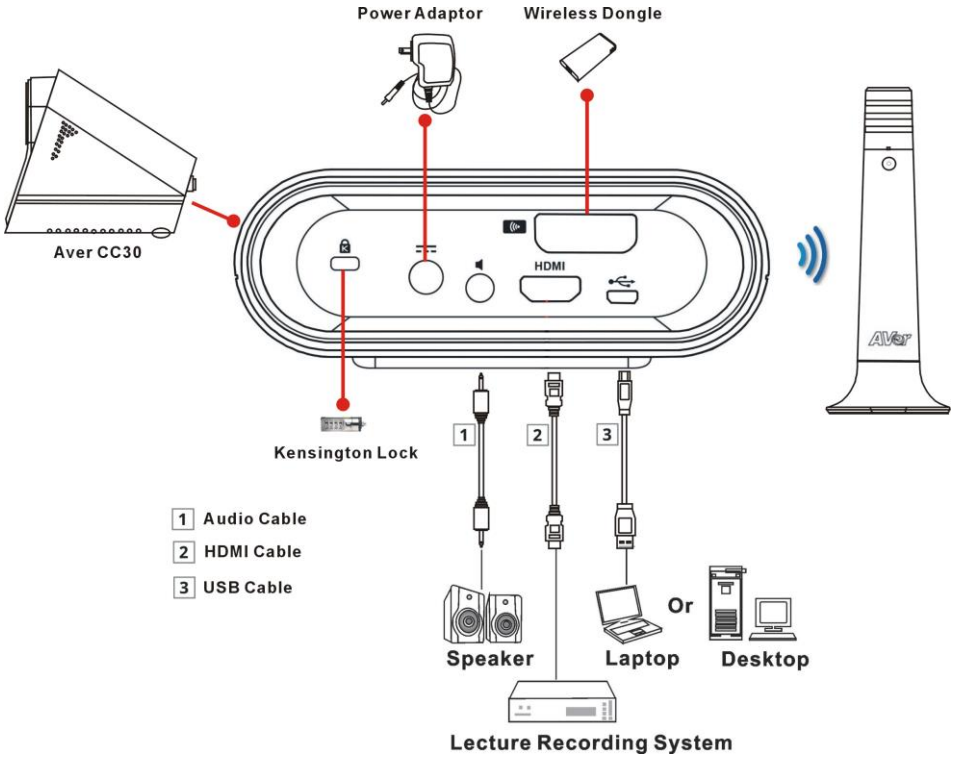

Basic Installation Steps

Following are basic installation steps of each item. Please install each item carefully for better use.

Camera

Place the wireless dongle into the wireless dongle slot on camera rear panel.

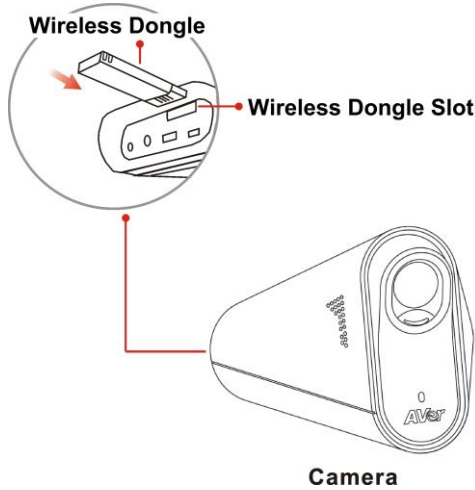

Connect the power adaptor to any power source and the power jack located on the camera rear panel. When the camera starts up, the camera indicator flashes Red. When the camera is connected to the wireless microphone, the camera indicator turns Solid green. When the camera is disconnected to the wireless microphone, the camera indicator blinks green.

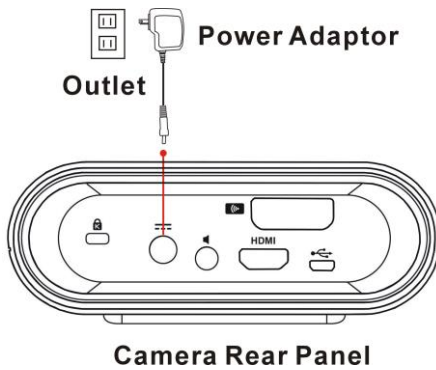

Pull down the privacy shutter of the camera carefully. Clean thoroughly the lens with lens tissue for better viewing effect before using.

[Note]

1. You may close the privacy shutter after using for protecting your privacy and protect the lens.
2. Do not clean the lens with cleaners containing strong acid or alkaline.
3. Do not press hard on the lens that will cause the camera malfunction.

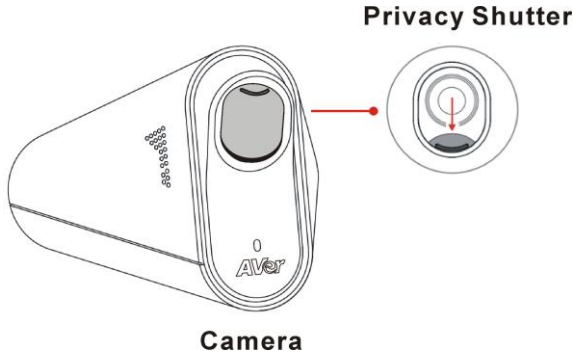

Mini tripod

Press both sides of the circular shaft and spread the head of your mini tripod to the end. Spread the left and right legs of the tripod away from the center support so that the three legs of tripod evenly rests on a flat surface, such as a table.

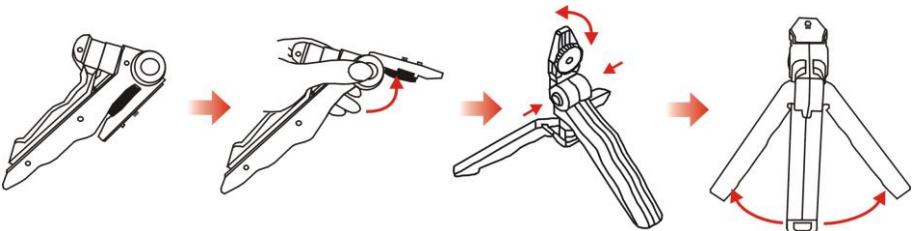

Attach the tripod socket of camera to the head of mini tripod. Lock the screw located in the center of the head, into the hole at the base of tripod socket.

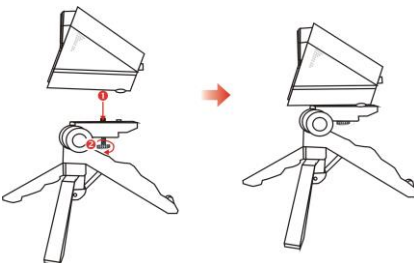

[Note] Do not rotate over close avoiding damage.

Wireless microphone

- Hold the upper part of the microphone and turn counterclockwise carefully to open the microphone.
- Place two AA batteries in to the battery holder. The battery cathode are toward outside.
- Hold the upper part back to the base and turn clockwise carefully to close the microphone.

[Note] When you close the microphone base, be sure aligning the latch slot avoiding causing damage.

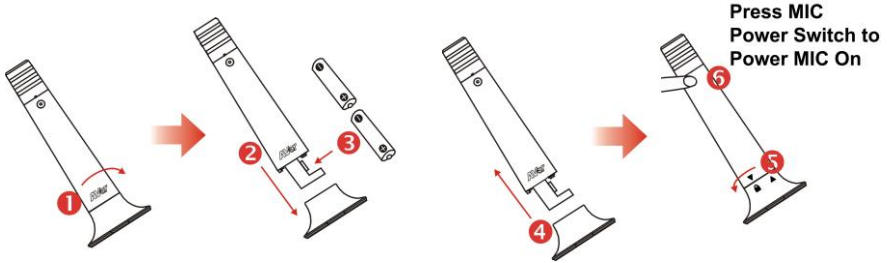

Press the microphone power switch to turn on the microphone. When the microphone connected to the camera successfully, the indicator turns to Solid green. If out of range or disconnected from wireless dongle, the indicator is blinking green.

Connection as a Conference Camera

Connect Camera to a computer or a laptop

Use a USB cable to connect the USB jack located on the camera rear panel and your computer or laptop.

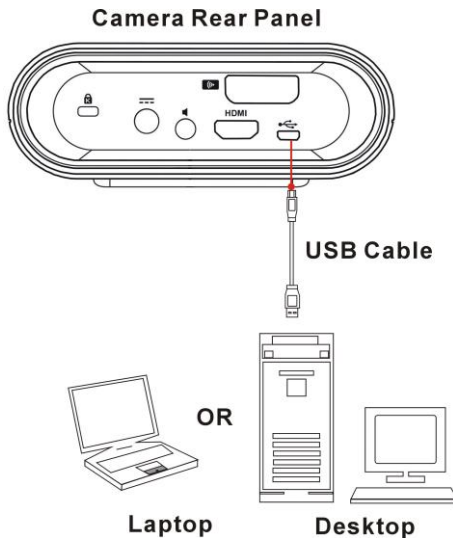

Connect Speaker to Camera

Use an audio cable to connect the line out port and a speaker.

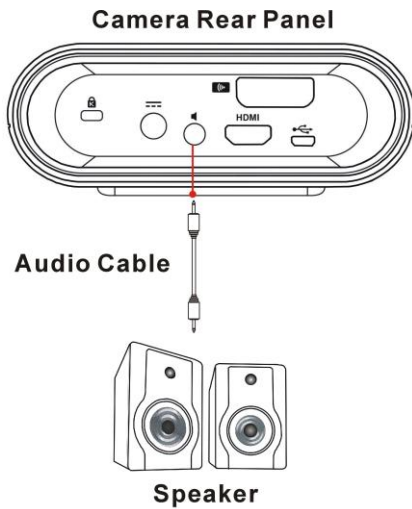

[Note] It is highly recommended that setting low volume level before turn on the speaker for protecting your hearing.

Connection as a Lecture Capture Camera

Use the Kensington Lock

Properly use the Kensington lock to connect the camera to a stable object (desk or table legs) for protecting the camera from being stolen or moved.

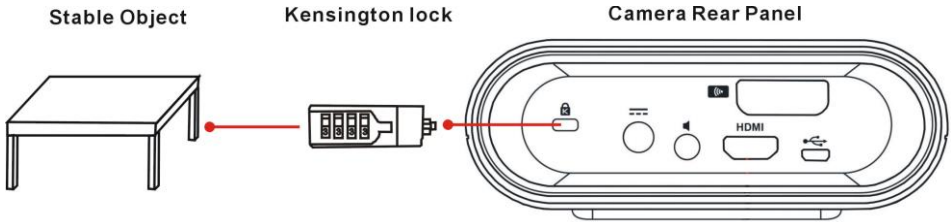

Connect HDMI to Lecture Recording System

Use a HDMI cable to connect the HDMI output jack and a lecture recording system.

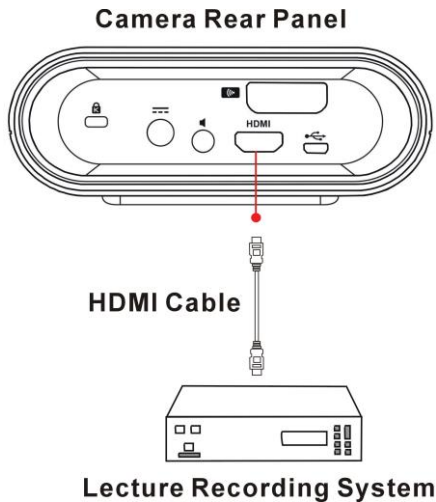

Use AVer CC30 CaptureShare Software

Please download the software from URL: <http://averusa.com/support/>. For more information, please refer to **USING THE CC30 CAPTURESHARE** chapter.

DEPLOYMENT

This chapter explains how to deploy the CC30 HD Camera in a best suitable angle and position for a good visual and audio effect.

Using the Camera

1. The camera provides 120° wide view angle. Set the camera able to capture all view expected.

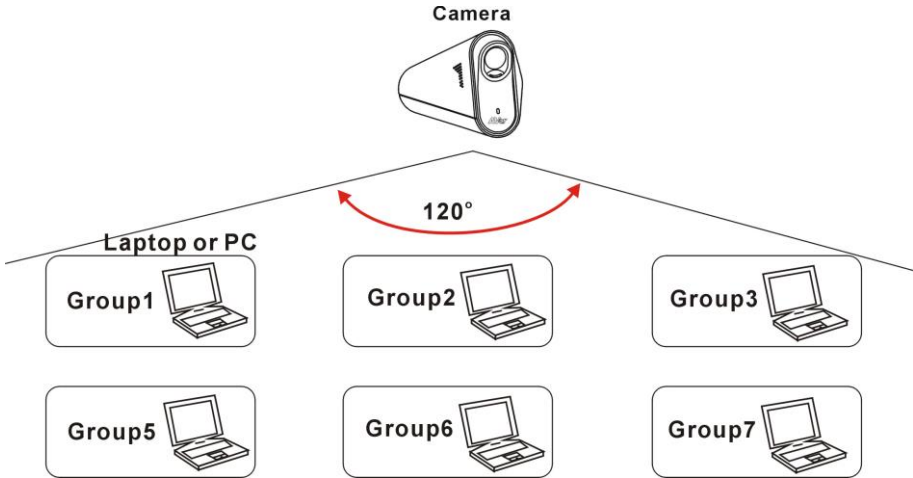

2. Do not place objects in front of the camera to avoid influencing the recording effect.
3. Clean and dry thoroughly the lens with lens tissue to avoid influencing the viewing effect.

[Note] Do not clean the lens with cleaners containing strong acid or alkaline.

4. Do not place the camera on the edge of a desk to avoid dropping and causing damage.

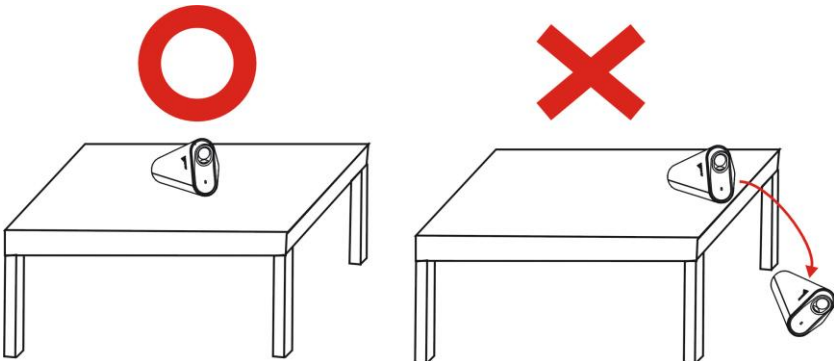

5. Properly use the mini tripod to adjust the height of the camera for better recording effect.

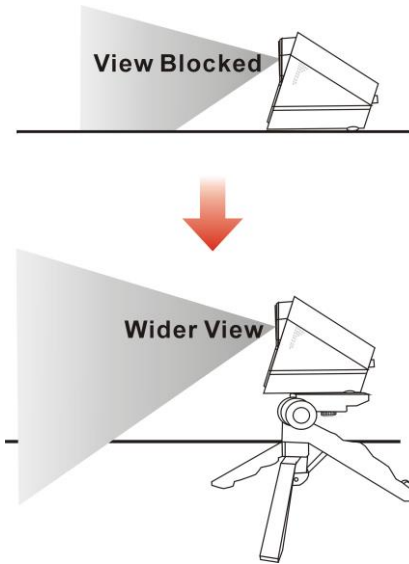

Wireless Microphone Connection

1. Build-in 10 meters distance transceiver provides mobility and free cabling arrangement.
2. Do not place the wireless microphone on the edge of a desk to avoid dropping and causing damage.

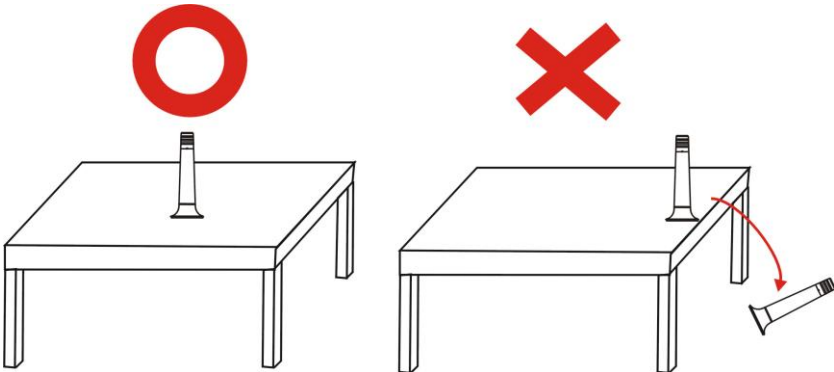

3. Too many people use the wireless microphone simultaneously might cause the voice picked up unclearly. It is recommended that use the wireless microphone in turns.

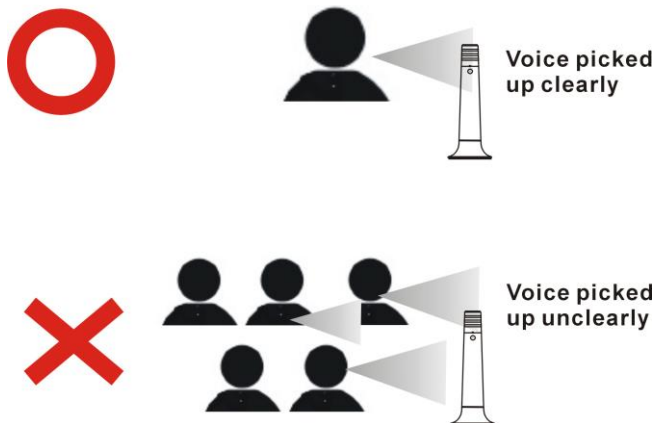

4. Please make sure that there is no too much obstacle between the camera and the wireless microphone to avoid reducing voice pick-up and the transceiver effect.

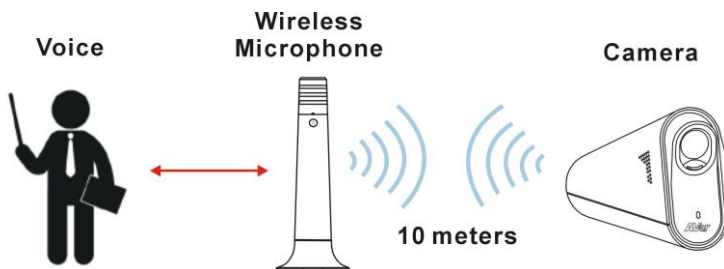

Web Video Conferencing

1. Open your Video application in your computer or laptop. (For more information, please refer to **SOFTWARE APPLICATIONS** chapter.)
2. Be sure the camera and the wireless microphone are set within the effective range.

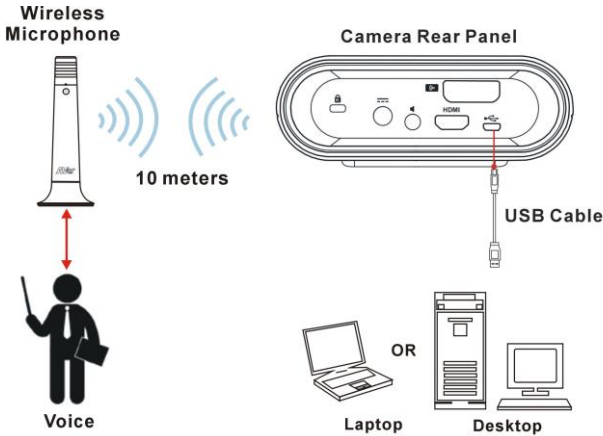

3. The camera provides 120° wide view angle. Set the camera able to capture all view expected.
4. Properly use the mini tripod to adjust the height of the camera for better recording view.
5. Turn on the wireless microphone for higher quality to make a video conference or a video call.
6. Please make sure that there is no too much obstacle between the camera and the wireless microphone to avoid reducing voice pick-up and the transceiver effect.

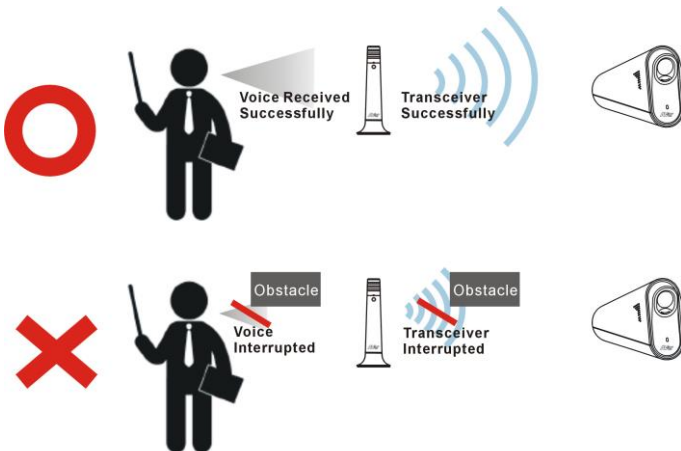

Lecture Capture

1. The camera provides 120° wide view angle. Set the camera able to capture all view expected.
2. Properly use the mini tripod to adjust the height of the camera for better recording view.
3. Turn on the wireless microphone for higher quality to make a video conference or a video call.
4. Be sure the camera and the wireless microphone are set with the effective range.

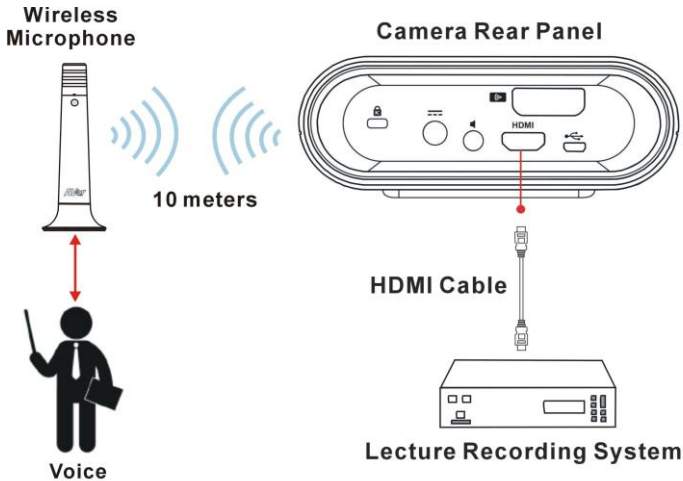

5. Please make sure that there is no too much obstacle between the camera and the wireless microphone or between the wireless microphone and the voice to avoid reducing voice pick-up and the transceiver effect.
6. You can use CC30 camera and AVer F70W camera simultaneously. Connect both cameras to your computer or laptop with the **CaptureShare** software for better effect when using lecture capture function.
7. For more information, please refer to **USE AVer CC30 CaptureShare SOFTWARE** chapter.

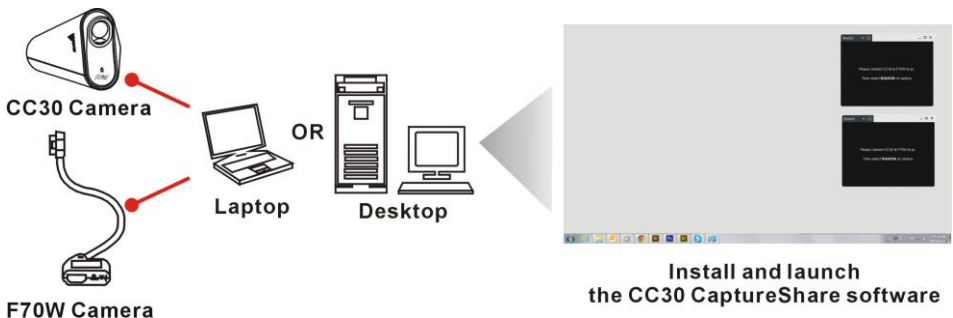

LMS/CMS

As technology advances, e-learning becomes more common and more effective. A **content management system (CMS)** and a **learning management system (LMS)** are the main two applications of e-Learning.

A **content management system (CMS)** is simply an application that allows only one user to manage content. Teachers can edit, add, and view content. Students can only view the content. This prevents the documents from be changed.

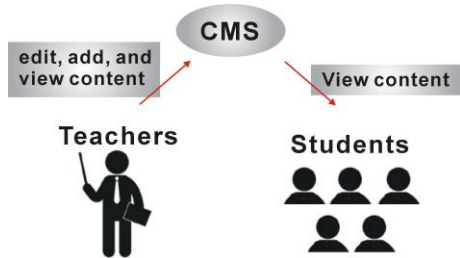

A **learning management system (LMS)** is another type of software application. Rather than version control, an **LMS** is more of a training control system. An **LMS** provides tracking function which students have completed them and what kind of score they received on the class. An **LMS** also allows teacher to prepare reports and exchange with other teachers.

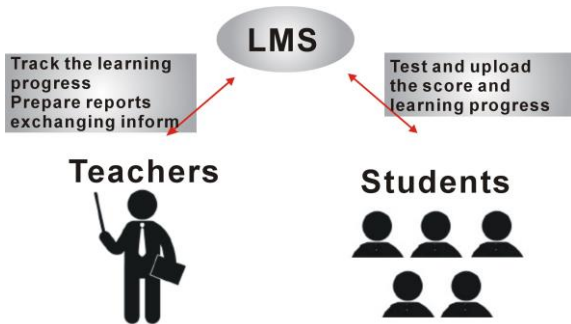

It is very helpful that use **CC30 HD Camera** with **LMS** or **CMS** system. With the **Plug and Play** functions of both the camera and the wireless microphone, it is simpler to install **LMS** or **CMS** system. Combined with 120-degree wide-angle lens design table to capture wider view and wireless movable wireless microphone allowing you can expand the scene size viewed and ensure the audio quality in a large-scale conference or classroom.

USE AVer CC30 CaptureShare SOFTWARE

Please download software from the following web link:

USA

<http://averusa.com/support/>

Global

<http://www.aver.com/download-center>

[Note] The version may be different.

Before You Begin

Make sure all connections are connected successfully before you are using the CC30 CaptureShare application. Connections error will cause no image showing, no audio or no reaction. (For more information, please refer to **INSTALLATION** chapter.)

Windows

Tool Bar

When you launch CaptureShare, the tool bar is showed at the bottom of the windows.

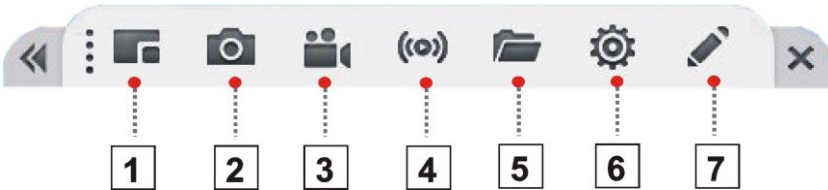

1. Select Layout

CaptureShare can connect up to two cameras simultaneously. There are four types of layout modes to choose.



- **No camera:** Shows no camera screen.

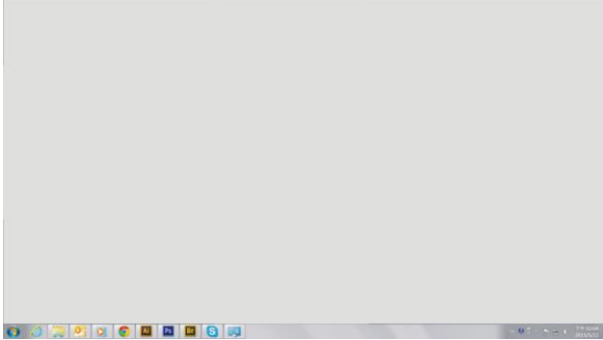

- **1 camera:** Shows 1 camera screen.

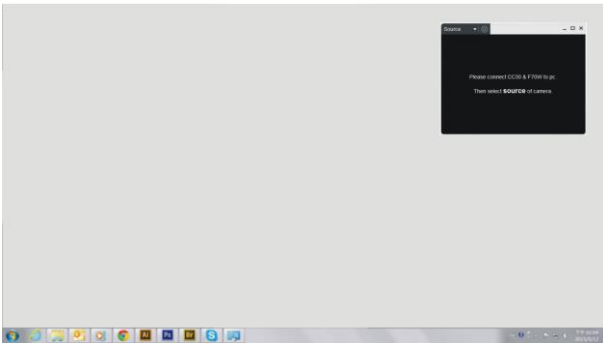

- **2 cameras:** Shows 2 camera screen.

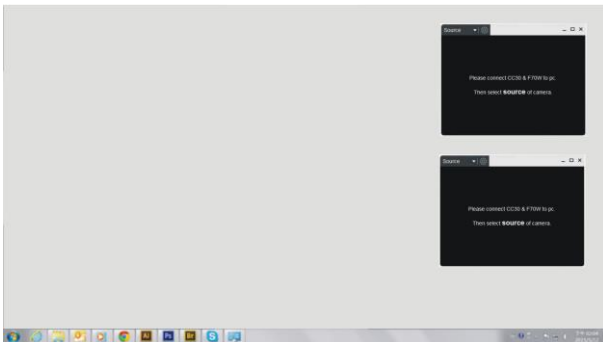

- **PIP mode:** Picture in Picture mode. One camera small screen is displayed on the other camera full screen at the same time. Sound is usually from the main program only.

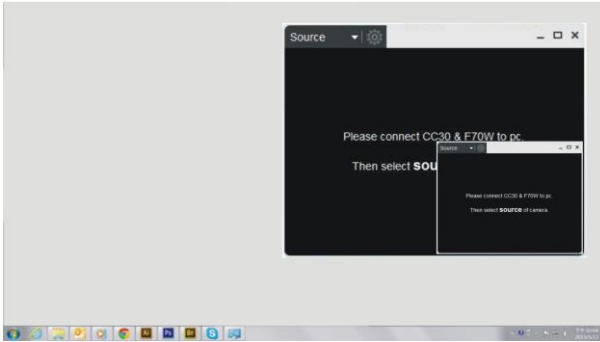

Select source of camera then connect the camera to the computer or laptop.

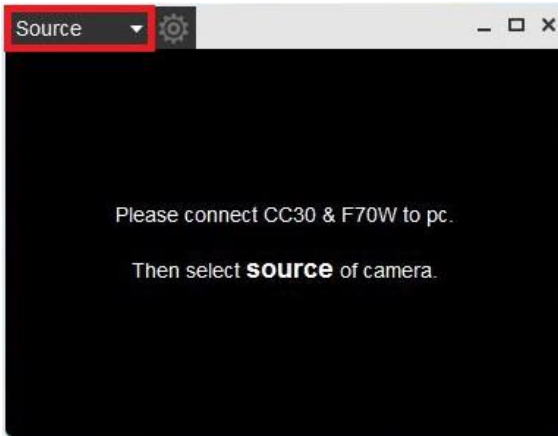





2. Capture Desktop

Click the  button to capture a screen shot of the computer or laptop.

3. Record Desktop

Click the  button to show the Desktop Control.



- Click the  button to start record the movement of the screen of the computer or the laptop.
- Click the  button to pause recording.
- Click the  button to stop recording.
- Click the  button to choose the build-in microphone of the camera or the wireless microphone.
- Slide the blue spot on the volume bar  to control the record volume.

4. Stream Setting

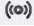
Streaming is a technology that the videos are broken up into several sections before sending to the end user. The process of the transmission and playback of the video are simultaneous in order to shorten the download times. Click the  button showing the **Stream Setting**.

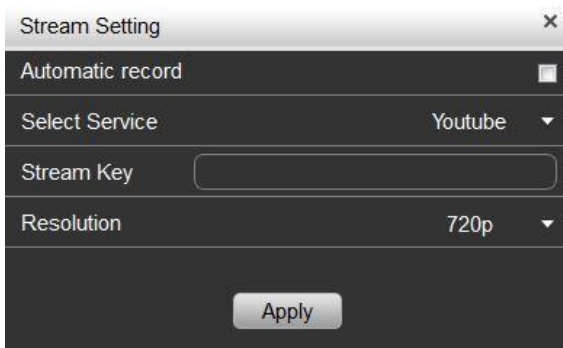

- There are two Select Service: YouTube and LiveHouse.in
- There are four Resolution: 1080P, 720P, 480P, 360P
- You can set a Stream Key.

After setting click the  button to confirm the settings.

5. Open File

Click the  button to review all the recorded videos and captured shots.

6. Other Setting

- **Network Information:** QR code for connection of an android mobile phone and a computer or laptop.

[Note] The computer or laptop and the mobile phone should share the same Wi-Fi network.

- **Language Setting:** Set the language displayed on the screen.

- English
- 日本語
- Polski
- Русский
- 繁體中文

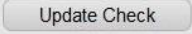
- **Software Update/Firmware Update:** Click the  button to check if the version of software and the firmware is the latest. It is recommended to check if the software and firmware need to upgrade regularly for better use.

- **Stream Setting:**

- There are two **Select Service:** YouTube and LiveHouse.in
- There are **four Resolution:** 1080P, 720P, 480P, 360P
- You can set a **Stream Key.**









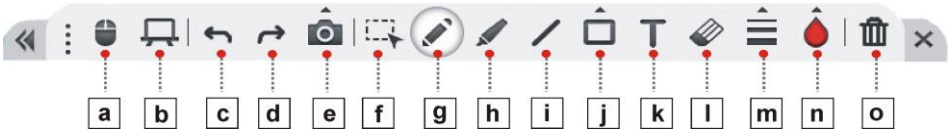



Click the  button to confirm the setting.



















7. Overlaytool

Click the  button to show overlaytool bar.

Overlaytool



<p>a. Mouse Mode</p>	<p>Click the  button to pause the Overlaytool function.</p>
<p>b. Whiteboard Mode</p>	<p>Click the  button to enter Whiteboard Mode. The full screen transfers to a whiteboard. Click the  button again to exit Whiteboard Mode.</p>
<p>c. Undo</p>	<p>Click the  button to cancel or reverse the effects of a previous action.</p>
<p>d. Redo</p>	<p>Click the  button to reconstruct.</p>
<p>e. Capture</p>	<p>Click the  button to capture the screen shot. There are three types capture mode to choose.</p> <div data-bbox="400 810 674 912" style="text-align: center;"> </div> <ul style="list-style-type: none"> - Click the  button to capture a full screen shot. - Click the  button to select a specific interface and capture a shot. - Click the  button to marquee a specific area and capture a shot.
<p>f. Select</p>	<p>Click the  button to select a specific object to modify or cancel.</p>
<p>g. Freehand</p>	<p>Click the  button to write or draw on the screen or the whiteboard in the Whiteboard Mode.</p>
<p>h. Highlighter</p>	<p>Click the  button to use highlighter to emphasize a specific area or object.</p>

i. Line	Click the  button to make a line.
j. Shape	<p>Click the  button to make six different types of shapes</p> <ul style="list-style-type: none"> -  Rectangle outline -  Rectangle -  Circle outline -  Circle -  Triangle outline -  Triangle
k. Text	Click the  button to enter text.
l. Erase	Click the  button to erase a specific object.
m. Color	<p>When you use Freehand, Highlighter, Line or Shape function, click the  button to set the color of line. There are six fixed colors to choose:  Red,  Yellow,  Green,  Blue,  Black, and  White. Or you can click the  button to set more colors.</p>
n. Clearall	Click the  button to clear all objects.

Recording Interface

You can make different setting on each recording layout screen. This menu shows when the camera is connected to your computer and laptop successfully. You can adjust these functions before recording or during recording.

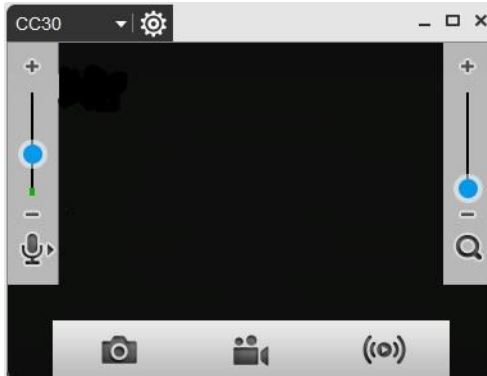

Following are descriptions for each function:

Volume

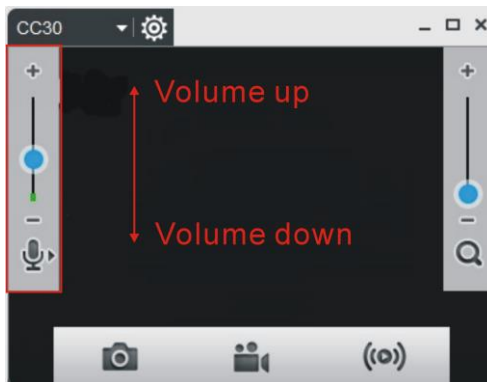

Set the recording volume on the left of the screen. Press the blue dot and move up to increase the volume. Conversely move down to decrease the volume.

Digital zoom

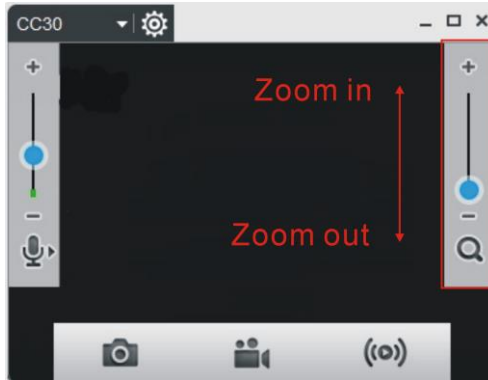

Set the recording digital zoom on the right of the screen. Press the blue dot and move up to zoom in. Conversely move down to zoom out.

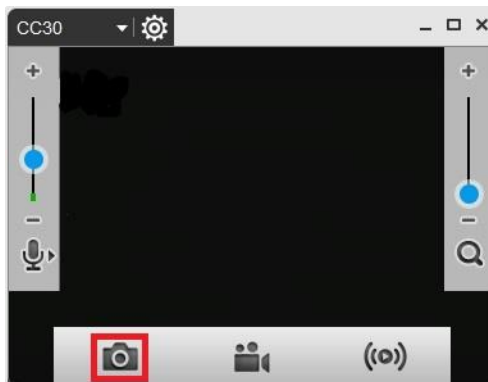

Capture recording

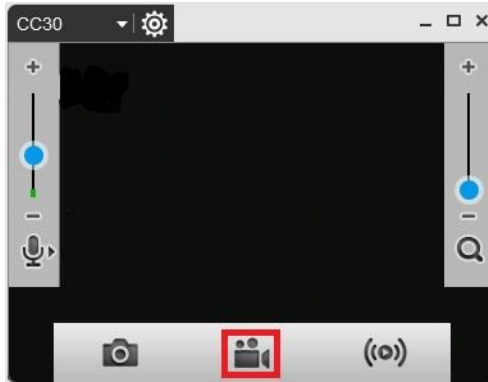

Click the  button on the bottom of the screen to take a screen shot. You can use the Capture recording function before recording or during recording.

Recording



- Click the  button to start recording.
- Click the  button to pause recording.
- Click the  button to stop recording.

Stream setting

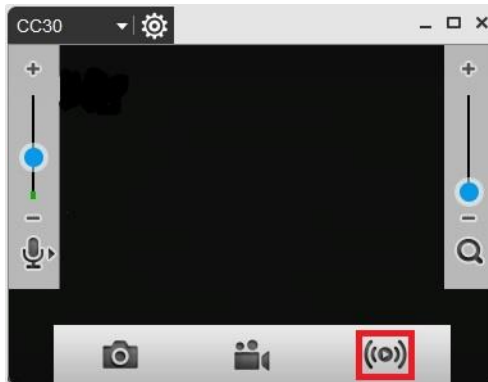

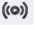
Streaming is a technology that the videos are broken up into several sections before sending to the end user. The process of the transmission and playback of the video are simultaneous in order to shorten the download times. Click the  button showing the **Stream Setting**.

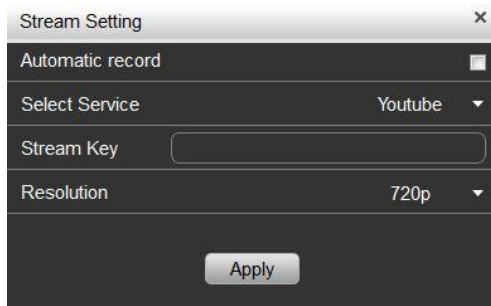

- There are two Select Service: YouTube and LiveHouse.in
- There are four Resolution items: 1080P, 720P, 480P, 360P
- You can set a Stream Key.

After setting click the  button to confirm the settings.

Recording Setting

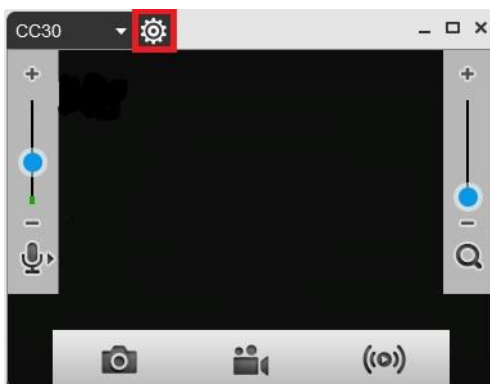

Click the  button on the top of the screen to enter **Recording Setting**.

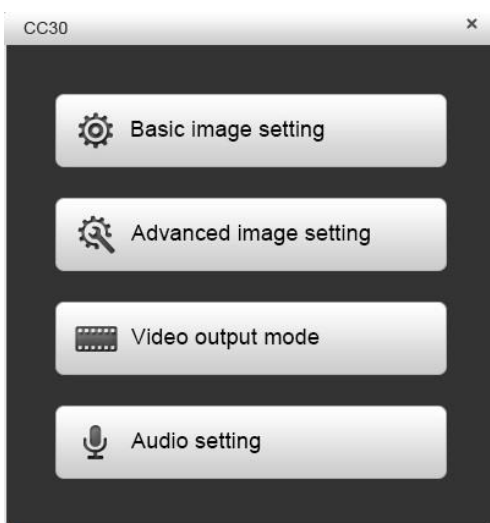

Basic image setting

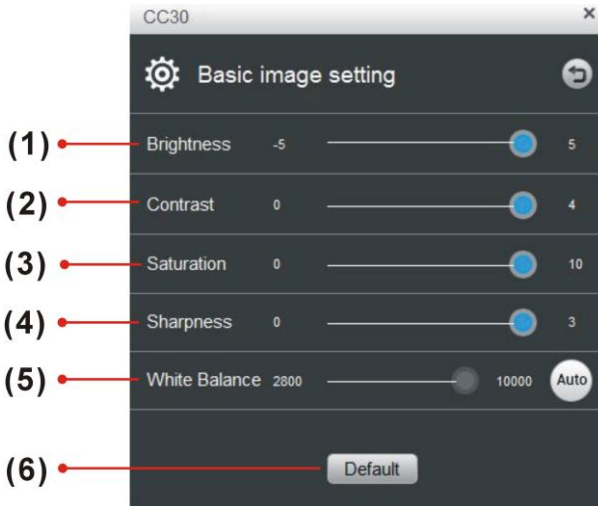

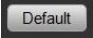
Name	Descriptions
(1) Brightness	Adjust the screen to be brighter or darker. Value: -5,-4,-3,-2,-1,0,1,2,3,4,5
(2) Contrast	Adjust the color and light of the picture. Value: 0,1,2,3,4
(3) Saturation	Adjust the degree of purity of a color. Value: 1,2,3,4,5,6,7,8,9,10.
(4) Sharpness	Higher the sharpness is, clearer the picture. Value: 1,2,3.
(5) White Balance	The White Balance feature can boil down to the concept of color temperature. Color temperature is a way of measuring the quality of a light source. Adjust the white balance to get the colors in your images as accurate as possible recorded the video. Or click the  button to enable automatic adjustment. Value: 2800~10000
(6) Default	Click the  button to reset all settings to factory default values.

Advanced image setting

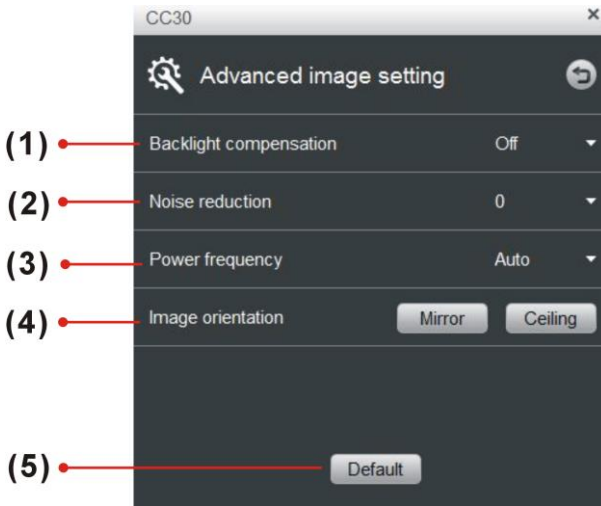

Name	Descriptions
(1) Backlight compensation	Backlight compensation allows the camera to adjust the exposure of the entire image to properly expose the subject in the foreground. Value: on/off
(2) Noise reduction	Adjust the level of reduction of noise during recording. Value: 0,1,2,3
(3) Power frequency	It depends on what voltage the country uses. 60Hz systems usually use 110V (120V) while 50Hz systems tend to use 220V or 230V. Value: Off/Auto/50Hz/60Hz
(4) Image orientation	Click the <input type="button" value="Mirror"/> button to mirror the screen. Click the <input type="button" value="Ceiling"/> button to put screen to the upper edge.
(5) Default	Click the <input type="button" value="Default"/> button to reset all settings to factory default values.

Video output mode

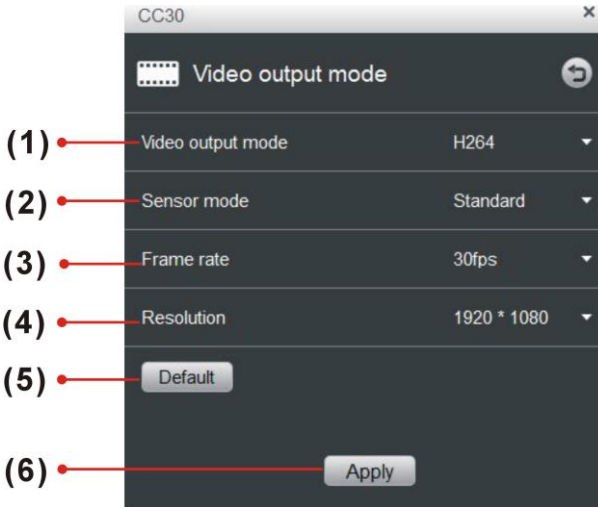

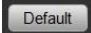
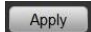
Name	Descriptions
(1) Video output mode	Value: H264/MJPG/YUY2
(2) Sensor mode	Value: Standard/60fps/8M
(3) Frame rate	Higher the RATE is, smoother the video. Value: 30fps/20fps/15fps/10fps
(4) Resolution	As the resolution goes up, the image becomes clearer, sharper, more defined, and more detailed as well. Value: 320*240/480*360/640*480/800*600/1280*960(4:3) 640*360/320*180/44*240/800*448/848*480/960*540/1280*720/1600*900/1920*1080(16:9)
(5) Default	Click the  button to reset all settings to factory default values.
(6) Apply	After setting click the  button to confirm the setting.

Audio setting

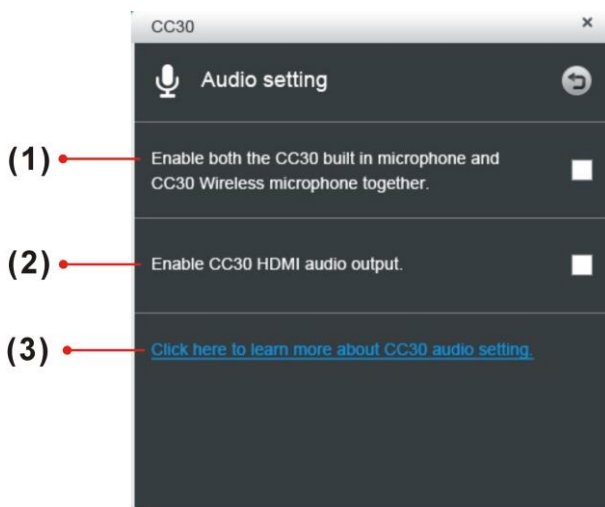

Name	Descriptions
(1) Microphone setting	Enable both the CC30 built in microphone and CC30 wireless microphone together. Value: Enable/Disable
(2) HDMI output setting	Enable CC30 HDMI audio output Value: Enable/Disable.
(3) More information	Click this link to learn more about CC30 audio setting.

[Note] Video output mode setting can't adjust during recording. Make sure that this setting is correct before recording.

Android

Use your android mobile phone as remote controller to control the camera properly. Improve the mobility of a conference or a course.

The Same Network

The computer or laptop and the mobile phone should share the same Wi-Fi network.

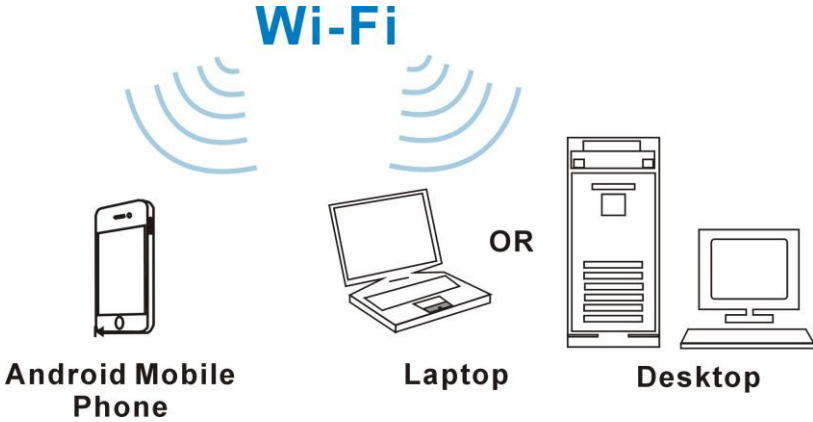

Connect to CaptureShare Software

1. Enable the CaptureShare APP in your android mobile phone and CaptureShare software in your computer or laptop simultaneously.

[Note]

- It is recommended that the version of the **CaptureShare** APP and **CaptureShare** software are the same for better using.
- You can check if the **CaptureShare** software is the latest in the **Software Update/Firmware Update** of **Other Setting**.

2. Find connection information through the **CaptureShare** software on your computer or laptop. In the **Network Information** of the **Other Setting** shows IP address or QR code.



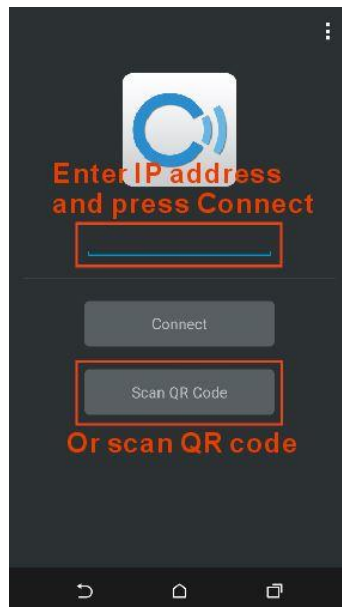

3. Enter the IP address or scan the QR code to the **CaptureShare** APP in your android mobile phone.

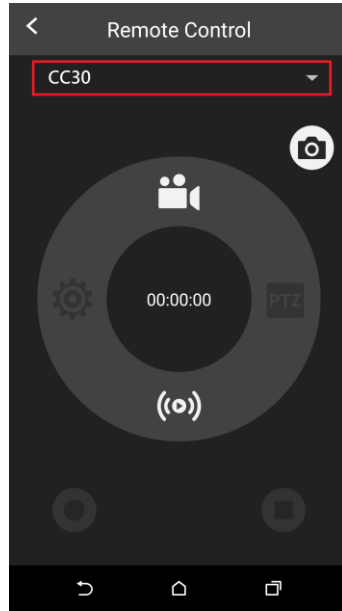

4. Select the source as CC30.
[Note] The camera is required to connect to your computer or laptop.



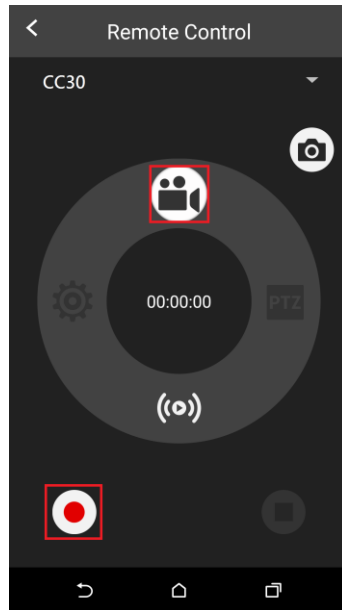

5. Press the  button firstly and press the  button to start recording.



6. After starting recording, your computer or laptop will show Desktop Control.



7. Press the  button to pause recording.
Press the  button to stop recording.

[Note] You can pause or stop recording on your computer or laptop.

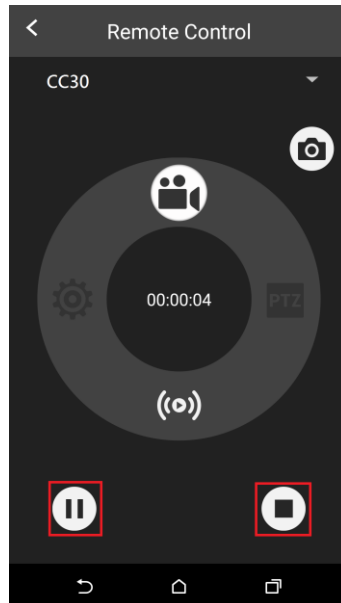

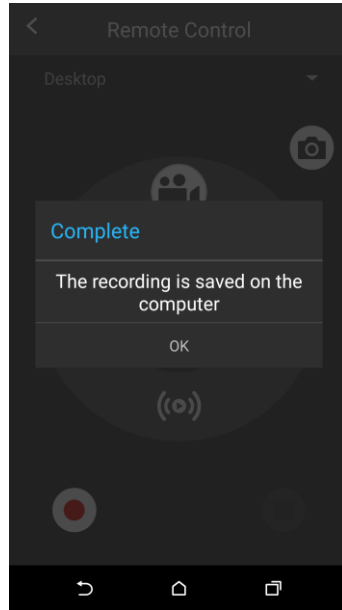

8. When the recording is complete, the recording file is saved on your computer or laptop.

[Note] Click the  button in the CaptureShare software in your computer or laptop to review the recorded videos.

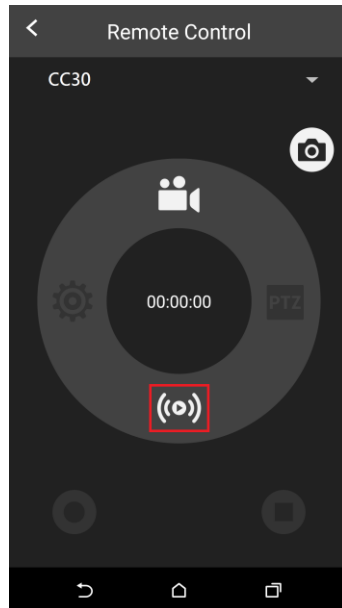

9. Press the  button to start stream. This function should set through the CaptureShare software in your computer or laptop.



10. Press the  button to capture the screen shot.

[Note] Click the  button in the CaptureShare software in your computer or laptop to review the captured shots.

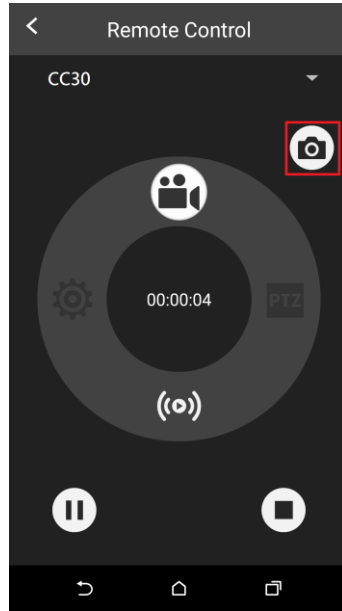

11. If you choose the source as **Desktop**, the recording video and the captured shots will be the screen of your computer or laptop.

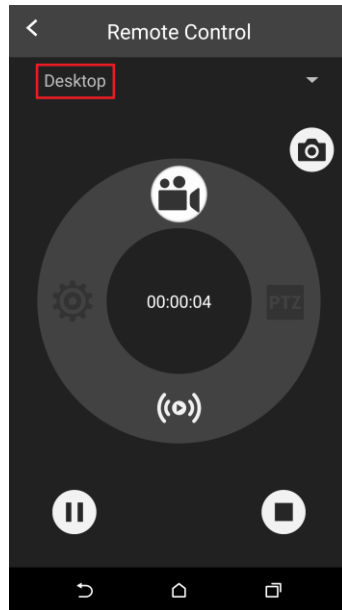

SOFTWARE APPLICATIONS

Before You Begin

Make sure all connections are connected successfully before you are using Video applications. Connections error will cause no image showing, no audio or no reaction. (For more information, please refer to chapter **INSTALLATION**.)

Making a Video Call

1. Open your Video application (Skype™, Skype for Business, Google Hangouts™, Zoom™, WebEx™, Adobe Connect™, WebRTC and etc.)
2. Some Video application needs specific account before using.
3. Set the CC30 as your primary camera, microphone and speaker devices in your application. (For more information, please refer to chapter **INSTALLATION**.)
4. Ready to make a video call.
5. It is highly recommended that setting low volume level before turn on the speaker for protecting your hearing when you start the video call.
6. For a good visual and audio effect, please refer to chapter **DEPLOYMENT**.

[Note] A computer or a laptop is required to use this device.

Skype

1. Download Skype™ from the official website.
(Reference: <http://skype.pchome.com.tw/download.html>)
[Note] A Skype™ account is required.
2. Install Skype™.
3. Open Skype™
4. Choose **CC30** as video camera.

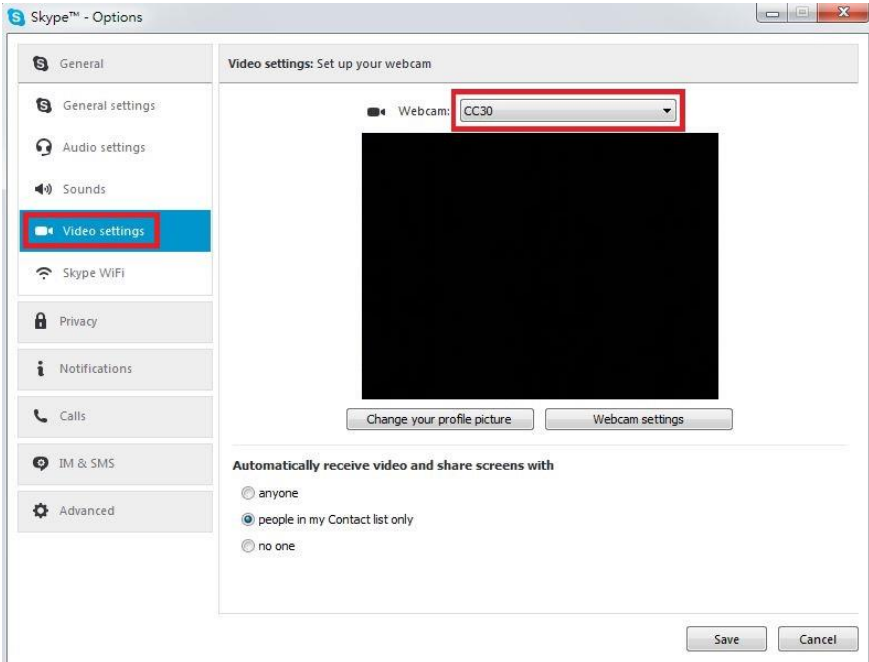

5. Choose **CC30 Wireless Microphone** (Echo canceling microphone) as video microphone.

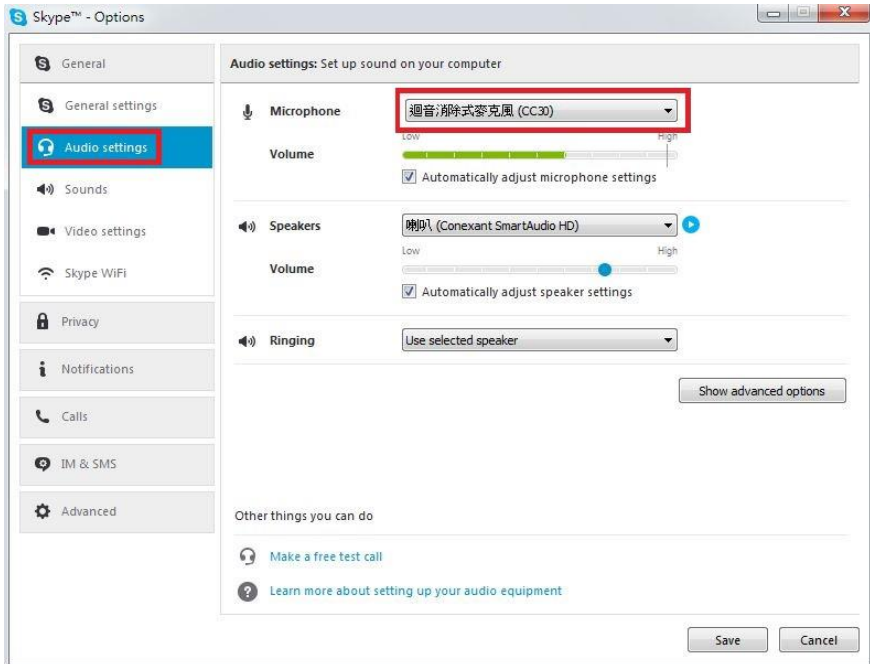

6. Start to make a video call.

Google Hangouts

1. Open your Google Hangouts.
(Reference: <https://hangouts.google.com/>)

[Note] A Google account is required.

2. Choose **CC30** as video camera.
3. Choose **CC30 Wireless Microphone** (Echo canceling microphone) as video microphone.

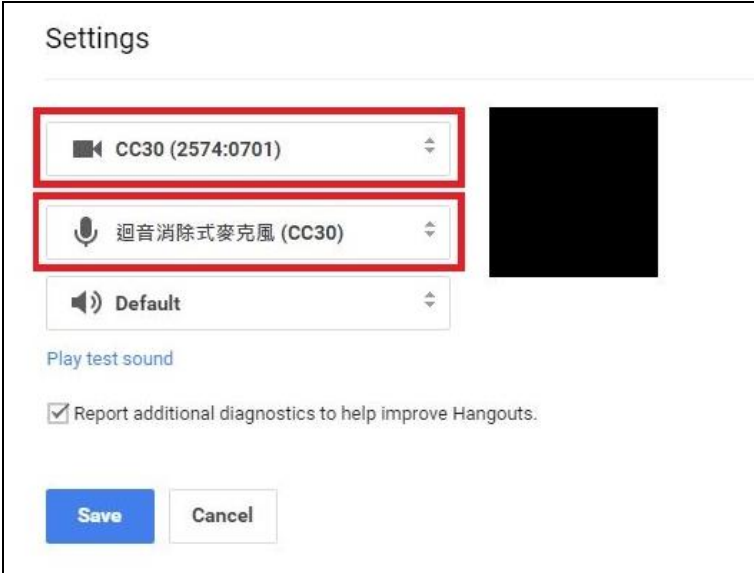

4. Start to make a video call.

Zoom

1. Download Zoom from the official website.
(Reference: <https://zoom.us/support/download>)
[Note] A Zoom account is required. Or you can use Google or Facebook account to register.
2. Install Zoom.
3. Open Zoom.
4. Choose **CC30** as video camera.

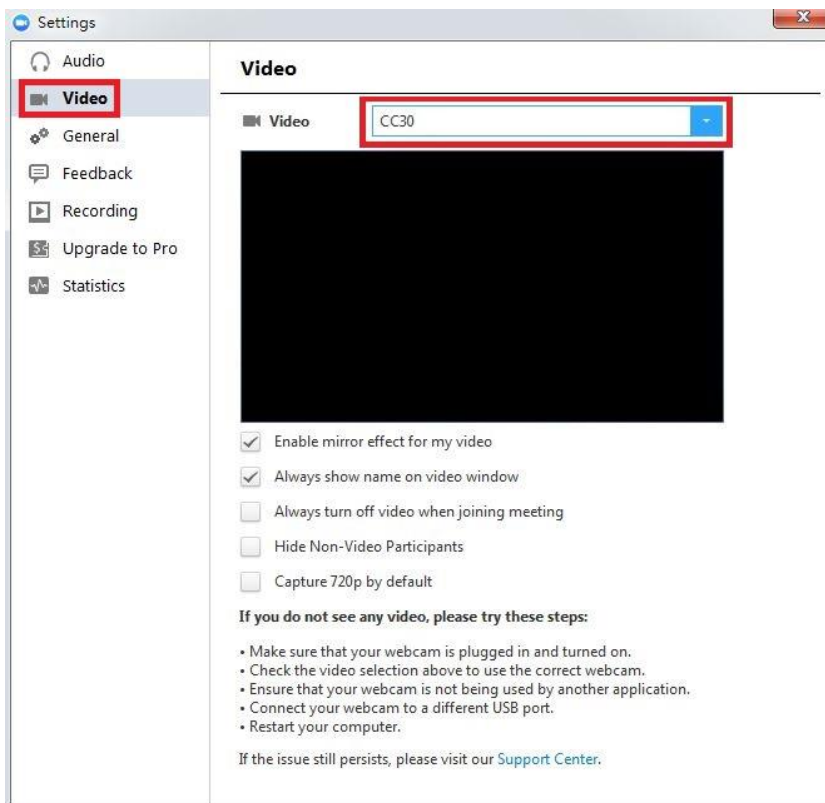

5. Choose **CC30 Wireless Microphone** (Echo canceling microphone) as video microphone.

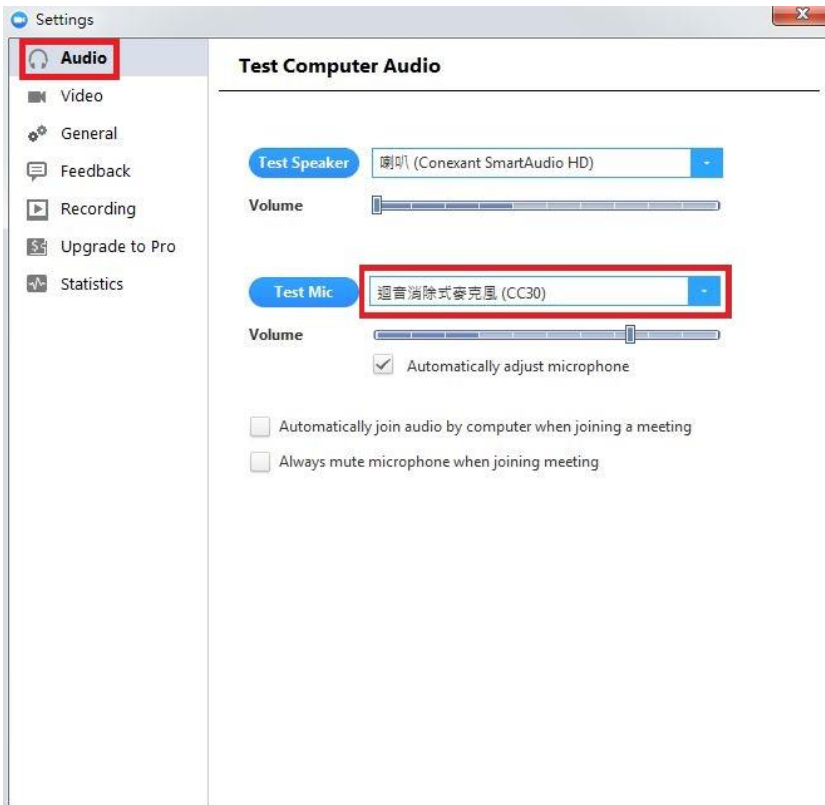

6. Start to make a video call.

TROUBLESHOOTING

Q: There are items in package are damaged.

A: Do not disassemble or modify the items by yourself. Contact the dealer for help when the items is failed to work.

Q: No audio.

A:

1. Please make sure the wireless microphone is not muted.
2. Please make sure the wireless microphone connections are properly connected as illustrated in the manual. (For more information, please refer to chapter **DEPLOYMENT**.)
3. Ensure proper volume level on the system.
4. Please make sure the microphone receiver placed into the receiver slot on camera rear panel.
5. Please make sure if the wireless microphone is with charged battery.
6. Please make sure that there is no too much obstacle between the camera and the wireless microphone to avoid reducing voice pick-up and the transceiver effect.

Q: The audio quality is poor

A:

1. Please make sure the wireless microphone is not damaged.
2. Please make sure if the battery of the wireless microphone is full.
3. Please make sure if the wireless microphone is not facing the output speakers to prevent echo.
4. Please make sure the distance between the camera and the wireless microphone is within 10 meters.
5. Please make sure the distance between the voice and the wireless microphone is within 2 meters.
6. Please make sure that there is no too much obstacle between the camera and the wireless microphone to avoid reducing voice pick-up and the transceiver effect.

Q: Unable to install the CaptureShare software

A:

1. Please make sure if your computer or laptop memory capacity is enough.
2. Verify if the firewall blocks the **CaptureShare** software.
3. Please try to restart your computer or laptop again.

Q: Unable to booting the CaptureShare application

A:

1. Please make sure if the installation is successful.
2. Restart your computer or laptop before use the **CaptureShare** firstly.
3. Try to reinstall the **CaptureShare**.

Q: Unable to connect the computer or laptop to the mobile phone when use the CaptureShare.

A:

1. Please make sure if the **CaptureShare** software on your computer or laptop and the **CaptureShare** APP on your mobile phone installed successful.
2. Please make sure if the **CaptureShare** software on your computer or laptop and the **CaptureShare** APP on your mobile phone enabled simultaneously.
3. Please make sure your computer or laptop and mobile phone are on the same Wi-Fi network.
4. Please make sure if the entered IP address in your mobile phone is correct.
5. Please make sure that your computer or laptop and mobile phone is not too far away from each other.
6. Please try to restart your computer or laptop again.

Q: Unable to connect to other lecture capture systems.

A:

1. Ensure the power status of the device from the other site is on.
2. Verify if the firewall blocks the inbound traffics from the other site.
3. Verify if the other site rejected your lecture capture systems.

Q: No image or poor image on the screen.

A:

1. Please make sure if pull down and open the privacy shutter of the camera.
2. Please make sure if the power adaptor connected to any power source and the power jack is on the camera rear panel.
3. Please make sure if the camera connected to your computer or laptop with USB cable successfully.
4. Please do not place objects before the camera to avoid influencing the recording effect. It is recommended the use properly the mini tripod to adjust the height of the camera for better recording effect.
5. Clean and dry thoroughly the lens to avoid influencing the recording effect.

[Note] Do not clean the lens with cleaners containing strong acid or alkaline.

Q: No image or poor image when use Video applications.

A:

1. Please make sure if pull down and open the privacy shutter of the camera.
2. Please make sure if the power adaptor connected to any power source and the power jack is on the camera rear panel.
3. Please make sure if the camera connected to your computer or laptop with USB cable successfully.
4. Please make sure if the **CC30** is chosen as video camera.
5. Please do not place objects before the camera to avoid influencing the recording effect. It is recommended the use properly the mini tripod to adjust the height of the camera for better recording effect.
6. Clean and dry thoroughly the lens to avoid influencing the recording effect.

[Note] Do not clean the lens with cleaners containing strong acid or alkaline.

SPECIFICATIONS

Camera		
Image Sensor	High resolution 8MP 1/3.2" CMOS	
Zoom ratio	8X digital	
Field of view	120° (Diagonal), 100° (Horizontal) @ 8MP full resolution	
Lens f-number	F2.0	
Built-in Microphone	Integrated dual full duplex omni-directional microphone with AEC and NR	
Video encoder	YUV, MJPEG, H.264 AVC high profile/baseline profile, H.264 SVC	
Resolution	YUV	720p@10fps, 360p@30fps, down to 320x180@30fps
	MJPEG	3264x2448@5fps, 1080p@30fps, 480p@60fps, down to 320x180@60fps
	H.264	3264x2448@5fps, 1080p@30fps, 720p@60fps, down to 320x180@60fps
Output interface	HDMI	HDMI connector *HDCP is not supported.
	Audio	Stereo mini-jack Line-Output (Φ 3.5mm)
	USB	USB 2.0 micro-B connector
LED indicator	Power and Wireless microphone connection status LED x 1	
Privacy	Mechanical privacy shutter	
Security	Kensington lock port	

Wireless Microphone	
Polar pattern	Omnidirectional
RF carrier frequency range	2.404 to 2.476 GHz
Working range	10 m (32.8 ft) ¹
Microphone sensitivity	-36 dB +/- 3 dB
Microphone SNR	58 dBA @ 1K Hz, 1 Pa A weighted
LED indicator	Power and wireless microphone connection status LED x 1 Battery status LED x 1
Battery type	AA x 2
Battery life	Typical up to 8 hours (Zinc-carbon) ² @25°C (77°F)
Compatibility and Compliance	
USB	USB 2.0 UVC video and audio for broad application compatibility
Driver	No driver needed for Windows 7, 8, 8.1, 10; Mac OS X, Chrome OS 29 above
Application Compatibility	Skype™, Skype for Business, Google Hangouts™, Zoom™, WebEx™, Adobe Connect™, WebRTC, YouTube™

¹ Actual range depends on signal absorption, reflection and interference.

² Calculated with a new battery, runtimes vary depending on battery.