

CONNECTING EXTERNAL DEVICES

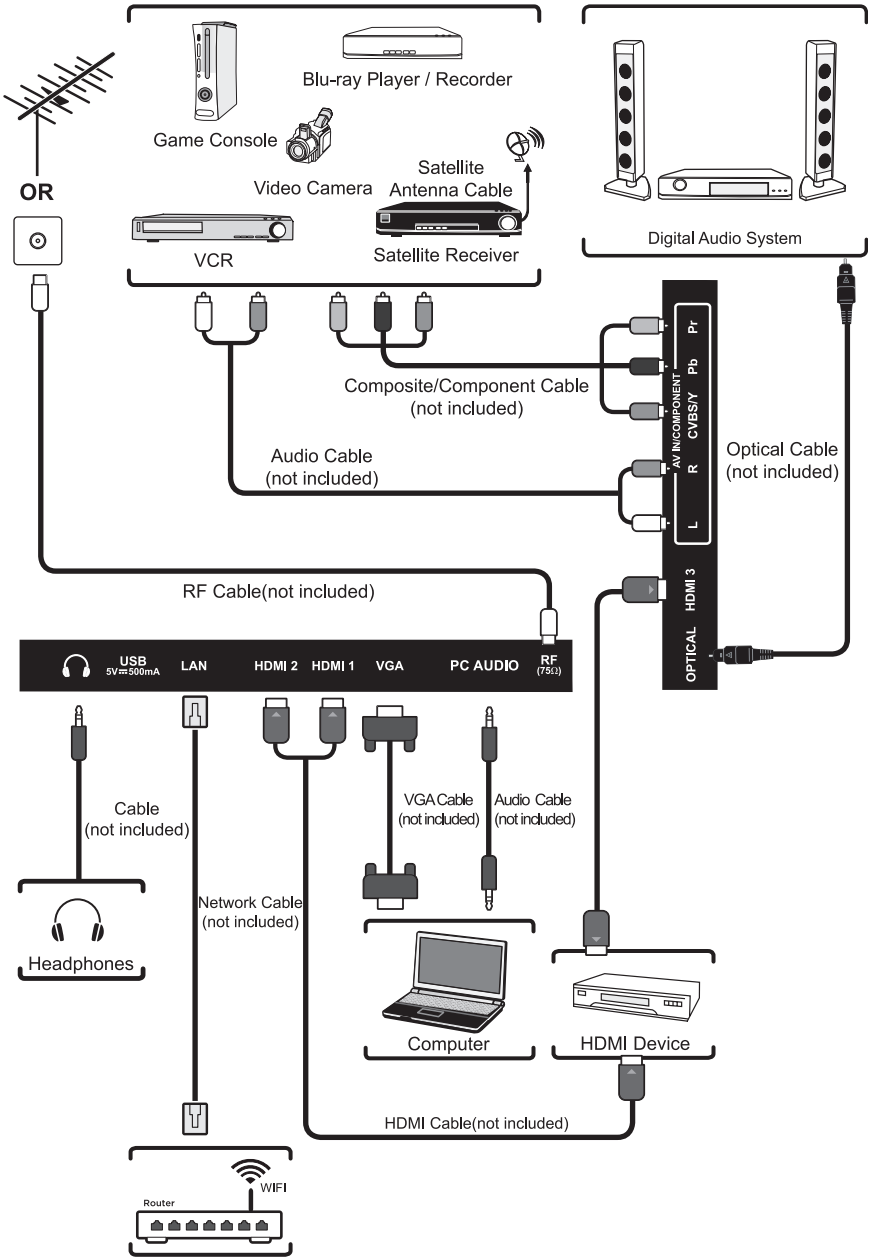

CUSTOMIZING TV SETTINGS

Turning On/Off Your TV

- Connect the power cord to the power socket after you have completed all the physical connections. At this stage, the TV will enter Standby Mode and the red LED indicator will illuminate.
- In Standby Mode, press the **⏻** button on the main unit or on the remote control to turn the TV on. The red LED indicator will turn blue.



The **POWER** button on the main unit or on the remote control can only switch the TV into standby. To completely turn off the TV, please disconnect the power cord from the power socket.

Setup Wizard

- The first time you turn the TV on; it will go into the Setup Wizard. Press the **▲/▼** buttons to select your desired mode and press OK button to confirm.

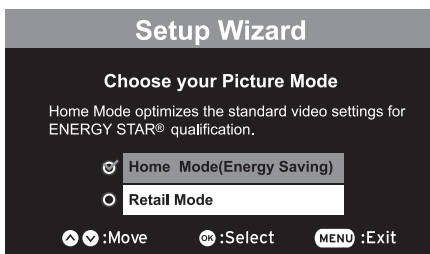

Home Mode (Energy Saving) is the default as-shipped television configuration and settings. And Home Mode (Energy Saving) is the setting in which the product qualifies for ENERGY STAR®. Any changes to default as-shipped television configuration and settings would change the energy consumption. And enabling certain optional features and functionalities may increase energy consumption beyond the limits required for ENERGY STAR® qualification, as applicable.

Retail Mode: Select Retail Mode if you would like your picture to be brighter. At times this mode may use more energy to operate the Volume/Sound mode and the Picture Mode. In this setting, the power consumption may possibly exceed the limited requirement of the ENERGY STAR® qualification.

ENERGY STAR® is a joint program of the U.S. Environmental Protection Agency and the U.S. Department of Energy helping us all save money and protect the environment through energy efficient products and practices.

The On-MODE Power under Home Mode should be less than 40.7 W.

The SLEEP-MODE Power should be less than 0.49 W.

CUSTOMIZING TV SETTINGS

Setup Wizard

- Press Yes to confirm.

Note: If you want change the modes between Home Mode(Energy Saving) and Retail Mode, you can change the setting in the Setup Menu under Display Mode.

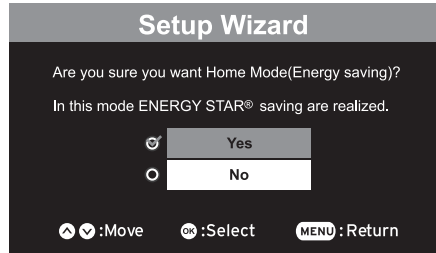

- Press the ▲/▼ buttons to select your desired mode and press OK button to confirm.

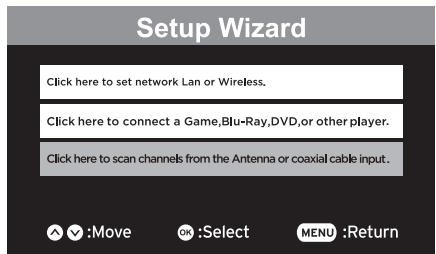

- Press the ◀/▶▲/▼ buttons to select your desired mode and press OK button to confirm.

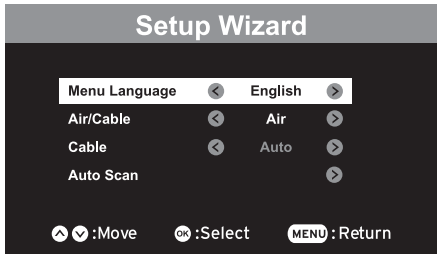

Menu Language	Select your desired language to be displayed on the menu. The default on-screen menu language is set as English.
Air/Cable	Select antenna between Air and Cable.
Cable	Select Cable system: Auto, STD, IRC, HRC.
Auto Scan	Search and store the available channels automatically.

CUSTOMIZING TV SETTINGS

Navigating The On-screen Display

- Press the **MENU** button to display the main menu.
- Press the **▲/▼** buttons to navigate and select the available menus.

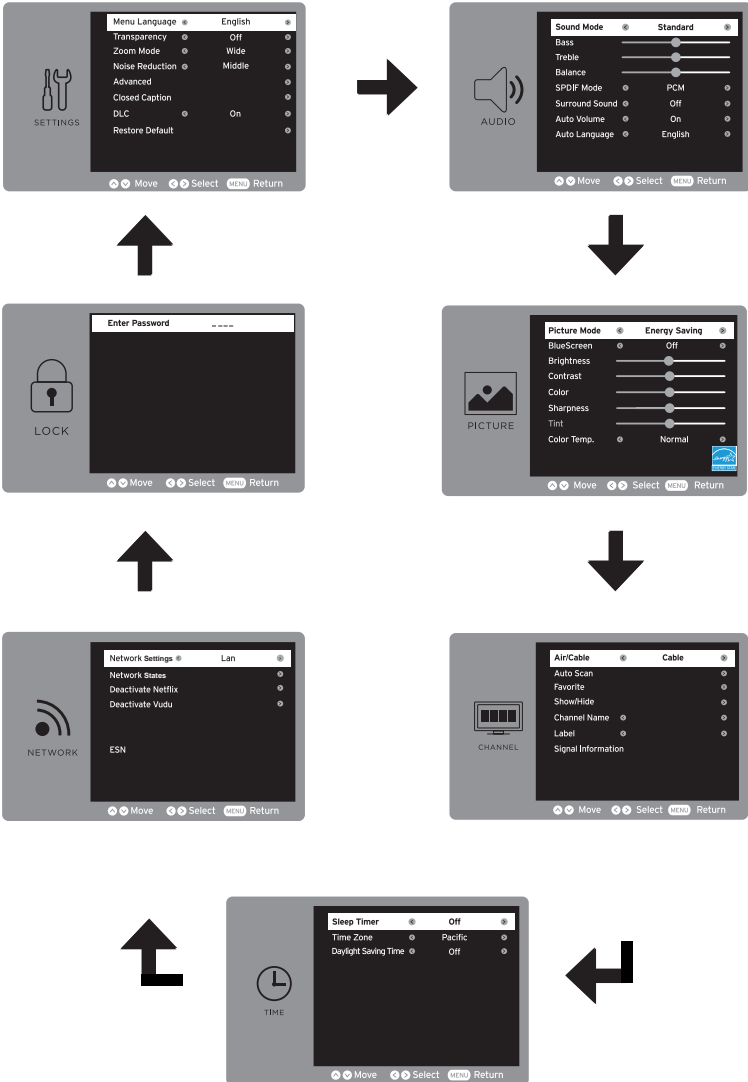

CUSTOMIZING TV SETTINGS

Streaming

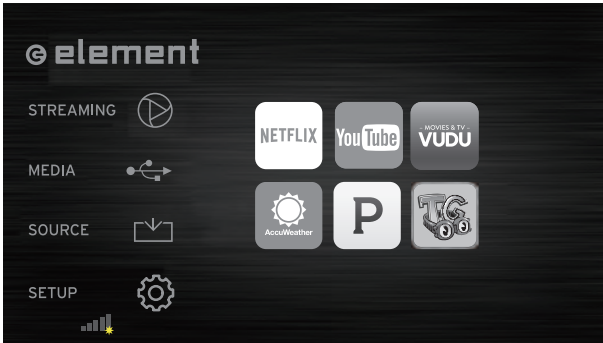

- Press the **MENU** button on the main unit or on the remote control to display the **STREAMING**. Then press **◀/▶** buttons to select the desired APP and press **OK** button to view what you want. Or press the hotkey on the remote control to enter the APP directly.

Note:After the TV connects to network, the status Unconnected will alter to Connected.

NETFLIX	Enjoys TV shows & movies streamed instantly over the Internet.
YouTube	YouTube your way on the best screen in your house.
VUDU	Discover, watch and collect the latest movies and TV shows in high quality 1080p. Free to sign up. No subscriptions, late fees or commitments.
AccuWeather	Displays the current weather conditions and the temperature anywhere in the world in centigrade or Fahrenheit.
Pandora	Free personalized radio that offers effortless and endless music enjoyment and discovery. Just start with the name of one of your favorite artists, songs, genres or composers and Pandora will do the rest. It's easy to create personalized stations that play only music you'll love.
Toongoggles	A subscription video on-demand platform that offers animated, fun and educational cartoons, engaging games and songs from all over the world and in many different languages to children.

CUSTOMIZING TV SETTINGS

Media

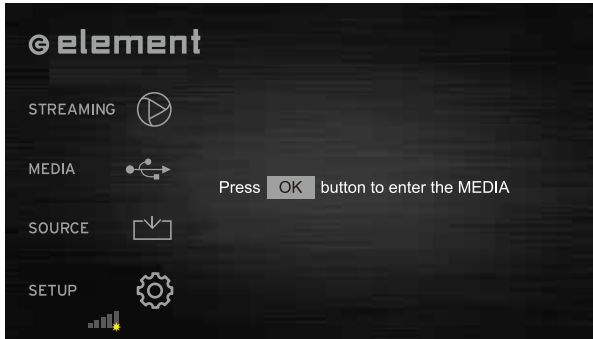

NOTE: Portable storage devices(USB disk or Hard disk) should be inserted.

- Press the **MENU** button on the main unit or on the remote control and then press **▲/▼** buttons to select the **MEDIA**, and then press **OK** button to enter.

Viewing Photos

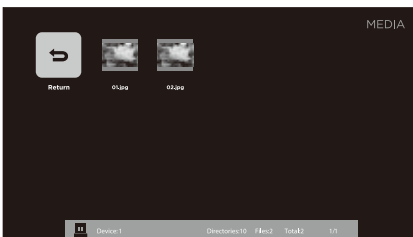
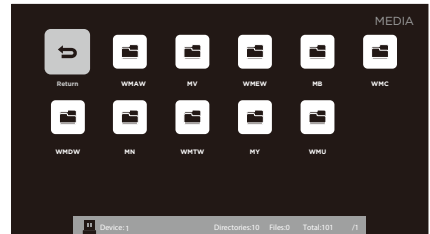
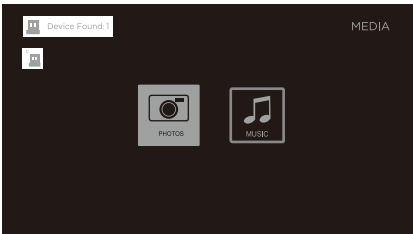

- After entering **MEDIA**, press **◀/▶** buttons to select **PHOTOS** and then select the disk type to enter. Then use **▲/▼ / ◀/▶** buttons to navigate in the picture folder and then press **▶||** button enter.

Note: File format supported: **JPEG**.

CUSTOMIZING TV SETTINGS

Listening To Music

- After entering **MEDIA**, press **◀/▶** buttons to select **MUSIC** and then select the disk type to enter. Then use **▲/▼** / **◀/▶** buttons to navigate in the music folder and then press **▶▶** button enter.

Note: File format supported: **MP3**.

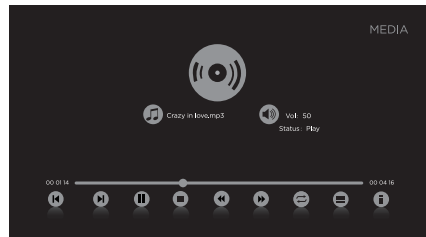
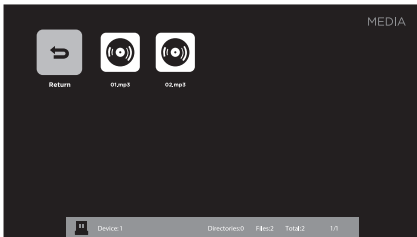
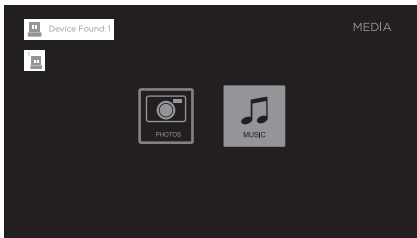

CUSTOMIZING TV SETTINGS

Selecting The Input Source



- Press the **SOURCE** button on the main unit or on the remote control to display the Input Source list.
- Press the ◀/▶ buttons to select your desired input source among: TV/AV/Component/HDMI1/HDMI2/HDMI3/VGA and then press **OK** button to confirm.

Channel Selection

- Press the **CH^/CH∨** buttons on the main unit or on the remote control repeatedly to select the channel.
- Press the **0-9** buttons on the remote control to select the channel directly.



Press "4", and then press **OK** button to select channel 4.
Press "4" and "5", and then press **OK** button to select channel 45.
Press "1", "2" and "3", and then press **OK** button to select channel 123.

Volume Adjustment

- Press the **VOL+/-** buttons on the main unit or on the remote control to adjust the volume.
- If you wish to switch the sound off, press the **MUTE** button again or the **VOL+** button to resume the sound.

CUSTOMIZING TV SETTINGS

Setup

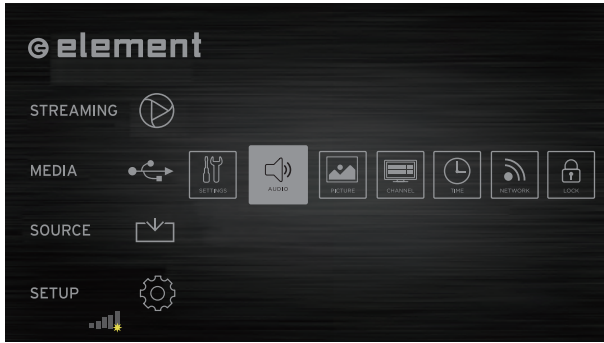

- Press the **MENU** button on the main unit or on the remote control to display the main interface. Then press **▲/▼** buttons to select **SETUP** menu and press **◀/▶** button to select the desired option.

Settings

- Press **◀/▶** buttons to select **SETTINGS** menu and then press **OK** button to enter.
- Press **▲/▼** buttons to select the following setting options and then press **◀/▶** buttons to adjust each option's setting.

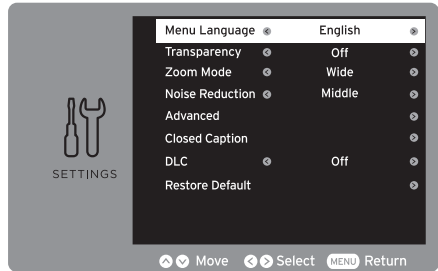

Menu Language	Select menu language:English, French or Spanish. The default on-screen menu language is English.
Transparency	Select to turn On/Off transparency function.
Zoom Mode	Select zoom mode:Normal/Wide/Cinema/Zoom/Just Scan(For HDMI)/Dot to Dot(For VGA). Note: Different input source, the zoom mode options may differ.
Noise Reduction	Reduce the noise level of the connected device:Off/Weak/Middle/Strong.

CUSTOMIZING TV SETTINGS

Advanced	Adjust advanced option's setting: Horizontal POS, Vertical POS, Clock, Phase or Auto. (VGA source mode only)	
Closed Caption	CC Mode	Select CC mode : On, Off or CC on Mute.
	Basic Selection	Basic Selection: CC1, CC2, CC3, CC4, Text1, Text2, Text3, Text4.
	Advanced Selection	Advanced Selection: Service1, Service2, Service3, Service4, Service5, and Service6.
	Option	Options: Mode, Font, Size, Edge Effect, Edge Color, Text Color, Background Color, Text Opacity, Background Opacity.
DLC	Select to turn On/Off the dynamic luminance control.	
Restore Default	Restore the TV to factory default settings.	

Audio Settings

- Press ◀/▶ buttons to select **AUDIO** menu and then press **OK** button to enter.
- Press the ▲/▼ buttons to select the following audio options and then press the ◀/▶ buttons to adjust each option's setting.

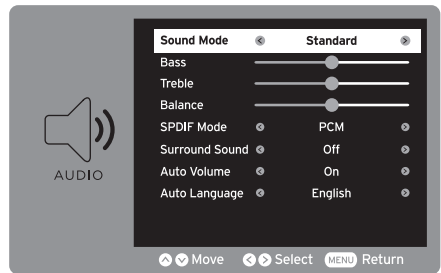

Sound Mode	Allow the selection of an audio-enhancement technique: Standard/Music/Movie/User Alternative: you may press the S.MODE button to select the sound mode directly.
Bass	Control the relative intensity of lower-pitched sounds. (For User mode)
Treble	Control the relative intensity of higher-pitched sounds. (For User mode)
Balance	Adjust the relative volume of the speaker in a multiple speaker system.
SPDIF Mode	Select the digital audio output mode between RAW/PCM.
Surround Sound	Provide an enhanced listening experience.
Auto Volume	Volume levels are automatically controlled.
Audio Language	Select audio language among: English, French, Spanish

CUSTOMIZING TV SETTINGS

Picture Settings

- Press ◀/▶ buttons to select **PICTURE** menu and then press **OK** button to enter.
- Press the ▲/▼ buttons to select the following audio options and then press the ◀/▶ buttons to adjust each option's setting.

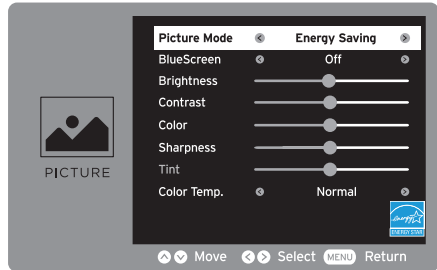

Picture Mode	Cycle among picture mode: Dynamic/Movie/Energy Saving/User/Standard. Alternative: you may press the P.MODE button to select the picture mode directly.
Blue Screen	Allow the blue background to turn On/Off during weak or no signal conditions.
Brightness	Increase or decrease the amount of white in the picture. (For User mode)
Contrast	Adjust the difference between light and dark levels in the pictures. (For User mode)
Color	Control the color intensity. (For User mode)
Sharpness	Adjust the level of crispness in the edges between light and dark areas of the picture. (For User mode)
Tint	Adjust the balance between red and green levels.
Color Temp.	Cycle among color temperatures: Cool/Normal/Warm.

CUSTOMIZING TV SETTINGS

Channel Settings

- Press ◀/▶ buttons to select **CHANNEL** menu and then press **OK** button to enter.
- Press the ▲/▼ buttons to select the following audio options and then press the ◀/▶ buttons to adjust each option's setting.

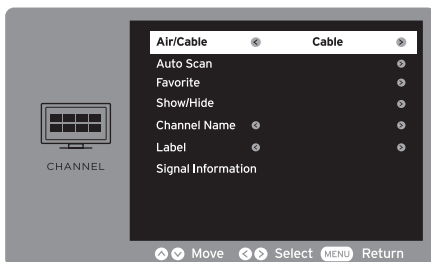

Air/Cable	Select antenna between Air and Cable.
Auto Scan	First, select your cable system from Auto/STD/IRC/HRC. Next, select the Auto Scan feature to scan your available cable channels. It will perform the auto scan if the Air antenna is selected.
Favorite	Set the selected channel as favorite channels.
Show/Hide	Show/Hide the selected channel.
Channel Name	Display the current channel name.
Label	Display the current channel label.
Signal Information	Display the information of current signal.

Time Settings

- Press ◀/▶ buttons to select **TIME** menu and then press **OK** button to enter.
- Press the ▲/▼ buttons to select the following audio options and then press the ◀/▶ buttons to adjust each option's setting.



Sleep Timer	Select a period of time after which the TV automatically switches to standby mode: Off/5/10/.../180/240 min. Alternative: You may press the SLEEP button repeatedly to select the number of minutes directly.
Time Zone	Select a Time Zone: Hawaii/ Alaska/ Pacific/ Mountain/ Central/ Eastern/ Atlantic/ Newfoundland.
Daylight Saving Time	Select to turn On/Off daylight saving time.

CUSTOMIZING TV SETTINGS

Network Settings

- Press ◀/▶ buttons to select **NETWORK** menu and then press **OK** button to enter.
- Press ▲/▼ buttons to select the following network options and then press ◀/▶ buttons to adjust each option's setting.

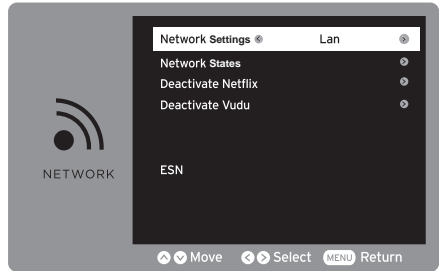

Network Settings	Select two types of network: Wireless or Lan.
Network States	Show details of network states. (Connect To, IP Address, Subnet Mask, Gateway, DNS Server IP address, MAC ADDR, Interface)
Deactivate Netflix	Deactivate Netflix and clear the account information.
Deactivate Vudu	Deactivate Vudu and clear the account information.
ESN	Electronic Serial Number.

CUSTOMIZING TV SETTINGS

Lock Settings

- Press ◀/▶ buttons to select **LOCK** menu and then press **OK** button to enter.
- Use the **0-9** buttons to input 4-digit password to enter the **LOCK** menu.
- Press the ▲/▼ buttons to select the following options and then press the ◀/▶ buttons to adjust each option's setting.

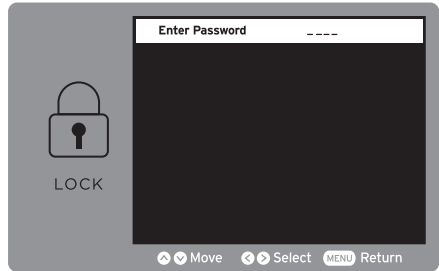

The default password is "0000".

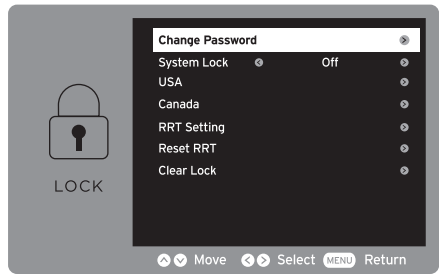

Change Password	Use 0-9 buttons to input the old password and then input the new 4-digit password. Re-enter new password for confirmation.	
System Lock	Select to turn On/Off system lock. The following options (USA, Canada, RRT Setting and Reset RRT) will only be accessible when you turn the system lock on.	
USA	TV	TV RATING: Press OK button to lock or unlock TV rating.
	MPAA	Select MPAA rating : N/A,G, PG, PG-13, R, NC-17,or X.
Canada	Canada English	Select MPAA rating for English-speaking Canada : E, C, C8+, G, PG, 14+, 18+.
	Canada French	Select MPAA rating for Quebec Canada : E, G, 8 ans+, 13 ans+, 16 ans+, 18 ans+.
RRT Setting	Set Rating Region Table.	
Reset RRT	Select to reset the RRT setting.	
Clear Lock	Clear all lock settings.	

Parental Control

Press the **MENU** button on the main unit or on the remote control and then press the **▲/▼** buttons to select **LOCK** menu. Use the **0-9** buttons to input 4-digit password to enter the **LOCK** menu. If used, this option feature can "block" undesirable programming from appearing on the TV. Parental Control offers the user a wide variety of options and settings that restrict or "block" the programming that can appear on the TV. Parental Control allows the user the capability of defining which program rating they consider acceptable to the younger more sensitive viewer. It can be preset and turned either on or off by the user who specifies the secret 4-number code, the password. The number of hours blocked are specified. General audiences and children blocks should be both programmed into the TV's memory. Viewer ratings are specified for both TV and the motion picture Industry; both rating systems should be used, for complete coverage. The ratings are based on the ages of children.

Overview

To ensure complete coverage for all TV programs, (movies and regular TV shows) choose a rating for MPAA, from the selections below, as well as ratings from the TV Parental Guidelines Rating Systems below, using the Age Block option for General Audiences, and for children. In addition to those, you may wish to add additional restrictions from the content block menu, and submenus examples below.

Things to Consider before Setting up Parental Control

Determine which rating you consider acceptable to the viewer. (For example, if you choose TV-PG, more restrictive ratings will be automatically blocked; the viewer will not be able to see: TV-PG, TV-14, or TV-MA rated programming.) Do you want to block the auxiliary video source entirely? (Blocks the signal sent by the equipment, such as VCR, connected to the TV Audio/Video Input Jacks) Or leave unblocked, then choose allowable ratings. Block program "Content" based on individual parameters such as: Strong Dialog, Bad Language, Sex Scenes, Violence Scenes, or Fantasy. Violent Scenes; in Content Blk option. Select a secret password, in the Set Password option, using the numbers keys on the remote control. Do not forget the password, it is the only way you can access the Parental Control menu and change rating selections, or turn Parental Control off. Do you want the Parental Control to be active at all times? If not, you can turn it on or off with the Lock On/Off option.

- You can set different Parental Control viewing restrictions for general audiences and for children, both can be active at the same time.
- Simply specifying one content block such as Sex Scenes, will not automatically restrict the programming that appears from the video sources.
- Even if you choose to leave the AUX Inputs unblocked, the ratings you specify will automatically restrict the programming that appears from the video sources.
- You can not disable Parental Control by disconnecting the TV from power. Block hours will be automatically reset to the original block time setting specified if power is disconnected.

CUSTOMIZING TV SETTINGS

Motion Picture Association of America (MPAA) Rating System

Grade	Meaning
G	General Audiences Content not offensive to most viewers.
PG	Parental Guidance Suggested Content is such that parents may not want their children to view the program.
PG-13	Parents Strongly Cautioned Program is inappropriate for pre-teens, with a greater degree of offensive material suggested than a PG rated program.
R	Restricted Not for children under 17, strong element of sex and/or violence.
NC-17	No children under age 17 Not for children under 17 under any circumstances. Strong sexual content.
X	Hard Core Films Same as NC-17 rating.
No Rating	No Rating MPAA Not Rated

TV Parental Guideline Rating System

Grade	Meaning
TV-Y	All Children Content not offensive to most viewers.
TV-Y7	Directed to Older Children Considered suitable for children over 7, may contain fantasy violence scenes.
TV-G	General Audience Considered suitable for all audience; children may watch unattended.
TV-PG	Parental Guidance Suggested Suggested unsuitable for younger children, may contain suggestive language, bad language, sex and violence scenes.
TV-14	Parents Strongly Cautioned unsuitable for children under 14, may contain strong language, bad language, sex and violence scenes.
TV-MA	Mature Audience Only Adults only, may contain strong language, bad language, sex and violence scenes.

Canadian Rating:

- Canadian English is used throughout all English-speaking Canada (E, C, C8+, G, PG, 14+, 18+).
- Canadian French is used in Quebec (E, G, 8 ans+, 13 ans+, 16 ans+, 18 ans+).



The V-Chip will automatically block certain categories that are "more restrictive". If you block TV-Y category, then TV-Y7 will be automatically blocked. Similarly, if you block TV-G category, then all the categories in the "young adult" will be blocked (TV-G, TV-PG, TV-14, and TV-MA).

TROUBLESHOOTING

If your TV does not operate normally or cannot be turned on, please check the following troubleshooting questions. Remember also to check any other connected electronic device, such as DVD or blu-ray player to pinpoint the problem. If the TV still fails to operate normally, please contact technical support (Refer to Warranty page).

SYMPTOM	POSSIBLE CAUSE	REMEDY
Dead. No LED lit	No power to the TV.	<ul style="list-style-type: none"> Check all connections to the TV's AC socket.
Dead. No LED lit red	Set in standby mode.	<ul style="list-style-type: none"> Press either the Power button or the Standby button on the remote control.
Blue screen	No signal.	<ul style="list-style-type: none"> Press the SOURCE button to select the correct source.
	Incorrect source selected.	
Noisy, snowy, ghosting picture (TV)	Poor antenna signal.	<ul style="list-style-type: none"> If using an indoor antenna, try adjusting the antenna position. Check antenna connections.
No sound	Sound "Mute".	<ul style="list-style-type: none"> Turn sound "Mute" off.
	Volume set too low.	<ul style="list-style-type: none"> Check volume settings.
	External leads not connected "if used".	<ul style="list-style-type: none"> Check that all external leads are connected properly.
PASSWORD		
Lost password	Select the SET Password setting in the LOCK menu, then enter the following master password "8899". The master password clears your previous password and allows you to enter a new password.	

TROUBLESHOOTING

Before contacting the service technician, perform the following simple checks. If any problem still persists, unplug the LED TV and call for assistance.

PROBLEM	POSSIBLE SOLUTIONS
No sound and picture	<ul style="list-style-type: none"> • Check that the main plug has been connected to a wall outlet. • Check that you have pressed the POWER on the front of the TV set. • Check the picture contrast and the brightness setting.
Red LED indicator lights	<ul style="list-style-type: none"> • Set in standby mode. Press either the Power button or the Standby button on the remote control.
Normal picture but no sound	<ul style="list-style-type: none"> • Check the volume. • Sound muted? Press the MUTE button. • Try another channel, the problem may be with the broadcast. • Are the audio cables installed properly?
The remote control does not work	<ul style="list-style-type: none"> • Check to see if there are any objects between the TV and remote control causing obstruction. • Are batteries installed with correct polarity (+/-)? • Correct remote operating mode set: TV, VCR, etc? • Install new batteries.
Power suddenly turns off	<ul style="list-style-type: none"> • Is the sleep timer set? • Check the power connection, power may be interrupted. • No broadcast on the station tuned.
Picture appears slowly after switching on	<ul style="list-style-type: none"> • This is normal, the image is muted during the product start up process. Please contact a service provider if the picture has not appeared after 5 minutes.
Poor color or picture	<ul style="list-style-type: none"> • Adjust the color in Menu option. • Keep a sufficient distance between the product and the VCR. • Try another channel, the problem may be with the broadcast. • Are the VIDEO cables installed properly? • Activate any function to restore the brightness of the picture.
Horizontal/vertical bars or picture shaking	<ul style="list-style-type: none"> • Check for local interference, such as an electrical appliance or power tool.
Blue screen	<ul style="list-style-type: none"> • Press the SOURCE button to select correct source.
Poor reception on some channels	<ul style="list-style-type: none"> • Station or cable experiencing problems. Tune to another station. • Station signal is weak, reorient antenna for better reception. • Check for sources of possible interference.
Lines or streaks in pictures	<ul style="list-style-type: none"> • Check the antenna (change the direction of the antenna).
No output from one of the speakers	<ul style="list-style-type: none"> • Adjust balance in the Menu option.

TROUBLESHOOTING

Note: When there is a problem in VGA mode (only when VGA mode is applied).

PROBLEM	POSSIBLE SOLUTIONS
The signal is out of range	<ul style="list-style-type: none">• Adjust resolution, horizontal or vertical frequency.• Check whether the signal cable is connected or loose.• Check the input source.
Vertical bar or strip on the background, horizontal noise and incorrect position	<ul style="list-style-type: none">• Set the auto configure or adjust clock, phase, or H/V position.
Screen color is unstable or is a single color	<ul style="list-style-type: none">• Check the signal cable.• Reinstall the PC video card.

Maintenance

Early malfunction can be prevented. Careful and regular cleaning can extend the amount of time you will have with your new TV. Be sure to turn the power off and unplug the power cord before you begin any cleaning.

Do not use your TV in areas that are too hot or too cold, because the cabinet may warp or the screen may malfunction. Your TV works best in temperatures that are comfortable to you.

Storage temperatures are 32° to 122°F(0° to 50°C).

Working temperatures are 32° to 95°F(0° to 35°C).

Do not place your TV in direct sunlight or near a heat source.

Clean the screen

A great tip to dust off your screen: wet a soft cloth in a mixture of lukewarm water and a little fabric softener or dish washing detergent. Wring the cloth until it's almost dry, and then use to wipe the screen.

Make sure the excess water is off the screen, then let air-dry before you turn on the TV.

Cleaning the cabinet

To remove dirt or dust, wipe the cabinet with a soft, dry, line-free cloth. Please be sure not to use a wet cloth.

**FCC STATEMENT**

This device complies with Part 15 of the FCC Rules. Operation is subject to the following two conditions:

- (1) This device may not cause harmful interference, and
- (2) This device must accept any interference received, including interference that may cause undesired operation.

Changes or modifications not expressly approved by the party responsible for compliance could void the user's authority to operate the equipment.

NOTE: This equipment has been tested and found to comply with the limits for a Class B digital device, pursuant to Part 15 of the FCC Rules. These limits are designed to provide reasonable protection against harmful interference in a residential installation.

This equipment generates uses and can radiate radio frequency energy and, if not installed and used in accordance with the instructions, may cause harmful interference to radio communications. However, there is no guarantee that interference will not occur in a particular installation. If this equipment does cause harmful interference to radio or television reception, which can be determined by turning the equipment off and on, the user is encouraged to try to correct the interference by one or more of the following measures:

Reorient or relocate the receiving antenna.

Increase the separation between the equipment and receiver.

Connect the equipment into an outlet on a circuit different from that to which the receiver is connected.

Consult the dealer or an experienced radio/TV technician for help.

FCC Radiation Exposure Statement

This equipment complies with FCC radiation exposure limits set forth for an uncontrolled environment. This equipment should be installed and operated with minimum distance 20cm between the radiator & your body.

NOTE: THE GRANTEE IS NOT RESPONSIBLE FOR ANY CHANGES OR MODIFICATIONS NOT EXPRESSLY APPROVED BY THE PARTY RESPONSIBLE FOR COMPLIANCE. SUCH MODIFICATIONS COULD VOID THE USER'S AUTHORITY TO OPERATE THE EQUIPMENT.

SPECIFICATIONS

Panel Size	42.5 inches diagonally
Display Type	DLED
Panel Technology	TFT
Panel 60 Hz Vs. 120 Hz	60 Hz
Display Resolution	Up to 1080P
HDMI & Component Support	1080P
Panel Resolution	1920 x 1080
Aspect Ratio	16:9
Contrast Ratio-Panel	1000:1
Brightness (Centre Typ.) Cd/M ²	170~200
Response Time (G To G)	8 ms
Lamp Life (Typ. Hours)	20,000 hours
Horizontal Viewing Angle (L ₀ /3)	100
Vertical Viewing Angle (L ₀ /3)	80
TV System	ATSC/NTSC
Channel Range	VHF/UHF

Design and specifications are subjects to change without prior notice.

OTT APP SERVICE

If you want to know about these APP information or get more service. Please refer to following content.

- Netflix



You can call the following telephone for more help: **866-579-7172**

If your matter is regarding customer service, please refer to <https://contactus.netflix.com/help> for alternative contact information.

- YouTube



You can browse the following website for more help:

<https://productforums.google.com/forum/#!categories/youtube/smart-tvs>

- VUDU



You can call the following telephone for more help: **888-554-8838**

- TG



You can call the following telephone for more help: **888-874-5411**

- Pandora



You can send E-mail to Pandora for more help: pandora-support@pandora.com

- AccuWeather



You can send E-mail to AccuWeather for more help: CustomerService@AccuWeather.com



This product contains electrical or electronic materials. The presence of these materials may, if not disposed of properly, have potential adverse effects on the environment and human health. Presence of this label on the product means it should not be disposed of as unsorted waste and must be collected separately. As a consumer, you are responsible for ensuring that this product is disposed of properly.



P/N:39060770

CONTENU

Consignes de sécurité importantes	2
Renseignements sur la sécurité	3
Préparation	4
Éléments compris	4
Vue avant	5
Vue arrière	6
Installation du socle	7
Retrait du socle en vue d'un montage mural	7
Télécommande	8
Connexion des appareils externes	9
Personnalisation des paramètres du téléviseur	10
Configuration initiale	10
Naviguer dans les paramètres de configuration	11
Diffusion	12
Média	13
Visionnement de photos	13
Écoute de musique	14
Source	14
Configuration	15
Paramètres	15
Audio	16
Image	17
Prog.	18
Heure	18
Réseau	19
Verrouillage	20
Contrôle parental	21
Dépannage	23
Entretien	24
Caractéristiques technique	25
Garantie limitée	26
OTT APP Service	27

CONSIGNES DE SÉCURITÉ IMPORTANTES

CONSIGNES DE SÉCURITÉ IMPORTANTES

- **Lisez ces consignes** – Avant d'utiliser ce produit, vous devez lire toutes les consignes liées à la sécurité et au fonctionnement de l'appareil.
- **Conservez ces consignes** – Nous vous conseillons de conserver les consignes liées à sécurité et au fonctionnement de l'appareil pour consultation future.
- **Observez toutes les mises en garde** – Vous devez suivre toutes les consignes liées au fonctionnement et à l'utilisation de l'appareil.
- **Suivez toutes les consignes** – Vous devez suivre toutes les consignes liées au fonctionnement et à l'utilisation de l'appareil.
- **N'utilisez pas cet appareil près de l'eau** – L'appareil ne doit pas être utilisé près de l'eau ou dans un lieu humide, par exemple dans un sous-sol humide ou près d'une piscine et autres.
- Nettoyez uniquement à l'aide d'un chiffon sec.
- N'obstruez pas les orifices de ventilation. Installez l'appareil conformément aux consignes du fabricant.
- N'installez pas l'appareil à proximité d'une source de chaleur comme un radiateur, une bouche de chaleur, une cuisinière ou d'autres appareils qui produisent de la chaleur (y compris les amplificateurs).
- Ne contournez pas le dispositif de sécurité de la fiche polarisée ou de la fiche de mise à la terre. Une fiche polarisée comporte deux lames dont l'une est plus large que l'autre. Une fiche avec mise à la terre comporte deux lames, en plus d'une broche de masse. La lame plus large ou la broche de masse vise à assurer votre sécurité. Si la fiche fournie n'est pas compatible avec votre prise, adressez-vous à un électricien pour faire remplacer la prise, qui est probablement désuète. Protect the power cord from being walked on or pinched particularly at plugs, convenience receptacles, and the point where they exit from the apparatus.
- Placez le cordon d'alimentation de sorte qu'il ne risque pas d'être piétiné ou coincé, particulièrement au niveau de la fiche et de la prise de courant, ainsi qu'au point de sortie de l'appareil.
- N'utilisez que les fixations et les accessoires recommandés par le fabricant.
- Utilisez l'appareil uniquement avec le chariot de manutention, le support, le trépied ou la table recommandé par le fabricant ou vendu avec l'appareil. Si vous utilisez un chariot, déplacez-le avec précaution afin d'éviter de le renverser et de vous blesser.





- Débranchez l'appareil en cas d'orage ou lorsqu'il reste inutilisé pendant une période prolongée.
- Confiez toute réparation à un technicien qualifié. Une réparation est nécessaire si l'appareil a été endommagé d'une manière ou d'une autre, par exemple lorsque le cordon d'alimentation ou la fiche est endommagé, si un liquide a été renversé sur l'appareil, ou si des objets sont tombés sur celui-ci, l'appareil a été exposé à la pluie ou à l'humidité, s'il fonctionne mal ou s'il est tombé. Please keep the unit in a well-ventilated environment.

- Veuillez installer l'appareil à un endroit bien aéré.
- **MISE EN GARDE** : pour réduire les risques d'incendie et de choc électrique, n'exposez pas cet appareil à la pluie ou à l'humidité. Ne l'exposez pas non plus aux égouttements ou aux éclaboussures. Ne placez pas d'objets remplis de liquide, par exemple un vase, sur le dessus de l'appareil.
- **MISE EN GARDE** : n'exposez pas les piles à une chaleur excessive comme celle induite par la lumière du soleil, un feu ou autrement.
- **MISE EN GARDE** : la prise secteur sert de dispositif de désaccouplage; elle doit demeurer facilement accessible.
- **MISE EN GARDE** : afin de réduire les risques d'électrocution, retirez pas le couvercle (ou le panneau arrière), car il n'y a aucune pièce réparable par l'utilisateur à l'intérieur. Confiez les réparations à un technicien qualifié.





 Le symbole représentant un éclair terminé par une flèche à l'intérieur d'un triangle équilatéral vise à avertir l'utilisateur du danger de la présence d'une « tension dangereuse » présente par des pièces non isolées à l'intérieur de l'appareil, éventuellement suffisante pour constituer un risque d'électrocution.

 Le symbole de point d'exclamation à l'intérieur d'un triangle équilatéral, vise à informer l'utilisateur de la présence de consignes de fonctionnement et de maintenance importantes dans la documentation qui accompagne l'appareil.

 Cet équipement est un appareil électrique de classe II ou à double isolation. Il a été conçu de sorte à ne pas nécessiter une connexion de sécurité mise à la terre.

 Ce produit contient des composants électriques ou électroniques. S'ils ne sont pas mis aux rebus adéquatement, ces composants pourraient nuire à l'environnement ou à la santé des humains.

 La présence de cette étiquette sur le produit signifie qu'il ne doit pas être mis aux rebus en tant que déchet non trié, mais faire l'objet d'une collecte sélective. Comme consommateur, vous devez vous assurer que ce produit est mis aux rebus de la bonne manière.

 Ce produit est conforme aux directives ENERGY STAR® pour l'efficacité énergétique. ENERGY STAR et la marque ENERGY STAR sont des marques américaines déposées. ENERGY STAR est une marque déposée appartenant au gouvernement des États-Unis.