

SMART INDOOR/ OUTDOOR RGB NEON QUICK START GUIDE

MLB7-1033-RGB - V8.0 0823

GETTING STARTED

Thank you for choosing the Neon Indoor/Outdoor LED Light Strip by Monster Smart Illuminescence. This quick start guide will help you with setup and installation of your device.

WHAT'S IN THE BOX

- Neon Indoor/Outdoor LED Light Strip (16.4ft/5m)
- Mounting Clips + Screws
- Power Adapter (24V 1.5A, 6ft/1.8m cord)
- Quick Start Guide

WHAT DO YOU NEED?

- Cellphone or tablet with Android™ 6.0 Marshmallow or higher / IOS 10 or higher
- Wi-Fi router with an internet connection
- Wi-Fi 2.4GHz 802.11n
- Phillips head screwdriver

Before setup, make sure your phone is connected to the **2.4GHz Wi-Fi network** that your Neon will be placed on. For easier pairing, turn on Location and Bluetooth to quickly find nearby devices.

TIP: Do you know your Wi-Fi network name and password? Write it down now if it's hard to remember.

ANYTHING ELSE?

Your Neon LED Light Strip is very flexible and can be used to write messages or draw glowing images! If your design ideas are ambitious, draw it out on paper or try out different designs with your Neon on the floor or a table to plan where the mounting clips should be placed.

TIP: Save these instructions for future reference.

SETUP COMPLETE SETUP BEFORE INSTALLATION

Remove your LED Strip and all components from the box. **To prevent overheating, uncoil the light strip before use.**

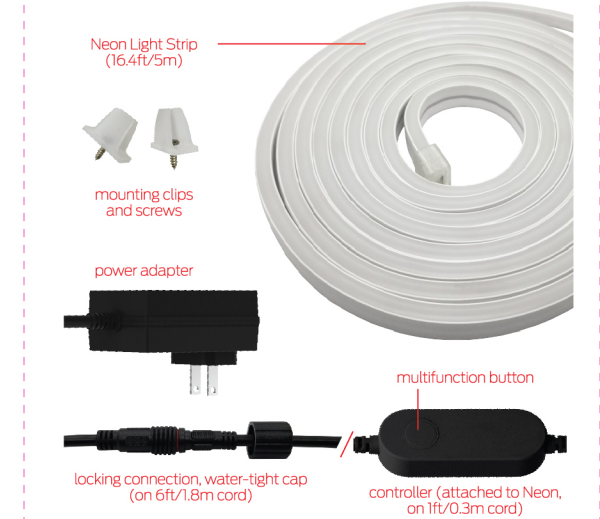

WATER-RESISTANCE

Your Neon Light Strip is water-resistant and is suitable for both indoor and outdoor use. The power adapter is NOT waterproof. To ensure maximum water protection:

- Ensure that the power adapter connection is tightly sealed.
- The power adapter must be connected to a GFCI protected hooded flush type cover plate receptacle marked "Wet Location" while in use outdoors.
- Do not submerge the strip, controller, or adapter in water.
- Do not cut, puncture, or otherwise damage the strip.

STEP 1

Download the **MONSTER SMART** app from the App Store (for iPhone) or Google Play Store (for Android phones).

STEP 2

Make sure your phone or tablet is successfully connected to the **2.4GHz Wi-Fi network** that your device will be placed on and **ensure that your Bluetooth is enabled.**



STEP 3

Open the **MONSTER SMART** app and create an account by following the on-screen instructions.

NOTE: Most Smart devices only work on a **2.4GHz Wi-Fi network.** Many newer home Wi-Fi networks are mixed networks that are set to 5GHz by default (ex: AT&T, Verizon) and you may need to use AP pairing mode to connect. If you still have difficulty, contact your Internet Service Provider for assistance with 2.4GHz network setup.

STEP 4

Connect the power adapter to a powered wall outlet, the light should turn on. If needed press the multifunction button twice to turn on the light.

Press and hold the multifunction button for 5-6 seconds to enter pairing mode. The light will begin blinking when it has entered pairing mode and is ready to pair.

STEP 4

Confirm that the device is in pairing mode, LED is RAPIDLY blinking.

In the **MONSTER SMART** app, select the "+" in the upper right corner of the home screen to add a new device.



The app will detect the nearby Wi-Fi+BLE enabled device and ask if you would like to add it, click "Go to add". Ensure that the device is checked and then click the "+" button.

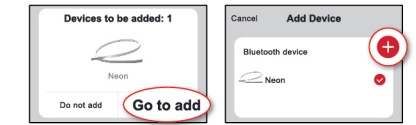

STEP 5

Confirm that the network displayed is your **2.4GHz Wi-Fi network**, then enter your Wi-Fi password and click "Confirm".

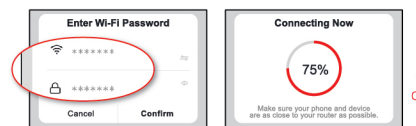

Once complete, your device will be connected to the network. Confirm or change the settings for your device and then click "Done". Your device is now setup and ready to use!

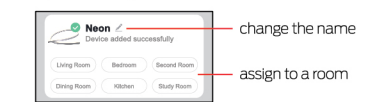

You can now use the app to add voice control (see pg 10), adjust settings, create custom lighting effects, set schedules, and more!

DESIGN

CREATE LINES AND CURVES

Neon's water-resistant housing makes it perfect for edge-lighting large outdoor spaces like decks, patios, and walkways, or for illuminating large indoor spaces with the look of premium, diffused lighting.

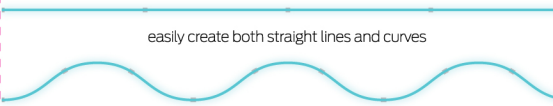

CREATE CUSTOM DESIGNS

The Neon is exceptionally flexible and can also be used to write cursive messages or create artistic, neon-style lighting designs to enhance any decor.

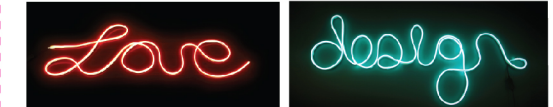
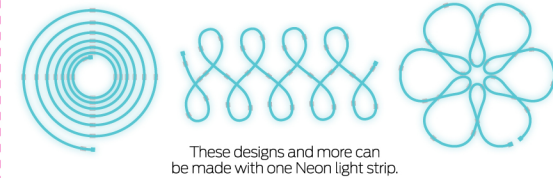

Before installing, try out different designs with your Neon on the floor or a table to decide what you would like to create!

DESIGN TIP: Shape your design and use tape to hold it in place. Make sure that you have enough mounting clips for each piece of tape, this will ensure your design looks the same when installed.

NOTE: To avoid damage, do not tightly fold the Neon light strip.

INSTALLATION

STEP 1

Determine where you will install the Neon. Make sure the location is still within the range of your Wi-Fi network and that it is close enough to a power source for the cord to reach without becoming a tripping hazard.

STEP 2

Using the included mounting clips and screws, and a phillips head screwdriver (not included), mount the Neon in the desired location. For best results place one clip approximately every 18 inches to secure the entire light strip evenly.



TIP: Place more mounting clips closer to curves or corners to better secure the strip around turns and use fewer on straight areas.

STEP 3

Once installed, connect the power adapter to the port on the cable and screw on the water-tight locking cap until secure.



Connect the other end of the adapter to a powered wall outlet (outdoors this must be a GFCI protected, hooded outlet.) The Neon will automatically reconnect to the paired Wi-Fi network and will now be ready to use!



ENJOY!

TROUBLESHOOTING

HAVING TROUBLE WITH SETUP?

Don't return this product to the retailer, we're here to help. Please call/write us for customer support: 866-246-2008 customerservice@monsterilluminescence.com

Q: Why is my device failing to connect to my Wi-Fi network?

- A1: Make sure your phone or tablet is successfully connected to the **2.4GHz Wi-Fi network** that your device will be placed on.
- A2: Make sure you enable Bluetooth and allow location services on your phone or tablet to find nearby devices.
- A3: If your Wi-Fi network is a mixed 2.4GHz/5GHz network, try using AP pairing mode for better results.



- 1. Press and hold the pairing button until the LED is **slowly blinking.**
- 2. In the app, select the "+" in the upper right corner of the home screen to add a new device and then select "Lighting (Wi-Fi)".
- 3. Click "Net Pairing Mode" in the upper right to switch to AP mode.
- 4. Confirm that the LED indicator is slowly blinking, confirm the network is your mixed Wi-Fi network, enter your Wi-Fi password, and click "Confirm".
- 5. Follow on-screen instructions to set up your device via wireless access point.

A4: If you still have issues with your mixed network, you may need to access your router settings and/or call your Internet Service Provider to create a separate 2.4GHz network.

Q: Can I cut this LED Light Strip?

A1: Yes. If desired, you can cut the light strip to shorter lengths. **However, once cut, the strip will no longer be water resistant or covered under the Monster warranty.** Be sure to remove the end cap and replace it on the new end of your light strip using waterproof glue.

Q: Can I attach additional LED Light Strips to this one?

A1: Due to the water-resistant design, this strip is not equipped with an expansion plug. Please group your Neon devices in the app. For instructions on how to group devices, please see page 9.

For other frequently asked questions please visit our website at www.monsterilluminescence.com