

Product Introduction

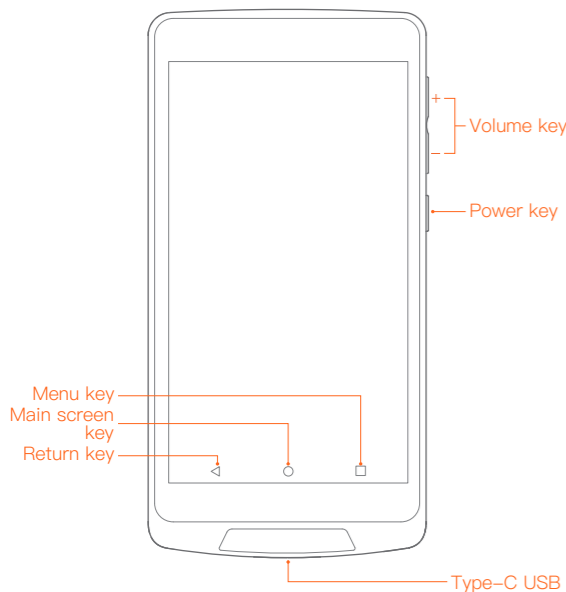

Power key

Short press: light the screen, lock the screen.
Long press: in shutdown mode, long press for 2 to 3 seconds to turn on the device;
in service mode, long press for 2 to 3 seconds, and you can choose to shut down or to reboot;
in crashed mode, long press for 11 seconds to automatically reboot.

Volume key

Adjust the volume

Return key

Click to return to the previous screen

Main screen key

Click to quickly return to the main screen

Menu key

Click to quickly check the program running at the backstage; choose application and sideslip to close this application.

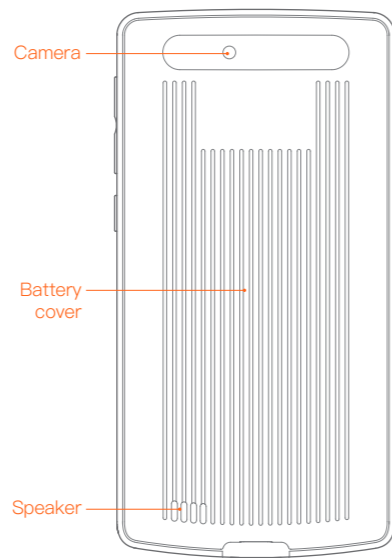

Camera

Used for payment code scanning, supporting 1 D & QR code.

Battery Instructions/Points for Attention

This device chooses 3.8V/3000mAh non-removable built-in lithium battery. Please don't disassemble it by yourself.

To ensure the lifetime of this battery, please don't charge it after it has been completely consumed.

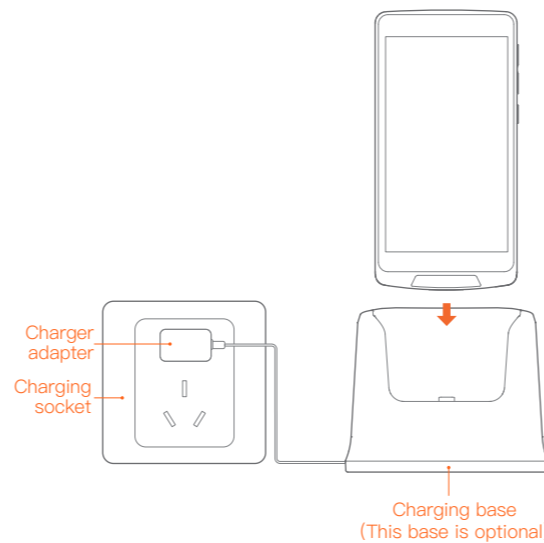

Charging & battery instructions

This device supports the charging with USB line, and also charging with charging base;

Insert the base adapter into the charging socket;

Place the device into the charging base in the direction as shown in this figure;

It is being charged, there will be a corresponding icon to display it on the screen;

If there is no charging icon displayed, please check whether the direction in which the device is placed into the charging base is correct or not.

Minimalist Setting

It will take only a few steps to enable an intelligent commercial device

① Long press the power key for 2 to 3 seconds, light the screen, enter the first boot interface and then operate according to the prompt. As for this device, there are two types of Internet surfing modes available.

② WiFi setting

- Click "Setting" button, and then enable WLAN to enter WLAN search interface. Wait for its search and listing of available WLAN hot spots;
- Click WLAN to be connected. If one encrypted network is selected, it is necessary to enter access password for connection.

How to download/use App

As for the relevant Apps, you may complete the installation by opening App market, browsing & downloading App in networking mode.

Common troubleshooting

Unable to turn on the device (for example: too low electric quantity of the device)

- Power on the device or place it onto the charging base to charge it. Turn the device on after charging for 3 minutes;
- Check whether charging state is normally displayed or not on the screen.

What to do if the device is crashed

Long press the power key for 11 seconds, and enter the reboot state.

More using help

After turning on the device, please check the "User Guide" of the application

Technical Indexes of the Product

Items	Technical Specification
Operating system	Android 7.1
CPU basic frequency	1.4GHz quad core
RAM	1GB LPDDR3
FLASH	8GB Nand Flash
Display screen	5 inch IPS, resolution 1280 x 720
Touch screen	Capacitive touch control screen
Camera	0.3MP FF
Wi-Fi	Built-in IEEE 802.11 a/b/g/n (2.4G/5G)
Bluetooth	BT4.2, BR/EDR, BLE
Button	Power key, volume key
Port	USB Type C port
Battery	3.8V/3000mAh
External dimension	L 144.4mm xW 73.2mm xH 13.7mm
Adapter	OUTPUT: DC5V/1A INPUT: AC100-240V/0.2A

Package Content

- One host
- One piece of User Guide
- One charging adapter
- One USB connection line
- _____

Points for Attention

Safety warning

- Please insert the AC plug into the AC socket corresponding to ID input on the accessory of power adapter;
- Strictly forbidden to be applied at sites with any potentially explosive gas;
- This is Grade A product. In the living environment, this product may cause radio interference. In this case, the user maybe required to apply feasible measures against the interference.
- About the battery replacement:
 - ① Replacing it with a wrong model of battery may cause the risk of explosion!
 - ② After replacement, the used battery should be delivered to the maintenance staff for handling. Never throw it into the fire!

Important Safety Instructions

- This terminal is a handheld device. The user is required to carry out shield with his/her body in the process of inputting individual password, to prevent the password from being peeped at by others;
- Avoid it to be installed or used during the thunder & lightning period, otherwise there will be risk of being electrically shocked by it;
- When you have discovered unusual odor, overheat or smog, please cut off the power supply at once!

Suggestions

- Do not use it in extreme cold or hot environment. For example: near the ignition source or lighted cigarette;
- Do not drop, throw or bend it;
- Try best to use it in clean and dust-free environment, to prevent small items from dropping into the terminal;
- Do not use it nearby the medical devices when not allowed.

Statement

Our company will not be responsible for the results of the following actions

- Damage caused by usage & maintenance not under the conditions of this guidance note;
- Our company will not be responsible for any damage or problem caused by any option or consumable (not the initial product or recognized product provided by our company). You have no right to make product modifications or changes without the consent of our company;
- The operating system of this product supports the official system update. If the user has flashed ROM system of third party or modified the system file by applying cracking method, it may lead to unstable system and bring safety risk and safety threat.

Disclaimer

Due to the product update, certain details of this document may be inconsistent with the product. Please refer to the material item. Our company owns the interpretative right of this document. We reserve the right to modify this user guide without giving advance notice.

Declaration of Conformity



BE	BG	CZ	DK
DE	EE	IE	EL
ES	FR	HR	IT
CY	LV	LT	LU
HU	MT	NL	AT
PL	PT	RO	SI
SK	FI	SE	UK

Hereby, Shanghai Sunmi Technology Co., Ltd. declares that the Wireless data ordering system(Model No.:T7820) is in compliance with the essential requirements and other relevant provisions of RED 2014/53/EU.

CAUTION: The user has to turn off the 5GHz WiFi in outdoor environment.

5.8G SRD receiver category: 1

CE certification information (SAR)

This device was tested for typical body-worn operations with the back of the handset kept 5mm away. To maintain compliance with RF exposure requirements, use accessories that maintain a 5mm separation distance between the user's body and the back of the handset. The use of belt clips, holsters and similar accessories should not contain metallic components in its assembly. The use of accessories that do not satisfy these requirements may not comply with RF exposure requirements, and should be avoided. If you are using pacemaker, hearing aid, cochlear implant or other device, please use the phone according to the doctor's advice.

PRODUCT SAFETY WARNINGS

Use responsibly. Read all instructions and safety information before use to avoid injury. The limit operating ambient temperature of the equipment declared by the manufacturer is -10~45°C

Battery safety

Charge battery only at ambient temperatures ranging from 40°C.

- (1) CAUTION: Danger of explosion if battery is incorrectly replaced. Replace only with the same or equivalent type of battery recommended by the manufacturer. Dispose of used batteries according to battery manufacturer's instructions.
- (2) CAUTION: RISK OF EXPLOSION IF BATTERY IS REPLACED BY AN INCORRECT TYPE. DISPOSE OF USED BATTERIES ACCORDING TO THE INSTRUCTIONS.
- (3) CAUTION: Battery charging temperature upper limit is 40°C.

Adapter safety

When charging, please place the device in an environment that has a normal room temperature and good ventilation. It is recommended to charge the device in an environment with a temperature that ranges from 0°C~40°C. For altitude 2km below use only

Camflash safety

LED is only used as indicating light.

Wi-Fi Safety

Turn Wi-Fi off in areas where Wi-Fi use is prohibited or when it may cause interference or danger, such as in airplanes while flying.

	Operation Frequency	Transmitted for EU only
WIFI	2412MHz-2472MHz	18.1dBm E.I.R.P
	5150MHz-5250MHz	15.0dBm E.I.R.P
SRD	5725MHz-5850MHz	13.97dBm E.I.R.P
BT	2402MHz-2480MHz	9.9dBm E.I.R.P

Please take attention that changes or modification not expressly approved by the party responsible for compliance could void the user's authority to operate the equipment.

This device complies with Part 15 of the FCC Rules. Operation is subject to the following two conditions:
(1) This device may not cause harmful interference, and
(2) This device must accept any interference received, including interference that may cause undesired operation.

Name and content of toxic and harmful substances contained in this product are shown in the following table

Name of parts	Toxic and harmful substances and elements					
	(Pb)	(Hg)	(Cd)	(Cr(VI))	(PBB)	(PBDE)
Circuit board	×	○	○	○	○	○
Shell	○	○	○	○	○	○

○:It indicates that the content of toxic and harmful substances in all homogeneous materials of this part is below the limit specified in SJ/T11363-2006.

×:It indicates that the content of toxic and harmful substances is higher than the limit specified in SJ/T11363-2006 in at least one homogeneous material of this part; however, the reason why the toxic substance of that part exceeds the limit is that there is no applicable material to replace it currently.

For products that have reached or passed the service years for environmental protection, they should be recycled according to Measures for Control and Management of Electronic Information Products and should not be thrown away at will.

This product can be used across EU member states. The full text of the EU declaration DOC is available at the following internet address: www.sunmi.com

Manufacture
Room 605,Block 7,KIC Plaza,No.388 Song Hu Road Yang Pu District,Shanghai, China



M2

USER GUIDE
T7820