

S2 User Guide

Please read carefully this instruction manual before using the product, Please keep it properly

Three options

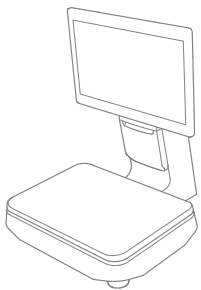

15.6"

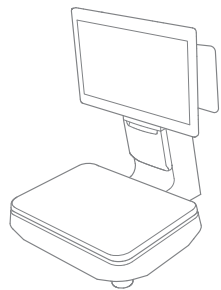

15.6" +10.1"

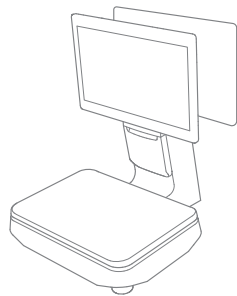

15.6" +15.6"

Quick Assembling

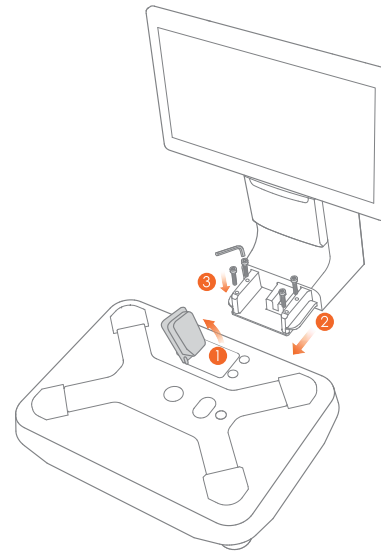

- 1 Open the rubber cover.
- 2 Fix the main screen to the scale body.
- 3 Assemble with the screws in the accessories.

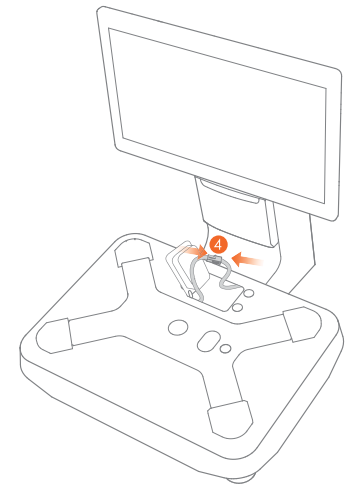

- 4 Connect the scale body with the main screen and then close the rubber cover.

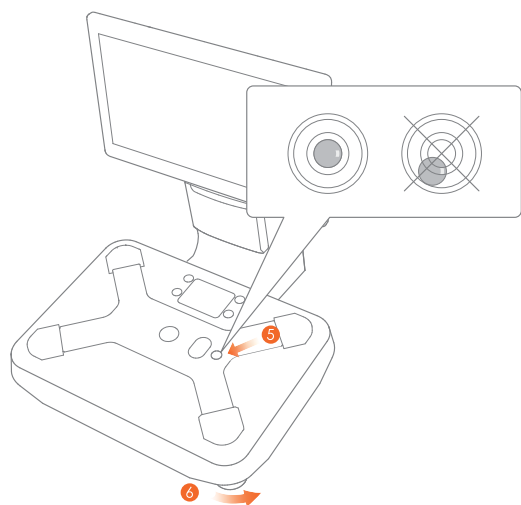

5 The scale is equipped with a level indicator to level the scale easily.

6 Please turn the adjustable scale feet under the scale body (4 under the scale body + 1 under the vertical rod) to adjust the scale body to be horizontal until the air bubble in the level indicator is positioned at the middle of the inner circle.
(Only a perfect levelled scale delivers accurate weighing results)

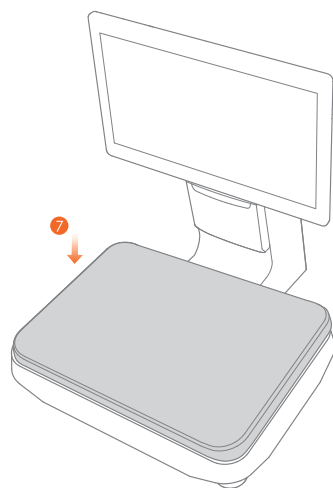

7 Install the scaleplatter onto the scale body.

Simple Setting

It only takes several steps to enable this smart commercial device.

- 1 Press the power button to turn on the device, enter the initial boot-up interface, then follow the prompts. Two on-line modes for choice.
- 2 WIFI setting
 - Click "Setting" button, and then enable WLAN, enter WLAN search interface to wait for its searching and listing available WLAN hotspots;
 - Click WLAN to be connected. If an encrypted network is selected, you are required to enter access password to get connected.
- 3 LAN setting

How to download/use App

This smart counter scale is applicable for the weighing cashier environment of various business formats such as upscale department store, convenience store, fruit shop, delicatessen, snack food store,, etc. You may open the App Store under the networking mode. Browse & download the App and complete the installation.

Scale Sealing

When the scale is used in trade or a legally controlled application, it must be set up, verified and sealed in accordance with local weights and measures regulations. It is the responsibility of the owner or the operator to ensure that all pertinent legal requirements are met. As verification requirements vary by jurisdiction, the owner or the operator should contact their local weights and measures office if they are not familiar with the requirements.

To prevent access to calibration and metrological settings, please check the scale is well sealed by the wire seal.

Please read the built-in help App for more usage guide

Overview of Smart Counter Scale

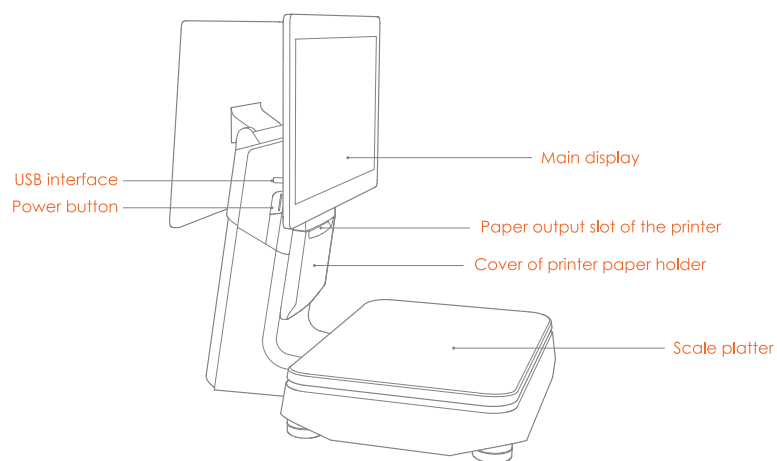

Power button

Short press to power on the scale.
Long press for 2-3 seconds to shut down or reboot the scale when in working status.
Long press for 11 seconds to power off the scale.

USB interface

Applied to connect with the external keyboard, mouse or U disk.

Paper exit of the printer

Applied to print receipts paper output slot of the printer.

Main display

Applied with the touch screen for operator.

Scale platter

Applied to place the weighing goods.

The cover for hidden cables

Open the cover, and applied to connect with external devices.

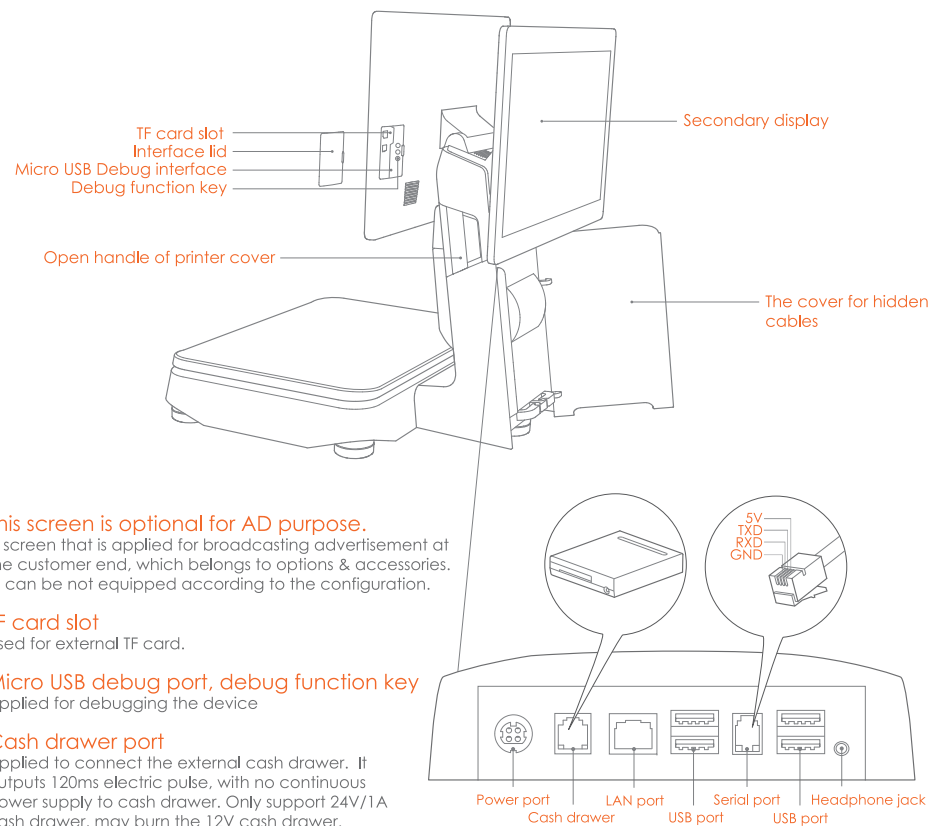

This screen is optional for AD purpose.

A screen that is applied for broadcasting advertisement at the customer end, which belongs to options & accessories. It can be not equipped according to the configuration.

TF card slot

Used for external TF card.

Micro USB debug port, debug function key

Applied for debugging the device

Cash drawer port

Applied to connect the external cash drawer. It outputs 120ms electric pulse, with no continuous power supply to cash drawer. Only support 24V/1A cash drawer, may burn the 12V cash drawer.

Installation on Printer Paper Roll

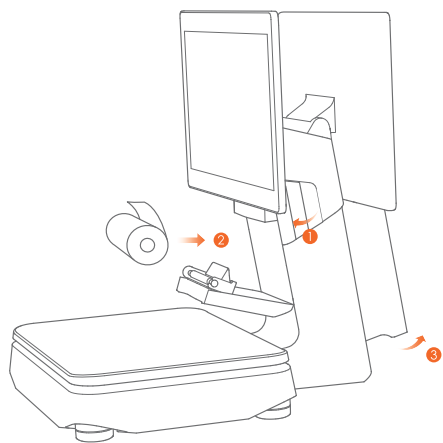

1 Open the cover of paper roll holder

Pull outward the printer handle, and the paper bin cover will automatically eject.

2 Install the print paper

Place the 80mm thermal paper roll, and pull several inch paper out of the paper output slot, then close the cover.

3 Connect the power

Connect the power interface of the adapter to the power port at the bottom of the host, and then connect with AC power.

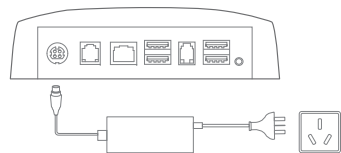

Wrong Operation on the Print Paper

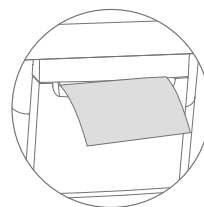

Please pay attention that the print paper is not obliquely placed.

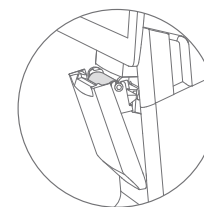

The print paper may roll back, that cause no paper being fixed on the paper output slot.

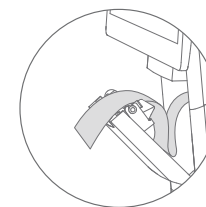

Please don't put the extra long paper directly back to the paper roll holder.

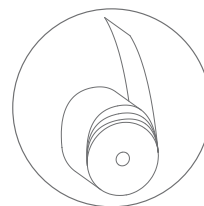

Please don't place the loose paper roll into the paper roll holder.

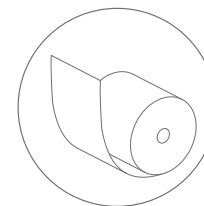

Please pay attention to load the print paper roll in the correct direction.

Common Troubleshooting

Symptoms	Solution
When there is a crash	Long press the power button for 11 seconds, to power off the device, then short press to boot up.
The printer doesn't work	<ul style="list-style-type: none"> · Confirm that the cover of paper roll holder; · Confirm whether paper jam fault has occurred or not.
The printing content is blank	<ul style="list-style-type: none"> · Please check whether the paper roll has been reversed or not; · Please check whether 80mm thermal print paper roll has been used or not.
The printing content is vague	<ul style="list-style-type: none"> · Please check whether the thermal head piece is dirty or not. If it is dirty, please wipe it with cotton swab dipped by absolute alcohol; · Please change the thermal paper with quality assurance to avoid the vague printing caused by paper quality.
Inaccurate weighing	<ul style="list-style-type: none"> · Please remove the scale platter, and check whether the bubble is in the middle position or not; · Check whether the five scale feet are firmly contacted to the table or not; · Check whether there are sundries in the place of the X shape bracket to cause inaccurate weighing.

Specifications of Smart Counter Scale

Operating system	Android 7.1
Processor	Snapdragon 8 core
Display	15.6 inch Resolution 1920 x 1080
Storage	16GB ROM+ 2GB RAM
Touch screen	Multipoint capacitive touch screen
WIFI	802.11 a/b/g/n(2.4Ghz/5Ghz)
Bluetooth	Bluetooth 4.0 BLE and iBeacon
Printer	80mm, with cutter
Speaker	3W
External Interfaces	5x USB typeA, 1x RJ11 serial, 1x RJ12 24V cash drawer, 1x RJ45 LAN, 1xheadphone, 1x power, 1x Micro-USB debug
External storage card	Support MicroSD(TF), up to 64G
Whole machine size	50.9cm x 41cm x 45.2cm
Power adapter	Output power 60W, input: AC100~240V/1.7A□output:DC24V/2.5A
Range	Max=6/15 kg
Division value	e=d= 2/5 g
Accuracy grade	III
Weight	14.8 kg
Operating temperature	-10 C ~ +40 C
Storage temperature	-10 C ~ +50 C
Humidity	Relative humidity≤85%, non-condensing
Limited altitude	below 5000 meters

15.6 inch secondary screen specifications

Display	15.6 inch Resolution 1920 x 1080
Touch screen	Multipoint capacitive touch screen

10.1 inch secondary screen specifications

Display	10.1 inch Resolution 1024 x 600
---------	---------------------------------

Name & Content Identification Table of This Product's Toxic & Harmful Substance

Component name	Toxic & harmful substance or elements					
	(Pb)	(Hg)	(Cd)	(Cr(VI))	(PBB)	(PBDE)
Circuit board assembly	×	○	○	○	○	○
Printing head assembly	×	○	○	○	○	○

○ indicates that the contents of toxic & harmful substance in all the homogeneous materials of this component are all under the limitation requirement specified by SJ/T11363-2006.

× indicates that the content of this toxic & harmful substance in at least one homogeneous material of this component exceeds the limitation requirement specified by SJ/T11363-2006; yet, as for the component marked by "x" in the above table, the exceedance of its content is because there has not been proven alternative technology in the current industry.

As for the products reaching or exceeding the environment-friendly use period, please carry out the recycling & reusing according to "The Control & Management Method for the Electronic Information Product", and not to discard them carelessly.

Package Contents

- 1 x host, 1x scale body
- User guide
- 1 x power adapter
- 1 set of installation tool
- _____

Points for Attention

Safety warning

- Please plug the AC plug into the AC socket corresponding to the identification input on the power adapter of the accessory;
- It is strictly forbidden to use it at a site with the existence of any potential explosive gas;
- Non-professionals are not allowed to tear down the power adapter to avoid dangers;
- This is a A grade product. In the living environment, this product may cause radio interference. In this case, the user maybe required to apply feasible measures against the interference.

Important Safety Instructions

- Avoid it to be installed or used during the thunder & lightning period, otherwise there will be risk of being electrically shocked by it;
- When you have discovered unusual odor, overheat or smog, please cut off the power supply at once!
- The paper knife is relatively sharp, please don't touch it!
- Avoid to use it in a humid environment; avoid to use it at a site that is dusty or easy to burn & explode;
- As for the host, it must be ensured that the grounding of the socket power system comply with the relevant standards, otherwise it may cause personal injury;
- After unpacking and installing the device, please first adjust four scale feet to make the bubble in the spirit level at the metal base to be in the center of the spirit level, and adjust the adjusting nut at the scale feet to be against the bottom of the scale body base to fix it.

Suggestions

- Do not use it near water or in humid environment to avoid fluid to fall into the terminal;
- Do not use it in extreme cold or hot environment. For example: near the ignition source or lighted cigarette;
- Do not drop, throw or bend it;
- Try best to use it in clean and dust-free environment, to prevent small items from dropping into the terminal;
- Do not use it nearby the medical devices when not allowed.

Statement

Our company will not be responsible for the results of the following actions

- Damage caused by usage & maintenance not under the conditions of this guidance note;
- Our company will not be responsible for any damage or problem caused by any option or consumable (not the initial product or recognized product provided by our company). (You have no right to make product modifications or changes without the consent of our company)

EU Regulatory Conformance

Hereby, Shanghai Sunmi Technology Co., Ltd. declares that the radio equipment type is in compliance with Directive 2014/53/EU.

The full text of the EU declaration of conformity is available at the following internet address: www.sunmi.com

Notice: The device complies with RF specifications when the device used at least 20cm from human body.



FCC Regulations:

This device complies with part 15 of the FCC Rules. Operation is subject to the following two conditions:

(1) This device may not cause harmful interference, and (2) this device must accept any interference received, including interference that may cause undesired operation.

This device has been tested and found to comply with the limits for a Class B digital device, pursuant to Part 15 of the FCC Rules. These limits are designed to provide reasonable protection against harmful interference in a residential installation. This equipment generates, uses and can radiate radio frequency energy and, if not installed and used in accordance with the instructions, may cause harmful interference to radio communications. However, there is no guarantee that interference will not occur in a particular installation. If this equipment does cause harmful interference to radio or television reception, which can be determined by turning the equipment off and on, the user is encouraged to try to correct the interference by one or more of the following measures:

- Reorient or relocate the receiving antenna.
- Increase the separation between the equipment and receiver.
- Connect the equipment into an outlet on a circuit different from that to which the receiver is connected.
- Consult the dealer or an experienced radio/TV technician for help.

Caution: Changes or modifications not expressly approved by the party responsible for compliance could void the user's authority to operate the equipment. This equipment must be installed and operated in accordance with provided instructions and the antenna(s) used for this transmitter must be installed to provide a separation distance of at least 20 cm from all persons and must not be co-located or operating in conjunction with any other antenna or transmitter. End-users and installers must be provided with antenna installation instructions and transmitter operating conditions for satisfying RF exposure compliance.

⊕	Operation Frequency⊕	Transmitted⊕
BT/BLE⊕	2402MHz-2480MHz⊕	2.5 ± 1.5 dBm⊕
Wi-Fi 802.11b⊕	2412MHz-2462MHz⊕	16.5 ± 1.5 dBm⊕
Wi-Fi 802.11g⊕	2412MHz-2462MHz⊕	14.5 ± 1.5 dBm⊕
Wi-Fi 802.11n⊕	2412MHz-2462MHz⊕	12.5 ± 1.5 dBm⊕
5G Wi-Fi⊕	5150MHz-5825MHz⊕	13.5 ± 1.5 dBm⊕

Metrological information

Important notice for verified weighing instruments in EU countries



Weighing instruments, for which conformity is declared (legal verification), bear the preceding mark on the packing label ...



Weighing instruments on which the declaration of conformity is carried out as below have no metrology marking on the descriptive plate and bear the preceding identification mark on the packing label.

The Declaration of Conformity has been carried out at the manufacturing factory, and comprises all tests according to EN 45501-8.3.3. If national regulations in individual countries have period limitation of validity of the verification, the customers of such a weighing instrument are themselves responsible for the timely reverification.

Disposal

In accordance with the requirements of European Directive 2002/96/EC on Waste Electrical and Electronic Equipment (WEEE), this device may not be disposed of with domestic refuse. This also applies for countries outside the EU in accordance with their respective national regulations.

— Please dispose of this product in accordance with local regulations for the separate collection of waste electrical and electronic equipment.

Should you have any questions, please contact the corresponding authorities or the dealer from whom this device was purchased.

If this device is passed on (for example for further private or commercial/industrial use), this regulation is also to be passed on.

Many thanks for your contribution to the protection of the environment.

Disclaimer

Due to the product update, certain details of this document may be inconsistent with the product.

Please refer to the real subject. Our company owns the interpretative right of this document.

We reserve the right to modify this user guide without giving advance notice.