

DOWELLIN TOYS FACTORY

X6C

GYROSCOPE 2.4G/5.8G

EXPLORERS

4CH 2.4G/5.8G REMOTE CONTROL QUADCOPTER

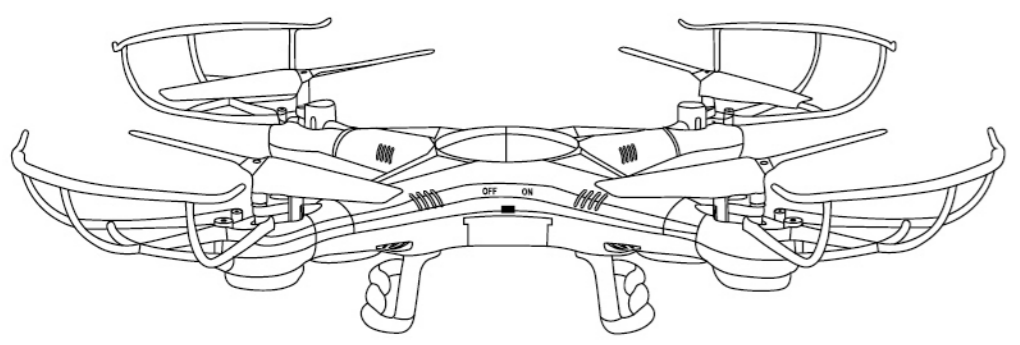

RC Drone Helicopter

1 INSTRUCTION MANUAL

IMPLEMENT STANDARD: GB/T26701-2001

Key features of quadcopter

- Four-axis structure makes the quadcopter more flexible and rapid when flying. It is wind-resistant and can be flown indoor or outdoor.
- Built-in 6 axis gyroscope for precise hovering in the sky.
- Simple modular design makes changing parts easy.
- With 360° 3D eversion and throwing flight function.

The materials and specification mentioned in this instruction manual or the parts inside the package are for reference only.

PREFACE

Dear Customers:

Thank you for purchasing our flying model. Please read this instruction manual carefully in order to master the skill more quickly and operate this product more safely. In the mean time, please well keep the original of this instruction manual for future reference.

IMPORTANT INSTRUCTION

- This product is not a toy but a precise equipment that integrating mechanics and electronics with expertise of aerodynamics and high-frequency transmitting. It requires to be correctly assembled and debugged so as to prevent the accident from being happened. The product owner should operate or control it in safe way. Please noted that we won't take any responsibility for any wrong operation as this may result in severe injury or loss of property and we can not control the operating process during the time when the time user assemble or use this product.
- This product is suitable to be used by people who has operating experience in flying model or age no less than that 6 years old.
- The flying ground we required should be the local field and legal for remote control flying.
- Once this product is sold, we won't be responsible for any safety responsibility. During the time the user operates or uses or controls this product.
- If there is any product occurred during the time of using, operating or repairing, please reach our sales agent for details. The sales agent that we authorized will provide you with the technical support and after-sale service.

SAFETY & CAUTIONS

This R/C flying model is a high dangerous commodity. Please make sure that it should be files far away from the crowd. Please also pay more attention to the phenomenon such as incorrect assembly or damaged model or incorrect connection of electronic control equipment. Please also pay attention to the flying safety when operating and know more about the accident that may be happened due to your own negligence.

- Keep it far away from the barrier or crowd.
- Keep it far away from the moisten environment.
- Use this product correctly and avoid operation by your own.
- Keep it far away from the high-speed rotating part and heat source.
- Please conform to the sequence of power ON/OFF. As the picture below shown, incorrect sequence of power ON/OFF may cause this product out of control and affect your own safety or others. Please form a good habit of switching on or switching off this product correctly.

CONTENTS

- Quadcopter
- USB Charging Cable
- Transmitter
- Screwdriver
- Main blades
- Instruction manual
- Screw 4PCS

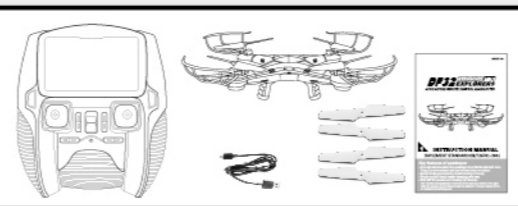

GET TO KNOW YOUR TRANSMITTER

Introduction of transmitter

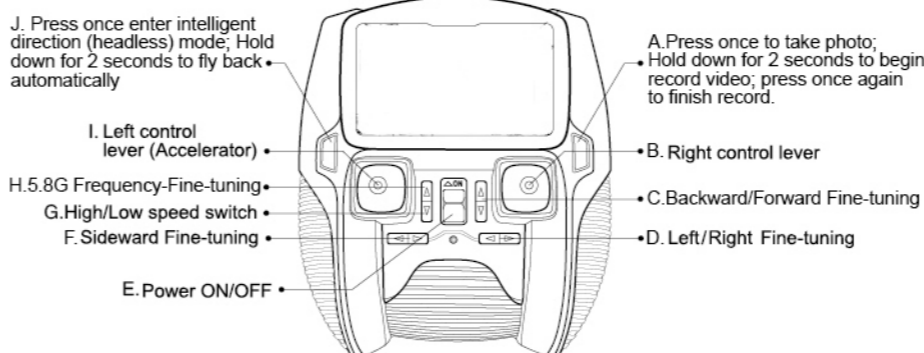

Remote control Installing the battery

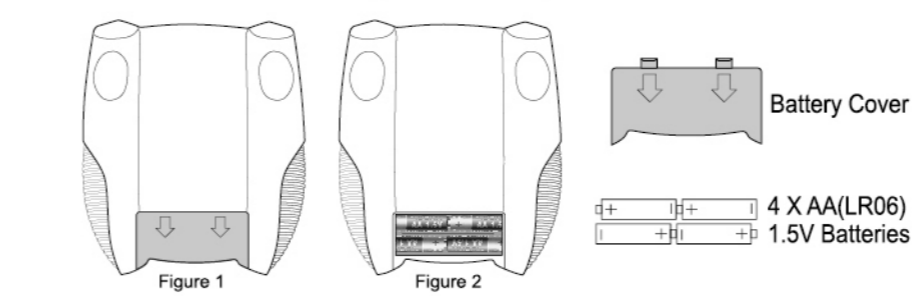

- Use a screwdriver to remove the screw on the back of transmitter, then open the battery cover (Figure 1).
- Install 4 "AA" batteries (not included) into the back of transmitter than replace battery cover and reinstall the screw (Figure 2).

1. Install batteries with correct polarity.
2. Do not mix old and new batteries.
- Do not mix different types of batteries.

FCC

Caution: The user is cautioned that changes or modifications not expressly approved by the party responsible for compliance could void the user's authority to operate the equipment.

This device complies with Part 15 of the FCC Rules. Operation is subject to the following two conditions: (1) this device may not cause harmful interference, and (2) this device must accept any interference received, including interference that may cause undesired operation.

NOTE: This equipment has been tested and found to comply with the limits for a Class B digital device, pursuant to Part 15 of the FCC Rules. These limits are designed to provide reasonable protection against harmful interference in a residential installation. This equipment generates, uses and can radiate radio frequency energy and, if not installed and used in accordance with the instructions, may cause harmful interference to radio communications. However, there is no guarantee that interference will not occur in a particular installation.

If this equipment does cause harmful interference to radio or television reception, which can be determined by turning the equipment off and on, the user is encouraged to try to correct the interference by one or more of the following measures:

- Reorient or relocate the receiving antenna.
- Increase the separation between the equipment and receiver.
- Connect the equipment into an outlet on a circuit different from that to which the receiver is connected.
- Consult the dealer or an experienced radio/TV technician for help.

FCC Radiation Exposure Statement:

This equipment complies with FCC radiation exposure limits set forth for an uncontrolled environment.

This transmitter must not be co-located or operating in conjunction with any other antenna or transmitter.

CAUTIONS:

- When the indicator of transmitter keep light on but the indicator of quadcopter is blinking slowly, it means signal matching was not successful. Please turn off the power both of transmitter and quadcopter than restart the transmitter and quadcopter.
- If the quadcopter is still flying to on side dramatically or spinning while hovering, please switch off the power of both the quadcopter and transmitter and then repeat the pre-flying steps.
- When the indicator of the quadcopter keeps flashing slowly, it means that the quadcopter has entered into the low battery state. This time you need to charge the quadcopter with the USB cable provided.

REMOTE CONTROL KEYPAD AND LCD MANUAL

- Push the on/off switch of quadcopter to OFF position than open the battery cover.
- Pull out the battery wire from the power port.
- Take out the USB charging cable, and insert the battery power port to the small end of it. (Make sure the ports connect tight and correct).
- To charge battery, please insert the USB port of provided USB charging cable to anyone USB port of computer. The indicator on USB cable will light ON during charging battery, than it will light OFF when battery fully charged. Caution: When using the computer for charging, please remember to pull out the charging cable before shutting down the computer. Take the battery cover, and close the battery cover on the quadcopter.
- Reconnect the battery wire to power port than close the battery cover.

Charging time: about 75 minutes; Flying time: about 6-8 minutes!

CAUTIONS WHEN CHARGING

- When charging, please put this product on a dried or ventilated area and keep it far away from heat source or explosive product.
- When charging, please remove the batteries from the quadcopter. Then charging process should be supervised by an adult so as not to cause an accident.
- After flying, please do not charge the battery if the surface temperature is still not cool. Otherwise it may cause a swollen battery or even a fire hazard.
- Please make sure that you use the original USB charging cable provided. When the battery has been used for a long time, or appears to be swollen, please replace them.
- A battery when not in use for a long time will lose its charge automatically. Charging or discharging too often may reduce the life of the battery.

CAUTIONS WHEN CHARGING

- Battery should be put in the dried or ventilated place with environment temperature about 18-25°C.
- In order to enhance the using life of the battery, please avoid repeat charging or excessive discharging.
- When the battery needs to be stored for a long time, please charge the battery first. That is to say, charge the battery for about 50-60% of the volume and then well store it.
- If you do not use it for more than 1 months, it's highly recommended that you need to check the battery voltage every month so as to make sure the voltage no less than 3V. Otherwise please do by following No.(3) mentioned.

INSTALL LANDING SKIDS & BLADE PROTECTING FRAME

- Install the landing skids to the bottom of quadcopter (Figure 1).
- Install the blade protecting frame to every corner than lock screws (Figure 2).

OPERATING DIRECTION

- Hover up and down**
- Push the throttle up or down, the quadcopter flies upward or downward.
- Forward and backward**
- Push the direction lever up or down, the quadcopter flies forward or backward.

Turn Left and Right

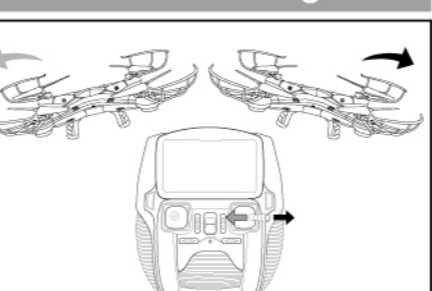

Pull the throttle left or right, the quadcopter turns to left or right.

Sideward fly

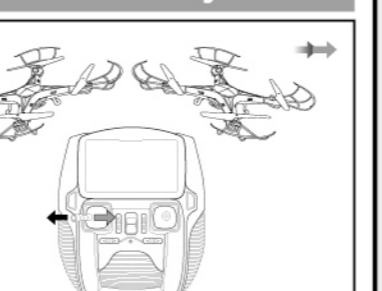

Pull the direction lever left or right, the quadcopter flies to left side or right side.

Fine-tuning operation

- Forward/Backward fine-tuning**
- When the quadcopter keeps flying forward/backward, you can correct it by pressing the fine-tuning button down/up.
- Turn left/right fine-tuning**
- When the quadcopter keeps flying to left/right side, you can correct it by pressing the fine-tuning button right/left.
- Sideward fly fine-tuning**
- When the quadcopter keeps rotating to left/right, you can correct it by pressing the fine-tuning button right/left.

INTRODUCTION TO QUADCOPTER FUNCTIONS

Low-voltage protection:

When the quadcopter battery is not enough, the rotors will be stopped power supply. As the quadcopter control system will protect battery automatically.

Over-current protection:

When the quadcopter's rotating blade is collided or jammed, the control system will stop supplying power for the rotors automatically. Then please re-match the signal for flying.

Restart function:

In case of flight disorder or sideward flight, restore factory default settings by the following methods:

Thanks to the 6 axis gyroscope, you can throw the quadcopter and push the throttle right up, it will automatically level out and hover smoothly in the sky. This can also be done when the quadcopter is rolling.



INSTALL CAMERA

- Push the camera into a hold on the battery cover (Figure 1).
- Open the battery cover with camera (Figure 2).
- Lock screws to add-on the camera tight (Figure 3).
- Close the battery cover with camera than insert the 3-pin plug to the hold in side (Figure 4).

PHOTOGRAPHY/VIDEO INSTRUCTIONS:

- Methods:
 - Make sure the 3-pin plug of camera is inserted to the quadcopter.
 - Turn the quadcopter power on, the camera works normally when the RED indicator change form flashing to green and keep light on. If the RED indicator just light on and light off seconds later, it means the SD card is not in the camera. Please insert the SD card, than the indicator light on GREEN.

- Get to know take photo and video:
 - Press once to take photo; Hold down for 2 seconds to begin record video; press once again to finish record.

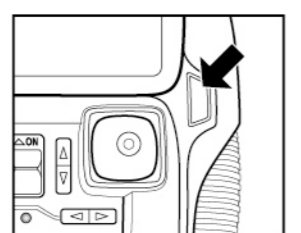

TROUBLE SHOOTING

Problem	Reason	Solution
No response from the quadcopter	1. Quadcopter battery power not enough. 2. Transmitter battery power not enough. 3. The band of the transmitter does not correspond to the decoding of the quadcopter.	1. Charge the quadcopter. 2. Charge or replace them if required. 3. Adjust the band on the transmitter and keep it the same as the quadcopter.
If the quadcopter is slow to respond or difficult to maneuver	1. Insufficient power with the transmitter. 2. Transmitter or the same frequency is used nearby	1. Replace the battery. 2. Use the helicopter out of the range of other RC quadcopter.

BREAKDOWN & DIAGRAM

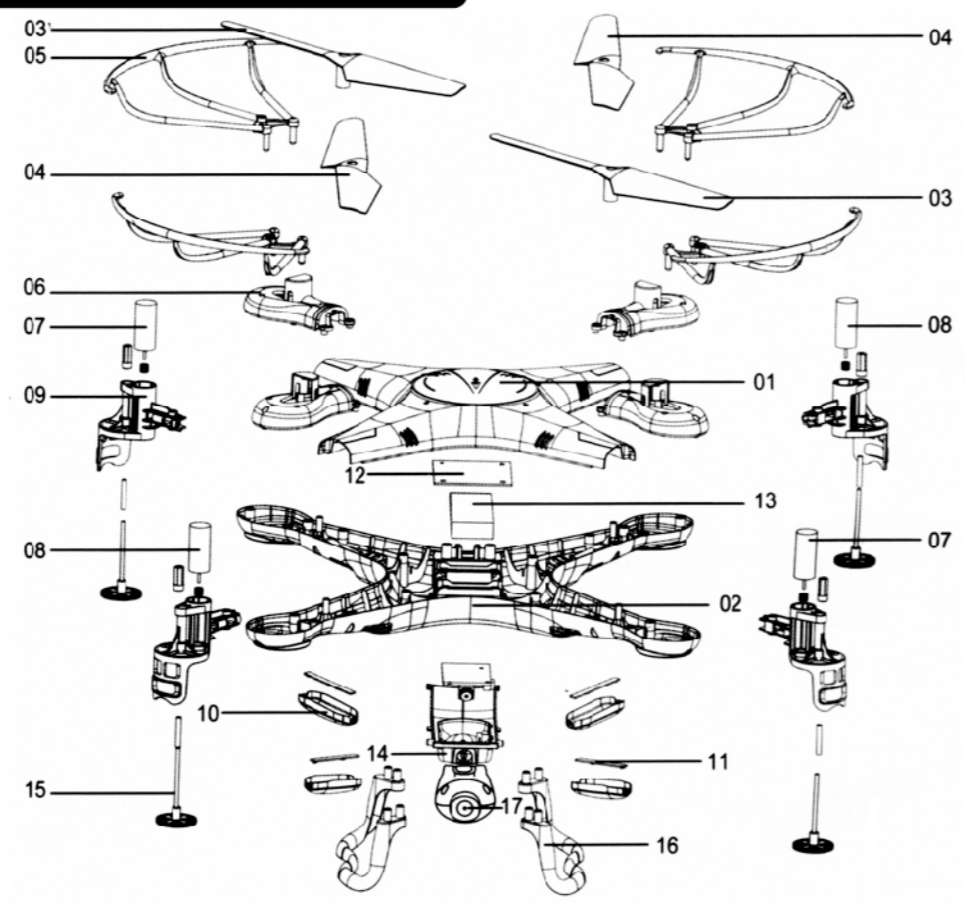

BREAKDOWN & DIAGRAM

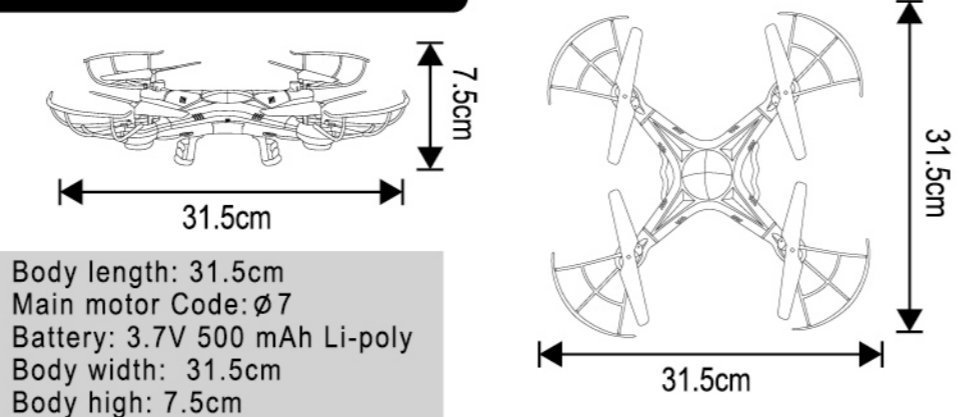

SPARE PARTS

All the spare parts below can bought from local distributor.

DF32-01 Body cover	DF32-02 Main blades	DF32-03 Protecting frames	DF32-04 Landing skids
DF32-05 Motorholder	DF32-06 Lampshades	DF32-07 Motor A	DF32-08 Motor B
DF32-09 Light boards	DF32-10 Receiver board	DF32-11 Battery	DF32-12 USB charging cable
DF32-13 Camera	DF32-14 Transmitter	DF32-15 Memory card	DF32-16 Card reader

4 TYPES OF CONFIGURATIONS

Code	Description	Quantity	Code	Description	Quantity	Code	Description	Quantity
01	Upper body	1	08	Receiver motor	2	15	Gear	4
02	Lower body	1	09	Motor holder	4	16	Landing skids	2
03	Rotating blade	2	10	Lampshades	4			
04	Reversing blade	2	11	Light boards	4			
05	Protecting frames	4	12	Receiverboard	1			
06	Battery cover	4	13	Battery	1			
07	Rotating motor	2	14	Battery cover	1			

Code	Description	Quantity	Code	Description	Quantity	Code	Description	Quantity
01	Upper body	1	08	Receiver motor	2	15	Gear	4
02	Lower body	1	09	Motor holder	4	16	Landing skids	2
03	Rotating blade	2	10	Lampshades	4			
04	Reversing blade	2	11	Light boards	4			
05	Protecting frames	4	12	Receiverboard	1			
06	Battery cover	4	13	Battery	1			
07	Rotating motor	2	14	Battery cover	1			

Code	Description	Quantity	Code	Description	Quantity	Code	Description	Quantity
01	Upper body	1	08	Receiver motor	2	15	Gear	4
02	Lower body	1	09	Motor holder	4	16	Landing skids	2
03	Rotating blade	2	10	Lampshades	4			
04	Reversing blade	2	11	Light boards	4			
05	Protecting frames	4	12	Receiverboard	1			
06	Battery cover	4	13	Battery	1			
07	Rotating motor	2	14	Battery cover	1			

Code	Description	Quantity	Code	Description	Quantity	Code	Description	Quantity
01	Upper body	1	08	Receiver motor	2	15	Gear	4
02	Lower body	1	09	Motor holder	4	16	Landing skids	2
03	Rotating blade	2	10	Lampshades	4			
04	Reversing blade	2	11	Light boards	4			
05	Protecting frames	4	12	Receiverboard	1			
06	Battery cover	4	13	Battery	1			
07	Rotating motor	2	14	Battery cover	1			

SPECIFICATIONS AND COLORS OF CONTENTS MAY VARY FROM PHOTO.