

SAMCOM

MADE IN FAITH



NP-580

***4G LTE Network
Portable Radio***

User Guide

INTRODUCTION

Thank you for purchasing our products. Combined the latest technology along with a sturdy mechanical frame, our radios provide cost-effective communications for the people who need to stay in touch with the working team such as retail stores, restaurants, campuses and schools, construction sites, manufacturing, shows and trade fairs, property and hotel management and more, they are the perfect communication solutions for all of today's fast-paced industries.

We sincerely appreciate your interest on our products, and strongly suggest you to read the instruction carefully. Your comment will be highly valued. Please read through the manual in order to get familiar with the device and learn the features of this model.

FCC Statement

Any Changes or modifications not expressly approved by the party responsible for compliance could void the user's authority to operate the equipment.

This device complies with part 15 of the FCC Rules. Operation is subject to the following two conditions:

- (1) This device may not cause harmful interference, and
- (2) This device must accept any interference received, including interference that may cause undesired operation.

RF Exposure Information (SAR):

This device meets the government's requirements for exposure to radio waves. This device is designed and manufactured not to exceed the emission limits for exposure to radio frequency (RF) energy set by the Federal Communications Commission of the U.S. Government.

The exposure standard for wireless devices employs a unit of measurement known as the Specific Absorption Rate, or SAR. The SAR limit set by the FCC is 1.6 W/kg. *Tests for SAR are conducted using standard operating positions accepted by the FCC with the device transmitting at its highest certified power level in all tested frequency bands.

Although the SAR is determined at the highest certified power level, the actual SAR level of the device while operating can be well below the maximum value. This is because the device is designed to operate at multiple power levels so as to use only the power required to reach the network. In general, the closer you are to a wireless base station antenna, the lower the power output.

The highest SAR value for the device as reported to the FCC when tested for face up is 0.30W/kg and when worn on the body, as described in this user guide, is 0.57W/kg (Body worn measurements differ among devices, depending upon available enhancements and FCC requirements.) While there may be differences between the SAR levels of various devices and at various positions, they all meet the government requirement. The FCC has granted an Equipment Authorization for this device with all reported SAR levels evaluated as in compliance with the FCC RF exposure guidelines. SAR information on this device is on file with the FCC and can be found under the Display Grant section of <http://www.fcc.gov/oet/fccid> after searching on FCC ID: 2AGPQ-POC580S.

The device was test for typical body-worn operations and head face up operations . keep the product at least 25mm from the face.when worn on body must use correct back clip for this product. Use of non-approved accessories may result in exposure levels which exceed the FCC's uncontrolled environmental RF exposure limits.

Main Features

- IP55 rating splash & dust protection
- Rugged and heavy-duty design
- Crystal, clear and loud audio
- 4200mAh high capacity Li-ion battery pack
- 1.77 TFT LCD with 128 x 128 pixels and 65 colors
- Compatible with 4G/3G networks
- Dual working mode:
 - Two-way calling mode & phone calling mode
- Group calls & private calls & dynamic groups
- Voice recording
- Dispatcher
- Text messages
- Radio stun function
- Panic/Emergency alarm button
- Lone worker mode
- Inbuilt VOX for hands-free communication
- Low battery alert
- OTA updates
- PC programmable

CONTENTS

01 Chapter 1: SAFETY INFORMATION

01 Radio Care

02 Battery Care

04 Chapter 2: RADIO OVERVIEW

04 Package Includes

04 At a Glance

07 Chapter 3: GETTING STARTED

07 Install and Remove Battery Pack

08 Install and Remove Antenna

08 Install and Remove Belt Clip

09 Charging the Battery Pack

10 Chapter 4: BASIC OPERATION

10 Turn the Radio ON/OFF

10 Adjusting Volume

10 Selecting a Group

10 Receiving a Call and Talking

11 Programming

11 LED Indicators

11 Chapter 5: ADVANCED OPERATION

11 Backlight

11 Brightness

11 Network

11 PTT Alert

12 Voice Quality

12 Time Zone

12 Emergency Alarm

12 Lone Worker

12 VOX

12 Keypad Beep

12 Key Lock-out

13 Phone Call function

14 Chapter 6: SPECIFICATIONS

15 Chapter 7: WARRANTY INFORMATION

SAFETY INFORMATION

Please read this information before using your radio. Failure to do so could result in personal injury, death, and/or damage to your radio, accessories and/or other property.

Radio Care

Advice

- Do not use options or accessories not specified.
- Ensure that the radio is used within the parameters for which it was designed.
- Turn the radio OFF before connecting optional accessories.

Warning

Turn the radio OFF in the following locations:

- In explosive atmospheres (flammable gas, dust including metallic & grain powders etc).
- Whilst taking on fuel or while parked near a fuel station.
- Near explosives or blasting sites.
- In aircraft, medical institutions or near persons known to be wearing a pacemaker.

Caution

- Do not disassemble or modify the radio for any reason.
- Do not transmit while touching the antenna terminal or any exposed metallic parts of the aerial as this may result in burn.
- Please check and observe regulation in your country with regards to use whilst driving.

End of Life Disposal

- When your radio reaches the end of its useful life, please ensure that the unit is disposed of in an environmentally friendly way.

Battery Care

Precautions

- Turn the radio OFF before charging.
- Charge the battery pack before use.
- Do not recharge the battery pack if it is already fully charged as this will use one its charge cycles and may shorten its life.
- Charge the battery in accordance with the instructions enclosed with your charger.
- Do not charge the radio and/or battery pack if they are wet.

The battery pack includes potentially hazardous components. Please:

- Do not disassemble or reconstruct battery.
- Do not short-circuit the battery.
- Do not incinerate or apply heat to the battery.
- Do not immerse the battery in water or get it wet by other means.
- Do not charge the battery near fires or under direct sunlight.
- Use only the specified charger and observe charging requirements.
- Do not pierce the battery with any object or strike it with an instrument.
- Do not use the battery pack if it is damaged in any way.
- Do not reverse-charge or reverse-connect the battery.
- Do not touch a ruptured or leaking battery.

If liquids from the battery get on your skin or into your eyes, immediately:

- Wash your eyes out with fresh water avoiding rubbing them.
- Seek medical treatment.

Notes:

- If a battery is not to be used for an extended period of time (several months) remove the battery pack from the equipment and store in a cool and dry location part charged. Do not fully discharge the battery before storage.

- Each charge cycle reduces the battery's life. Minimize the number of times you charge your battery especially in hotter environments which further shorten a battery's life.

RADIO OVERVIEW

Package Includes

1pcs radio
1pcs rubber antenna
1pcs rechargeable Lithium-ion battery pack
1pcs AC adapter & desktop charger kit
1pcs belt clip
1pcs user's manual

At a Glance

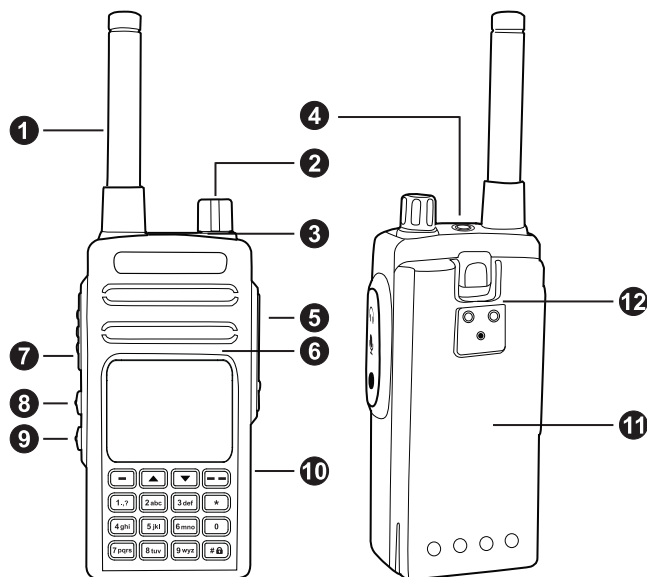

1 – Antenna

Provide attached full frequency range rubber flexible antenna.

Note: It may cause the performance changed to your radio if the antenna is connected inappropriately.

2 — On/Off/Volume Knob

Turn the radio ON or OFF and to adjust the radio's volume.

3 – LED Indicator

Green LED quickly flashing means searching for network and logging on.

Green LED slowly flashing means logged on to the network.

Green LED permanent means receiving.

Red LED permanent means programming or transmitting.

4 – Panic/Emergency Alarm Button

Long press this button to activate emergency alarm function.

5 – Audio Accessory Jack (Motorola 2 Pin Connector)

Connect compatible audio accessories.

6 – Microphone

Speak clearly into the microphone when transmitting.

7 – PTT (Push-To-Talk) Button

Press and hold down this button to transmit and talk, release it to receive and listen.

8 – Side Button P1

Short press the button P1 is to broadcast the current working group name and user account.

9 – Side Button P2

Short press the button P2 is to broadcast the current battery capacity volume and signal strength.

10 – LCD Display & Alphanumeric Keypad

The radio is with a 1.77 inch TFT, 65K colors and 160x128 pixels LCD display. You will see the network operators, working group, user account and various icons which stand for the corresponding functions. And you can program the radio functions via keypad directly.

11 – Lithium-Ion Battery Pack

Radio comes equipped with a rechargeable Lithium-ion battery pack. This battery should be fully charged before initial use to ensure optimum capacity and performance. Batteries are designed specifically to be used with a supplied charger and vice versa.

12 – Battery Latch

Push down battery latch to release battery pack.

GETTING STARTED

Install and Remove Battery Pack

Installing Battery (Figure 1)

1. Turn the radio OFF.
2. With the top side up on the battery pack, fit the tabs at the bottom of the battery into the slots at the bottom of the radio's body.
3. Press the top part of the battery towards the radio until a click is heard.

Removing Battery (Figure 2)

1. Turn the radio OFF.
2. Push down the battery latch and hold it while removing the battery.
3. Pull the battery away from the radio.

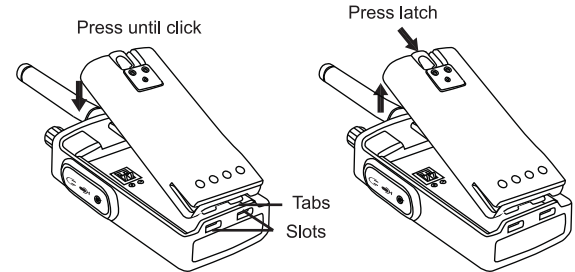

Figure 1

Figure 2

Install and Remove Antenna

Installing Antenna (Figure 3)

Screw the antenna into the connector at the top of the radio by holding the bottom of the antenna, and turning it clock-wise until secure.

Removing Antenna (Figure 4)

Rotate the antenna counter clockwise by holding the bottom of antenna.

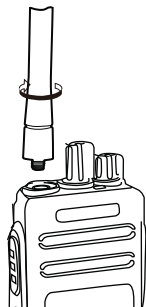

Figure 3

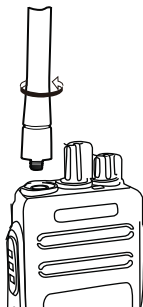

Figure 4

Install and Remove Belt Clip

Installing Belt Clip (Figure 5)

Align the screw eyelets of the belt clip with those on rear of radio and fasten the belt clip with enclosed screws.

Removing Belt Clip (Figure 6)

Loosen the screws to remove the belt clip.

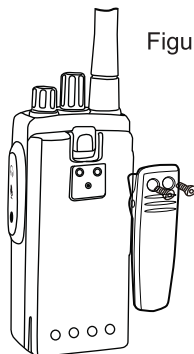

Figure 5



Figure 6

Charging the Battery Pack

The radio is equipped with 1pcs AC adapter and 1pcs desktop charger.

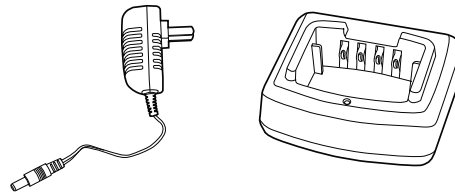

To charge the battery pack, place it in the supplied desktop charger.

1. Place the desktop charger on a flat surface.
2. Insert the connector of the AC adapter into the charger port on the back of the desktop charger.
3. Plug the AC adaptor into a power outlet.
4. The charger is ready for charging if the indicator LED lights red for one second and turns off. If the indicator LED is flashing, the charger is not ready.
5. Place the battery into the charger aligning the battery slots with the charger guide rails.
6. The indicator LED lights red when charging. If the battery capacity is too low, the indicator LED flashes red. The battery first trickle charges and turns to normal charging automatically.
7. The battery is fully charged when the battery LED light is green. The charger stops charging automatically.

Notes:

- when you charge a battery attached to the radio, turn the radio OFF to ensure a full charge.
- the estimated charging time of the battery with charger is about 5 hours.

BASIC OPERATION

Turn the Radio ON/OFF

To turn on the radio, rotate on the On/Off/Volume Knob clockwise. The radio plays power up audio and channel number. To turn off the radio, rotate the On/Off/Volume Knob counterclockwise until you hear a 'Click' sound.

Adjusting Volume

Turn the On/Off/Volume Knob clockwise to increase the volume, or counterclockwise to decrease the volume.
Note: Do not hold the radio too close to the ear when the volume is high or when adjusting the volume.

Selecting a Group

- To select a group:
1. Press [−] key to enter menu mode.
 2. Press [−] key again to enter group item, press [▲] or [▼] key to choose the target group and press [−] key again to confirm and return to the previous menu.

Receiving a Call and Talking

1. After you select the desired group, an audible voice prompts the group name.
2. Make sure the PTT button is released and listen for voice activity.
3. The LED indicator stays solid green when the radio is receiving a call.
4. To respond, hold the radio vertically 1 to 2 inches (2.5 to 5 cm) from mouth. Press the PTT button to talk; release it to listen.
5. When transmitting, the LED indicator stays solid red.

Programming

Press and hold the **PTT** button, then turn on the radio. It will enter the programming mode, and you can read/write the data with programming software.

LED Indicators

Radio Working Status and LED Indicators

Radio Status	LED Indicator
Searching the network	Green Blinks
Logged on the network	Green Heartbeat
Transmit (TX)	Solid Red
Receive (RX)	Solid Green
PC programming mode	Solid Red

Advanced Operation

Backlight

This feature allows you to set the brightness time of the LCD display.

Brightness

This feature allows you to set the brightness of the LCD display.

Network

This feature allows you to set which network the radio will use.

PTT Alert

This feature allows you to transmit to other radios in your group with a special tone by alerting them that you are about to talk or you have finished the talk.

Voice Quality

This feature allows you to select between standard and enhanced voice quality.

Time Zone

This feature allows you to set the right time zone for corresponding region to keep the same time.

Emergency Alarm

For hazardous / hostile duty environments, press the top panic button to transmit an alert to the same group user for emergency use.

Lone Worker

This ingenious feature provides an extra layer of security for individuals who work in remote or hazardous areas. If there is a long lapse (programmable), it will sound an alert and place an emergency call to the same group user.

VOX

The VOX feature enables hands free conversations without using PTT, just speak in the direction of the microphone and the communication will be automatically activated. The VOX sensitivity can be adjusted in 8 different levels.

Keypad Beep

A keypad beeper provides useful audible feed back whenever a keypad is pressed.

Key Lock-out

In order to prevent accidental change, the radio keypad and two side buttons can be locked out. You can long press the [#] button to activate the key lock. To release, long press the [#] button again.

Phone Call Function

The radio can make and receive phone calls. Long press [—] button to activate phone call, the icon will display on the top. You can directly input the target phone number via keypad, then press [—] button to call.

SPECIFICATIONS

General

Dimensions (H*W*D)	115*55*35mm
Weight	260 g
Protection Rating	IP55
Operating Voltage	3.3V ~ 4.2V DC
Working Temperature	-20℃ ~ +55℃
Storage Temperature	-30℃ ~ +65℃
Battery	4200mAh

Connectivity

Frequency Band	FDD-LTE: B2/B4/B12 WCDMA: B2/B5
----------------	------------------------------------

Transmit

RF Power	LTE: Level 3 (0.25W) WCDMA: Level 3 (0.25W)
Data Transmission	LTE Cat 4: 150 Mbps (DL) LTE Cat 4: 50 Mbps (UL) UMTS R99: 384 kbps DL/UL HSPA+: 5.76 Mbps (UL), 42 Mbps (DL)

WARRANTY INFORMATION

Warranty Period

Radio Body: 12 months from date of purchase.

Battery Pack: 6 months from date of purchase.

Note: Please retain your receipt as your proof of purchase will be required to valid warranty claim.

Warranty Exclusions

This warranty will not apply in relation to:

- Failure to provide a proof of purchase
- Product has been modified, changed or serial number has been removed
- If any damage is caused by the use of non approved accessories
- Product that has been replaced by an unauthorized person
- Product failure due to customer misuse, abuse or abnormal use
- Failure by the customer to take reasonable care
- Failure due to not using the product in accordance with instructions stated in the manufacture's user guide.
- Product failure due to recommended installation procedures not being followed as stated in the manufacture's user guide.

More warranty relative information please read our Warranty Policy on the website.