

Greetings!

Thanks for purchasing jWatch HM041, We hope you' ll enjoy using it!

Before you begin using HM041, please read our user guide and warranty card carefully, This will help streamline your setup process and ensure you are aware of all of the functions and features jWatch HM041 has to offer.

We have designed HM041 to be your convenient and capable friend, always with you and always fashionable. Read on to explore HM041 and please visit us on Facebook and Twitter to share your experience

Introduction

Please read below before you start your journey with your very own Watch :

- Please turn your Watch off when you are near chemical plants, gas stations or other explosives.
- Please do not use Watch during flight and check if its auto-power-on is activated.
- Please do not use Watch near heart pacemakers, hearing aids or other medical electrical equipment. Watch may interfere these devices.
- Please do not disassemble, repair or modify Watch . Please contact our post-sale service center if there is any problem.
- Charge your Watch in a well-ventilated environment and keep Watch away from flammable, explosive materials.
- Please keep Watch away from magnetic materials, such as disks, credit cards, etc.
- Please do not expose Watch to extreme temperatures.
- Prolonged direct sunlight or humid environments should be avoided as well.
- Please do not use liquid or a rag with detergent to clean your Watch , just wipe with a soft cloth.
- While recording audio, photograph or video with Watch , please do not engage in illegal or unethical behaviors as it may violate local laws and regulations.

Remarks: This User Guide is designed to be used in the English language mode of the watch operating system.

Warning: We hold no liabilities for any direct, incidental or consequential damages resulting from improper use. The actual device may not always match the content and material herein; please refer to the actual device.

inWatch Technology has the right to modify this manual at any time, without notice.

Contents and Buttons

Contents:

- 1 x j Watch Smart Watch
- 1 x USB Charger Clip
- 1 x USB Cable
- 1 x SIM-Eject Tool

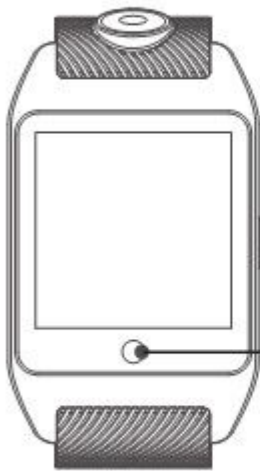

Power / Screen Lock Button:

Long press this button to turn on/off the watch.

Press this button to lock the screen;

Press the power button for 15 seconds to reset the watch. This has the same effect as removing and reinserting the battery.

Home Button:

By pressing the "HOME" button, you can:

- Return to the home page
- Return to the previous page

Network and Connections

Network: 3G 850, 2100; 2G 850, 900, 1800, 1900.

When using **Watch**, please abide by and respect local laws, local customs, privacy and legitimate rights of others (including copyright).

Because **Watch** can store a lot of useful information; we recommeand you backing up all your data regularly.

Tap any icon to open the application.
You can drag up or down to scroll the screen. You can also drag the screen left or right.
The control and notification panel swipes down from the top of the screen, the volume control panel swipes up from the botton.

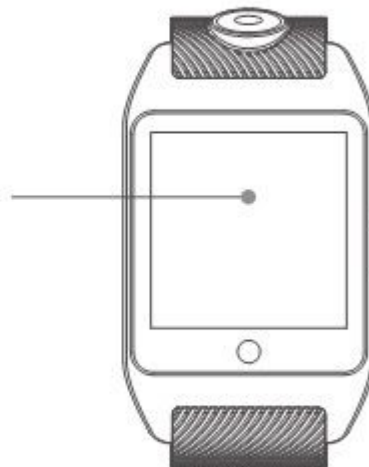

SIM Card

Watch 3 supports a micro SIM card.

Micro SIM cards let you save data for communication, such as your personal information, PIN code, contacts, messages, etc.

Insert a SIM card

1. Turn off your Watch 3.
2. Locate the small SIM card hole on the left side of the watch (the opposite side of the power button).
3. Push the SIM-eject tool into the hole until the SIM card tray pops out. (Do not insert SIM-eject tool into the Microphone hole)
4. Pull the SIM card tray out gently.
5. Place your Micro SIM card in the tray with the golden circuit side facing down.
6. Push the SIM card tray gently back into the slot until you feel it "click" into place.
7. Now turn your Watch 3 on. All of the information on the card will now be available on your Watch 3.

Warning:

Please do not twist or scratch the SIM card, and keep it away from static electricity, dust and water. Please keep the SIM card and tray away from the children.

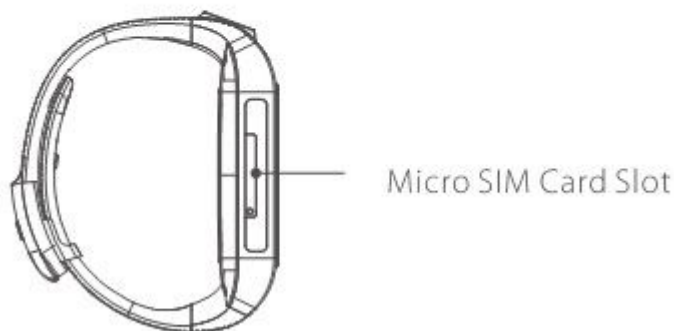

How to Wear jWatch

To put on Watch , please align the clasp, push from behind slightly and press down.

To take off Watch , pull up on the end of the metal clasp.

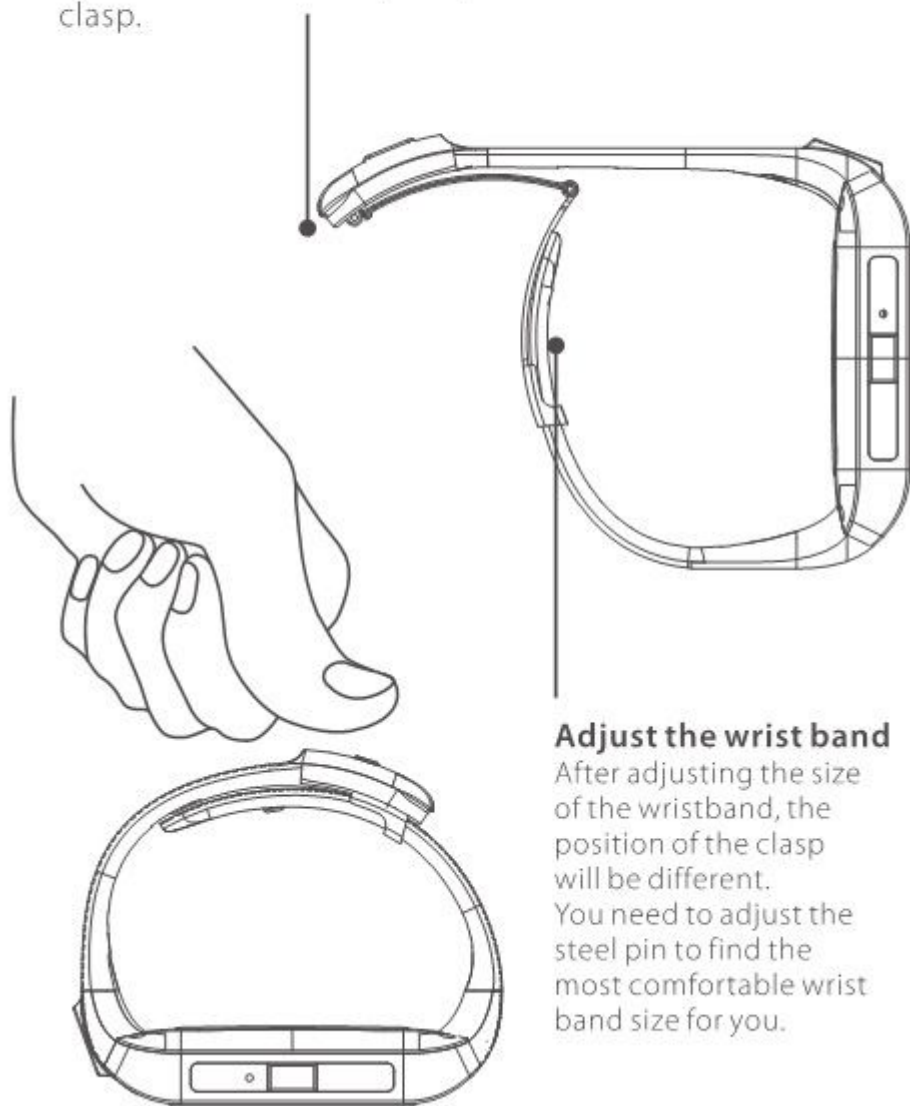

Adjust the wrist band

After adjusting the size of the wristband, the position of the clasp will be different.

You need to adjust the steel pin to find the most comfortable wrist band size for you.

How to Charge Watch

- jWatch uses external conductive contacts to charge.
- Open the charger clip and align it to the contacts under the wristband
 - Close the clip and connect the USB cable for charging.
(You may find the USB cable fits best when it is in the unclashed position)

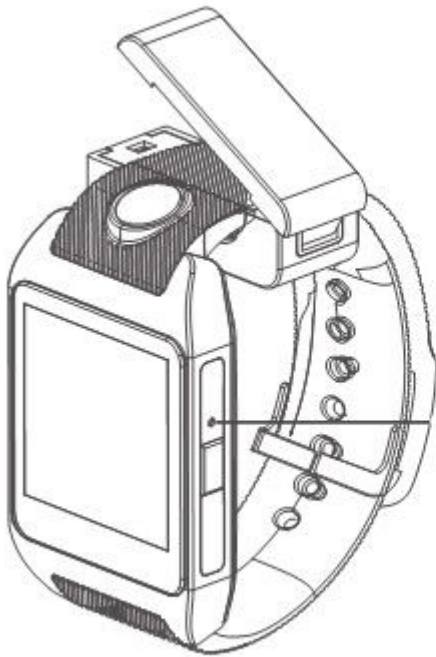

Operating System of jWatch

Home Screen

Includes: Weather, Date, Time, Messages and Phone.

Tap the weather widget to change background.

Long press to choose a different widget.

Favorites and App List

At the Favorites, you can long press the apps to delete or move other places.

At the App list, you can long press the apps and drag them from apps list to the Favorites page.

Control and Notification Panel

Swipe down from the top of the screen to view i's Control and Notification Panel. It shows time, date, connection type and strength, toggles for WIFI, Bluetooth, GPS, Data and Night Mode as well as a Brightness slider.

Volume Control Panel

Swipe down from the top of the screen to view i's Volume Control Panel. It shows speaker, phone and alarm volume sliders, music controls and some software buttons to access the apps that are running or navigate to the watch face lock screen.

Lock Screen:

Double tap to unlock, or swipe to the icon on the right to unlock.

(There are 3 other preset shortcut icons on the top/ bottom/left side, these can be customized in the settings menu)



Operating System of jWatch

Contacts

Tap "Contacts" icon at the App Center.

Contacts are arranged in alphabetical order, and only names are displayed on the first page of the phone book.

Contacts can be saved in Watch, micro SIM card and a smart phone which is set up for synchronization with your Watch.

Contact information includes : contact name, company, phone numbers and contact photo, etc.



Operating System of jWatch

Album

Watch will store pictures taken with the built-in camera to the photo album.

Tap "Album" icon at the App Center to access the album, where your photos will be arranged and displayed.

You can also create individual albums to manage your photos more efficiently.

Photos are laid out in a grid system. Single tap to view in full-screen. Swipe left or right to view the next or previous photo.

At the camera mode, there are settings at the bottom-left and you can switch photo and video modes by tapping the top-middle icon.



Operating System of jWatch

Music

The music player supports the use of a Bluetooth headset. Supported formats include: MP3, WMA, WAV, 3GP, MP4 and WMV.

Tap the "Music" icon in the App Center to enter the music player.

The Player page shows the currently playing song.

You can play a song by tapping its title on the playlist page.

Tap the upper-right corner to toggle shuffle mode on or off.



Operating System of jWatch

Video

The video player supports AVI, RM, RMVB and ASF formats. Tap the "Video" icon in the App Center to enter the video folder.

Videos are laid out in a grid system.

The bar at the bottom of the video displays playback progress.

Tap the lower-right corner to enter full-screen mode.



Operating System of jWatch

Voice

At the home screen, swipe right to access the voice assistant.

Voice assistant supports app opening commands.

Tap the microphone icon and say: open camera, or open message, etc.



A note on our keyboard

It's included default keyboard is great but for an interesting alternative, try installing Fleksy from the play store, it has a free version that is really cool. We hope to build it into future releases if possible!

FCC RF Exposure Information and Statement

This watch meets the government's requirements for exposure to radio waves. The guidelines are based on standards that were developed by independent scientific organizations through periodic and thorough evaluation of scientific studies. The standards include a substantial safety margin designed to assure the safety of all persons regardless of age or health. The SAR limit of USA (FCC) is 4W/kg averaged over 10 gram of tissue for limbs. Device types: Wireless Data Terminal (FCC ID: 2AGOEJXJ-HM041) has also been tested against this SAR limit. SAR information on this and other pad can be viewed on - line at <http://www.fcc.gov/oet/ea/fccid/>. Please use the device FCC ID number for search. This device was tested simulation typical at 1.45mm wear on wrist.

FCC Warning

This device complies with Part 15 of the FCC Rules. Operation is subject to the following two conditions:

(1) This device may not cause harmful interference, and (2) this device must accept any interference received, including interference that may cause undesired operation.

NOTE 1: This equipment has been tested and found to comply with the limits for a Class B digital device, pursuant to part 15 of the FCC Rules. These limits are designed to provide reasonable protection against harmful interference in a residential installation. This equipment generates, uses and can radiate radio frequency energy and, if not installed and used in accordance with the instructions, may cause harmful interference to radio communications. However, there is no guarantee that interference will not occur in a particular installation. If this equipment does cause harmful interference to radio or television reception, which can be determined by turning the equipment off and on, the user is encouraged to try to correct the interference by one or more of the following measures:

- Reorient or relocate the receiving antenna.
- Increase the separation between the equipment and receiver.
- Connect the equipment into an outlet on a circuit different from that to which the receiver is connected.
- Consult the dealer or an experienced radio/TV technician for help.

NOTE 2: Any changes or modifications to this unit not expressly approved by the party responsible for compliance could void the user's authority to operate the equipment.