

THIRD ANGLE PROJECTION

- Sheet Index:
 1. General Assembly
 2. Assembly Step 1
 3. Assembly Step 2
 4. Assembly Step 3
 5. Assembly Step 4
 6. Assembly Step 5

ITEM NO.	PART NUMBER	Description	QTY.
1	P1838-SA-244	Base Station PCB Sub Assembly	1
2	P1838-SK-645	Aavid Heatsink 241214B92200G	6
3	P1838-SK-704	Base Station SMA Bulkhead Jack	2
4	P1838-DP-703	Base Station Mounting Plate	1
5	P1838-SA-251	Base Station Enclosure Assembly	1
6	P1838-DP-817	Base Station Enclosure Lid	1
7	P1838-SK-1005	Base Station Antenna Cable	2
8	P1838-SK-568	M4 Washer DIN 125 - A	4
9	P1838-SK-263	M3x8 Torx Cap Head Screw ISO 14579	28
10	P1838-SK-950	M4x8 TORX CAP HEAD SCREWS ISO 14579	4
11	P1838-SK-789	M3 Plain Washer	4
12	P1838-SK-1188	Base Station Serial Number Label	1
13	P1838-DP-1242	RCOM FCC Safety Label	1

Refer to document P1838-ASS-002 for full assembly details.
 Use appropriate ESD for handling electronics throughout.
 Assembly Steps 1-5 shown on the following sheets.

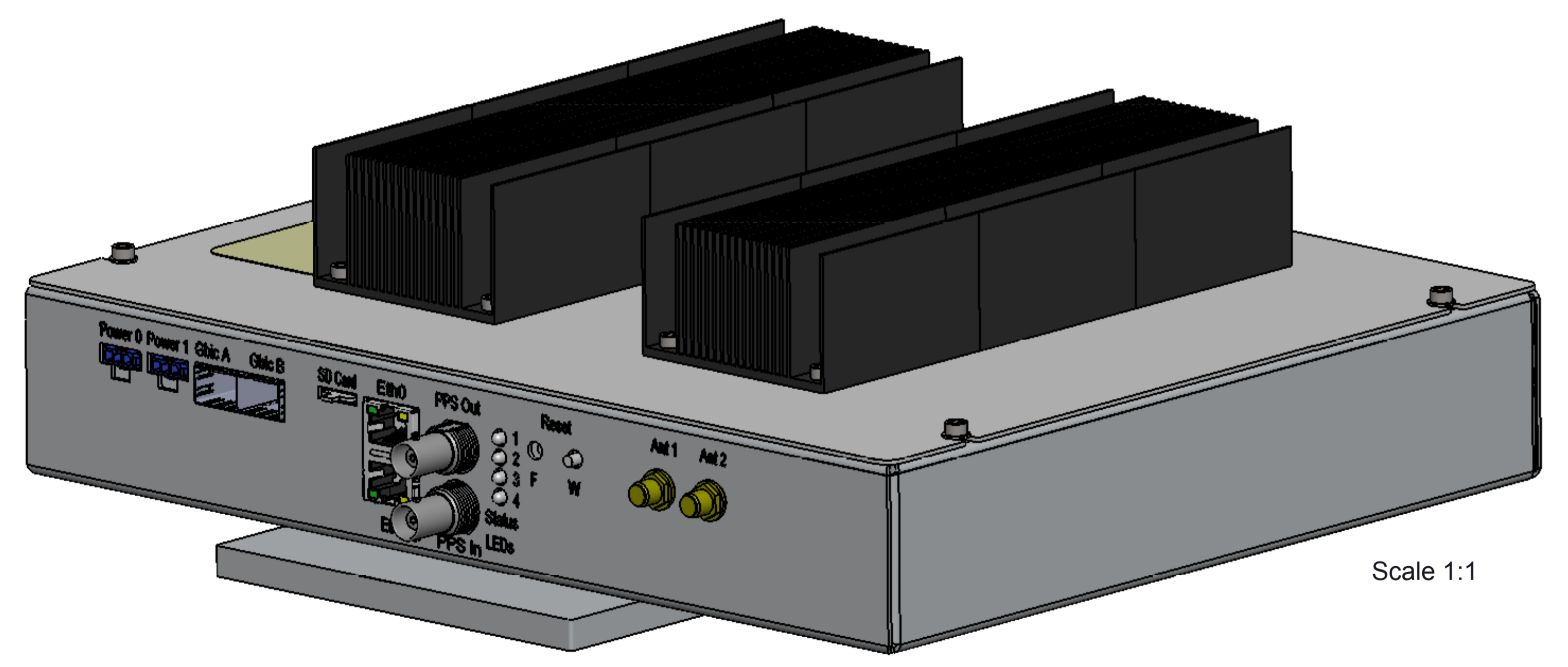
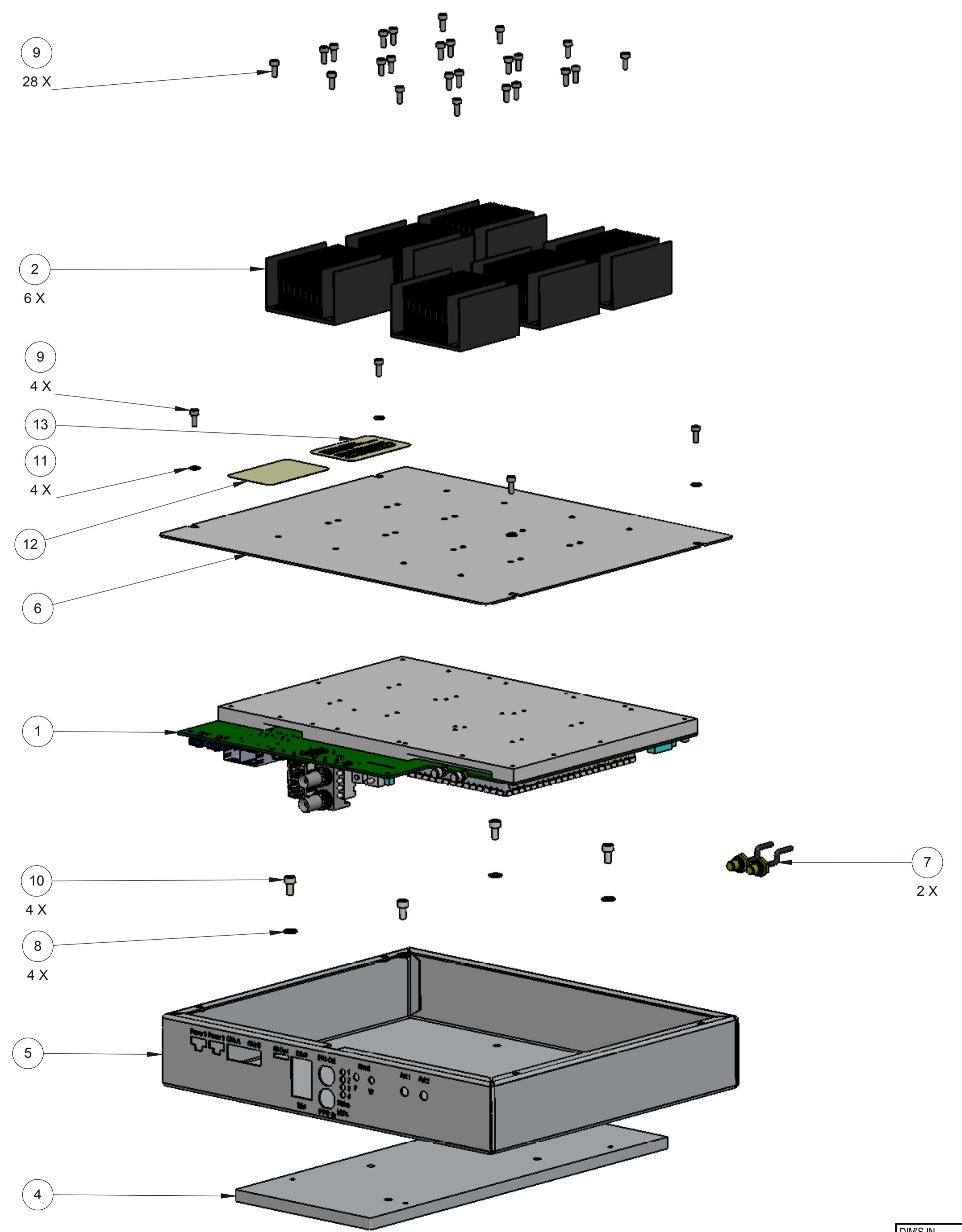

Scale 1:1

DRAWING & MODEL FILE VERSION HISTORY IS KEPT IN PDM Works, & CHANGE NOTES IN LotusNotes-DocMan. A "w" SHOWN AFTER AN ISSUE No. MEANS THE ITEM HAS BEEN MODIFIED SINCE LAST CHECK-IN.					
DRG	3.0	Controlled	09 October 2015 15:45:49 / mm2	P1838-CN-232	09-OCT-2015 / ADN
MODEL	3.0	Controlled	09 October 2015 15:45:10 / mm2	P1838-CN-232	09-OCT-2015 / ADN
FILE	ISSUE	REL. LEVEL	DATE FILE CHECKED-IN / BY	CHANGE NOTE No.	DATE APPROVED / BY

DIMS IN mm	STANDARD TOLERANCES WHOLE NUMBERS (eg 35) ± 0.5mm SINGLE DECIMAL (eg 3.5) ± 0.2mm DOUBLE DECIMAL (eg 3.52) ± 0.1mm WHOLE DEGREES (eg 90°) ± 1° DECIMAL DEGREES (eg 5.0°) ± 0.5°	COMMERCIALY CONFIDENTIAL. This drawing contains ideas and information which are proprietary to Cambridge Consultants Ltd and / or Cambridge Consultants Inc. It is given to you in confidence. You are authorised to open and view any electronic copy we send you of this document within your organisation and to print a single copy. Otherwise the material may not in whole or in part be copied, stored electronically or communicated to third parties without the prior written agreement of Cambridge Consultants Ltd and / or Cambridge Consultants Inc.
SCALE 1:2	see BoM Table on Drawing	
MATERIAL	N/A	
FINISH	N/A	

TITLE Base Station Assembly			
SUPPLIER'S REF NONE		CLIENT'S REF NONE	
	SHEET 1	DRAWING No P1838-SA-243	SHEET SIZE A1
	OF 6		

THIRD ANGLE PROJECTION

Refer to P1838-ASS-002 for full assembly details.

- Sheet Index:
1. General Assembly
 2. Assembly Step 1
 3. Assembly Step 2
 4. Assembly Step 3
 5. Assembly Step 4
 6. Assembly Step 5

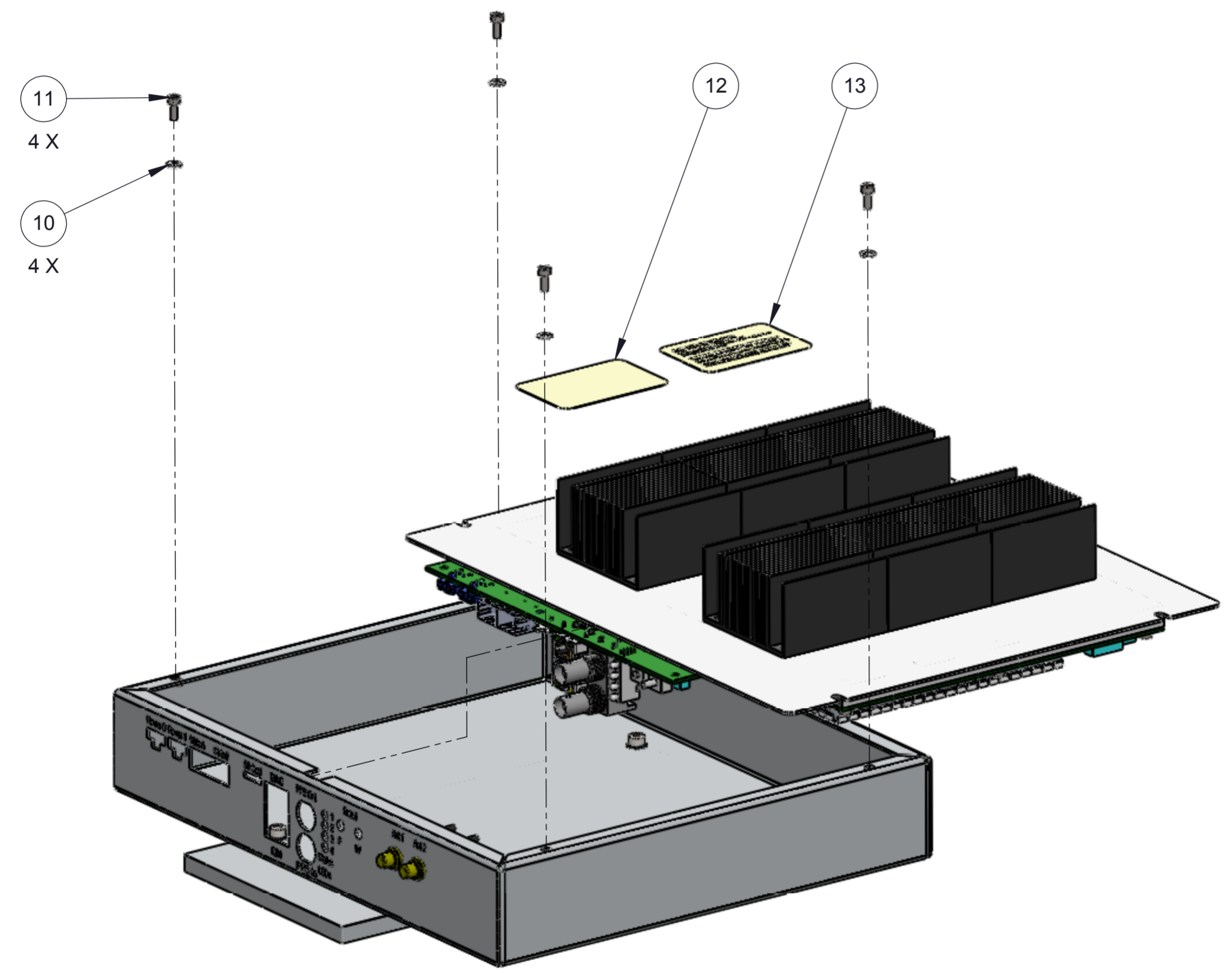

ITEM NO.	PART NUMBER	Description	QTY.
1	P1838-SA-244	Base Station PCB Sub Assembly	1
2	P1838-SK-645	Aavid Heatsink 241214B92200G	6
3	P1838-SK-704	Base Station SMA Bulkhead Jack	2
4	P1838-DP-703	Base Station Mounting Plate	1
5	P1838-SA-251	Base Station Enclosure Assembly	1
6	P1838-DP-817	Base Station Enclosure Lid	1
7	P1838-SK-1005	Base Station Antenna Cable	2
8	P1838-SK-950	M4x8 TORX CAP HEAD SCREWS ISO 14579	4
9	P1838-SK-568	M4 Washer DIN 125 - A	4
10	P1838-SK-789	M3 Plain Washer	4
11	P1838-SK-263	M3x8 Torx Cap Head Screw ISO 14579	28
12	P1838-SK-1188	Base Station Serial Number Label	1
13	P1838-DP-1242	RCOM FCC Safety Label	1

Assembly Notes:

1. Slide the lid assembly into the enclosure, P1838-SA-251.
2. Secure with 4 of P1838-SK-789, M3 washers, and 4 of P1838-SK-263, M3x8 Torx.
3. Tighten screws to 0.65 Nm.
4. Attach P1838-SK-1188 and P1838-DP-1242 to lid of the enclosure as shown below

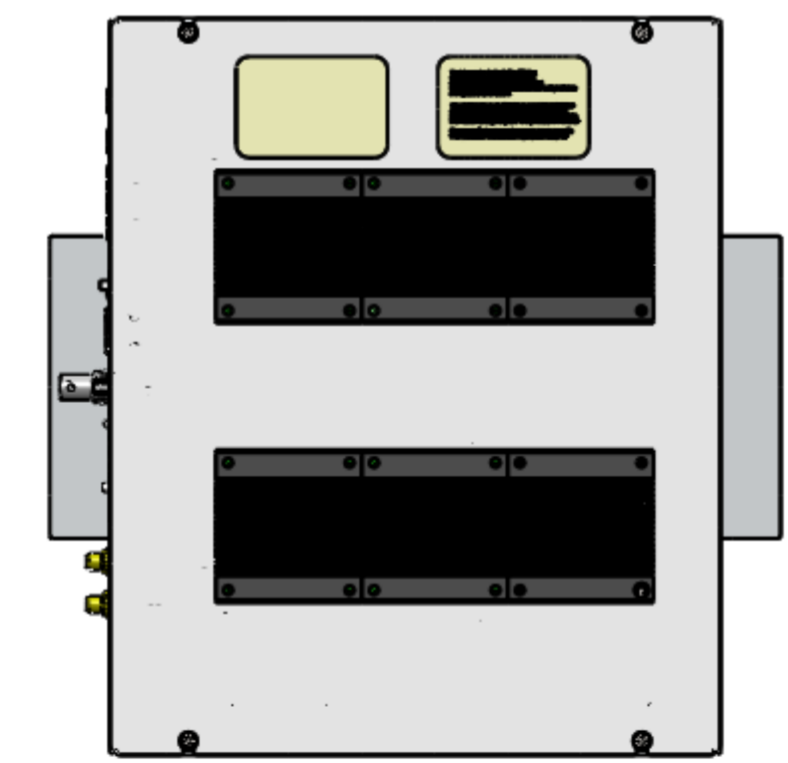

DRAWING & MODEL FILE VERSION HISTORY IS KEPT IN PDMWorks, & CHANGE NOTES IN LotusNotes-DocMan. A "w" SHOWN AFTER THE ISSUE No. MEANS THE ITEM HAS BEEN MODIFIED SINCE LAST CHECK-IN.

DRG	3.0	Controlled	09 October 2015 15:45:49 / mm2	P1838-CN-232	09-OCT-2015 / ADN
MODEL	3.0	Controlled	09 October 2015 15:45:10 / mm2	P1838-CN-232	09-OCT-2015 / ADN
FILE	ISSUE	REL. LEVEL	DATE FILE CHECKED-IN / BY	CHANGE NOTE No.	DATE APPROVED / BY

DIM'S IN mm	STANDARD TOLERANCES WHOLE NUMBERS (eg 35) ± 0.5mm SINGLE DECIMAL (eg 3.5) ± 0.2mm DOUBLE DECIMAL (eg 3.52) ± 0.1mm WHOLE DEGREES (eg 90°) ± 1° DECIMAL DEGREES (eg 5.0°) ± 0.5°	COMMERCIALLY CONFIDENTIAL. This drawing contains ideas and information which are proprietary to Cambridge Consultants Ltd and / or Cambridge Consultants Inc. it is given to you in confidence. You are authorised to open and view any electronic copy we send you of this document within your organisation and to print a single copy. Otherwise the material may not in whole or in part be copied, stored electronically or communicated to third parties without the prior written agreement of Cambridge Consultants Ltd and / or Cambridge Consultants Inc.
SCALE 1:2	see BoM Table on Drawing	
MATERIAL	N/A	
FINISH	N/A	

TITLE Base Station Assembly			
SUPPLIER'S REF NONE		CLIENT'S REF NONE	
	SHEET 6	DRAWING No P1838-SA-243	SHEET SIZE A2
	OF 6		