

**Model Number: ZJ-MHSB-A**

**Product Name: Smart Bridge**



### Product Parameter:

Category	Smart Bridge
Domination Principle	WIFI & BT 4.0
APP	Hao Deng
Language	Chinese、 English
Operation Platform	Android 4.4 or IOS 9.0 or higher
Voltage	AC 100-240V ,50/60HZ
Power Consumption	<1.5W
Number of connections	64
Working Temperature	-20 ~ +55°C
Control Distance(Visible)	50 Meters away from the router; And 15 meters from the BT device
Certification	CE, RoHS
Warranty	1year
Net Weight	43g
Dimension(L*B*H)	84MM*55MM*42MM

## Smart Bridge Indicator Lights Description

### 1: PWR Indicator Light(Red)

ON : The smart bridge is being power on.

OFF: The smart bridge is not getting power.



### 2: LAN Indicator Light(Blue)

(1) Blinking slowly (1 second): Intelligent network connection mode.

(2) Cyclic on and off (slow): AP Mode

(3) Flickering : The smart Bridge is attempting to establish a connection to your router . Solid blue: The smart bridge is fully connected to your router.



### 3: WAN Indicator light(Blue)

(1) Blinking(slow) : Device is connecting to the cloud server.

(2) Solid Blue : Device connected successfully.



## Key functions

(1) Restore factory settings: Press and hold the key for 15 seconds.

The WAN&LAN lights slow sync flash for 5 seconds indicates a successful reset.

(2) Intelligent connection mode : Short press(within 1 second).It will restore to the original state if there is no operation within ten minutes.

(3) AP Mode : Press and hold the key for 5~8 seconds. It will restore to the original state if there is no operation within ten minutes.



## First step: Download “Hao Deng” App

### Software User Manual for IOS

APP installation instructions:

Method 1: Search “Hao deng” in APP Store.

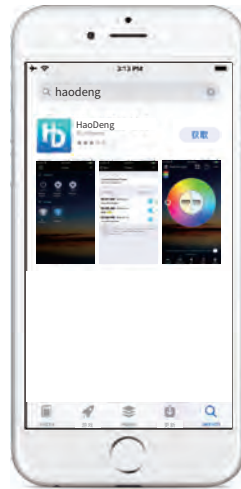

Method 2: Download the APP by scanning the below QR code for free.



Installation details as below.

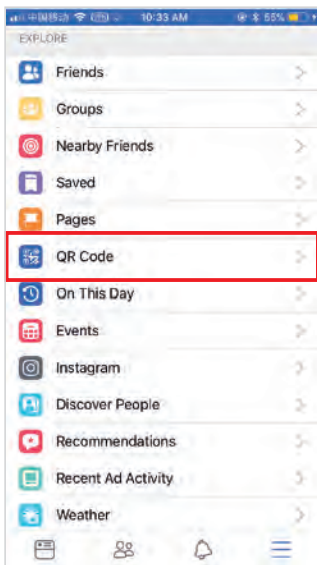

Step 1

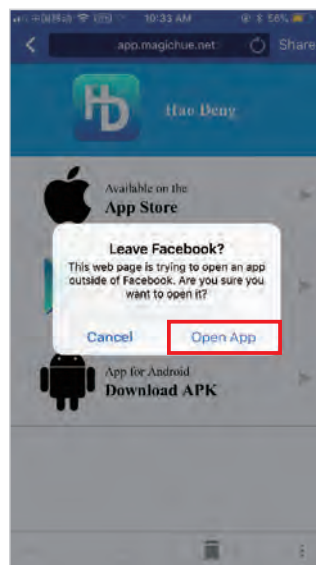

Step 2

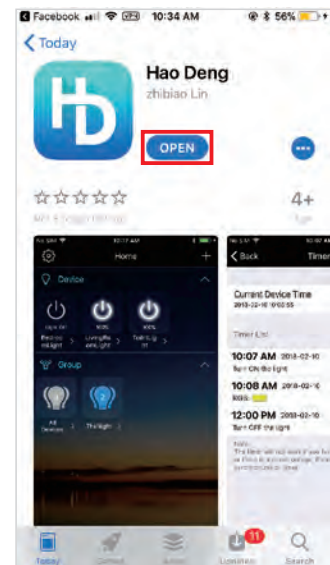

Step 3

# Software User Manual for Android.

APP installation instructions:

Method 1: Search Hao Deng in “Google Play Store” or from browsers. Installation details as follow.

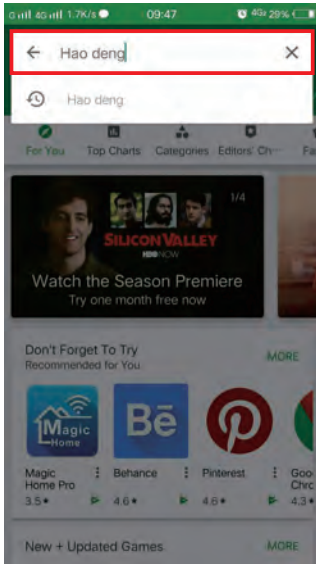

Step 1

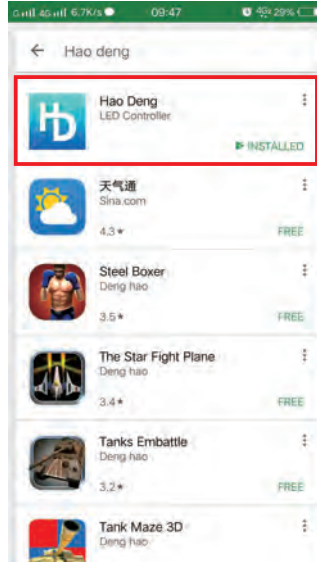

Step 2

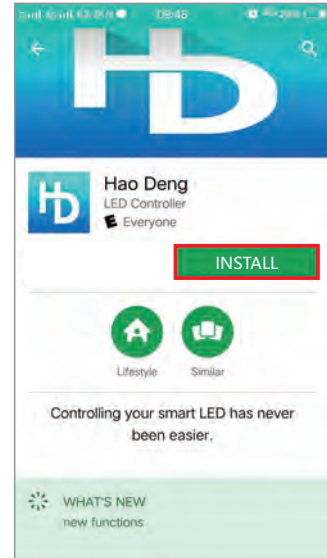

Step 3

Method 2: Download the APP by scanning the below QR code for free.



Installation details as below.

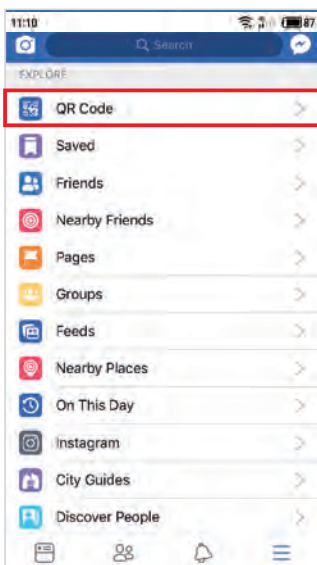

Step 1

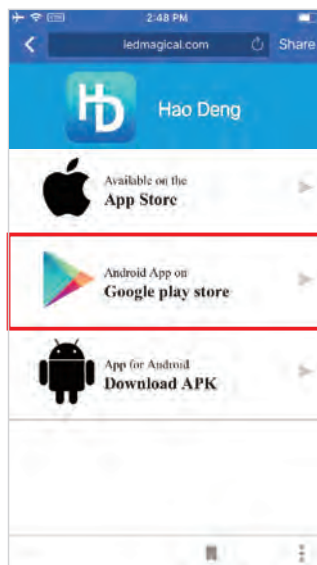

Step 2

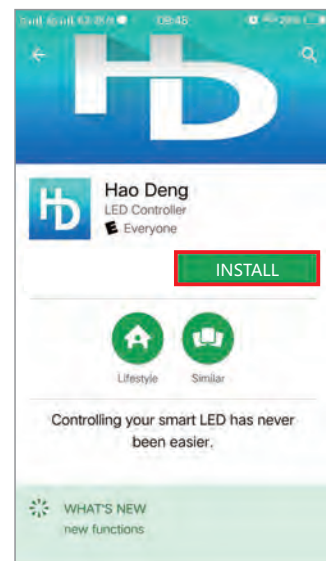

Step 3

## Second step: Adding the new light

A) Install the light and power it on, the light will keep gradually dimming & brightening as default factory mode. Otherwise, please refer to the user manual to restore the factory settings.

Open “Hao Deng” APP, sign up for an account and login.

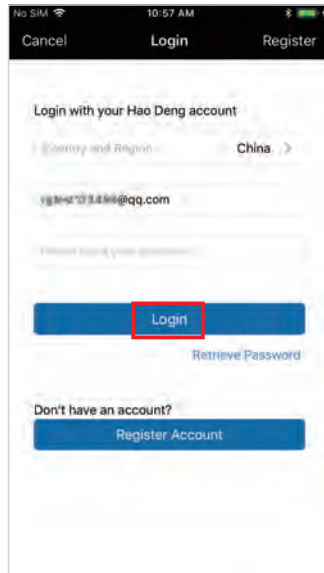

B) For 1st time use, please click on “Create a new place”, the APP will scan and add nearby smart LEDS automatically. Please enter the place name click on “Finished” after adding the light successfully.

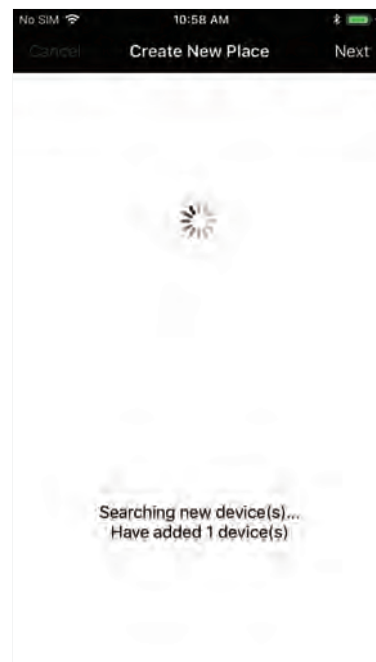
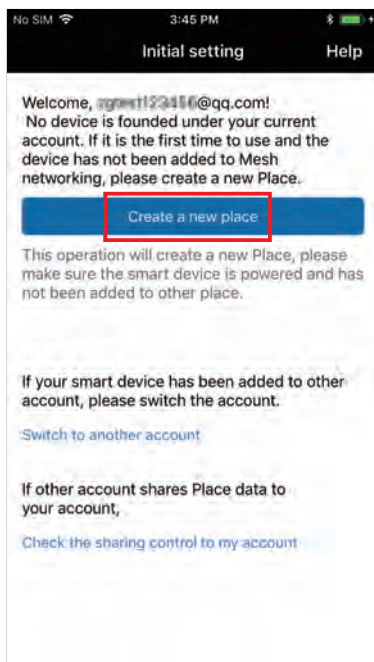

## Third step: Adding the Smart Bridge and configured.

You need to use our Smart Bridge to control your lights by issuing voice commands through Tmall Genie, Amazon Alexa & Google Home.

Click on the “” button in the top right corner, then click on menu “Smart Bridge Settings”.

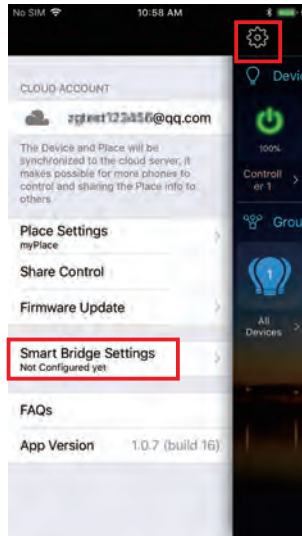

Follow the instructions on the interface, press the button on the Smart Bridge, and make sure the LAN indicator light flashes slowly (1sec). Click on “Confirm indicator light flashes slowly” on the APP, then enter your Wi-Fi password and click on “Next”, The Network configuration can be completed very quickly when the Network runs smoothly. After successfully connected to the Wi-Fi Network, the Smart Bridge settings will be shown as “Online”.

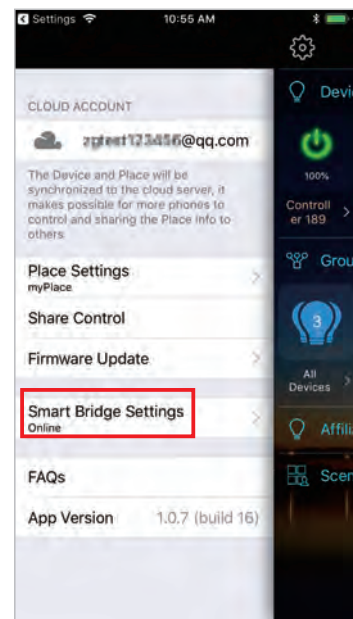

For more help, please click on the “  ” button and find more details from the “FAQs” pages.



## Amazon Alexa connection method

### Step 1: Create your “Hao Deng” account.

In order to control your smart light with the Amazon Alexa or control them remotely, you need to create a “Hao Deng” cloud account and login.

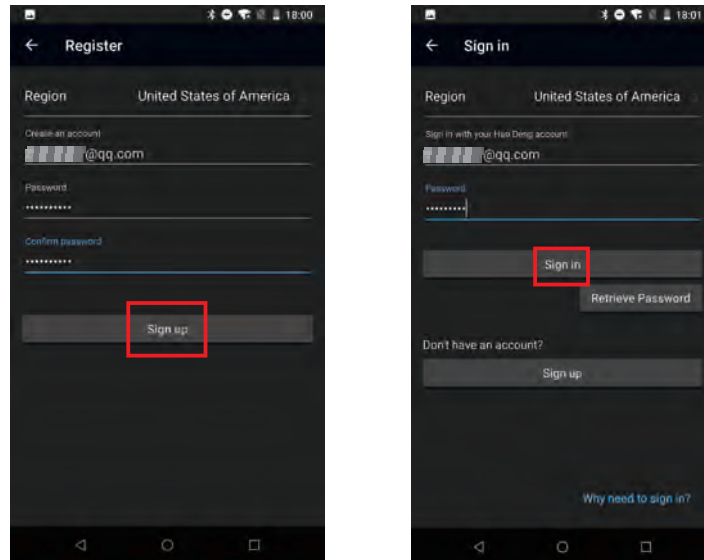

### Step 2: Add your light and modify the name

There will be a prompt to add the device after logging in successfully. (Make sure there is at least one smart light in the device list).

Long press the light to rename on “Home” page.

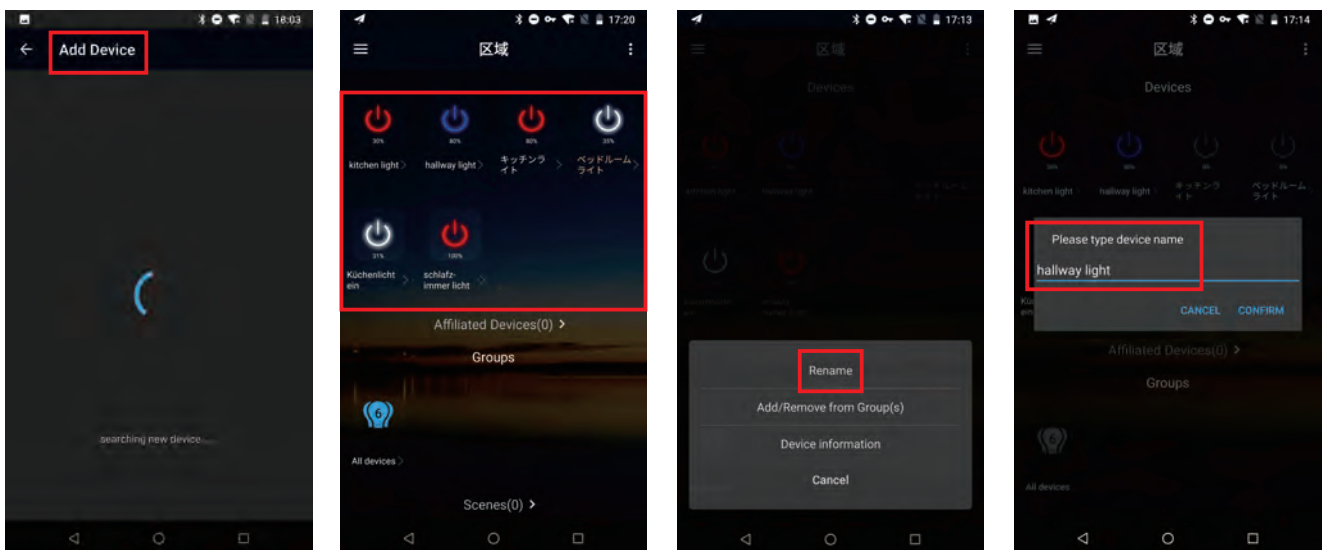



### Step 3: Configuring the Smart Bridge

Go back to Hao Deng APP, click on the sliding menu → Smart Bridge settings → Configure Smart Bridge. Follow the on-screen instructions and select your Wi-Fi Network (5G Hz Wi-Fi Network is not supported), enter the password for the secure Wi-Fi Network, then tap “CONFIRM” and your device will configure to the Wi-Fi Network automatically.

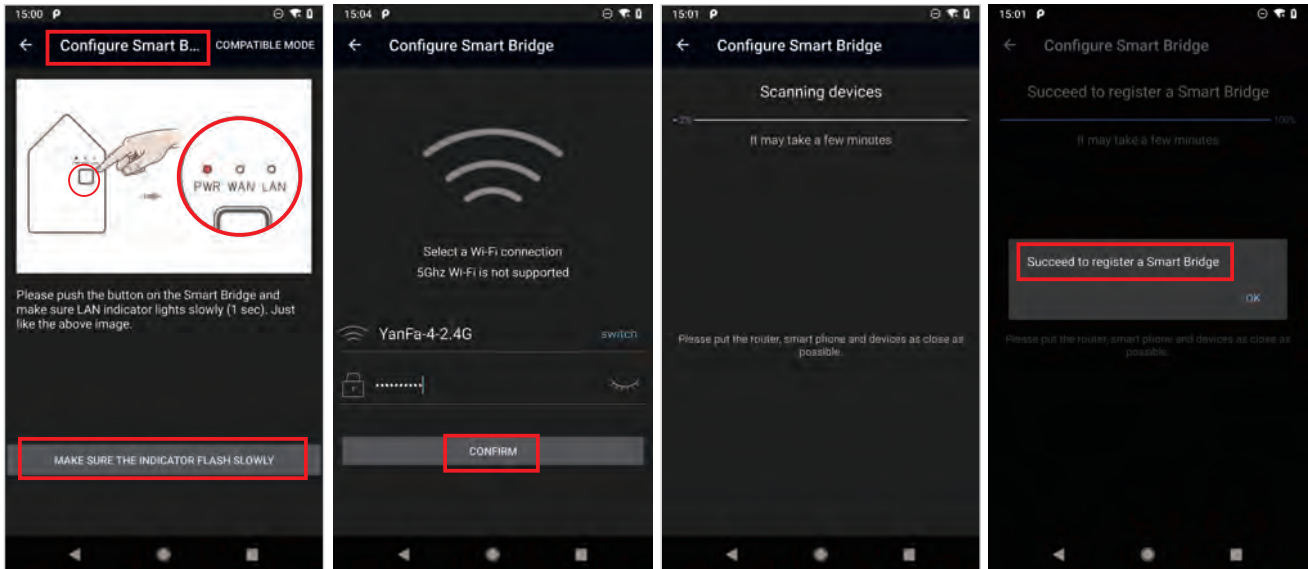

### Step 4: Enable Alexa Skills

Please download Amazon Alexa APP, go to the APP and click on the sliding menu → skills & Games → search "HaoDeng" → ENABLE → enter your user name and password → Login. You will see the below window after HaoDeng has been successfully linked.

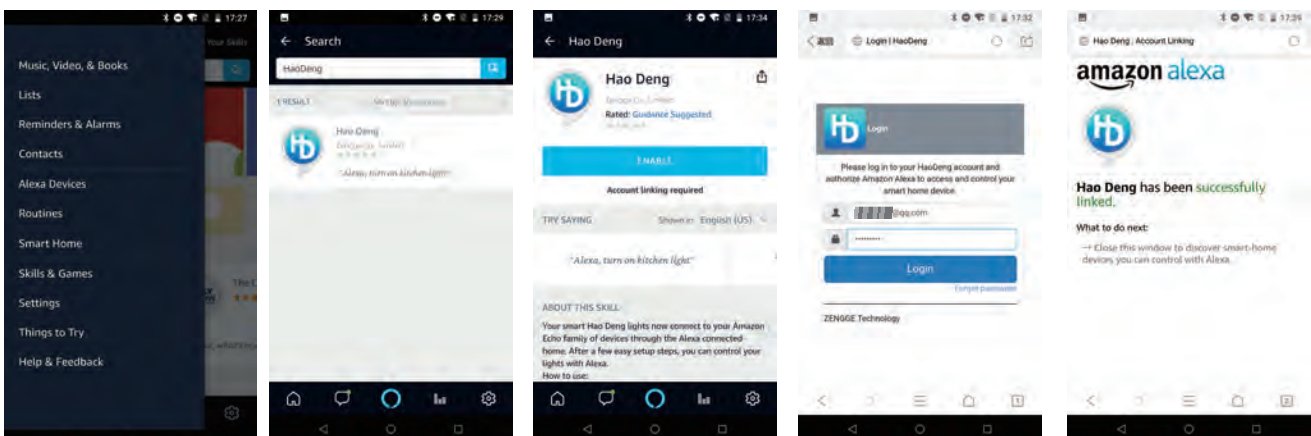

## Step 5: Discover Devices

You can say “Alexa, discover devices” ,the lights will appear on the Smart Home list as soon as the discovery finished. You can also click on “Add Device” on the “Smart Home” page to discover the lights.

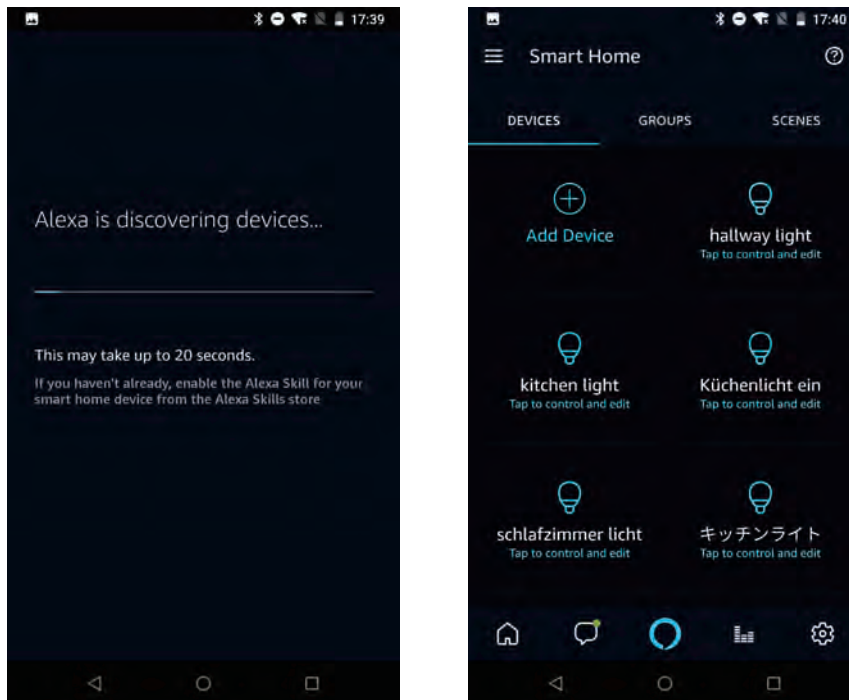

## Step 6: Control your lights

Here, you finish all setups. You can now control your lights by issuing voice command.

Supported commands:

These are some of the currently supported Alexa voice commands for the smart light.

- Alexa, set [light name] to [0-100]%
- Alexa, turn [light name] on/off
- Alexa, dim/brighten [light name]
- Alexa, increase/decrease [light name]
- Alexa, set the [light name] light to red
- Alexa, change the [light name] to the color blue
- Alexa, make the [light name] warm white
- Alexa, change the [light name] to the cool white
- Alexa, set the [light name] to daylight

Change the lights colors

Color Options for Alexa control of your smart device:

- |          |           |
|----------|-----------|
| Blue     | Orange    |
| Crimson  | Pink      |
| Cyan     | Purple    |
| Fuchsia  | Red       |
| Gold     | Salmon    |
| Green    | Sky Blue  |
| Lavender | Teal      |
| Lime     | Turquoise |
| Magenta  | Violet    |
|          | Yellow    |

## ATTENTIONS

1. Please use the product in a dry environment.
2. Please use the input voltage at AC (100-240)V voltage.
3. When using, keeping the product away from heat sources and ensure good heat dissipation.

### FCC Warning

This device complies with part 15 of the FCC rules. Operation is subject to the following two conditions: (1) this device may not cause harmful interference, and (2) this device must accept any interference received, including interference that may cause undesired operation.

Changes or modifications not expressly approved by the party responsible for compliance could void the user's authority to operate the equipment.

NOTE: This equipment has been tested and found to comply with the limits for a Class B digital device, pursuant to part 15 of the FCC Rules. These limits are designed to provide reasonable protection against harmful interference in a residential installation. This equipment generates uses and can radiate radio frequency energy and, if not installed and used in accordance with the instructions, may cause harmful interference to radio communications. However, there is no guarantee that interference will not occur in a particular installation. If this equipment does cause harmful interference to radio or television reception, which can be determined by turning the equipment off and on, the user is encouraged to try to correct the interference by one or more of the following measures:

-Reorient or relocate the receiving antenna.

- Increase the separation between the equipment and receiver.
- Connect the equipment into an outlet on a circuit different from that to which the receiver is connected.
- Consult the dealer or an experienced radio/TV technician for help.

### Radiation Exposure Statement

This equipment complies with FCC radiation exposure limits set forth for an uncontrolled environment. This equipment should be installed and operated with minimum distance 20cm between the radiator and your body.