



PHILIPS



Sensors

EasySense Switch

Philips Lighting North America Corporation  
10275 W. Higgins Road, Rosemont IL 60018  
Tel: 800-322-2086 Fax: 888-423-1882  
Customer/Technical Service: 800-372-3331  
OEM Support: 866-915-5886

Philips Lighting Canada Ltd.  
281 Hillmount Rd, Markham, ON, Canada L6C 2S3  
Tel. 800-668-9008

© 2017 Philips Lighting Holding B.V. All rights reserved.  
Philips reserves the right to make changes in specifications and/or to discontinue any product at any time without notice or obligation and will not be liable for any consequences resulting from the use of this publication.  
philips.com/easysense

PLt-17163QG\_EasySenseSwitch QIG 12/17  
Document #: 4422 944 00054 Rev A

## Philips Switch for EasySense Quick installation Guide

PLt-17163QG\_EasySenseSwitch QIG 12/17  
Document #: 4422 944 00054 Rev A

### Mechanical mounting

#### Parts list

- Front cover
- Adapter plate
- Switch assembly
- (2) Drywall screws
- (2) Drywall anchors
- (2) Junction box screws
- (2) Adapter plate screws
- (2) Wire nuts

#### Tools required

- Philips screwdriver
- Flathead screwdriver

#### NOTE

This switch is intended to be permanently mounted on a wall or installed to an outlet box by a qualified technician in accordance with the National Electrical Code (NEC) (ANSI/NFPA 70), Canadian Electric Code, Part 1 (CEC), and local codes.

#### Mounting to junction box

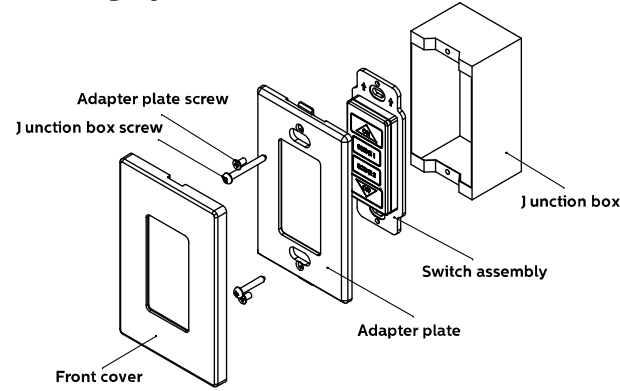

1. Remove existing switch and cap wires in accordance with all applicable codes. Line voltage must be permanently run to the light fixture.
2. Remove battery insulator strip from end of the switch assembly.
3. Place adapter plate over switch assembly and screw together with adapter plate screws provided.
4. Place adapter plate/switch assembly over junction box and screw down with junction box screws provided.
5. Snap front cover over adapter plate
6. If needed, the front cover can be removed by gently prying underneath the front cover with a flathead screwdriver.

#### Mounting to dry wall

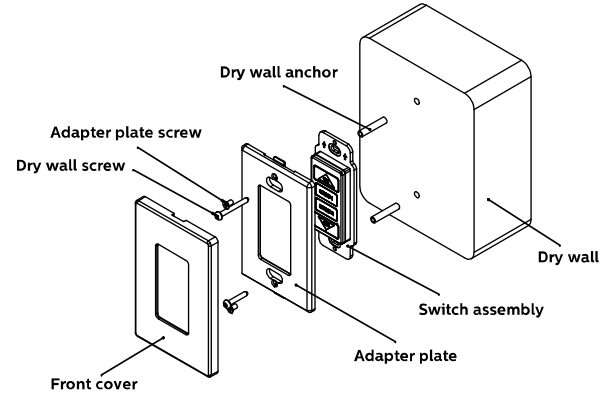

1. Drill 3/16" or 5mm pilot holes 3 1/4" on center.
2. Insert dry wall anchors provided
3. Remove battery protector strip from end of the switch assembly.
4. Place adapter plate over switch assembly and screw together with adapter plate screws provided.
5. Place adapter plate/switch assembly over anchors and screw dry wall screws provided into anchors.
6. Snap front cover over adapter plate.
7. If needed, the front cover can be removed by gently prying underneath the front cover with a flathead screwdriver.

**WARNING:** Chemical Burn Hazard. Keep batteries away from children.

1. This installation guide provides simple setup instructions for switch model number SMS200 for use only with compatible EasySense systems only.  
2. Up to (5) switches can be configured to operate in one group.  
3. The range of the SMS200 wireless switch is 50 ft. (15 m) line of sight.  
4. This switch is intended to be permanently mounted on a wall or installed to an outlet box by a qualified technician in accordance with the National Electrical Code (NEC) (ANSI/NFPA 70), Canadian Electric Code, Part 1 (CEC), and local codes.  
FCC Statement: This device complies with part 15 of the FCC rules. Operation is subject to the following two conditions: (1) This device may not cause harmful interference that may cause undesired operation.  
IC Statement: This device complies with Industry Canada License-exempt RSS standard(s). Operation is subject to the following two conditions: (1) this device must not cause interference, and (2) this device must accept any interference, including interference that may cause undesired operation of the device.  
Any changes or modifications not expressly approved by Philips could void the user's authority to operate this equipment. This product is intended for commercial use only. Déclaration De Conformité À La FCC Ce dispositif est conforme à la partie 15 des règles de Déclaration De Conformité À La FCC. Son fonctionnement est assujéti aux deux conditions suivantes: (1) l'appareil ne doit pas provoquer de brouillage préjudiciable, et (2) il doit accepter tout brouillage reçu, y compris le brouillage provenant d'un mauvais fonctionnement.  
Déclaration De Conformité À La FCC Cet appareil est conforme aux normes RSS exemptes de licence d'industrie Canada. Son fonctionnement est assujéti aux deux conditions suivantes: (1) cet appareil ne doit pas provoquer d'interférences, et (2) cet appareil doit accepter toute interférence, y compris les interférences susceptibles de provoquer un fonctionnement indésirable de l'appareil.  
Tous les changements ou modifications non expressément approuvés par Philips, sont susceptibles d'annuler le droit de l'utilisateur à se servir de cet équipement. Ce produit est exclusivement destiné à un usage commercial.

#### Compatible sensors

Commercial Product Name	Order Code	Description	Sensor Model Number
Battery-Powered Switch for EasySense	SMS200 (516914)	EasySense for Advanced Grouping	SNS202CMP
		EasySense Ceiling Mount Sensor	

#### Switch part number

FCC ID: 2AEGG-DELZB001

**Important Notes**  
Please read before installing

## Commissioning

Use the Philips Field App to add a switch to an EasySense group. An App User Manual can be found at [www.philips.com/easysense](http://www.philips.com/easysense). Follow the flow of either "Create group" or "Add to group" until the "Adding wireless switch" screen shows up. Simultaneously press the "On" and "Off" buttons for at least 4 seconds to move the switch into commissioning mode.

Upon entering commissioning mode the LED indicator flashes at a 500msec duty cycle for 30 seconds (500 msec on/500 msec off). The luminaire with Easysense will blink twice when the zigbee channel is matched. Finish the work flow on the App for creating or adding to the group.

A 30 second time-out is used during commissioning mode. If no reaction is received from the EasySense for 30 seconds, the device will move back to the decommissioned state.

When the device is commissioned, it can only enter commissioning mode again after being properly decommissioned.

When the device is commissioned, all commission data is stored in the switch memory. This memory is held even in the event of a battery changeout.

## Scene control and scene setting

Pressing a Scene button on the switch will instruct the sensors and lighting in the group to go to their programmed setting. Scenes can be custom configured through the Philips Field Apps. See the EasySense App User Manual on [www.Philips.com/easysense](http://www.Philips.com/easysense). The default settings are: Scene 1-- 60% light output; Scene 2 – 20% light output.

## Decommissioning the switch

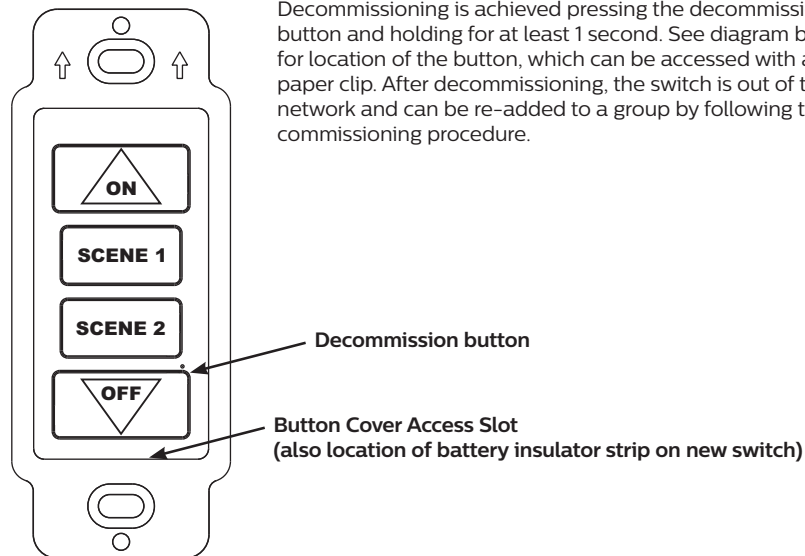

Decommissioning is achieved pressing the decommission button and holding for at least 1 second. See diagram below for location of the button, which can be accessed with a paper clip. After decommissioning, the switch is out of the network and can be re-added to a group by following the commissioning procedure.

## Battery LED Indication

Button state	Battery level – Normal (> 2.5V)	Battery level – Low (2.3 < Low < 2.5V)	Battery level – Dead (< 2.3V)
Any button in pressed state	RED LED blink 6 cycles, 50ms On – 100ms Off	RED LED flash once 50ms On	RED LED Off
All buttons in released state	RED LED Off	RED LED Off	RED LED Off

## Battery replacement and service

To replace the battery, disassemble the switch from the wall to access the Switch Assembly. Locate the "Button Cover Access Slot" at the bottom of the Button Cover Assembly (see drawing). Gently pry with a screwdriver to separate the cover. The battery will be visible pressed against the switch circuit board by the battery clip. Carefully remove the old battery. Replace only with lithium button cell battery CR2032. Be sure the battery "+" is facing the battery clip. Snap the cover back onto the Button Cover Assembly with the battery at the lower end of the switch. Re-assemble the switch to the wall.

Other than battery replacement, this switch is non-serviceable. A damaged or non-functioning switch should be completely replaced and should not be repaired.

This product contains a lithium button/coin cell battery. If a new or used lithium button/coin cell battery is swallowed or enters the body, it can cause severe internal burns and can lead to death in as little as 2 hours. Always completely secure the battery compartment. If the battery compartment does not close securely, stop using the product, remove the batteries, and keep it away from children. If you think batteries might have been swallowed or placed inside any part of the body, seek immediate medical attention.

The cells shall be disposed of properly, including keeping them away from children; and Even used cells may cause injury.