

folded 70x74mm

420 mm

70 mm

70 mm

70 mm

70 mm

70 mm

70 mm

74 mm

74 mm

296 mm

74 mm

74 mm

PHILIPS
hue personal wireless lighting



Smart button
Bouton Smart
Botón inteligente

Mini mount
Petit socle
Mini montaje

Wall mount
Plaque murale
Placa de pared

Main button
Bouton principal
Botón principal

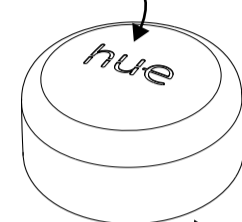

Setup button
Bouton de configuration
Botón configuración

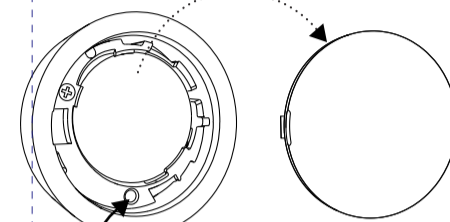
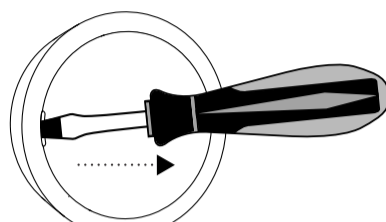

Setup button
Bouton de configuration
Botón configuración

Battery operated 1 x CR2032
Fonctionne avec des piles 1xCR2032
Con pilas 1xCR2032

Temperature (operation) -4...122°F
Température de fonctionnement -4 à 122°F
Temperatura (funcionamiento) -20 a 50 °C

Relative humidity: 5-95% non-condensing
Humidité relative: 5 à 95 % sans condensation
Humedad relativa: 5-95% sin condensación

© 2019 Signify Holding

3222 639 05011

A

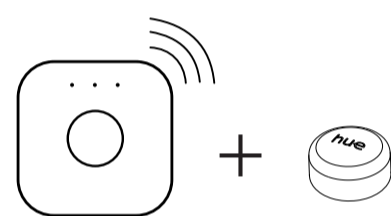

1. Open the Philips Hue app
Ouvrez l'application Philips Hue
Abra la aplicación Philips Hue
2. Go to Settings
Allez dans les paramètres
Vaya a Ajustes
3. Go to Accessory setup and follow instructions in the Hue app
Allez dans les réglages des accessoires et suivez les instructions données par l'application Hue
Vaya a la configuración de Accesorios y siga las instrucciones de la aplicación Hue

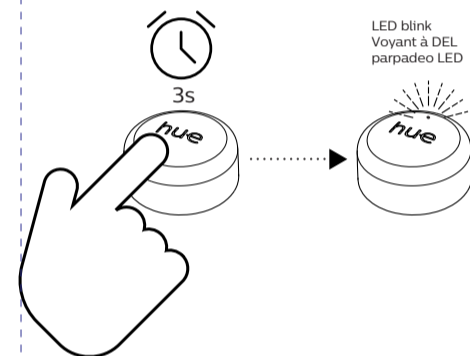

LED blink
Voyant à DEL
parpadeo LED

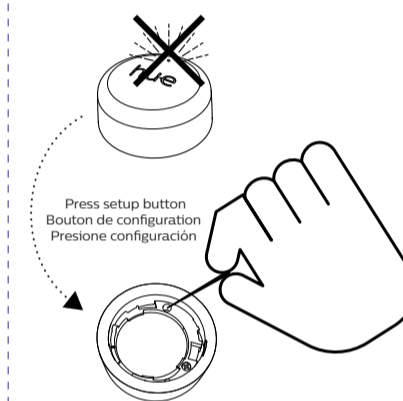

Press setup button
Bouton de configuration
Presione configuración

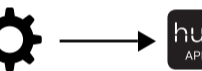
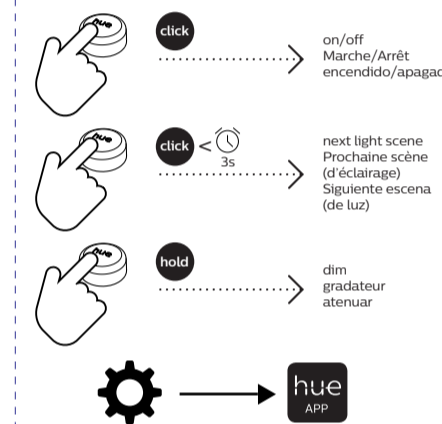

B

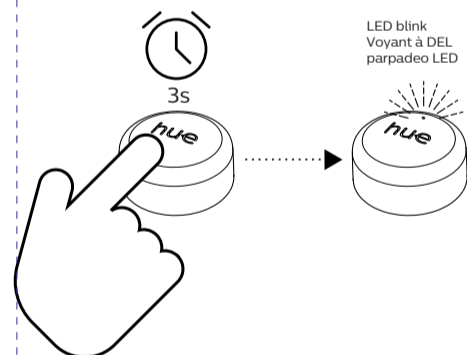
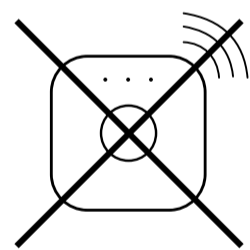

LED blink
Voyant à DEL
parpadeo LED

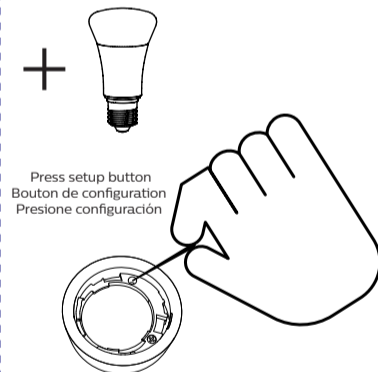

Press setup button
Bouton de configuration
Presione configuración

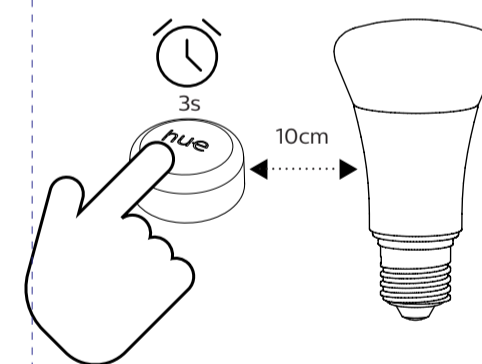

LED blink
Voyant à DEL
parpadeo LED

10cm

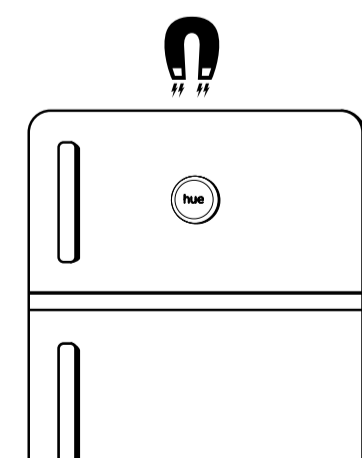
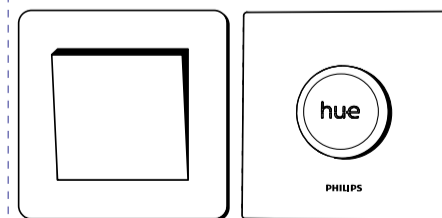
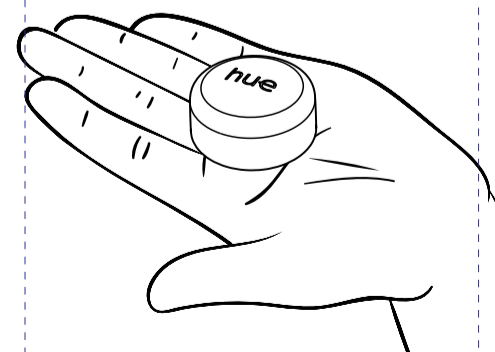
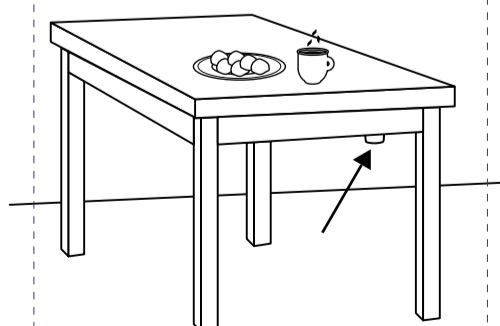
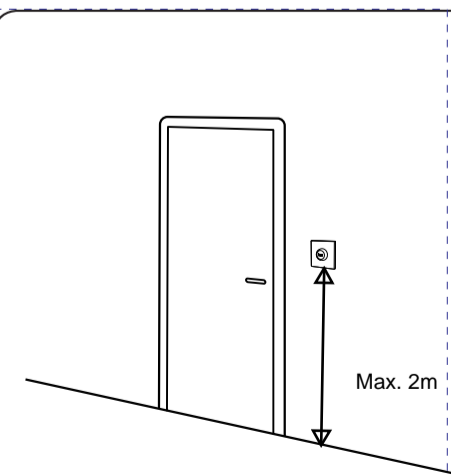
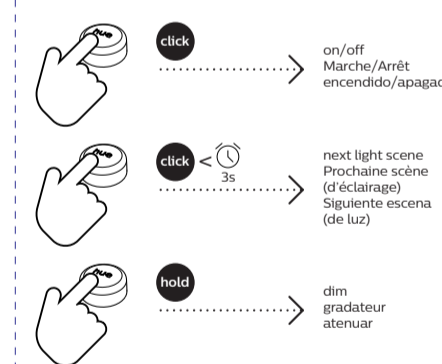

ARTWORK

Master Ref: PHL37827
TR161314
Brand: PHILIPS
Brand execution: HUE SUBBRAND 2017
Product name: USER MANUAL SMART BUTTON
Shape: N/A
Wattage: N/A
Region: Trident UK
Artwork 12NC: 3222 639 05011
Die cut 12NC: SQUARE/FOLDED 74X70
Barcode: N/A
CRC Number: N/A
Action: A
Date: 24/05/2019

Project Manager: Maryem Kok

Trident Artist: Matthew Simpson

Technical & Non Printing Items

■ Outline ■ Guides

Colours:
Black 1 3/4

PHILIPS



Trident UK, Connaught House, Connaught Road, Kingswood Business Park, Hull, HU7 3AP, England. T: +44 (0)1482 828100

Please note that any low resolution paper Canon colour copies associated with this job should be referred to for content, layout and colour separation only.

UNDER NO CIRCUMSTANCES SHOULD THIS ARTWORK BE ALTERED WITHOUT PRIOR PERMISSION FROM TRIDENT.

Manual NAM

FOR model: 9290022230

LMNAM003 Please go to www.meethue.com to learn more about Hue and how to use it.

LMNAM102 APPROBATIONS

LMNAM103 FCC, IC, UL, Zigbee

LMNAM147 FCC ID:

LMNAM012 This device complies with Part 15 of the FCC Rules and with RSS of Industry Canada.

LMNAM013 Operation is subject to the following two conditions: (1) this device may not cause harmful interference, and (2) this device must accept any interference received, including interference that may cause undesired operation.

LMNAM148 IMPORTANT NOTE

LMNAM149 FCC Radiation Exposure Statement:

LMNAM024 The advanced interface module complies with FCC radiation exposure limits set forth for an uncontrolled environment.

LMNAM094 This equipment should be installed and operated with a minimum distance of 8" or 20 cm between the radiator and your body.

LMNAM014 IC certification:

LMNAM148 IMPORTANT NOTE

LMNAM161 IC Radiation Exposure Statement:

LMNAM093 This equipment complies with IC RSS radiation exposure limits set forth for an uncontrolled environment.

LMNAM094 This equipment should be installed and operated with a minimum distance of 8" or 20 cm between the radiator and your body.

LMNAM012 This device complies with Part 15 of the FCC Rules and with RSS of Industry Canada.

LMNAM013 Operation is subject to the following two conditions:

1. This device may not cause interference; and
2. This device must accept any interference, including interference that may cause undesired operation of the device.

LMNAM021 This Class B digital apparatus complies with Canadian ICES-005.

LMNAM022 This digital apparatus does not exceed the class B limits for radio-noise emission from digital apparatus as set out in the Radio Interference Regulations of the Canadian Department of Communications.

APPROBATIONS

FCC, IC, UL, Zigbee

Cet appareil est conforme a l'alinéa 15 de la réglementation de la FCC et a la norme CNR d'Industrie Canada.

Son fonctionnement est assujéti aux deux conditions suivantes : (1) l'appareil ne doit pas causer d'interférences nuisibles; (2) l'appareil doit accepter toute interference recue, y compris les interferences qui peuvent causer un fonctionnement non desiré.

REMARQUE IMPORTANTE:

Enoncé FCC d'exposition aux rayonnements radioélectriques :

Cet équipement est conforme aux limites d' exposition a la radiation FCC presentées pour un environnement libre.

REMARQUE IMPORTANTE:

Enoncé IC d'exposition aux rayonnements radioélectriques :

Cet équipement est conforme aux limites d'exposition aux rayonnements IC établies pour un environnement non contrôlé.

Cet appareil est conforme a l'alinéa 15 de la réglementation de la FCC et a la norme CNR d'Industrie Canada.

Son fonctionnement est assujéti aux deux conditions suivantes : (1) l'appareil ne doit pas causer d'interférences nuisibles; (2) l'appareil doit accepter toute interference recue, y compris les interferences qui peuvent causer un fonctionnement non desiré.

Cet appareil numérique de la classe B est conforme a la norme canadienne NMB-003.

Cet appareil numérique ne dépasse pas les limites applicables aux équipements de classe B en termes d'émissions de bruit radioélectrique, telles que définies par le Règlement sur le brouillage radioélectrique établi par le Ministère des Communications du Canada.

AVIS : les modifications apportées a cet appareil sans avoir été explicitement approuvées par Signify North America Corporation ("Signify") peuvent annuler l'autorisation d'utilisation de cet appareil octroyée par la FCC aux États-Unis et par Industrie Canada.

A l' issue des tests dont il a fait l' objet, cet équipement a été déclaré conforme a la section 15 de la réglementation FCC applicable aux appareils numériques de classe B.

Ces limites sont conçues pour fournir installations résidentielles.

Cet équipement génère, utilise et peut émettre des ondes radioélectriques. Il est susceptible de créer des interférences nuisibles dans les communications radioélectriques s' il n' est pas installé ou utilisé conformément au mode d' emploi.

Cependant, l' absence d' interférences dans une installation particulière n' est pas garantie.

Dans le cas où cet équipement créerait des en éteignant et en rallumant l' appareil, il est conseillé d' essayer de corriger ces interférences en appliquant une ou plusieurs des mesures suivantes:

LMNAM023 NOTICE: Changes or modifications made to this device not expressly approved by Signify North America Corporation ("Signify") may void the U.S. FCC and Canadian authorization to operate this device.

LMNAM028: This device has been tested and found to comply with the limits for a Class B digital device pursuant to Part 15 of the FCC rules.

LMNAM029: These limits are designed to provide reasonable protection against harmful interference in a residential installation.

LMNAM030: This device generates, uses, and can radiate radio frequency energy and, if not installed and used in accordance with the instructions, may cause harmful interference to radio communications.

LMNAM031: However, there is no guarantee that interference will not occur in a particular installation.

LMNAM032: If this device does cause harmful interference to radio or television reception, which can be determined by turning the device off and on, the user is encouraged to try to correct the interference by one or more of the following measures:

LMNAM033: · Reorient or relocate the receiving antenna

LMNAM034: · Increase the separation between the device and receiver

LMNAM036: · Consult the dealer or an experienced radio/television technician for help

LMNAM040 WARNINGS AND CAUTIONS:

- **LMNAM140** Keep away from young children
- **LMNAM056** Keep away from liquids and humidity
- **LMNAM047** The device is for indoor use only.
- **LMNAM048** Do not use the device in wet locations, e.g. bathrooms or outdoors.
- **LMNAM050** This device is not a toy designed to be played with by children.
- **LMNAM052** Do not place the device on hot surfaces.
- **LMNAM155** Risk of explosion if battery is replaced by an incorrect type.
- **LMNAM151** CAUTION: Do not ingest battery—Chemical burn hazard.
- **LMNAM145** This product contains a coin/button cell battery.
- **LMNAM146** If the coin/button cell battery is swallowed, it can cause severe internal burns in just 2 hours and can lead to death.
- **LMNAM152** Keep new and used batteries away from children.
- **LMNAM153** If the battery compartment does not close securely, stop using the product and keep it away from children.
- **LMNAM154** If you think batteries might have been swallowed or placed inside any part of the body, seek immediate medical attention.
- **LMNAM143** Always switch off power prior to installation
- **LMNAM156** If in doubt, consult a qualified or licensed electrician.
- **LMNAM144** Ensure the product is always installed according to relevant regulations

LMNAM058 LIMITED WARRANTY:

LMNAM163 Signify warrants that this device will be free from defects in material and workmanship and will operate for 2 years when used as directed.

LMNAM060 If this device does not conform to the warranty, Signify will send you, at its election, a replacement device or refund your original purchase price upon receipt of the returned device, register receipt and proof of purchase.

LMNAM061 Please call our toll-free number 1-800-555-0050, write to Signify (address indicated on the packaging) or send an email at the website www.philips.com/lighting to find out how to return the device.

LMNAM062 This limited warranty does not cover devices subject to accident, neglect, abuse, misuse or acts of God.

LMNAM063 REPLACEMENT OR REFUND IS YOUR SOLE REMEDY.

LMNAM064 EXCEPT TO THE EXTENT PROHIBITED BY APPLICABLE LAW, ANY IMPLIED WARRANTIES ARE LIMITED IN DURATION TO THE DURATION OF THIS WARRANTY.

LMNAM065 LIABILITY FOR INCIDENTAL OR CONSEQUENTIAL DAMAGES IS HEREBY EXPRESSLY EXCLUDED.

LMNAM066 Some states and provinces do not allow exclusion of incidental or consequential damages, so the above limitation or exclusion may not apply to you.

LMNAM067 This warranty gives you specific legal rights, and you may also have other rights which vary from state to state and province to province.

LMNAM068 CLEANING AND MAINTENANCE:

LMNAM071 To avoid scratching, the product should only be cleaned with a soft dry cloth.

LMNAM073 Do not use cleaning agents to clean the device.

LMNAM074 Manage in accordance with disposal laws in your area.

LMNAM075 Remove the batteries when you discard the remote control.

LMNAM076 Do not throw the batteries away with normal household waste.

LMNAM077 They must be handed in at an official collection point or at a Philips Dealer, both of which will dispose of the batteries in an environmentally friendly way.

LMNAM129 Specifications Smart button

LMNAM130 Weight of product: 13g

LMNAM131 Weight of wall mount: 42g

LMNAM132 Weight of mini mount: 3g

LMNAM133 Size of product: 1.26 x 0.57 “

LMNAM134 Size of wall mount: 3.0 x 3.0 x 0.24 “

LMNAM135 Size of mini mount: 1.26 x 0.12 “

LMNAM137 Batteries: 1x CR2032

註解 [RM1]: To be confirmed

LMNAM080 Wireless specification

LMNAM081 Wireless RF mode frequency band: 2,400-2,483.5 MHz

LMNAM082 Wireless communications protocol: IEEE 802.15.4

LMNAM083 Operating channels: 11-26

LMNAM136 Installing the Hue Smart button on or near metal surfaces may lead to reduced range.

LMNAM084 Environmental specifications

LMNAM157 Temperature (operation): 0-40 °C.

LMNAM158 Temperature (storage): -40-80 °C.

LMNAM159 Relative humidity(operation): 0-80%

LMNAM160 Relative humidity(storage): 0-90%

LMNAM115 Product is designed for indoor use only.

LMNAM150 Product should not be submerged in water.

LMNAM117 CUSTOMER SUPPORT:

LMNAM118 For more information, please visit our website at www.meethue.com/support, or call our customer service (1-800-555-0050).

LMNAM119

Signify North America Corporation

200 Franklin Square Drive

Somerset, NJ 08873, USA

LMNAM120

Signify Canada Ltd./Signify Canada Ltée.

281 Hillmount Road,

Markham, ON, Canada L6C 2S3

LMNAM078 "Hue Personal Wireless Lighting" is a trademark owned by Signify Holding B.V.

LMNAM079 Philips and the Philips shield emblem are registered trademarks of Koninklijke Philips N.V.