

Quick Start Guide

Essential Bluetooth Headset HS-1500BT

Made for Calls and Music



www.CyberAcoustics.com

CA P/N: HS-1500BT Rev. A00
2021-09

In the Package

CA Essential
Bluetooth Headset



Quick Start Guide



USB
Bluetooth Adapter



USB Type C to C
Charging Cable

Note: The USB Bluetooth Adapter is packed along with the QSG, USB Type C to C Charging Cable are packed in the inner tray inside the box.

CA Essential
Bluetooth Headset HS-1500BT

Table of Contents

Pages

Using the Headset	1
Getting Started - Step 1	2
Getting Started - Step 2	3
LED Light	4
Controls	5,6
Technical Specifications	7
Frequently Asked Questions	8
Customer Support	9
Safety and Precautions	10
Compliance Information	11,12

Using the Headset

Best for Use In

Skype, Zoom & Other Internet Calls
Music

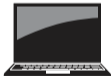

Getting Started - Step 1

Preparing the CA Essential Bluetooth Headset to connect to your Bluetooth enabled device. Before you start, please fully charge the CA Essential Bluetooth Headset. (See Page 6)

- Turn on the CA Essential Bluetooth Headset by pressing the Multi-Function button for 3 seconds.

LED Light alternately flashing Red and Blue

- The CA Essential Bluetooth Headset is ready to pair and connect

LED Light flashes Blue once every 10 seconds

- Your device has connected to the CA Essential Bluetooth Headset and is ready to use.
- The CA Essential Bluetooth Headset allows the last device it was connected with to automatically reconnect with the headset each time the headset is turned on and that device is within range.*

The CA Essential Bluetooth Headset can be connected to one device at a time.

- To pair and connect to a different device, you need to first disconnect the currently paired
- To disconnect the current device, Press and hold the + and - buttons at the same time for more than 1 second.
- The Light will begin flashing Red and Blue alternately and the CA Essential Bluetooth Headset is ready for the next device to pair and connect.

* Your device needs to be within 10 unobstructed feet of the CA Essential Bluetooth Headset to pair and connect. If there is an issue when connecting, please move your device closer to the headset, then pair and connect. When the charge is too low indicated by the LED Light flashing Red on the headset, your device will not be able to connect with the headset.

Multi-Function Button

LED Light



Getting Started - Step 2

With your Apple Mac or Windows 10 Laptop/Computer - Use the provided USB Bluetooth Adapter

- Plug the USB Bluetooth Adapter in a USB port on your computer.
- The CA Essential Headset will automatically pair with the USB Bluetooth Adapter.
- The LED Light on the ear cup will turn Blue and flash once every 10 seconds
- The CA Essential Bluetooth Headset is ready to use.

Note: The quality of the microphone recording is poor when connecting directly to the built in Bluetooth of your computer. For the best performance it is recommended to only use the USB Bluetooth Adapter.

With your iPhone, Tablet, Smartphone

- Go to Settings > Bluetooth, check Bluetooth is on
- Select 'CA Essential HS-1500BT' when it appears under 'Devices'
- Your device will connect in a few seconds
- The LED Light will turn Blue and flash once every 10 seconds
- The CA Essential Bluetooth Headset is ready to use.

Note: Your Smartphone or Tablet instructions may vary

Switching the connection between the USB Bluetooth Adapter and your iPhone, Tablet, Smartphone

- Connected to the USB Bluetooth Dongle
 - Unplug the USB Bluetooth Dongle from your computer
 - The CA Essential Bluetooth Headset will disconnect and is ready to pair with your iPhone, Tablet, Smartphone
 - See connection instructions above 'With your iPhone, Tablet, Smartphone'
- Connected to iPhone, Tablet, Smartphone
 - At the same time press and hold for 1 second the + and - buttons on the headset or manually disconnect on your iPhone, Tablet, Smartphone
 - The CA Essential Bluetooth Headset will disconnect and is ready to pair
 - To connect with the USB Bluetooth Adapter, plug the adapter into your computer and the headset will automatically pair with the USB Bluetooth adapter.

LED Light

Headset Powered On

Bluetooth Pairing	LED Light alternately flashes Red and Blue*
Bluetooth Connected	LED Light flashes Blue every 10 seconds*
Incoming call	LED Light flashed Red once a second
Call in progress	LED Light is lit solid Purple
Busy Light Enabled	LED Light is lit solid Purple
Headset is Powered Off	LED Light is lit Red for 1 second

Battery Status

Charging	LED Light is lit solid Red
Fully charged	LED Light is lit solid Blue
Low battery	LED Light flashed Red 2 times every 2 minutes - A voice prompt will indicate a low battery with approximately 15 minutes of battery power remaining.



*Blue LED will appear purple while charging

Controls



Multi-Function Button

Power On / Off

- Press and Hold for 3 seconds
- The headset will automatically enter into pairing mode when Powered On
- The headset will automatically power off after 5 minutes if not connected to a device

Voice Call (Only when connected to iPhone or Smartphone)

- Answer / End call: Press for less than 1 second
- Reject incoming call: Press the button two times
- Voice Transfer when connected to a Smartphone: Press and Hold the button for 2 seconds to transfer call to a connected Smartphone. Press and Hold again for 2 seconds to transfer back to headset.

Music *

- Play / Pause: Press for less than 1 second
- Sound mode: Press the button three times. A voice prompt will indicate Music or Gaming mode.

Busy Light *

- Manually turn On/Off: Press the button two times

* During a Voice Call the manual control of the Busy Light and Music Controls are not available

Volume Up Button +

- Volume Up: Press the + button one time for each volume increment
- Next track: Press and hold the + button for longer than 1 second

Volume Down Button -

- Volume Down: Press the - button one time for each volume decrement
- Previous track: Press and hold the - button for longer than 1 second

Disconnect Connected Device

- Press and hold the + and - buttons at the same time for more than 1 second

Controls

Mute / Un-mute mic

- Rotate the Mic Boom up towards the headband to mute the mic (Mic Boom in vertical position)
- Rotate the Mic Boom down away from headband to un-mute



Charging

- Insert the USB Type C Cable into a USB Type C port on your computer or a UL approved wall charger with Type C port.
- Insert the other end of the USB Type C cable into the USB Type C Charging Port on the headset.
- The headset will still function with your connected device when connected to a charging source.

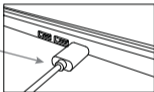

Technical Specification

Specifications

Sensitivity:	<ul style="list-style-type: none">• -58dBV / microbar• -38dBV / Pascal +/- 4dB
Frequency response	<ul style="list-style-type: none">• Headset: 20 - 20,000Hz• Microphone: 100 - 16,000Hz
Impedance	<ul style="list-style-type: none">• Headset: 32 ohms• Microphone: 2.2k ohms

Recommended system requirements

Supported operating system	Windows 10, Mac OS X 10.4.11 or higher
Operating temperature	Product working at ambient temperature for 0~35°C

Frequently Asked Questions

Frequently Asked Questions	Possible Solutions
<p>Bluetooth connection Cannot connect with your iPhone, Tablet, or Smartphone</p>	<ul style="list-style-type: none">• Turn the headset off.• Check that the USB Bluetooth Adapter is unplugged from your computer.• Check your Bluetooth source device and be sure you have found the section that allows you to discover new Bluetooth products. If you see the headset on the list, but cannot connect, you may need to try and synch again. To start fresh, with your Bluetooth device, select "Forget this device," to remove the "CA Essential HS-1500BT" from the list. You may need to turn off the Bluetooth function on your device to fully clear your list.• Turn the headset back on, the LED light will alternately flash red and blue indicating the headset is ready to pair and connect• Return to your source device, and re-enable the Bluetooth function. Look for the "CA Essential HS-1500BT" to show back up on the list.• Select the headset on your screen, and listen for the audible sound to confirm pairing.
<p>Bluetooth connection Cannot connect with the last connected device when returning</p>	<p>Last Connected Device was your iPhone, Tablet, Smartphone</p> <ul style="list-style-type: none">• If the headset does not automatically reconnect with your iPhone, Tablet or Smartphone, you may need to go into your device's Bluetooth settings and re-select the headset to reconnect.• Be sure to check your room environment. Today's Bluetooth technology has a designed limit of approximately 100 unobstructed feet, line of sight. Your best results will be when your source device and headset are in the same room. Extremely large rooms, or rooms with lots of wireless electronics, wi-fi routers, radio transmitters, etc, may affect your ability to pair and connect.• Check for obstructions, walls or other objects that might impede the Bluetooth signal.• Try returning to the source device to a closer proximity with your headset. <p>Last Connected Device was the USB Bluetooth Adapter</p> <ul style="list-style-type: none">• Make sure the USB Bluetooth Adapter is plugged in to a USB port on your computer.• If the headset does not automatically reconnect with the USB Bluetooth Adapter, unplug the adapter from your computer and replug into your computer.• If the LED Light flashes Blue every 10 seconds, the headset is connected to another device. At the same time press and hold for 1 second the + and - buttons on the headset to disconnect the headset from the currently connected device.

Customer Support

If you have a question about your CA Essential Bluetooth Headset, our Customer Service Team wants to assist you.

Contact us at:

www.cyberacoustics.com/support/contact

Safety and Precautions

- Read and follow all instructions – All operating and use instructions should be followed.
- Protect the Headset from being pinched. Power off during lightning storms or when unused for long periods of time.
- Do not place near any heat sources such as radiators, heat registers, stoves, or other apparatus (including amplifiers) that produce heat.
- Do not make alterations to the Headset.
- Do not place near naked flame sources, such as lighted candles.
- Do not expose to excessive heat (e.g. from storage in direct sunlight, fire or the like).

2021 Cyber Acoustics or its subsidiaries. All rights reserved. Cyber Acoustics and other trademarks are trademarks of Cyber Acoustics or its subsidiaries. Other trademarks may be trademarks of their respective owners.

Supplier's Declaration of Conformity 47 CFR § 2.1077 Compliance Information

Unique Identifier: (HS-1500BT)

Responsible Party - Cyber Acoustics LLC
3109 NE 109th Ave., Vancouver, WA 98682
cyberacoustics.com



Compliance Information Statement:

FCC Part 15

This device complies with Part 15 of the FCC Rules. Operation is subject to the following two conditions:

1. This device may not cause harmful interference, and
2. This device must accept any interference received, including interference that may cause undesired operation.

This equipment has been tested and found to comply with the limits for a Class B digital device, pursuant to Part 15 of the FCC Rules. These limits are designed to provide reasonable protection against harmful interference in a residential installation. This equipment generates, uses and can radiate radio frequency energy and, if not installed and used in accordance with the instructions, may cause harmful interference to radio communications. However, there is no guarantee that interference will not occur in a particular installation. If this equipment does cause harmful interference to radio or television reception, which can be determined by turning the equipment off and on, the user is encouraged to try to correct the interference by one or more of the following measures:

- Reorient or relocate the receiving antenna
- Increase the separation between the equipment and receiving device
- Connect the equipment into an outlet on different circuit from the receiving device
- Consult the dealer or an experienced radio/TV technician for help
- Changes or modifications not expressly approved by the party responsible for compliance could void the user's authority to operate the equipment.

IC WARNING

This device contains licence-exempt transmitter(s) that comply with Innovation, Science and Economic Development Canada's licence-exempt RSS(s). Operation is subject to the following two conditions:

- (1) This device may not cause interference.
- (2) This device must accept any interference, including interference that may cause undesired operation of the device.

L'émetteur/récepteur exempt de licence contenu dans le présent appareil est conforme aux CNR d'Innovation, Sciences et Développement économique Canada applicables aux appareils radio exempts de licence. L'exploitation est autorisée aux deux conditions suivantes:

1. L'appareil ne doit pas produire de brouillage;
2. L'appareil doit accepter tout brouillage radioélectrique subi, même si le brouillage est susceptible d'en compromettre le fonctionnement.



High sound pressure
Hearing damage risk
Do not listen at high volume levels for long periods.