

8. BACK COVER

© 2018 Zeikos, Inc. iHip is a trademark of Zeikos, Inc. iPod, iPhone and iPad are trademarks of Apple Inc., Registered in the U.S. and other countries. The illustrated product and specifications may differ slightly from that supplied. All other trademarks and trade names are those of their respective owners. United States and international patent pending. All Rights Reserved. For ages 12+up. This is not a toy. Designed by iHip, Manufactured in China.



Limited One Year Warranty.
Customer service: 1-800-500-4434
To activate your product warranty go to our website www.ihip.com & register this product.



18 Progress St.
Edison, NJ 08820
www.ihip.com



Find us on Facebook.
Keyword: iHip: Portable
Entertainment

PAGE 2.

How to use it?

Pair the headphones with a bluetooth enabled device
Turn the headphone On by long press the power switch,a tone will be heard and the LED indicator light will alternately flash RED and BLUE.

Keep your bluetooth headphone and bluetooth enabled device within 3feet of each other during the pairing process,set your mobile phone or other bluetooth enabled device to search for Bluetooth devices.

When the bluetooth enabled device finds the headphone, select "BTSTAMINA" from the list of found devices. If required, enter the password 0000. Select OK or Yes to pair your device

After a successful registration,a tone will be heard and the LED indicator light will slowly blink BLUE.

1. COVER



stamina

WIRELESS HEADPHONES



Operating Instructions

PAGE 7.

Note: If you would like to connect the headphones to another device, you must unpair the headphones from the currently paired device first. On your device's bluetooth settings, select "BTSTAMINA" then select "unpair". When the headphones have been unpaired, it automatically goes into pairing mode again.

Features

Driver Unit: 40mm
Built-in bluetooth chipset: JL-BT 2.1 Stereo
Playing Time: 12-14h
Standby Time: 18-20h
Battery: 400mah
Operation Range: 10-12m
Frequency: 20-20kHz
Built-in Mic
Aux Port
Volume control/music
Control/Play/Pause/Answer/Hang-up

PAGE 6.

Location of Controls

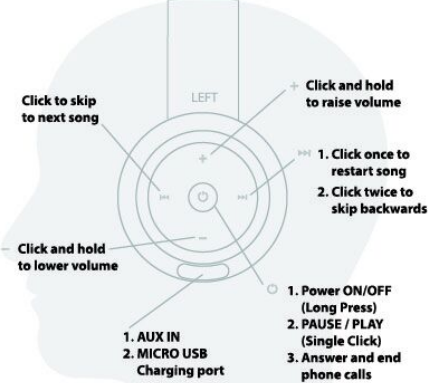

PAGE 3.

Using as wired headphones

Connect the one end of the included 3.5mm Aux cable to the Aux In jack on the headphones,and the other end of the cable to an external device's headphone jack(smart-phone,tablet,computer,or MP3 player).Open a media player on your device and click on play to start playing your music. Use the controls on your connected device to control music playback and volume(Or you can use the volume control on the bluetooth headphone to control the volume,and control music playback by using the controls on your connected device).



PAGE 4.

Charging the bluetooth headphones

Connect the small end of the Micro USB cable to the charging port on the headphones. Connect the large end of the Micro USB cable to your computer's USB port or an AC adaptor(not included). The LED indicator light turns RED when charging.It will turn off when fully charged.



PAGE 5.

The Bluetooth® word mark and logos are registered trademarks owned by Bluetooth SIG, Inc. and any use of such marks by "iHip" is under license. Other trademarks and trade names are those of their respective owners.

Changes or modifications not expressly approved by the party responsible for compliance could void the user's authority to operate this device.

This device complies with part 15 of the FCC Rules. Operation is subject to the following two conditions: (1) This device may not cause harmful interference, and (2) this device must accept any interference received, including interference that may cause undesired operation.

NOTE 1: This equipment has been tested and found to comply with the limits for a Class B digital device, pursuant to part 15 of the FCC Rules. These limits are designed to provide reasonable protection against harmful interference in a residential installation. This equipment generates, uses and can radiate radio frequency energy and, if not installed and used in accordance with the instructions, may cause harmful interference to radio communications. However, there is no guarantee that interference will not occur in a particular installation. If this equipment does cause harmful interference to radio or television reception, which can be determined by turning the equipment off and on, the user is encouraged to try to correct the interference by one or more of the following measures:

- Reorient or relocate the receiving antenna.
- Increase the separation between the equipment and receiver.
- Connect the equipment into an outlet on a circuit different from that to which the receiver is connected.
- Consult the dealer or an experienced radio/TV technician for help.