



GATOR 6

Quick Start Guide

Z555 Quick Guide

SAFETY INFORMATION

Transportation Safety

Please observe all transportation laws and regulations

Hospital Safety

The handset must be turned off when you are in a hospital.

You have to abide by the relevant regulations of hospital and turn your handset off when you are near medical equipment. Any wireless transmission device, including mobile, will interfere those equipment not fully-protected.

Airport Safety

Remember to follow all airport and flight Safety regulations.

Emergency Calls

Make sure your mobile phone is switched on and in a service area. In home screen, tap the phone key and dial the emergency number

Battery Usage

For better performance and longer battery life, it is recommended that you charge the battery fully before using the mobile phone for the first time and that you initially complete two to three charge cycles.

KEY FUNCTIONS



Keys	Instructions
1.Home Key	Click to back to home screen
2.Return Key	Click to Return
3.Menu Key	Click this button to Option Menu
4.USB	Micro USB
5.Power Key	Long press this key to turn off/on. Short press this key to lock the phone or light the screen
6.Headphone Jack	Headphone jack
7.Volume Key+	Press to increase volume
8.Volume Key-	Press to decrease volume
9.Camera	Back Camera
10.Flash	Flashlight
11.Loud Speaker	Loud speaker
12.SIM/microSD slot	SIM/microSD slot

INTRODUCTION

Installation of the SIM Card

Warning: Please keep the SIM card out of the reach of children. The SIM card and its contact are easily damaged due to scratching or bending. Please use caution when carrying, installing or taking out the SIM card.

Note: Please contact your cellular phone service provider directly to obtain your SIM card.

To insert SIM card

1. Remove the tray that has SIM and microSD installed. For removing SIM tray use SIM extractor tool.

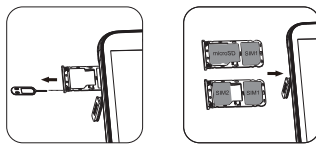

2. Insert the SIM card and a microSD card if need.
3. Place the tray in the appropriate slot and secure it.

When you initially power on your phone, there will be a series of steps to set up basic features.

INSERT SIM

Insert your SIM card so the phone can register to the network.

CHARGER THE BATTERY

Please make sure always turn off the power before installing or replacing the SIM card and the MicroSD card.

1.You can charge the device with a travel adapter or by connecting the device to a PC with a USB cable.

2.Battery full icon will show when finished if your device is power off.

Warning: Please use original charger and battery. Unapproved accessories and Battery can cause explode or damage your device.

GETTING STARTED

Turn your device on and off

Press and hold the power key to turn on your device, to turn off your device, press and hold the power key then tap Power Off.

Airplane mode

The Airplane Mode will interrupt all the wireless communication on your device. Please follow the instructions below to turn on flight mode:

Tap Settings → Network & Internet → Airplane mode to enable/disable Airplane mode.

USE THE TOUCH PANEL

You can operate the icon, button, keyboard by the touch panel.

Including:

Touch:

To access an application, touch it with your finger. For example: Touch an application icon, you can open the application.



Touch and Hold:

To enter the available options for an item, touch and hold the item.



Slide/Swipe:

Slide the screen to scroll up and down the applications, images, and web-pages... at your convenience. You could slide the screen horizontally too.



Drag:

Place your finger on the screen to drag an object to another location.



Pinch/Spread:

Place your fingers of one hand on the screen surface and draw them apart or together to scale an element on the screen.



HOME SCREEN

You can bring all the items (applications, shortcuts, folders and widgets) you want to your Home screen for quick access.

Slide the Home screen horizontally left and right to get a complete view of the Home screen.

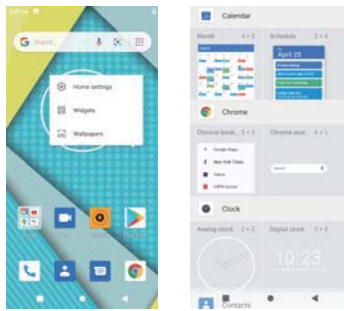

To add the widget, press and hold on the screen, then choose the Widgets button

You are able to change the wallpaper by choose the wallpapers in the above interface also.

NOTIFICATION PANEL

Slide the notifications area down to open the notification panel shown below. You can access a list of notifications.

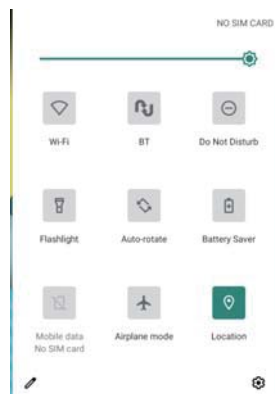

You may tap the related icons to activate or deactivate Wireless connection features or other function like the Airplane mode or Flashlight.

LOCK & UNLOCK THE SCREEN

To lock/awake the screen manually, press **Power** key once.

Tap and hold the lock icon, then slide it up to unlock the device.

Security

You can protect your device and data by setting screen lock or encrypting your device.

Set a screen lock

To set a screen lock, tap Settings → Security & location → Screen lock from application list.

None: Deactivate the screen lock.

PIN: Enter a numeric PIN to unlock. When prompted, enter the PIN to unlock the screen.

Pattern: Draw a pattern to unlock. Follow the instructions to draw your lock pattern. When prompted, draw the pattern to unlock the screen.

Password: Enter a passcode to unlock. When prompted, enter the passcode to unlock the screen.

Screen time-out

Select Settings → Display → Advanced → Screen Timeout from application list, you can set the time before the screen times out and goes into lock mode.

Auto rotation

If you rotate the device while using some features, the interface will automatically rotate as well. To prevent the interface from rotating, open the notifications panel and select Auto-rotate , then scroll it to Off.

Enter text

You can enter text by selecting characters on the virtual keyboard. Tap the text input field to display the virtual keyboard.

From a text field, you can use the copy and paste feature for fast inputting.

Manage applications

To manage the applications installed on your device, tap Settings → App& notification.

To uninstall an application, select the application and tap Uninstall, tap OK to confirm.

To stop or change the settings of an application, select the application and click Force stop.

Reset device

You can reset system and desktop settings to their original values by the following steps:

Select Settings → System → Reset options from application list.

Tap Erase all data (Factory reset).

Tap Erase all data

The device resets to the factory default settings automatically.

Warning!: Factory data reset will erase all data from your device and SD card, including your google account, system and application data and settings, and downloaded applications.

COMMUNICATION**Phone**

To use calling functions, tap Phone from application list.

Make calls

To make calls, you can use any of the three ways:

1. Enter numbers by using the virtual keypad on the screen.
2. Make a call from call log (Recent).
3. Make a call from contacts.

Answer a call

To answer a call, **swipe the circled button up**
To decline a call, **swipe the circled button down**.
To end a call in progress, **tap the red button**.

Call settings

To change call settings, tap the option button at the upper right inside the call interface.

Ringtone & Vibrate

Select Settings → Sound from application list.

You can set different ringtones for incoming calls. Select Phone ringtone to open a list of ringtones, select the desired ringtone, and then select OK to confirm.

Tap Vibrate when ringing to create a checkmark and the device vibrates to notify you of incoming calls.

Dial pad touch tones

Tap Dial pad touch tones to create a checkmark and your device will sound a tone once you tap the dial pad.

CONTACTS

Tap Contacts from application list to access the interface.

Add new contact

1. Access Contact.
2. Tap + icon(+).
3. Enter necessary fields.
4. Tap DONE.

Edit a contact

1. To edit a contact, scroll to the contact you want to change.
2. Tap the pen button at the upper right.
3. Change necessary fields.
4. Tap Save.

Create Label

1. Tap the option button at the upper left.
2. Tap Create label
3. Enter a category name
4. Tap OK

IMPORT /EXPORT CONTACTS

Import from SD/ SIM card

To copy the contacts from the SIM card/ SD Card, tap the option button at the upper left and then Settings → Import, and choose the location you want to import

Export to SD card

To export contacts from your device to a memory card, tap the option button at the upper left and then select Export → Export to SD card, select OK to confirm.

Search for contacts

Input the desired information at the upper bar of the contact interface, the result will be shown in the lower interface

MESSAGES

Learn to create and send a text or multimedia message, and view or manage messages that you have sent or received.

View messages

1. Tap Messages from application list.
2. Tap the message to view the detailed information.

Create and send SMS

1. Tap **Start Chat** button.
2. If you want to start a group chat, please press the "Create group" at the beginning, if no, please ignore this step.
3. In To field, enter the recipient's mobile phone numbers manually (You may also press the related contact to start the chat directly).

4. Then press the Send to... button.
(If you are creating a group, just press the OK/ tick icon inside the input interface)

5. In Type message, enter the text of the message.

6. Tap(+) ➤ to send the message.

Create and send MMS

Multimedia message can include pictures, sound and text.

1. Tap **Start Chat**

2. After enter the SMS interface, Tap (+) button at the title bar.

3. Select one of the items below.

Pictures: Insert image.

Capture picture: Capture new picture and insert it

Videos: Insert video clip.

Capture video: Capture new video clip and insert it

Record audio: Press and hold the mic icon to record sound, release the icon to end the recording

Tap ➤ to send the message.

GMAIL

Gmail is an easy to use email app that saves you time and keeps your messages safe. Get your messages instantly via push notifications, read and respond online & offline, find any message quickly and lots more.

Create a Gmail Account

If you don't have a Google Account, tap New, then follow the on- screen instructions to create a new one.

Set up a Gmail Account

If you want to add an existing account, tap Existing, enter your email address and password, and then select Next, when you are finished setting up the email account, the email messages are downloaded to your device.

View email messages

When you open the email account, the amount of unread email messages is displayed at the title bar and the unread email messages are displayed in bold.

Create and send an email

1. Tap the + icon.
2. In To field, enter the recipient's email addresses manually and separate them with a comma
3. Add more recipients by tapping Cc/Bcc.
4. To insert attachments, tap the paper icon button at the upper right and select Attach file.
5. Enter the subject and the text.
6. Tap **SEND** to send the email.

Google Play

Google Play is your entertainment unbound. It brings together all of the entertainment you love and helps you explore it in new ways, anytime, anywhere. We've brought the magic of Google to music, movies, TV, books, magazines, apps and games, so you get more from your content every day.

Note

All applications offered by Play Store are developed by third party. To get the information about the developers, you can read the descriptions of each application.

Our company is not liable for performance issues caused by third- party applications.