

Instructions

Maximum charge voltage DC 5V,
under 500mA for the build-in battery

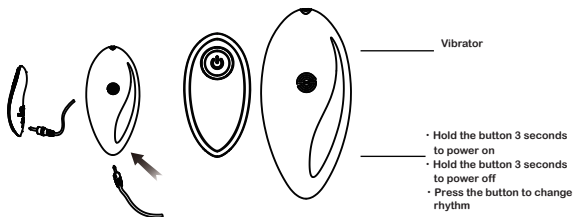

- Plug in the DC jack to recharge the build-in battery.
- Plug in the USB cable in to the power sources with appropriate adaptor or USB port from computer for recharging the vibrator.
- The LED light blinks when the vibrator is being charged.
- The LED light remains on when the vibrator is fully charged.

Warning: To Avoid Battery Leakage

- To recharge the vibrator, please only use the USB cable provided in the packaging.
- Please recharge the vibrator for 2 hours before initial usage.
- Do not short the terminals. Connection to improperly grounded equipment can result in short-circuit.
- Use of non-original manufacturer-approved accessories may damage the product and cause explosion.
- Recharge the vibrator at room temperature.
- Store in a cool and dry place.
- If terminals are soiled, clean with a soft cloth.
- Unplug the USB cable when the vibrator is not being recharged.
- Keep the vibrator from heat.
- Keep the vibrator out of reach of infants or children.
- Prolonged use is not recommended. When the vibrator gets warm, stop and cool the vibrator down before you use it again.
- Retain packaging and instructions for future reference.

This device complies with part 15 of the FCC Rules. Operation is subject to the following two conditions: (1) this device may not cause harmful interference, and (2) this device must accept any interference received, including interference that may cause undesired operation.

Any changes or modifications not expressly approved by the party responsible for compliance could void the user's authority to operate the equipment.

NOTE: This equipment has been tested and found to comply with the limits for a Class B digital device, pursuant to Part 15 of the FCC Rules. These limits are designed to provide reasonable protection against harmful interference in a residential installation. This equipment generates, uses and can radiate radio frequency energy and, if not installed and used in accordance with the instructions, may cause harmful interference to radio communications.

However, there is no guarantee that interference will not occur in a particular installation.

If this equipment does cause harmful interference to radio or television reception, which can be determined by turning the equipment off and on, the user is encouraged to try to correct the interference by one or more of the following measures:

- Reorient or relocate the receiving antenna.
- Increase the separation between the equipment and receiver.
- Connect the equipment into an outlet on a circuit different from that to which the receiver is connected.
- Consult the dealer or an experienced radio/TV technician for help.

The device has been evaluated to meet general RF exposure requirement. The device can be used in portable exposure condition without restriction

FCC ID: 2AG2KSV-12-BK