

THE **RABBIT**
COMPANY



BUTTERFLY
COLLECTION

OVERVIEW

All products by **The Rabbit Company™** are made from soft, smooth, body safe materials.

Our easy to use interface allows users to easily find the right stimulation and intensity. Get ready for sensual satisfaction that can not be matched and will have you craving for more.

THE REMOTE CONTROL BUTTERFLY PANTY VIBE



THE BUTTERFLY PANTY VIBE

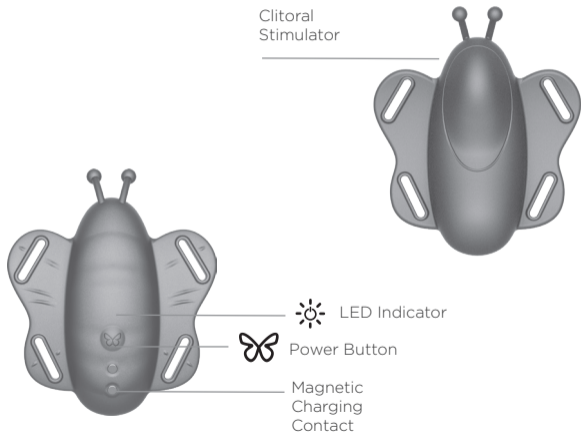

WIRELESS REMOTE CONTROL

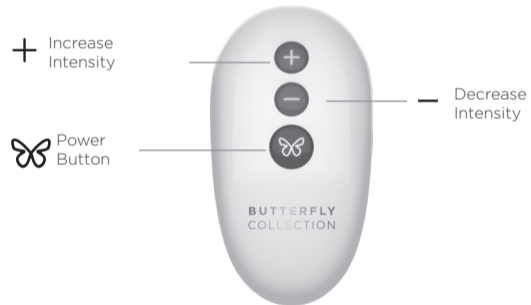

GETTING STARTED

1. Before first use, charge your butterfly vibe for approximately 1.5 hours. The USB charging cable can be plugged into any USB port or USB/AC power adapter (not included).

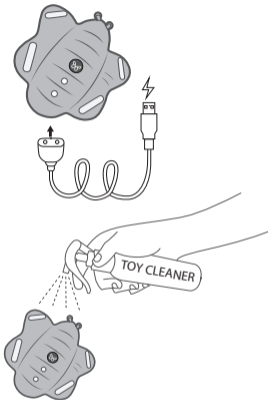

- Flashing Light = Charging
- Solid Light = Fully Charged
- Rapid Flashing Light = Low battery, charge is needed

2. Wash your butterfly vibe with soap and water, or toy cleaner suitable for use with silicone items.



3. Lubricate your butterfly vibe (if needed) with a water based, silicone compatible lubricant.

4. Turn ON your butterfly vibe by pressing  quickly. The light will flash, indicating the power is on and in standby mode.

Push  again on your butterfly vibe to use the manual mode, or push  on the remote to pair the remote & butterfly vibe.

Once in use, the light will change from flashing to solid.

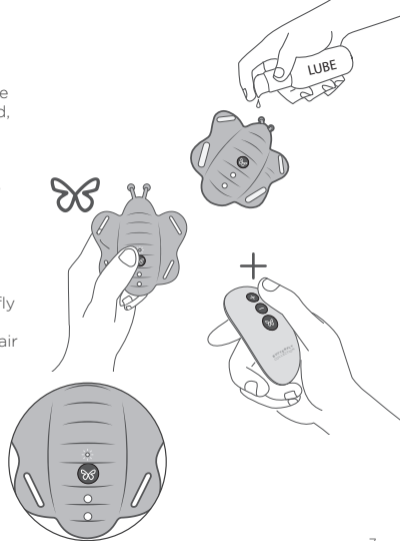

FAQs can be found at
www.TheRabbitCompany.com

Email us at
customercare@TheRabbitCompany.com
for any unanswered questions

5. To change the vibration pattern via manual control, press the .

6. To change the vibration intensity via the remote control press and release **+** (Increase Intensity) and **-** (Decrease Intensity).

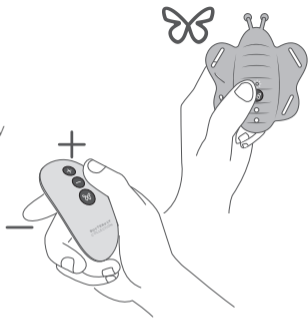



HOW TO USE YOUR BUTTERFLY PANTY VIBE

Assemble the three adjustable and removable waist and thigh straps (1xwaist, 2xthigh) to butterfly vibe, and dress up accordingly as photo shown while the ON/OFF button faces outside.



Adjustable harness included

MANUAL CONTROL

1. To turn the item ON quickly press  on your butterfly vibe. The  will flash to indicate the power is on. Push  again to change the vibration pattern. There are a total of 15 modes using the manual control.

2. To power OFF your butterfly vibe press  and hold for 2 seconds. LED will turn off to indicate the power is OFF.

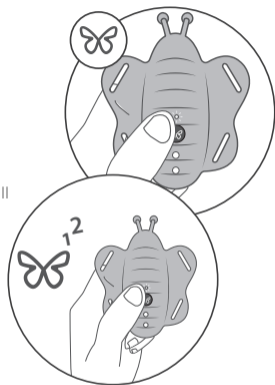

REMOTE CONTROL

1. First turn your butterfly vibe on in standby mode by quickly pressing  on your butterfly vibe.

2. While the light is flashing, press **+** to power on your remote and to pair the remote & butterfly vibe.



3. Once the item is paired, the light on the butterfly vibe () will become **solid** and you can control your butterfly vibe by remote.

4. Press and release **+** on the remote to increase vibration intensity.

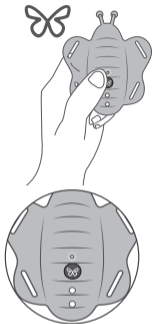
5. Press and release **—** on the remote to decrease vibration intensity.



6. To change the vibration pattern, press and release  on the remote.

7. Holding  for 3 seconds will pause vibration. Quickly pressing  resumes vibration.

8. To turn the item ON/OFF press and release  on the remote.

9. To completely turn off your butterfly vibe, press and hold  on your butterfly vibe.

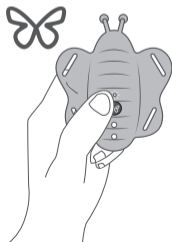

CHARGING

- Attach the magnetic charging plug to the designated charging area on the base of the product.
- Flashing light indicates item is charging
- Solid light indicates item is fully charged
- The butterfly vibe requires approximately **1.5** hours for full charge

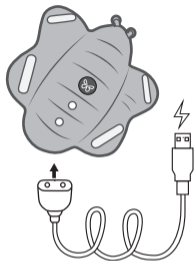

Flashing light = Charging



Solid light = Fully Charged



CHANGING YOUR REMOTE CONTROL BATTERY

- Use a coin to open the cover by placing it in the slit at the center of the battery cover. Rotate until the battery cover is removed. Open the battery compartment.
- Button cell CR 2032 has been preinstalled into the remote control.
- Remove the paper slip inside the battery compartment to activate the power in the remote control.
- Store the remote control and the battery separately to prolong the battery life.

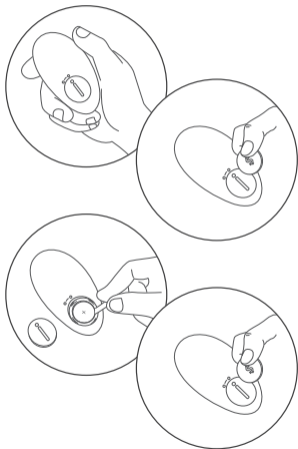

TRAVEL LOCK

The Rabbit Company™ items include a travel lock for safe and convenient travel.



For the remote:

Simultaneously press and hold the + and - buttons for 3 seconds. Flashing light will indicate the item is locked.

To unlock simply press and hold + and - again for 3 seconds. Flashing light will indicate lock is disabled.



For the butterfly vibe:

Hold  for 5 seconds, flashing light will indicate the item is locked. For unlocking, hold  again for 5 seconds, flashing light will indicate the item is unlocked.



VIBRATION PATTERNS

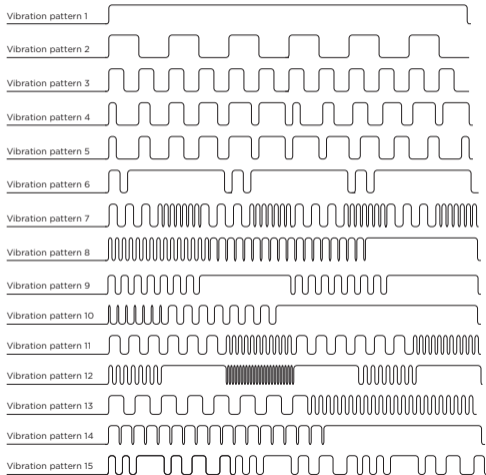

HARE CARE™

Cleaning, Storage & Safety

1. Always clean your butterfly vibe thoroughly before and after each use.
2. We recommend using a premium water-based lubricant when needed. Silicone-based lubricants are not recommended and can cause damage to the product. Never use hand cream, or massage oils as lubricants for your intimate areas.
3. To properly clean your butterfly vibe, use a suitable silicone-compatible toy cleanser. If this is not available, wash the silicone area of your butterfly vibe with luke-warm water and an antibacterial soap. Rinse clean and pat dry using a lint-free cloth or towel. Do not use cleaners containing alcohol, petrol or acetone.

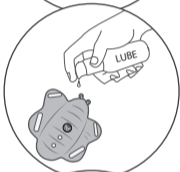

4. Avoid leaving your butterfly vibe in direct sunlight and never expose it to extreme heat.

5. Our products are designed to be splash-proof. Never immerse your butterfly vibe in water.

If your butterfly vibe appears to function abnormally, turn OFF and consult our customer care section on TheRabbitCompany.com where you will find help tips. Should you require further assistance please contact:

customercare@TheRabbitCompany.com

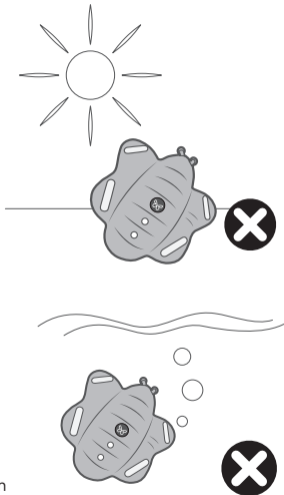

SPECIFICATIONS

Materials

Body Safe Abs / Silicone

Size

Butterfly: 58 x 72 mm

Remote: 37 x 69 mm

Weight

Butterfly: 40g

Remote: 20g

Battery

Li-ion 200 mAh

Charging

1.5 hours

Use Time

1 hour

Max Noise Level

<68 db

Interface

15 vibration patterns

DISPOSAL INFORMATION

Disposal of old electronic equipment (applicable in the EU and other European countries with separate waste collection systems):

The crossed-out dustbin symbol indicates that these items should not be treated as household waste, but rather brought to the appropriate collection point for recycling electrical and electronic equipment.



RoHS



RED DECLARATION

EC Declaration of Conformity

In accordance with EN ISO 17050-1:2004

We: XGEN, LLC

of: Horsham, PA 19044

in accordance with the following Directive(s)

2014/53/EU Radio Equipment Directive (RED)

hereby declare that:

Equipment: BUTTERFLY PANTY VIBE

Branded: 

Model No: TRC-030PUR

Is in conformity with the applicable requirements of the above directives and the following documents

ETSI EN300 220-1 V3.1.1(2017-02) **ETSI EN300 220-2 V3.2.1(2018-06)**

ETSI EN301 489-1 V2.2.3(2019-11) **ETSI EN301 489-3 V2.1.1(2019-03)**

EN62479:2010; EN50663:2017

Signed:

Name: G. Greene

Position: Manager

Date: 01 January 2021

SUPPLIER'S DECLARATION OF CONFORMITY

Brand name:  THE RABBIT
COMPANY

Product name: BUTTERFLY PANTY VIBE

Model No: TRC-030PUR

This device complies with part 15 of the FCC Rules. Operation is subject to the following two conditions: (1) This device may not cause harmful interference, and (2) this device must accept any interference received, including interference that may cause undesired operation.

Supplier's Name: XGEN, LLC

Supplier's Address: Horsham, PA 19044

Supplier's Phone number: 877-450-9436

Supplier's E-mail address: sales@xgenproducts.com

Caution!

Any changes or modifications not expressly approved by the party responsible for compliance could void the user's authority to operate the equipment.

FCC Statement

This equipment has been tested and found to comply with the limits for a Class B digital device, pursuant to part 15 of the FCC Rules. These limits are designed to provide reasonable protection against harmful interference in a residential installation. This equipment generates uses and can radiate radio frequency energy and, if not installed and used in accordance with the instructions, may cause harmful interference to radio communications. However, there is no guarantee that interference will not occur in a particular installation. If this equipment does cause harmful interference to radio or television reception, which can be determined by turning the equipment off and on, the user is encouraged to try to correct the interference by one or more of the following measures:

- Reorient or relocate the receiving antenna.
- Increase the separation between the equipment and receiver.
- Connect the equipment into an outlet on a circuit different from that to which the receiver is connected.
- Consult the dealer or an experienced radio/TV technician for help.

This device complies with FCC radiation exposure limits set forth for an uncontrolled environment.

This device complies with Part 15 of the FCC Rules. Operation is subject to the following two conditions: (1) this device may not cause harmful interference, and (2) this device must accept any interference received, including interference that may cause undesired operation.

IMPORTANT SAFETY INFORMATION



- Do not expose this product to fire or water.
- Disposal of a battery into fire or a hot oven, or mechanically crushing or cutting of a battery, that can result in an explosion.
- Leaving a battery in an extremely high temperature surrounding environment that can result in an explosion or the leakage of flammable liquid or gas.
- A battery subjected to extremely low air pressure that may result in an explosion or the leakage of flammable liquid or gas.
- Do not attempt to disassemble the product yourself. Please contact after-sales service if there is an issue.
- The battery used in this product is a non-chargeable battery. Do not try to charge it.
- This product contains small parts such as battery, battery cover. The small parts are not toys, do not allow children to play with them to prevent the risk of suffocation.
- Risk of safety issue if the battery is replaced by an incorrect type.
- Replacement of a battery with an incorrect type that can defeat a safeguard.
- Dispose of used batteries according to instructions.
- Do not ingest battery. Chemical Burn Hazard!
- This product contains a coin/ button battery. If the coin/ button cell is swallowed, it can cause severe internal burns in just 2 hours and can lead to death.
- Keep new and used batteries away from children.
- If the battery compartment does not close securely, stop using the product and keep it away from children.
- This product contains a battery that is hazardous and is to be kept away from children. The battery can cause serious injuries if it is swallowed or placed inside any part of the body. Seek medical attention immediately if it is suspected the battery has been swallowed or placed inside any part of the body.

Complete user instructions in additional languages can be found at:

www.TheRabbitCompany.com

Sold as a novelty only. Made and packed in China. All rights reserved. The shape and appearance of the products in this guide are a trademark and trade dress of B.C.B.V.I

Visit www.trcpatents.com for more info.

Designed and Developed by
The Rabbit Company™

Made in China
© The Rabbit Company™

FAQs can be found at
www.TheRabbitCompany.com

Email us at
customercare@TheRabbitCompany.com
for any unanswered questions

TheRabbitCompany.com