

Icon Instruction

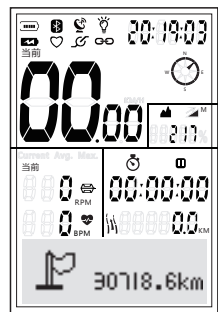

Battery Status	Cadence Sensor Connected	Compass	Total Riding Distance
Charging Indication	Speed Sensor Connected	Altitude	Total Riding Time
Bluetooth Connected	Smart Light Connected	Stop	Total Calories
Heart Rate Sensor Connected	Cadence Sensor Connected	Timer	Total Track Counts
GPS Signal	Speed Sensor Connected	Single Track	

Button Instruction

ON/OFF Button Operation



ON/OFF

Keep pressing ON/OFF button, power-on/power-off

Button Instruction

SET Button Operation



SET



Press SET button to switch total riding distance, total riding time, calories and total track counts display circularly.
Keep pressing SET button to start/stop single trip recording.

Button Instruction

MODE Button Operation



MODE

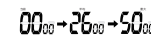

Press MODE button to switch Current/Average/Top Speed, Cadence and Heart Rate value display.
Keep pressing MODE button to reset Current/Average/Top Speed, Cadence and Heart Rate value.

Button Instruction

SET + MODE Buttons Operation



SET

MODE

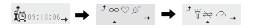

Press MODE and SET buttons more than 2 seconds. Enter or exit setting mode.

Parameter Setting

- Wheel Circumference Setting: Press MODE button to move cursor under digits, press SET button to change value.
- Clock Setting: Press MODE button to move cursor under clock digits, Press SET button to change values.
- Sensor Binding / Unbinding: Press MODE button to move cursor under a sensor icon, press SET button to unbind the sensor and main unit begins to search new sensor for binding.
- Backlight Setting: Press MODE button to move cursor under LCD icon, press SET button to turn on/off the backlight.
- Smart Light On/Off Setting: Press MODE to switch to Smart Light icon, press SET to turn on or off the light.
- Body Weight Setting: Press MODE button to move cursor under digits, press SET button to change value.
- Kilometers / Miles Setting: Press MODE button to select KM/H or MPH, Press SET button to confirm.

Installation

Main Unit Installation

- Fix the bracket to the handlebar on either side of the stem, tighten the bracket on the handlebar with rubber belt.
- Tighten the rubber belt on the bracket.
- Aim the main unit toward the base.
- Slide the main unit into the bracket and tight it up.

Installation

Speed Sensor Installation



1 Fix the speed sensor to the front hub and keep it in balance.



2 Tighten the silicon rubber case.

Cadence Sensor Installation



1 Put the cadence to the left crank arm.



2 Tighten the rubber ring around crank, fix the cadence sensor.

Operation

Start/Stop GPS track record



Keep pressing SET button to start / stop GPS track record.

Front Light Operation



Press the ON/OFF button to switch the bike front light working mode (high-standard off) when power-on.

Auto Light Output Downshift

If battery power is lower than 10%, light output downshifts automatically avoiding the danger of riding in darkness caused by sudden light off.

Front Light Turning Off Forcedly

If battery power is lower than 5%, front light turned off forcedly, bike computer keeps working with remaining capacity.

APP Operation

Add a device



We suggest that keep Discovery close to the smart phone, and select a device with strongest signal on APP.

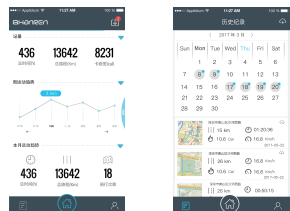

Track download from Discovery main unit

Track upload to server

Smart Warning Light



Smart warning light has two working mode:
1 light color changed according to speed
2 breathing light. Users can change colors breathing light on APP

Corresponding Wheel Size Diagram

ETRTO	Wheel Size	Perimeter(mm)	ETRTO	Wheel Size	Perimeter(mm)
47-203	12 x 1.75	935	58-590	26 x 1 1/8	1970
54-203	12 x 1.95	940	37-584	26 x 3/8	2068
40-254	14 x 1.5	1020	37-590	26 x 3/8	2068
47-254	14 x 1.75	1055	37-584	26 x 1/2	2100
40-305	16 x 1.75	1185	20-571	650C tubular 26 x 7/8	1920
47-305	16 x 1.90	1195	25-571	650 x 25C	1938
54-305	16 x 1 1/8	1245	45-514	650 x 25C (650 x 1071)	1952
28-349	16 x 1 3/8	1290	40-590	650 x 38A	2125
37-349	17 x 1 1/4	1300	40-584	650 x 38B	2105
33-369	18 x 1.50	1340	25-630	27 x 1 (630)	2145
40-355	18 x 1.75	1350	28-630	27 x 1 1/8	2155
47-355	20 x 1.25	1450	32-630	27 x 1 1/4	2161
32-406	20 x 1.35	1460	37-630	27 x 1 3/8	2169
35-406	20 x 1.50	1490	40-584	27.5 x 1.50	2079
40-406	20 x 1.75	1515	54-584	27.5 x 2.1	2148
50-406	20 x 1.95	1565	57-584	27.5 x 2.25	2162
28-451	20 x 1 1/8	1545	40-635	28 x 1 1/2	2246
37-451	20 x 1 3/8	1615	18-622	700 x 19C	2070
37-501	22 x 1 3/8	1770	18-622	700 x 19C	2080
40-501	22 x 1 1/2	1785	25-622	700 x 25C	2096
47-507	24 x 1.75	1890	25-622	700 x 25C	2096
50-507	24 x 2.00	1925	30-622	700 x 30C	2146
54-507	24 x 2.125	1965	34-622	28 x 1.25, 700 x 32C	2130
25-520	24 x 1 (520)	1783	35-622	700C tubular	2168
28-540	24 x 1 1/8	1795	37-622	28 x 1.40, 700 x 35C	2180
32-540	24 x 1 1/4	1805	44-622	28 x 1.50, 700 x 40C	2218
37-540	24 x 1 3/8	1932	48-622	28 x 1.75, 700 x 45C	2256
47-507	24 x 1.75	1888	47-522	2.8 x 1.75, 700 x 45C	2280
25-559	26 x 1 (559)	1913	54-622	29 x 2.00	2288
32-559	26 x 1.25	1950	56-622	29 x 2.25	2303
37-559	26 x 1.40	2005	58-559	26 x 2.25	2303
40-559	26 x 1.50	2010	60-522	29 x 2.35	2330
42-559	26 x 1.60	2020			
47-559	26 x 1.75	2023			
50-559	26 x 1.95	2050			
50-559	26 x 2.00	2050			
54-559	26 x 2.10	2068			
57-559	26 x 2.125	2070			
57-559	26 x 2.25	2070			
58-559	26 x 2.35	2083			
75-559	26 x 3.00	2170			

Specification

Mode:	SR-BLC30
Communication mode:	Bluetooth smart
Front Light Brightness:	800lm
Lighting Mode:	High Standard
Front Light Working Time:	3hrs/hrs
Computer Working Time:	80hrs
Battery Capacity:	2800mAh
Charging Time:	2hrs (5V/1.5A)
Weight:	155g

Speed	Cadence	Trip Distance	Calorie	LED Front Light
Altitude	Gade	Warning Light	Compass	Clock
Heart Rate	GPS Tracking	GPS Positioning	APP Support	LCD Backlight
Auto Wake Up	Data Analysis	Data Statistics	Data Storage	Data Upload

Warranty Card

Main unit, speed sensor and cadence sensor are covered under 1 year's warranty. Accessories excluded.

Each product unit is warranted to be free of factory defects for 1 year from original purchase. If the product fails to work through normal usage, we will repair or replace the defect at no charge. Service must be performed by an authorized Shanren dealers or an authorized Shanren retailers. To return the product, enclose its warranty card together with details about its dis-function. Please type your name and address clearly on the warranty card.

Insurance and transportation charges shall be born by the party requesting service.

Thanks for understanding.

User name: _____
 Address: _____
 Telephone: _____
 Order No.: _____
 Commodity name and specification: _____
 Dealer name: _____
 Purchasing date: _____

Shanren International Co., Limited
 103, Hang Seng Monjok Building, 677 Nathan Road, Kowloon, Hong Kong
 Email: sales@shanrentech.com
 Website: www.shanrentech.com
 Made in China

Federal Communications Commission (FCC) Statement

This device complies with part 15 of the FCC Rules. Operation is subject to the following two conditions: (1) This device may not cause harmful interference, and (2) this device must accept any interference received, including interference that may cause undesired operation.

Note: This equipment has been tested and found to comply with the limits for a Class B digital device, pursuant to part 15 of the FCC Rules. These limits are designed to provide reasonable protection against harmful interference in a residential installation. This equipment generates, uses and can radiate radio frequency energy and, if not installed and used in accordance with the instructions, may cause harmful interference to radio communications. However, there is no guarantee that interference will not occur in a particular installation. If this equipment does cause harmful interference to radio or television reception, which can be determined by turning the equipment off and on, the user is encouraged to try to correct the interference by one or more of the following measures:

- Reorient or relocate the receiving antenna.
- Increase the separation between the equipment and receiver.
- Connect the equipment into an outlet on a circuit different from that to which the receiver is connected.
- Consult the dealer or an experienced radio/TV technician for help.

Warning: Changes or modifications made to this device not expressly approved by SHENREN SHANREN TECHNOLOGY CO.,LTD may void the FCC authorization to operate this device.

Note: The manufacturer is not responsible for any radio or TV interference caused by unauthorized modifications to this equipment. Such modifications could void the user's authority to operate the equipment.

IC Statement: This device complies with Industry Canada licence-exempt RSS standard(s). Operation is subject to the following two conditions: (1) this device may not cause interference, and (2) this device must accept any interference, including interference that may cause undesired operation of the device.

Le présent appareil est conforme aux CNR d'Industrie Canada applicables aux appareils radi o exempts de licence. L'exploitation est autorisée aux deux conditions suivantes : (1) l'appareil n e doit pas produire de brouillage, et (2) l'utilisateur de l'appareil doit accepter tout brouillage radioélectrique subi, même si le brouillage est susceptible d'en compromettre le fonctionnement.