



AVM700UI

QUICK START GUIDE

Media Receiver with Bluetooth and SiriusXM-Ready[™]
featuring 7" Touch Screen Display.

This Quick Start Guide gives you the basics to start using your AVM700UI. Please visit www.axxeraaudio.com/support/manuals.php to download a complete owner's manual or call customer service at 1-866-382-5476 (Monday-Friday, 9AM-5PM EST).



Customer Service Toll Free: 1-866-382-5476

Installation

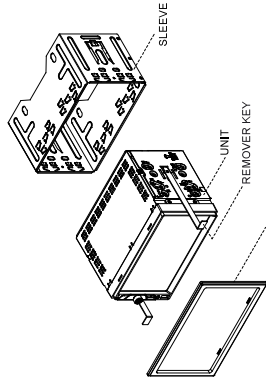

TYPICAL FRONT-LOAD DIN MOUNTING METHOD

Copyright and Trademark Notice
SD Logo is a trademark of SanDisk, LLC.
Android is a trademark of Google Inc.
Other trademarks and trade names are based on their respective owners.
Sirius and SiriusXM are registered trademarks owned by Sirius XM Radio, Inc. All rights reserved.
Google Assistant and Android are registered trademarks owned by Google LLC.

Wiring Diagram - Inputs/Outputs

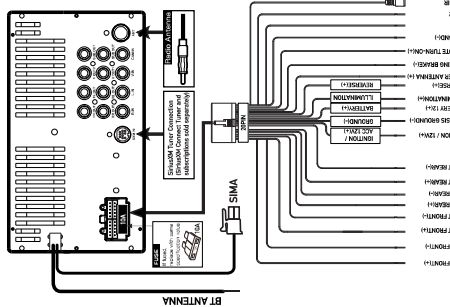

Control Locations



- 1. IR sensor
- 2. MIC
- 3. Short Press-Mode change
- 4. Paper/Track Up
- 5. Volume/Power/Mode
- 6. Tune/Track Down
- 7. microSD card slot
- 8. Reset
- 9. AUX
- 10. USB port

Remote Control



Main Menu

In main menu, press the desired icon to enter the corresponding mode: Radio, SiriusXM[™], USB Screen Mirroring, SD Card, BT Phone, BT Music, Camera, Aux In, AV In, Settings.

Radio Operation

Select the Radio icon from the Main Menu screen or press MODE until Tuner is selected.

- 1. Current Mode Indicator
- 2. Information Display
- 3. Tune Up
- 4. Presets
- 5. AS/PS
- 6. Stereo
- 7. Local/Distance
- 8. Band
- 9. Tune Down

SiriusXM[™] Operation

- 1. Band
Displays SiriusXM[™] radio band currently selected. Preset channels are available: SM4, SM7, SM12, and SM25.
- 2. Search
Press this icon to search channels by category.
- 3. Channel List
Press this icon to see the preset channels per band.
- 4. Live channel
Go to Live channel.
- 5. Channel Up
Press this icon to select station forward manually.
- 6. Channel Down
Press this icon to select station backward manually.
- 7. Skip forward
Tap this icon to skip to the beginning of the current song or prior songs. Press and hold to fast-rewind.
- 8. Pause
Press this icon to pause the audio.
- 9. Skip backward
Tap this icon to skip to the beginning of the current song or prior songs.
- 10. Preset
Press and hold to add the current channel to a preset. Tap to recall the preset.
- 11. Content Info
Press Song icon to cycle through song, content info and description link.

General Operation

- Press the function icons to select in Settings
- 1. Screen Dimmer
 - 2. Voice Activation
 - 3. Audio
 - 4. Nav/ hot button
 - 5. Settings

Audio Operation

- Press Sound Effect icon to setup menu to select Preset, 7-band tone control, Surround and Balance.
- 1. EQ Setting
 - 2. Surround Setting
 - 3. Balance

Screen Operation

In Settings menu press one of options to adjust the screen condition.



Speaker Zone Operation

- Zone 1 Button
Press Zone 1 to turn the sound from Zone 1 on or off.
- Zone 2 Button
Press Zone 2 to turn the sound from Zone 2 on or off.

Bluetooth Operation

The microphone is hidden in the receiver.

Pairing and Connecting
Make sure that Bluetooth is activated on your device before you begin the pairing process. The AVM700UI will automatically discover and pair with devices that are currently connected. Complete the pairing sequences from your Bluetooth device. The device name is "AVM700UI". The unit can be in any mode of operation when pairing is performed. On certain phones, pairing may need to be done more than once.

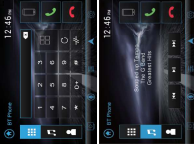

- Dialing a Number**
Press **DISK** to connect a call, and press **NUM** to end a call.
- Making and Ending a Call**
Press **NUM** to transfer audio between the head unit and mobile phone.
- Streaming Audio**
Press **MUSIC** to play or pause the music.
- Press **DISK** to go back to the previous track.
- Press **NUM** to advance to the next track.

Voice Activation Operation

Bluetooth should be paired between your smartphone and the receiver. Press the voice activation button **VA** and the receiver will switch into Bluetooth mode. This will activate Siri[®] or Google Assistant[™] on your smartphone. You will need to manually switch back to the previous or desired mode once this operation is terminated.

On-screen Nav/ App Operation

Activation of Axxera Smart App should not be asked, but open on your smartphone for this operation. Touching **VA** will guide you instant access to your favorite navigation App on your smartphone. Please refer to the complete manual on www.axxeraaudio.com/support/manuals.php.

APP Operation

The Axxera Smart App is the ultimate wireless remote control for your AVM700UI receiver. You can download Axxera Smart App from Apple App Store or Google Play Store and install it on your smartphone or tablet. Please scan the following QR code to download Axxera iRig P1 App to your smart phone.



USB Screen Mirroring Operation

See the Owner's Manual for details.

Note:
Operating system updates from Apple and Android may cause issues with your receiver not to function properly. This can usually be fixed by going to the manufacturer's website to check for updates. To see if your receiver has the latest firmware, contact customer service at 1-866-382-5476 to see if your radio needs an update.



One-Year Limited Warranty

This warranty gives you specific legal rights. You may also have other rights which vary from state to state. This warranty is limited to the original purchaser. It is void if the receiver is damaged, modified, misused, used in a manner for a period of one year from the date of the original purchase. Certain accessories and components, such as cables and/or car kits are not covered by this warranty. Axxera Audio is not responsible for any damage to the receiver or accessories, including but not limited to, theft, fire, flooding, or damage to property. Axxera Audio is not responsible for any damage to property, including but not limited to, theft, fire, flooding, or damage to property. Axxera Audio is not responsible for any damage to property, including but not limited to, theft, fire, flooding, or damage to property. Axxera Audio is not responsible for any damage to property, including but not limited to, theft, fire, flooding, or damage to property.

- 1. Please call for service. Check the troubleshooting guide in your owner's manual. A slight adjustment of any preset and step (by equal temperament) with a copy of the original receipt from the dealer to an authorized Axxera Audio representative in writing and include your name, a return UPS shipping address (R/O. Box not allowed), a return label and a return receipt. A return label and a return receipt are required. For more information and for the location of the nearest authorized service center please contact us by one of the following methods:
support@axxeraaudio.com
(Monday-Friday, 9:00 am to 5:00 p.m. EST)
- 2. If you cannot access our website, please contact us by one of the following methods:
1-866-382-5476
800-368-5476
- 3. Please describe your problem in writing and include your name, a return UPS shipping address (R/O. Box not allowed), a return label and a return receipt. A return label and a return receipt are required. For more information and for the location of the nearest authorized service center please contact us by one of the following methods:
support@axxeraaudio.com
(Monday-Friday, 9:00 am to 5:00 p.m. EST)
- 4. For more information and for the location of the nearest authorized service center please contact us by one of the following methods:
support@axxeraaudio.com
(Monday-Friday, 9:00 am to 5:00 p.m. EST)

FCC Compliance

This device complies with Part 15 of the FCC Rules. Operation is subject to the following two conditions:
(1) This device must not cause any interference received, including interference that may cause undesired operation.
(2) If this device does cause interference, the user must be advised to stop using the device. It is the user's responsibility to take corrective action.
Note: This equipment has been tested and found to comply with the limits for a Class B digital device, pursuant to Part 15 of the FCC Rules, which limit the radio frequency energy that they can emit from this equipment to prevent interference with residential installations. This equipment generates, uses and can radiate radio frequency energy and, if not installed and used in accordance with the instructions, may cause interference to radio reception. However, there is no guarantee that interference will not occur in a particular installation. If this equipment does cause interference to radio reception, which can be determined by turning the equipment off and on, the user is encouraged to try the following steps to resolve the interference:
• Reorient or relocate the receiving antenna.
• Increase the separation between the equipment and the receiver.
• Connect the equipment into an outlet on a circuit different from that to which the receiver is connected.
• Consult the dealer or an experienced radio/TV technician for help.

www.axxeraaudio.com
Customer Service Toll Free:
1-866-382-5476