

Product Configuration

- Keyco Mini
- Key Ring
- Quick Start Guide

Name of Components

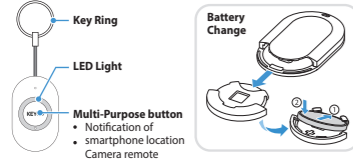

Things to Know before Usage

- Use the product only in the country where it is purchased. Performance and quality of the product are not guaranteed in other countries.
- Due to the characteristics of Bluetooth technology, the distance that can be connected to a smartphone may vary according to the user environment.
- The actual components may differ from the illustration.
- The appearance and specifications of the product is subject to change without notice to improve performance.
- This product is optimized for Google Android 4.4 or higher and Apple OS 8.0 or higher.
- Battery (CR2016) can be replaced, and the life-cycle of battery is about 6 months.
- Battery consumption may vary depending on the conditions of use and the environment.

Detailed use of each function can be found in the manual in the Keyco Finder app or the homepage.

- Keyco Finder app → Menu button (☰) → Tap **User Manual**
- www.keycofinder.com

How to install Keyco Finder app

You must install the Keyco Finder app to use the Keyco Mini.

- 1 Access the **Play store** on your smartphone.
 - For iPhone users, access the **App Store**.
- 2 Type **'Keyco Finder'** in the search box.
- 3 Select Keyco Finder in the list, and tap **Install**.

How to Connect to your Smartphone

First, you must register the product on the Keyco Finder app to use the Keyco Mini.

- 1 Run **'Keyco Finder'** on your smartphone.
- 2 Tap **Next** then select the **Keyco Mini** on the screen.
- 3 Follow the guide on the screen to register the Keyco Mini.

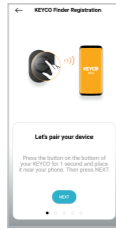

Main Features

<h4>Finding a Lost Item</h4> <p>Identify the location of Keyco Mini which is attached to people, pets and items in a near distance with a sound.</p> <p>▶ Press button on the smartphone</p>	<h4>Out of Range Alarm</h4> <p>Prevent loss by emitting a sound when the smartphone and Keyco Mini are separated for more than a certain distance (around 10 m)</p> <p>▶ Setting 'Out of Range Notification'</p>
<h4>Indicating a Last Location</h4> <p>Identify the location where the item to which the Keyco Mini is attached is lost on the map in the Keyco Finder app</p> <p>▶ Check the map on the smartphone</p>	<h4>Into Range Alarm</h4> <p>A sound is emitted to notify that the Keyco Mini registered to the smartphone is within a certain range</p> <p>▶ Setting 'Into Range Notification'</p>
<h4>Finding a Smartphone</h4> <p>Identify the location of a smartphone by sounding an alarm when the smartphone to which the Keyco Mini was registered is not visible</p> <p>▶ Press the Multi-Purpose button on the Keyco Mini</p>	<h4>Camera Button</h4> <p>When using a camera on the Keyco Finder app, photos and/or videos can be taken by pressing the button on the Keyco Mini</p> <p>▶ Tap on Keyco Finder</p>

Safety Precautions

- ⚠ Caution**
- Failure to comply with the below may result in injury to the user or failure/malfunction of the product.
- Do not disassemble, repair, or modify the product without the assistance of an authorized technician.
 - Care should be taken not to let children or pets suck or bite the product.
 - Do not bend the product excessively or subject the product to impacts.
 - Do not use while pressing yourself against metal. Due to the sensitivity of wireless products to frequency bands, the reception may become poor or disconnection from the mobile phone may occur.
 - Do not use for purposes other than the instructed function.
 - Avoid exposing the product to water.
 - Check positive and negative poles of battery to replace the battery with new one.
 - Do not use the battery other than specified by the standards.
 - Please dispose of this product at your local collection point for recycling electrical and electronic equipment.

Product Specification and Certification

Rated Voltage	3V
Communication Method	2.4 GHz ISM Band Bluetooth Low Energy 4.2
Dimension	39.0 x 25.0 x 5.65 (mm)
Battery	CR2016 Coin Type Lithium Battery (replaceable)
Operating Temperature	-10 °C - 50 °C



FCC Operation Guide

- THIS DEVICE COMPLIES WITH PART 15 OF THE FCC RULES. Operation is subject to the following two conditions:
- (1) This device may not cause harmful interference, and
 - (2) This device must accept any interference received, including interference that may cause undesired operation.

User's Caution Statement

Any changes or modifications to the equipment not expressly approved by the party responsible for compliance could void user's authority to operate the equipment.

FCC Compliance statement

This equipment has been tested and found to comply with the limits for a Class B digital device, pursuant to part 15 of the FCC Rules. These limits are designed to provide reasonable protection against harmful interference in a residential installation. This equipment generates, uses and can radiate radio frequency energy and, if not installed and used in accordance with the instructions, may cause harmful interference to radio communications. However, there is no guarantee that interference will not occur in a particular installation. If this equipment does cause harmful interference to radio or television reception, which can be determined by turning the equipment off and on, the user is encouraged to try to correct the interference by one or more of the following measures:

- Reorient or relocate the receiving antenna.
- Increase the separation between the equipment and receiver.
- Connect the equipment into an outlet on a circuit different from that to which the receiver is connected.
- Consult the dealer or an experienced radio/TV technician for help.

Warranty

- This product is a product of SoluM Co., Ltd.
- This product is shipped after internal quality control and inspection.
- The warranty period of this product is 1 year. If defects or failure of the product occurs within 1 year, it will be repaired or replaced free of charge, unless the defects or failure have occurred due to the negligence of the user.
- This product is a short-range wireless communication product using Bluetooth, and no distance for connection is guaranteed.
- Repair is not free of charge in the cases below, even within the warranty period.
 - Failure or damage due to the mishandling, deliberate actions, or negligence (dropping, impact, breakage, submergence, etc.) of a user
 - Failure or damage due to disassembly, repair or modification by the user
 - Failure or damage due to usage for purposes other than the original function
 - Failure or damage due to uncontrollable environmental factors (earthquake, fire, flood, lightning, etc.)

Fill out the warranty below at the time of purchase. The warranty will not be reissued in the event of loss.

Model Name	TBHH01AFO
Product Name	Keyco Mini
Date of Purchase	
Vendor	
Warranty Period	1 year
Manufacturer / Country of Manufacture	SoluM Co., Ltd. (Korea) / China

Inquiry Regarding Service

If you have any difficulty in using Keyco, please refer to this manual. For further questions and technical support, please contact us to visit our website on www.keycofinder.com/support.

SoluM



Quick Start Guide

www.solu-m.com

