

Bluetooth Keyboard Case Connect Step

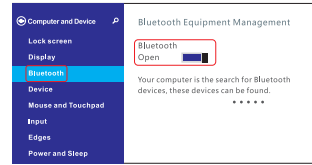

1. Open you tablet /pc, Go to " settings" and click to opened.



2. Turn to the "Bluetooth" click to searching.



3. Open the power switch keyboard



4. Press the Fn + ESC combination of code the key, blue for code light is lit up.

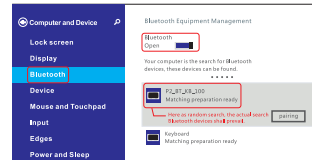

5. Tablets found bluetooth keyboard, "BT3.0 the rid_device_info_keyboard " namely the pop-up tip matching PIN.

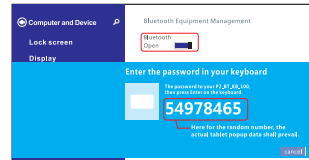

6. In accordance with the tablet prompt, Enter pairing password and press Enter; Linking to code is successful, can start using.

Troubleshooting

Please contact the after-sales service

Copyright

It is forbidden to reproduce any part of this quick start guide without the permission of Seller

Safety instructions

Do not open or repair this device. Do not use the device in a damp environment. Clean the device with a dry cloth.

Warranty

The device is provided with one-year limited hardware warranty from the purchase day.

Technical specifications

Keyboard size: 258.28X173.28X5.0mm

Working voltage:3.3-4.2V

Touch panel size: 72.25X39.7mm

Charge current: 150MA

Operating distance: 10 m

Standby current: 0.2MA

Weight : 420g

Dormancy current: 100UA

Apply to system : WIN8 (Surface plate) 、 WINXP、 WIN8 (HP WIN8.1) 、 WIN7

Charging method

1. When power is low the red light will flash, Keyboard should be put to charge. after charging full, the red light goes out.

Tips: if Keyboard is not used for long time, turn off the power switch. In order to extend battery life.

10.1" Bluetooth Keyboard Folio

Quick Start Guide



G1405

Caution : To properly operate this product , please read the user manual thoroughly.



1. Open the keyboard package;



2. The keyboard after folding package, as shown;



3. Open the tablet in the holster fixed position, power supply, follow the instructions step connecting bluetooth;



4. Holster fold after you use it, as shown, and shut off the power.

TouchPad function



One finger click -left mouse



Two finger click- right mouse



Two finger stretch ---Zoom



Three finger click -middle button



Two finger slide -mouse wheel



Two finger slide left/right -back/forward



One finger swipe down from the top edge - toggle the app

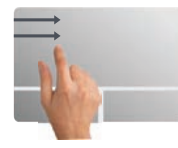

One finger swipe in from the left edge - switch to last application

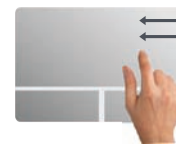

One finger swipe in from the right edge - toggle the charm

Product features(Fn+)

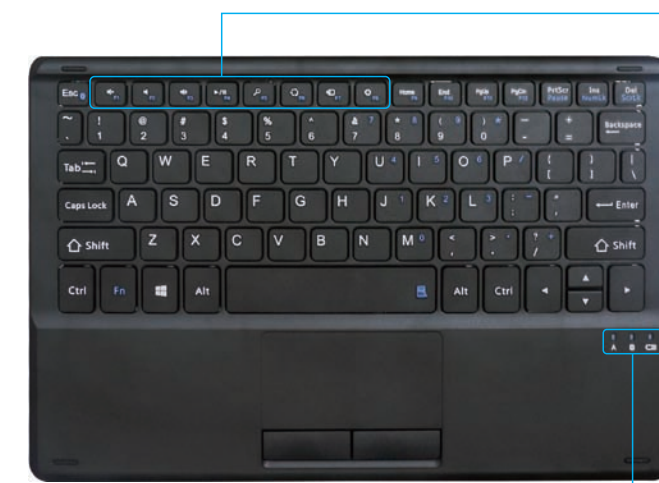

- F1 Mute
- F2 Volume Decrease
- F3 Volume Increase
- F4 Play/Pause
- F5 Web Search
- F6 Share
- F7 Device
- F8 Set up
- Fn + Esc Bluetooth connection

A Caps lock light Bluetooth light Power light

FCC Warning:

This equipment has been tested and found to comply with the limits for a Class B digital device, pursuant to part 15 of the FCC Rules. These limits are designed to provide reasonable protection against harmful interference in a residential installation. This equipment generates, uses and can radiate radio frequency energy and, if not installed and used in accordance with the instructions, may cause harmful interference to radio communications. However, there is no guarantee that interference will not occur in a particular installation. If this equipment does cause harmful interference to radio or television reception, which can be determined by turning the equipment off and on, the user is encouraged to try to correct the interference by one or more of the following measures:

- o Reorient or relocate the receiving antenna.
- o Increase the separation between the equipment and receiver.
- o Connect the equipment into an outlet on a circuit different from that to which the receiver is connected.
- o Consult the dealer or an experienced radio/TV technician for help.

Caution: Any changes or modifications to this device not explicitly approved by manufacturer could void your authority to operate this equipment.

This device complies with part 15 of the FCC Rules. Operation is subject to the following two conditions: (1) This device may not cause harmful interference, and (2) this device must accept any interference received, including interference that may cause undesired operation. The device has been evaluated to meet general RF exposure requirement. The device can be used in portable exposure condition without restriction.