

2.4G Wireless Keypad B038 User Manual

Notice:Please read user manual carefully before you start using this product.

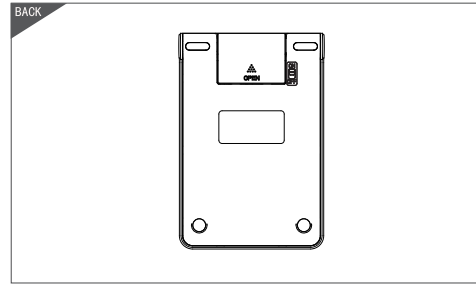
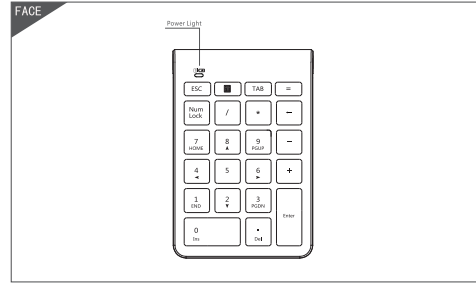

Remark:Please according to the battery plus and minus to install batteries,please don't charging the batteries,please don't thrown in the fire,please don't mixture different types batteries or old and new batteries.in order to avoid battery leakage. Please put the battery in a cool and dry place and keep away from children;please take out the battery if the electrical appliance long time out of use.

• Connection Instructions:

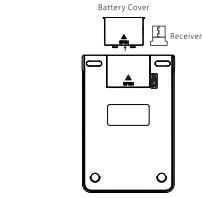

1.Open the battery compartment cover, you will see the battery compartment and usb receiver

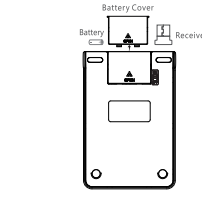

2.Install 2*AAA battery and battery compartment cover correctly.

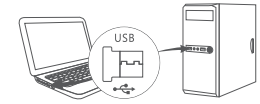

3,Place 2.4G Nano receiver into USB port of your computer

Technical Specifications

- Keypad size: 129.9 X84.2X14mm
- Weight: 93g
- Key: 22 keys
- Working voltage : 1.5V
- Working current use key: <4mA
- Working distance :8 m
- Sleep current : 0.028 mA
- Sleep time :8 minutes
- Standby current: 1.27mA (Light on)
- Awake way : Press key

LED light display status:

- keypad indicator light: NUM indicator light color(Green), Power indicator light color(Red)
- Low voltage status: when the working voltage below 0.9V, the red indicator light blink.

Any question, please contact the after-service team.

Copyright

It is forbidden to reproduce any part of this quick start guide without the permission of seller.

Safety instructions

Do not open or repair this device, Do not use the device in a damp environment. Clean the device with a dry cloth.

Keypad Maintenance

1. Please keep the keypad away from liquid or humid environment,saunas,swimming pool,steam room and don't let the keypad get wet in the rain.
- 2.Please don't expose the keypad at too high or too low temperature condition.
- 3.Please don't put keypad under sun for a long time.
- 4.Please don't put keypad close to the flame,such as cooking stoves,candles or fireplace.
- 5.Avoid sharp objects scratching products,timely to recharge or replace the dry cell products to ensure the normal use.

FAQ

- 1.The 2.4G Nano receiver unrecognized?
If the 2.4G Nano receiver unrecognized,please check the USB interface is functioning.
- 2.Why the red light always twinkle when in use?
The keypad red light always twinkle when in use,indicates low power of battery,please change new battery quickly.
- 3.The device display the 2.4G Keypad is disconnecting?
The 2.4G wireless keyboard after some time later not used, the tabler PC will go dormant mode to save battery power,Press any key to awake the device.

FCC Statement

Changes or modifications not expressly approved by the party responsible for compliance could void the user's authority to operate the equipment.
This equipment has been tested and found to comply with the limits for a Class B digital device, pursuant to Part 15 of the FCC Rules. These limits are designed to provide reasonable protection against harmful interference in a residential installation. This equipment generates uses and can radiate radio frequency energy and, if not installed and used in accordance with the instructions, may cause harmful interference to radio communications. However, there is no guarantee that interference will not occur in a particular installation. If this equipment does cause harmful interference to radio or television reception, which can be determined by turning the equipment off and on, the user is encouraged to try to correct the interference by one or more of the following measures:
– Reorient or relocate the receiving antenna.
– Increase the separation between the equipment and receiver.
– Connect the equipment into an outlet on a circuit different from that to which the receiver is connected.
– Consult the dealer or an experienced radio/TV technician for help.
This device complies with part 15 of the FCC rules. Operation is subject to the following two conditions (1) this device may not cause harmful interference, and (2) this device must accept any interference received, including interference that may cause undesired operation.

CE Statement

Herby, Shenzhen DZH Industrial Co., Ltd declares that this 2.4G Wireless Keypad, B038 is in compliance with the essential requirements and other relevant provisions of Directive 2014/53/EU. In accordance with Article 10(2) and Article 10(10), this product allowed to be used in all EU member states. Use the 2.4G Wireless Keypad in the environment with the temperature between -20 C and 25 C.

Operation Frequency:
2402MHz ~ 2479MHz

Manufacturer: Shenzhen DZH Industrial Co., Ltd
Address: 3th Floor, YITuo Mike Industrial A building, Bu Yong Industrial D zone, Shajing, Shenzhen, China

DECLARATION OF CONFORMITY	
I hereby declare that the product	This Declaration is based on the sole responsibility of the manufacturer and, if applicable, its authorized representative.
Product: 2.4G Wireless Keypad Model No: B038 Trade Mark: N/A Hardware Version: V1.0 Software Version: V1.0	Place of contact: Name: 2020-05-01 Place: No. 3 Floor, YITuo Mike Industrial A building, Bu Yong Industrial D zone, Shajing, Shenzhen, China
Name of person, upon whom sole responsibility is assumed: Name: 2020-05-01 Place: No. 3 Floor, YITuo Mike Industrial A building, Bu Yong Industrial D zone, Shajing, Shenzhen, China	Name: Place: No. 3 Floor, YITuo Mike Industrial A building, Bu Yong Industrial D zone, Shajing, Shenzhen, China
<p>Model of the technical regulations applicable to the product within the scope of Council Directives 2014/53/EU, 2014/53/EU and 2014/53/EU and declares that the same application has not been made elsewhere.</p> <p>EN 61288-1:2014-11:2015 EN 61288-2:2014-11:2015 EN 61288-3:2014-11:2015 EN 61288-4:2014-11:2015 EN 61288-5:2014-11:2015 EN 61288-6:2014-11:2015 EN 61288-7:2014-11:2015 EN 61288-8:2014-11:2015 EN 61288-9:2014-11:2015 EN 61288-10:2014-11:2015 EN 61288-11:2014-11:2015 EN 61288-12:2014-11:2015 EN 61288-13:2014-11:2015 EN 61288-14:2014-11:2015 EN 61288-15:2014-11:2015 EN 61288-16:2014-11:2015 EN 61288-17:2014-11:2015 EN 61288-18:2014-11:2015 EN 61288-19:2014-11:2015 EN 61288-20:2014-11:2015 EN 61288-21:2014-11:2015 EN 61288-22:2014-11:2015 EN 61288-23:2014-11:2015 EN 61288-24:2014-11:2015 EN 61288-25:2014-11:2015 EN 61288-26:2014-11:2015 EN 61288-27:2014-11:2015 EN 61288-28:2014-11:2015 EN 61288-29:2014-11:2015 EN 61288-30:2014-11:2015 EN 61288-31:2014-11:2015 EN 61288-32:2014-11:2015 EN 61288-33:2014-11:2015 EN 61288-34:2014-11:2015 EN 61288-35:2014-11:2015 EN 61288-36:2014-11:2015 EN 61288-37:2014-11:2015 EN 61288-38:2014-11:2015 EN 61288-39:2014-11:2015 EN 61288-40:2014-11:2015 EN 61288-41:2014-11:2015 EN 61288-42:2014-11:2015 EN 61288-43:2014-11:2015 EN 61288-44:2014-11:2015 EN 61288-45:2014-11:2015 EN 61288-46:2014-11:2015 EN 61288-47:2014-11:2015 EN 61288-48:2014-11:2015 EN 61288-49:2014-11:2015 EN 61288-50:2014-11:2015 EN 61288-51:2014-11:2015 EN 61288-52:2014-11:2015 EN 61288-53:2014-11:2015 EN 61288-54:2014-11:2015 EN 61288-55:2014-11:2015 EN 61288-56:2014-11:2015 EN 61288-57:2014-11:2015 EN 61288-58:2014-11:2015 EN 61288-59:2014-11:2015 EN 61288-60:2014-11:2015 EN 61288-61:2014-11:2015 EN 61288-62:2014-11:2015 EN 61288-63:2014-11:2015 EN 61288-64:2014-11:2015 EN 61288-65:2014-11:2015 EN 61288-66:2014-11:2015 EN 61288-67:2014-11:2015 EN 61288-68:2014-11:2015 EN 61288-69:2014-11:2015 EN 61288-70:2014-11:2015 EN 61288-71:2014-11:2015 EN 61288-72:2014-11:2015 EN 61288-73:2014-11:2015 EN 61288-74:2014-11:2015 EN 61288-75:2014-11:2015 EN 61288-76:2014-11:2015 EN 61288-77:2014-11:2015 EN 61288-78:2014-11:2015 EN 61288-79:2014-11:2015 EN 61288-80:2014-11:2015 EN 61288-81:2014-11:2015 EN 61288-82:2014-11:2015 EN 61288-83:2014-11:2015 EN 61288-84:2014-11:2015 EN 61288-85:2014-11:2015 EN 61288-86:2014-11:2015 EN 61288-87:2014-11:2015 EN 61288-88:2014-11:2015 EN 61288-89:2014-11:2015 EN 61288-90:2014-11:2015 EN 61288-91:2014-11:2015 EN 61288-92:2014-11:2015 EN 61288-93:2014-11:2015 EN 61288-94:2014-11:2015 EN 61288-95:2014-11:2015 EN 61288-96:2014-11:2015 EN 61288-97:2014-11:2015 EN 61288-98:2014-11:2015 EN 61288-99:2014-11:2015 EN 61288-100:2014-11:2015</p>	
<p>NOTIFIED BODY: MCCM Labs Inc. Name: Address: City: Country: Telephone: Fax: E-mail: Website: Identification Number: 2001</p>	
<p>MANUFACTURER or AUTHORIZED REPRESENTATIVE: Name: Address: City: Country: Telephone: Fax: E-mail: Website:</p>	

B038 2.4G键盘 用户手册

注意：正确操作本产品，请仔细阅读用户手册。

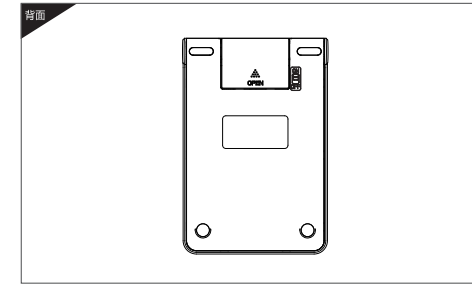
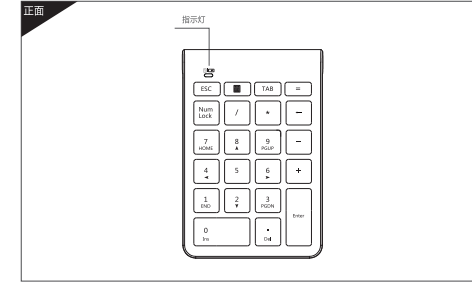

注意：请按正负极正确安装电池，请勿将电池充电，并子火中，或将不同类型或新旧电池混用，以免电池漏液。请将电池存放在阴凉干燥处并远离儿童；电量长时间不用时，请将电池取出。

• 连接使用说明：

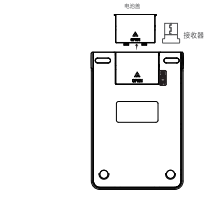

1. 请打开键盘底部的电池盖，取出接收器。

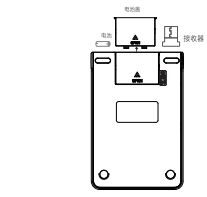

2. 如图所示，装入1节7号电池，再装上电池盖。



3. 将接收器插入有USB口的设备上，即可使用。（请确保您的电脑设备USB接口可用）

技术规格

- 键盘尺寸：129.9 X84.2X14mm
- 键盘重量：93g
- 按键个数：22键
- 工作电压：1.5V
- 工作电流使用按键:<4mA
- 工作距离：8m
- 休眠电流：0.028mA
- 休眠时间：8分钟
- 待机电流：1.27mA (点灯)
- 唤醒方式：按键唤醒

状态显示LED

- 键盘指示灯：NUM指示灯颜色（绿色），power指示灯颜色（红色）
- 低电压指示：当电压低于0.9V，红色指示灯闪烁。

故障分析

请与售后服务人员联系

知识产权信息

未经卖方的许可，禁止复制本用户手册的内容。

安全提醒

请不要打开或修理该设备，请不要在潮湿的环境使用该设备。请用干布擦拭该设备。

键盘保养

1. 请勿将设备暴露在液体和潮湿的环境中或使其淋雨，请勿在浴缸、水槽、桑拿房、游泳池或蒸汽房附近使用。
2. 请勿将设备暴露于过高或过低的温度条件下。
3. 请勿长时间放置在阳光直射的地方。
4. 请勿靠近明火，如烹饪用炉、蜡烛或者壁炉。
5. 避免使用锋利器物刮擦产品，及时给产品进行充电或更换干电池以保证正常使用。

常见问题解答

1. 接收器无法识别？
接收器插入电脑未识别，请检查USB接口是否接触良好。
2. 键盘指示灯在使用途中红灯闪烁？
键盘指示灯在使用途中红灯闪烁，表示电池即将没电，请尽快更换电池。
3. 设备显示无线键盘断开连接？
无线键盘在一段时间内不使用，设备为了省电将自动进入休眠，按键盘任意键盘唤醒，无线连接将自动恢复。