

2.4GHz Wireless Mouse



MODEL NO:
M7129

User Manual

1. Package Contents

- 1 x Wireless Mouse
- 1 x USB Receiver
- 1 x AAA Battery

Note:

- 1 If any of above item is not packed in your package when open, please consult your reseller immediately.

2. Overview



Front View



Bottom View

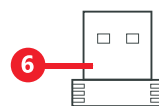

- 1 Scrolling Wheel
- 2 Right Key
- 3 Left Key

- 4 Power Switch
- 5 Optical LED
- 6 USB Receiver

3. Using the Device

Install Battery

1. Open the Battery Compartment Cover at bottom of the mouse.
2. Insert battery into the battery compartment.
3. Replace the Battery Compartment Cover back to its original position.

Note:

1. Make sure the battery orientation is properly affixed accordingly as specified.
2. The lit up Optical LED indicates that the mouse is power-on and functioning; whereas Optical LED is off while in sleep-mode or power-off mode.

Install Receiver

- The USB receiver and the mouse are paired to work as a complete set.
- User can use the product right away by inserting the receiver into USB port of PC. The computer will detect and setup the mouse automatically.
- Upon completion, the mouse can be used right away. If no response from mouse, please eject the receiver and insert to another USB port of the PC.

Sleep Mode

When the mouse is idle for 3 minutes, it will turn to sleep mode for battery saving purpose. At the same time, the LED will be off. To exit from sleep mode, simply click any button of the mouse.

4. Specifications & Functions

1. Plug and forget Nano receiver
2. Robust wireless connection with advanced 2.4GHz 2 Way fast digital RF
3. Up to 10 meters operation distance
4. Power Switch and Sleep Mode for maximum battery life
5. Resolution: 1200 dpi
6. Input Battery Power: 1.5V AAx 1
7. Weight: 58g (Mouse); 1.5g (Receiver)
8. Dimension: 102mm x 64mm x 35mm (Mouse); 19mm x 15mm x 6mm (Receiver)

FCC STATEMENT

1. This device complies with Part 15 of the FCC Rules. Operation is subject to the following two conditions:

(1) This device may not cause harmful interference.

(2) This device must accept any interference received, including interference that may cause undesired operation.

2. Changes or modifications not expressly approved by the party responsible for compliance could void the user's authority to operate the equipment.

NOTE: This equipment has been tested and found to comply with the limits for a Class B digital device, pursuant to Part 15 of the FCC Rules. These limits are designed to provide reasonable protection against harmful interference in a residential installation.

This equipment generates uses and can radiate radio frequency energy and, if not installed and used in accordance with the instructions, may cause harmful interference to radio communications.

However, there is no guarantee that interference will not occur in a particular installation. If this equipment does cause harmful interference to radio or television reception, which can be determined by turning the equipment off and on, the user is encouraged to try to correct the interference by one or more of the following measures:

Reorient or relocate the receiving antenna.

Increase the separation between the equipment and receiver.

Connect the equipment into an outlet on a circuit different from that to which the receiver is connected.

Consult the dealer or an experienced radio/TV technician for help.

RF warning statement:

The device has been evaluated to meet general RF exposure requirement.

The device can be used in portable exposure condition without restriction