

PureVoice

PureVoice

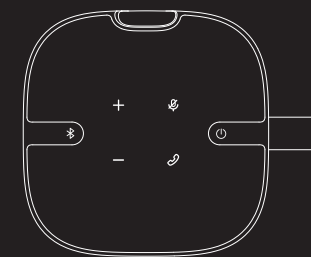

MANUFACTURER
 Shenzhen SoundSOUL Information Technology Company Limited
 Room 1506-1509, Building 8, Huina Square, Chuangye Road,
 Longhua District, Shenzhen, China, 518109
 support@soundpeatsaudio.com
 www.soundpeatsaudio.com



Company: Qing LGHafungzbeschränkt
 Address: Lindener 7, 10203 Berlin, Germany



FCC ID: 2AFTU-00027 IC ID: 27765-X001 MADE IN CHINA

Using Guide | Gebrauchsanweisung | Manual de instrucciones |
 Mode d'emploi | Istruzioni per l'uso | 取扱説明ガイド | 说明使用指南

Product Diagram

Button Control:

- Bluetooth Button
- Power Button

Touch Control:

- Mute Button
- Call Button
- Volume+
- Volume-

Charging Port:

- Type-C Charging Port

LED Indicator:

- Bluetooth indicator
- Power Indicator
- Mute Indicator
- Call Indicator
- Volume Indicator

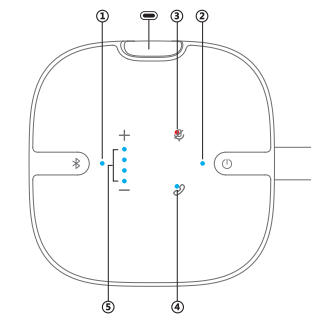

English

Connection

Wireless connection-Bluetooth Pairing

- Long press the power button for 3s to turn on, the power indicator stays blue, then short press Bluetooth button till the Bluetooth indicator flashes blue, the PureVoice conference speaker enters pairing mode.
- Activate Bluetooth on the device, and choose "SOUNDPEATS PureVoice" on Bluetooth list to pair.

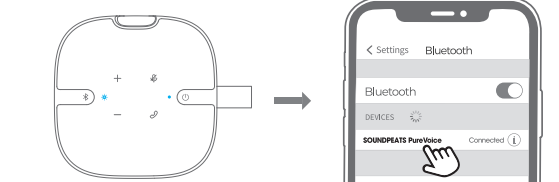

Wired Connection

- Long press power button for 3 seconds to turn on, the power indicator stays blue.
- Connect the Type-A end of the cable to the device.
- Then connect the Type-C at the other end to the PureVoice conference speaker.

English

Control

Power on	Long press power button for 3s
Power off	Auto: 1) Automatically power off when not connected with the device within 10 minutes. 2) Automatically power off when in low battery. Manually: Long press power button for 3s
Volume-	Short tap volume- button
Keep Volume down	Long press volume- button
Volume+	Short tap volume+ button
Keep Volume up	Long press volume+ button
Enter/Exit Mute Mode	Short press Mute button
Bluetooth Pairing	Short press Bluetooth button till the Bluetooth indicator flashes blue
Turn on Bluetooth visibility	Short press Bluetooth button
Turn off Bluetooth visibility	Long press Bluetooth button for 3s
Answer/ Hang up phone call	Short tap call button
Reject phone call	Long press call button for 1.5s

English

Reset

Long press power button for 8 seconds when the PureVoice Conference Speaker is in power on/off status, then wait for 3 seconds, the PureVoice will be rebooting with voice prompt "Power on", its power indicator stays blue, reset complete.

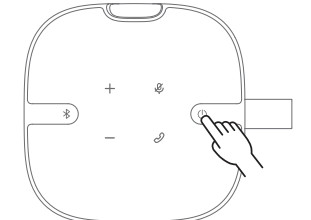

English

Q&A

Q1: What does the LED of PureVoice Conference Speaker mean?

PureVoice Speaker	Indicator	Meaning
Bluetooth indicator①	Flash blue quickly	Pairing mode
	Blue	Connected
Power indicator②	Blue light off	Turn off Bluetooth visibility
	Blue	Power on/ enough battery
	Flash red	Low battery
Mute indicator③	Red	In charging
	Green	Full Charged
	Red	Enter mute mode
Call indicator④	Red light off	Exit mute mode
	Flash Blue	Incoming call
Volume indicator⑤	Flash Blue	Calling
	Blue	After volume+/-, the volume indicator will display current volume status and stay blue for 2s then disappear

English

Q2: If Bluetooth visibility is turned off during use, the PureVoice conference speaker will be disconnected from the current device. Can other devices still connect to the conference speaker?

Other devices can be connected. The main purpose of turning off Bluetooth visibility is to disconnect from the current device without automatically reconnecting, so that other devices can be connected quickly, enabling convenient switching of devices in the meeting.

Q3: After the PureVoice conference speaker is connected to the phone, why is it sound so small when the volume on the phone is one bar?

- Because the volume is already at a low level when the volume is one level on the phone, the sound will be relatively small.
- The main reason is related to the volume gradient set by the phone manufacturer. Because the volume gradients set by different phone manufacturers are different, the sound of the conference speaker will be relatively small when the volume of some phones is one level. You can adjust the volume to a suitable level.

English

FCC Statement

This equipment has been tested and found to comply with the limits for a Class B digital device, pursuant to Part 15 of the FCC rules. These limits are designed to provide reasonable protection against harmful interference in a residential installation. This equipment generates uses and can radiate radio frequency energy and, if not installed and used in accordance with the instructions, may cause harmful interference to radio communications. However, there is no guarantee that interference will not occur in a particular installation. If this equipment does cause harmful interference to radio or television reception, which can be determined by turning the equipment off and on, the user is encouraged to try to correct the interference by one or more of the following measures:
 - Reorient or relocate the receiving antenna.
 - Increase the separation between the equipment and receiver.
 - Connect the equipment into an outlet on a circuit different from that to which the receiver is connected.
 - Consult the dealer or an experienced radio/TV technician for help.

This device complies with part 15 of the FCC rules. Operation is subject to the following two conditions:
 (1) This device may not cause harmful interference.
 (2) This device must accept any interference received, including interference that may cause undesired operation.
 Changes or modifications not expressly approved by the party responsible for compliance could void the user's authority to operate the equipment.

IC ID

- English -
 This device complies with Industry Canada licence-exempt RSS standard(s). Operation is subject to the following two conditions:
 (1) this device may not cause interference, and
 (2) this device must accept any interference, including interference that may cause undesired operation of the device.

- French -
 Le présent appareil est conforme aux CNR d'Industrie Canada applicables aux appareils radio exempts de licence. L'exploitation est autorisée aux deux conditions suivantes:
 (1) l'appareil ne doit pas produire de brouillage, et
 (2) l'utilisateur de l'appareil doit accepter tout brouillage radioélectrique subi, même si le brouillage est susceptible d'en compromettre le fonctionnement.

If warning statement:
 The device has been evaluated to meet general RF exposure requirement. The device can be used in portable exposure condition without restriction.

English