

THANKS FOR

XWIT

YOUR PURCHASE!

MINI KARAOKE MACHINE WITH MICROPHONE

USER MANUAL

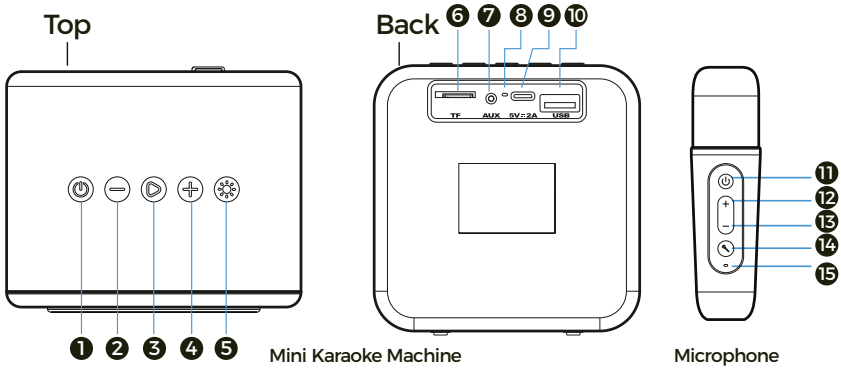

A

Button Operation

- 1

Long press 2-3s to power on/off the speaker
Short press to change mode
(Bluetooth Mode-->TF Card Mode-->USB Flash Drive Mode-->AUX Mode)
- 2

Long press to choose the previous song
Short press to down the volume of speaker
- 4

Long press to choose the next song
Short press to raise the volume of speaker
- 24

Short press these two buttons at the same time to enter/exit TWS when you want to use multiple speakers

- 3

Long press to disconnect the Bluetooth
Short press to play/pause the music
When there is an incoming call:
Short press to answer/hang up the call
Long press to reject the call
- 5

Short press to turn on/off the LED light
Short press to change the light mode(3 different light mode)
- 6

TF Card port

7

AUX port

8

Indicator light

9

Charging port

10

USB port

- 11

Long press 2-3s to turn on/off the microphone
Short press to switch the reverb adjustment/volume adjustment
- 12

Short press to down the reverb/volume of microphone
- 13

Short press to raise the reverb/volume of microphone
- 14

Voice Changer
Short press to change your voice:Male Voice--Lolita Voice--Monster Voice--Minions Voice.
Double click to remove/restore music vocals

B

Bluetooth Pairing

- “Long press”

1.Long press the power button to turn on the speaker, you can hear a sound "Power On".(The default mode is Bluetooth mode.)
- “Bluetooth Pairing”

2.When you hear a sound "Bluetooth pairing",This means it is looking for a Bluetooth pairing.

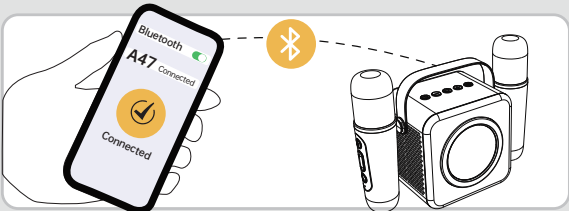

- 3.Turn on your bluetooth of your smart device. Choose the bluetooth which named “A47”. The speaker will pair your smart phone successfully When you hear the prompt sound "Bluetooth connected"
- Note: if there is a pairing record, You need to disconnect from the record device, otherwise the speaker will automatically connect the device you connected before.

C

specification

Model	A47	Charging Time of speaker:	2H-3H
Bluetooth Version:	AB5608	Charging Time of microphone:	2H-3H
Bluetooth Range:	>30m/98ft	Speaker Battery Capacity:	1800mAh
TWS Range:	≤15m/48ft	Using time of speaker:	≥7H(With lights on and volume at 50%)
Wireless Microphone Range:	10m/32ft	Using time of microphone:	10H
Maximum Speaker Power:	6W	Speaker size	3.937*3.937*3.217inch
Charging Input of speaker:	Type-C 5V/1A	Microphone size	5.275*1.476inch
Charging Input of microphone:	Type-C 5V/0.3A		

D

Synchronizing Speaers(TWS)

- 1

“Long press”

1. Long press the power button to turn on the speaker.
- 2

2. Connecting the Bluetooth of your smart device and label this speaker as Main speaker.
- 3

3. Long press the power button to turn on another speaker(Secondary speaker)
- 4

4. Short press the " - " button and " + "button of Main speaker at the same time, you will hear a prompt tone.
- 5

5. When the blue indicator light of Main speaker is always on, and the blue indicator light of secondary speaker flashes slowly, it means that two speaker are synchronized.

E

Charging

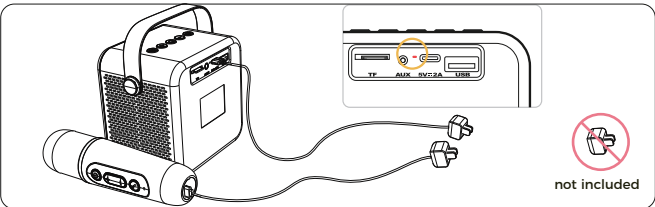

- 1.Take out the type-C charging cable include in the package.
- 2.Use the included type-C end of the charging cable to connect the speaker or microphone,and plug the another end into power supply with a adapter(not included), they will be start charging.
- 3.When the speaker/microphone is charging, the indicator light turns red. Once it is fully charged, the red indicator light will turn off.

F

Indicator Light

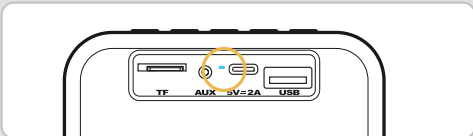

1. When Bluetooth is not connected, the indicator light turns blue and flashes once per second. When Bluetooth is successfully connected,the blue indicator light will remain on.
2. When entering the TWS, the indicator light of main speaker turns blue and flashes once per second. When TWS is successfully paired, the blue indicator light of the main speaker will remain on, and the blue indicator light of the secondary speaker flashes slowly.
3. When is charging, the indicator light turns red. Once it is fully charged, the red indicator light will turn off.

G

Warning &Tips

1. The Speaker will alarm once a minute for "Low Power", and will shut down after the third time.
2. The Microphone will alarm once every 3 minutes for "Low Power", and will shut down after the third time.
3. It will automatically shut down after 15 minutes when Bluetooth is not connected or connected without playing
4. Can be selected one microphone or two microphones together (but two receiving positions should be reserved when layout)
5. Can be K song in TWS connection state
6. Microphone delay is 10ms
- 1.Please fully charged the speaker and microphone before use.
- 2.Do not expose this product to rain or moisture.
- 3.Store and use the product at room temperature.
- 4.Do not drop the product to avoid damage caused by falling.
- 5.Please use the rated voltage power supply to charge the product.

FCC Statement
This device complies with Part 15 of the FCC Rules. Operation is subject to the following two conditions:
(1) This device may not cause harmful interference.
(2) This device must accept any interference received, including interference that may cause undesired operation.
Changes or modifications not expressly approved by the party responsible for compliance could void the user's authority to operate the equipment.

Note:
This equipment has been tested and found to comply with the limits for a class B digital device,pursuant to Part 15 of the FCC Rules. These limits are designed to provide reasonable protection against harmful interference in a residential installation. This equipment has been tested and found to comply with the limits for a Class B digital device, pursuant to part 15 of the FCCRules. These limits are designed to provide reasonable protection against harmful interference in a residential installation. This equipmentgenerates, uses and can radiate radio frequency energy and, if not installed and used in accordance with the instructions, may cause harmfulinterference to radio communications. However, there is no guarantee that interference will not occur in a particular installation. If thisequipment does cause harmful interference to radio or television reception, which can be determined by turning the equipment off and on, theuser is encouraged to try to correct the interference by one or more of the following measures:
--Reorient or relocate the receiving antenna.
--Increase the separation between the equipment and receiver.
--Connect the equipment into an outlet on a circuit different from that to which the receiver is connected.
--Consult the dealer or an experienced radio/TV technician for help.