

2.1 CH Sound Bar with Wired Subwoofer and Bluetooth

Installation & User Instructions – Please keep for future reference

A6

Pixel

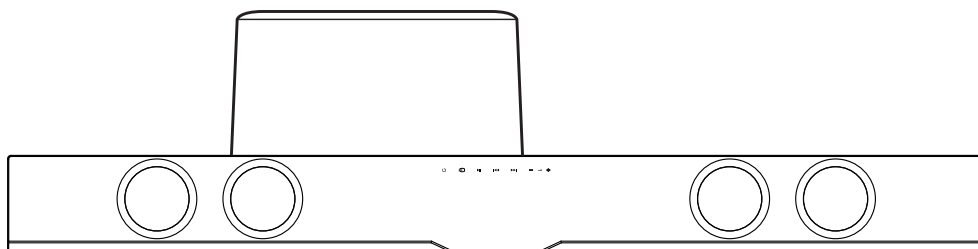

Important – Please read these instructions fully before installing or using

These instructions contain important information which will help you get the best from your appliance and ensure safe and correct installation, use and maintenance.

Table of contents

Trademarks	1
Safety information	2
Safety information	2
Notice of compliance	2
Functions and controls	3
What's included	3
Overview of controls	3
Overview of remote	4
Remote battery usage	4
User instructions	5
Connecting the external subwoofer	5
TV connections	5
Auxiliary connections	7
Mains connection	7
Standby mode	7
General operation	7
- Switching inputs	7
- Adjust the volume level	7
- Sound effect presets	7
- Bass enhancement	8
- Mute function	8
- Sleep timer	8
- Adjusting the display brightness	8
Bluetooth operation	8
Play audio from USB storage devices	9
Wall mounting the sound bar	10
Troubleshooting & Maintenance	11
Troubleshooting	11
Care & maintenance	11
Specifications	12

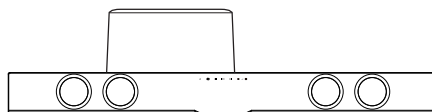

Trademarks



For DTS patents, see <http://patents.dts.com>. Manufactured under license from DTS Licensing Limited. DTS, the Symbol, & DTS and the Symbol together are registered trademarks, and DTS TruSurround is a trademark of DTS, Inc. © DTS, Inc. All Rights Reserved.



The Bluetooth® word mark and logos are registered trademarks owned by Bluetooth SIG, Inc. and any use of such marks is under license.



Safety information

Important safety instructions

1. Read these instructions.
2. Keep these instructions.
3. Heed all warnings.
4. Follow all instructions.
5. Do not use this apparatus near water.
6. Clean only with dry cloth.
7. Do not block any ventilation openings.
Install in accordance with the manufacturer's instructions.
8. Do not install near any heat sources such as radiators, heat registers, stoves, or other apparatus (including amplifiers) that produce heat.
9. Do not defeat the safety purpose of the polarized or grounding-type plug. A polarized plug has two blades with one wider than the other. A grounding type plug has two blades and a third grounding prong. The wide blade or the third prong are provided for your safety. If the provided plug does not fit into your outlet, consult an electrician for replacement of the obsolete outlet.

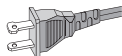

10. Protect the power cord from being walked on or pinched particularly at plugs, convenience receptacles, and the point where they exit from the apparatus.
11. Only use attachments/accessories specified by the manufacturer.
12. Use only with the cart, stand, tripod, bracket, or table specified by the manufacturer, or sold with the apparatus. When a cart is used, use caution when moving the cart/apparatus combination to avoid injury from tip-over.



13. Unplug this apparatus during lightning storms or when unused for long periods of time.
14. Refer all servicing to qualified service personnel.
Servicing is required when the apparatus has been damaged in any way, such as power-supply cord or plug is damaged, liquid has been spilled or objects have fallen into the apparatus, the apparatus has been exposed to rain or moisture, does not operate normally, or has been dropped.

Notice of compliance

FCC Compliance Statement

This device complies with part 15 of the FCC rules. Operation is subject to the following two conditions:

(1) This device may not cause harmful interference, and

(2) This device must accept any interference received, including interference that may cause undesired operation.

NOTE: This equipment has been tested and found to comply with the limits for a Class B digital device, pursuant to Part 15 of the FCC Rules. These limits are designed to provide reasonable protection against harmful interference in a residential installation. This equipment generates, uses, and can radiate radio frequency energy and, if not installed and used in accordance with the instructions, may cause harmful interference to radio communications. However, there is no guarantee that interference will not occur in a particular installation. If this equipment does cause harmful interference to radio or television reception, which can be determined by turning the equipment off and on, the user is encouraged to try to correct the interference by one or more of the following measures:

- Reorient or relocate the receiving antenna.
- Increase the separation between the equipment and receiver.
- Connect the equipment into an outlet on a circuit different from that to which the receiver is connected.
- Consult the dealer or an experienced radio/TV technician for help.

FCC Radiation Exposure Statement:

This equipment complies with FCC radiation exposure limits set forth for an uncontrolled environment. This equipment should be installed and operated with a minimum distance of 20cm between the radiator and your body.

This transmitter must not be co-located or operating in conjunction with any other antenna or transmitter.

CAUTION : FCC regulation state that any unauthorized changes or modifications to this equipment may void the user's authority to operate it.

Functions & controls

Please familiarize yourself with the parts and accessories listed below

What's included

- 1 x Sound bar
- 1 x Subwoofer
- 1 x Remote control
- 1 x CR2025 battery
- 1 x Audio cable (RCA - 3.5mm)
- 1 x Instruction manual
- 1 x Power adaptor 24V 1.5A

Overview of controls

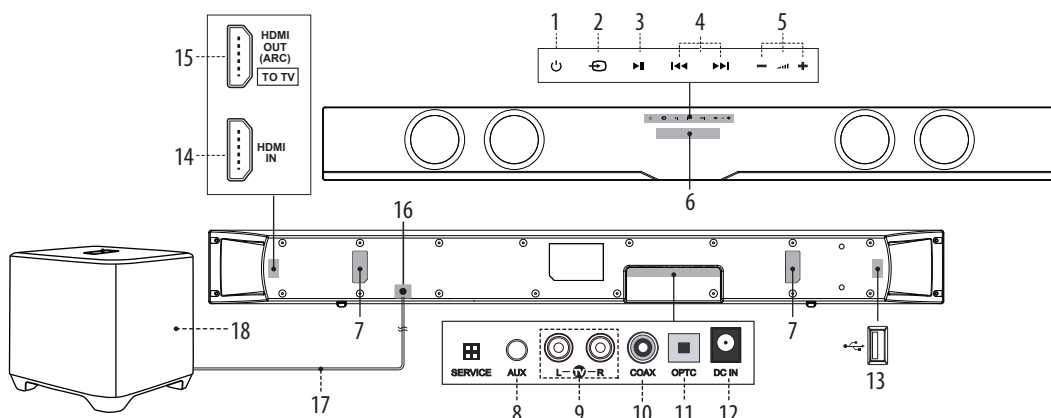

1 STANDBY touch button: Switch on the Sound bar or switch to STANDBY mode .

2 SOURCE touch button: Select an audio source from **TV, AUX, COAX, BT, OPTC, USB** or **HDMI** inputs.

3 ►|| PLAY/PAUSE touch button: **START, PAUSE** or **RESUME** play in USB mode and Bluetooth mode.

4 ◀◀ ▶▶ SKIP touch button: Skip to the previous or next track in USB mode and Bluetooth mode.

5 VOLUME + / - touch buttons: Increase or decrease the output volume.

6 DISPLAY: Indicates the current status of the unit.

7 WALL-MOUNT BRACKETS: Use these brackets to fix the Sound bar to a wall.

8 AUX AUDIO INPUT (3.5mm): Connect the analogue audio output from an **MP3** player or similar using a **3.5mm** audio cable.

9 TV AUDIO INPUT (RCA): Connect the analogue audio output from a TV or other audio source.

10 COAXIAL AUDIO INPUT (RCA): Connect the digital audio output from a **TV, DVD** or **Blu-ray** player.

11 OPTICAL AUDIO INPUT: Connect the digital audio output from a **TV, DVD** or **Blu-ray** player.

12 DC IN SOCKET of sound bar: Connect to the power adaptor 24V, 1.5A

13 USB PORT: Audio input from a USB storage device.

14 HDMI IN: Connect to the HDMI output on a digital device.

15 TO TV- HDMI OUT (ARC): Connect to the HDMI input on the TV.

16 SUBWOOFER CONNECTORS: Connect to the external subwoofer.

17 SPEAKER CABLE (fixed on the subwoofer): Connect the external subwoofer to the Sound bar.

18 SUBWOOFER

Functions and controls

Overview of remote

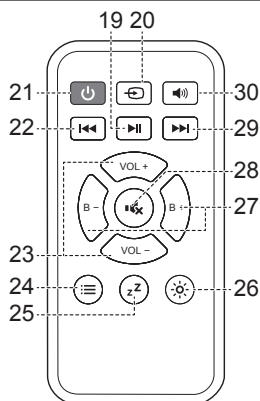

19 ►/|| PLAY/PAUSE: START, PAUSE or RESUME
USB and Bluetooth playback.

20 SOURCE: Select an audio from **TV, AUX, COAX, BT, OPTICAL, USB** or **HDMI** inputs.

21 STANDBY: Switch on the Sound bar or USB and switch to **STANDBY** mode.

22 SKIP ◀◀ : Skip to previous track for USB and Bluetooth playback.

23 VOLUME - / +: Increase or decrease the volume output.

24 OPTION:

- In Bluetooth mode, press and hold for 3 seconds to "unpair" a connected Bluetooth device.
- In USB mode, press repeatedly to cycle through the repeat modes: **◀◀-1 (REPEAT)**, **◀◀ (REPEAT ALL)** or **◀◀ (RANDOM PLAY)**.

25 SLEEP: Activates the sleep timer function.

26 DIM: Press this button to adjust the display brightness.

27 BASS - / +: Increase or decrease the bass output.

28 MUTE: Press to mute the sound output.

29 SKIP ▶▶ : Skip to next track for USB and Bluetooth playback.

30 SOUND EQ MODES: Press repeatedly to assign different sound EQ modes: **STANDARD, MOVIE, MUSIC** or **NEWS**.

Remote battery usage

Using the remote for the first time

Before use, pull the tab out from the bottom of the remote control . This allows the terminals contact with the pre-installed battery.

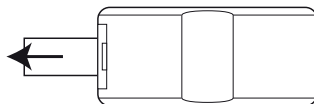

Installing batteries in the remote

1: Push open the battery compartment on the bottom of the remote control using a fingernail.

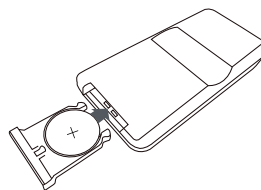

2: Insert a **CR2025** battery into the space taking care to match the + & - polarity symbols correctly .

3: Replace the battery compartment .

Disposal of batteries

Dispose of used batteries with regard to the recycling regulations in your area. Do NOT short circuit batteries or throw them into water, the general rubbish or in a fire. Weak batteries can leak and damage the remote control. Replace them in good time!

User instructions

Connecting the external subwoofer

Connect the SPEAKER CABLE (fixed on the external subwoofer) to SUBWOOFER CONNECTORS on the back of the Sound bar.

NOTE: Make sure to match the cable with RED line to the RED socket, and the WHITE cable to the BLACK socket.

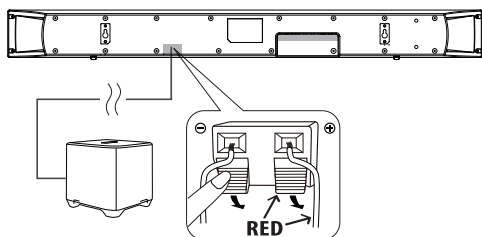

TV connections

1) Connection to a TV using HDMI (ARC) cable.

Your Sound bar supports HDMI 1.4 with Audio Return Channel (ARC). If your TV is HDMI ARC compliant, you can hear TV audio through your Sound bar by using a single HDMI cable.

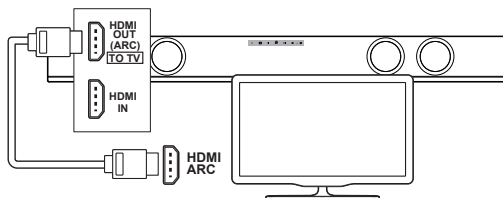

- 1: Connect one end of the HDMI cable (Type A, High Speed HDMI™ cable with Ethernet) to the HDMI ARC socket on TV.

NOTE: The HDMI ARC socket on TV might be labeled differently. For detail, see the TV manual.

- 2: Connect the other end to the TO TV- HDMI OUT (ARC) input (15) at the side of Sound bar.
- 3: On your TV, turn on the HDMI-CEC operations. For details, see the TV user manual.

TV connections

NOTE: If your TV is not HDMI ARC compliant, connect an audio cable to hear the TV audio through your Sound bar. See connection 3) to 6).

NOTE: The setting method of HDMI-CEC and ARC may differ depending on the TV. For details about ARC function, refer to your TV manual.

NOTE: You may need to activate PCM (Downmix) on your TV.

2) Connection to digital devices using HDMI cable.

Connect a digital device such as a set-top box, DVD/Blu-ray player or games console to your Sound bar using a single HDMI cable and play a file or game, the

- Video is automatically displayed on your TV, and
 - Audio is automatically played on your Sound bar.
- 1: Using a High Speed HDMI cable to connect the HDMI OUT socket on your digital device to the HDMI IN socket (14) at the side of your Sound bar.
 - 2: Using a High Speed HDMI cable to connect the HDMI ARC socket on your TV to the TO TV-HDMI OUT (ARC) socket (15) at the side of your Sound bar.
 - If the TV is not HDMI-CEC compliant, refer to the manual to select the correct video input on your TV.
 - 3: On the connected device, turn on the HDMI-CEC operations. For details, see the user manual of the device.

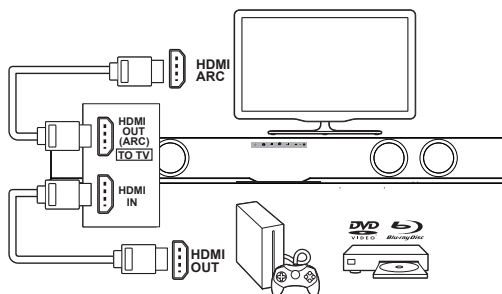

NOTE: You may need to activate PCM (Downmix) on your source device EG: set-top box, DVD/Blu-ray player, games console or TV.

User instructions

TV connections

3) Connecting a TV, DVD or GAMES CONSOLE using the RCA - RCA audio cable.

NOTE: Ensure that the TV PHONO connectors are audio **OUTPUTS** and not audio **INPUTS**. If they are **INPUTS** then use connection 4 instead of 1.

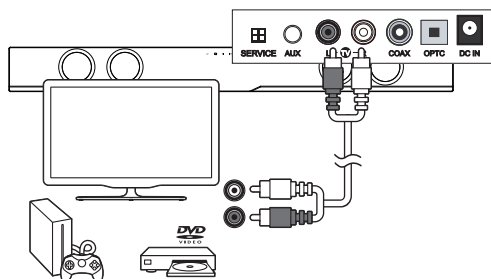

- 1: Connect one end of the **RCA** cable to the **TV**, **DVD** or **CONSOLE** audio output **RCA** sockets.
- 2: Connect the other end to the TV inputs on the back of the Sound bar **(9)**.

NOTE: Take care to match the **RED** plug to the **RED** socket and the **WHITE** plug to the **WHITE** socket.

4) DIGITAL connection to a TV, DVD or Blu-ray player using the COAXIAL cable.

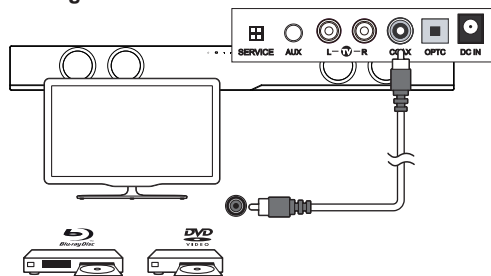

- 1: Connect one end of the **RCA COAX** cable to the **TV**, **DVD** or **Blu-ray** **COAXIAL** audio output **RCA** socket.
- 2: Connect the other end to the **COAX** input on the back of the Sound bar **(10)**.

NOTE: You may need to activate PCM (Downmix) on your source device EG:- TV, DVD or Blu-ray player.

5) DIGITAL connection to a TV, DVD or Blu-ray player using the OPTICAL cable.

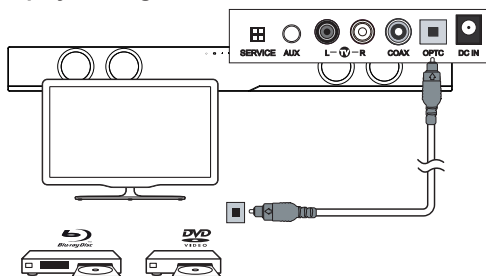

- 1: Connect one end of the **OPTICAL** cable to the **TV**, **DVD** or **Blu-ray** **OPTICAL** audio output socket.
- 2: Connect the other end to the **OPTC** input on the side of the Sound bar **(11)**.

NOTE: You may need to activate PCM (Downmix) on your source device EG:- TV, DVD or Blu-ray player.

6) Connection to a TV using the RCA - 3.5mm audio cable.

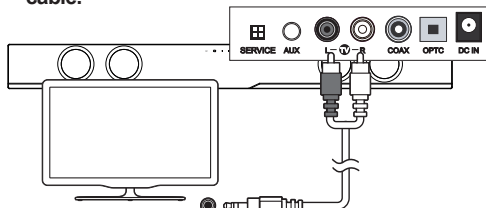

- 1: Connect the **3.5mm (small)** end of the cable to the **TV** headphone **3.5mm** audio output socket.
- 2: Connect the other **RED & WHITE** ends to the **TV** inputs on the side of the Sound bar **(9)**, taking care to match the **RED** plug to the **RED** socket and the **WHITE** plug to the **WHITE** socket.

NOTE: In some cases the Sound bar volume output is effected by the volume level on the TV. In this case adjust the TV volume to increase the audio output from the sound bar.

NOTE: If no sound can be heard from the sound bar using this connection, you may need to check your TV settings to enable the headphone socket output.

User instructions

Auxiliary connections

Connecting an MP3 player

The below diagram shows the connection to an audio device such as an MP3 player, using a 3.5mm audio cable.

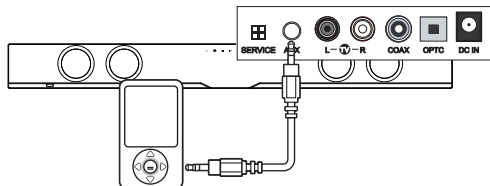

- 1: Connect one end of the **3.5mm** audio cable to the headphone output of your **MP3** player.
- 2: Connect the other end to the **AUX** input (**3.5mm socket**) on the back of the Sound bar (**8**).

Mains connection

Connecting mains power

- 1: Connect the **AC power adaptor** between the DC IN socket on the back of the Sound bar and the power supply outlet.
- 2: Switch the power outlet **ON**.

Standby mode

Standby mode

- 1: Press the **STANDBY** button (**1 Unit & 21 Remote**) to wake the unit from **STANDBY** mode.
- 2: To enter **STANDBY** mode press either **STANDBY** buttons (**1 Unit & 21 Remote**).

NOTE: As part of the power saving mode the unit will enter **STANDBY** mode automatically after 20 minutes (approx) of no audio output.

General operation

Switching inputs

Follow the below steps to switch inputs between : TV, Auxilliary, Coaxial, Bluetooth, Optical, USB or HDMI.

- 1: Ensure the Sound bar is powered **ON**. If not press the **STANDBY** button (**1**) or remote (**21**).
- 2: Press the **SOURCE** button (**2, 20**) repeatedly until you reach the required input mode.

Switching inputs (cont)

TV input:	TV
Auxilliary input:	AUX
Coaxial input:	COAX
Bluetooth input:	BT
Optical input:	OPTC
USB input:	USB
HDMI input:	HDMI

NOTE: When switching inputs there will be a 5 second pause after selecting **BT** while the unit scans for paired devices.

Adjusting the volume level

- 1: To increase the volume level press the **VOLUME +** button (**5 Unit or 23 Remote**) repeatedly or press and hold for fast adjustment.

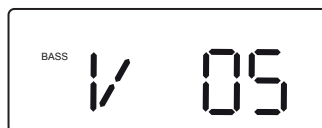

- 2: To decrease the volume level press the **VOLUME -** button (**5 Unit or 23 Remote**) repeatedly or press and hold for fast adjustment.

Sound effect presets

- 1: During playback pressing the **SOUND EQ** button on the remote control (**30**) repeatedly cycles through the available sound modes

Choose between : **STANDARD (STD)**, **MOVIE**, **MUSIC** or **NEWS**.



- 2: As you select a sound mode the corresponding name appears on the display to indicate that sound mode is active.

NOTE: The **STANDARD** sound mode when selected does not show an icon on the display.

User instructions

Bass enhancement

- 1: To increase the bass level press the **BASS (B)+** button (27) repeatedly.



- 2: To decrease the bass level press the **BASS (B)-** button (27) repeatedly.

NOTE: The BASS levels range from -3 to +3.

Mute function

- 1: Pressing the **MUTE** button (28) on the remote will temporarily silence the audio output. You will see 'MUTE' flash on the display to indicate the mute function is active.



- 2: Press the **MUTE** button again to resume the audio output.

Sleep timer

The unit can be set to enter STANDBY mode after a period of time.

- 1: During playback mode, press the **SLEEP** button (25) to enter the timer settings.
- 2: Press the **SLEEP** button repeatedly to cycle through the available time duration options of :- **5, 10, 15, 30, 45, 60, 90 minutes & OFF**.



- 3: When you have selected the required timer duration, just leave all buttons untouched for **2 seconds** and the timer will begin the countdown.

Sleep timer (cont)

- 4: When the timer elapses the STANDBY mode will be activated.

Adjusting the display brightness

- 1: Press the **DIM.** button (26) repeatedly to cycle through the 3 brightness states **LOW, MED & HIGH**.

Bluetooth operation

Before you can use the sound bar with your phone or other BT capable device, you will need to pair the Device to the sound bar.

NFC Compatible Smart phone

- 1: Touch the NFC-Mark on the unit with the smart phone.
- 2: Touch and hold until the smart phone responds. If prompted for a confirmation, enter 'yes' or 'confirm'.
- 3: To remove the pairing, touch the NFC-Mark again.



Non-NFC compatible devices

- 1: Press the **SOURCE** button (2, 20) repeatedly until you see 'BT' appear on the display.



- 2: When selected, the 'BT' text on the display will flash while the unit tries to connect to previously paired devices. If no devices are found the 'BT' text will still flash but to indicate it is ready for pairing a new device.
- 3: Enable the Bluetooth function on your smart phone and search for a device labelled '**WBOX A6W**' in the available list.
- 4: Select and enable pairing for the '**WBOX A6W**' device. If prompted for a password enter '**0000**'.

User instructions

Non-NFC compatible devices(cont)

- 5: If pairing is successful the sound bar will beep and the 'BT' text will stop flashing.
- 6: If the connected device goes out of range, the sound bar will attempt to connect for 2 minutes. When the device comes into range the sound bar will reconnect again automatically.
- 7: To remove the paired device using only the sound bar, press and hold the **OPTION** button (24) on the remote control. The 'BT' text will begin flashing again.

Bluetooth status table

'BT' state	Reason
'BT' solid (no flash)	<ul style="list-style-type: none"> Connected
'BT' flash	<ul style="list-style-type: none"> Auto re-connecting with last paired device. Pairing mode

Controlling a paired device

Once connected you can either use the controls on the audio device to begin playback, skip tracks etc. Or you can use the control buttons on the sound bar & remote.

- 1: The **PLAY/PAUSE** button (3 or 19) when pressed will begin playback of the selected track on the audio device. Press again to pause playback.
- 2: To skip to the next track press the **SKIP ►►** button (4 or 29).
- 3: To skip to the previous track press the **SKIP ◄◄** button (4 or 22)
- 4: Any further operations must be done from the audio device.

NOTE: the volume output is effected by the volume level on the audio source EG: Phone or laptop, so make sure that is set to about 70-80% (not too loud to avoid distortion).

Bluetooth notes

- The operation range of bluetooth is approximately 10 meters (30 Feet). Any obstacles in the path between devices may reduce this range.
- Only one Bluetooth device can be paired at a time.
- Not all Bluetooth devices are compatible.

Play audio from USB storage devices

Enjoy audio on a USB storage device, such as an MP3 player and USB flash memory, etc.

What you need

- A USB storage device that is formatted for FAT file systems, and complies with the Mass Storage Class.
- An MP3 or WMA file on a USB storage device

1. Connect a USB storage device to the sound bar.

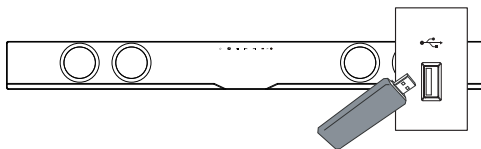

2. Press **SOURCE** button (2 Unit or 20 Remote) repeatedly until USB text appears on display.



3. Select a file you want to play.

To	Do this
Playback	Press ►► (3 Unit or 19 Remote).
Pause	During playback, press ►► .
Skip to the next/previous file	During playback, press ►► or ◄◄ (4 or 22, 29) to go to the next file or to step back to the previous file.
Play repeatedly or randomly	Press ≡ (Option) (24 on remote) repeatedly, the display will be changed in the following order : ◄◄-1 (repeat) → ◄◄ (repeat all) → ◄◄ (random) → (normal).

Note:

- This product may not be compatible with certain types of USB storage device.
- If you use a USB extension cable, USB HUB, or USB multi-reader, the USB storage device may not be recognized.
- Digital camera PTP protocols are not supported.
- Do not remove the USB storage device while it is being read.
- DRM-protected music files (MP3, WMA) are not supported.
- Support a USB port: 5V=, 1A.

User instructions

Wall mounting the sound bar

- 1: Align the Sound bar in the chosen location. Use a pencil to mark the drilling positions 630mm (24.8") apart.



NOTE: The Sound bar should be located at least 7.5cm (3") below the bottom of the TV.

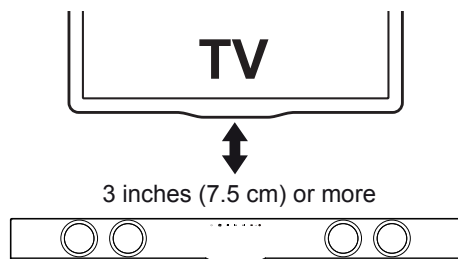

- 2: Drill holes as marked in step 1.

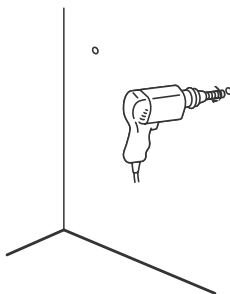

- 3: Insert 2 screws (not supplied) into the holes and tighten. Take care to leave 5mm between the screw heads and the wall.



NOTE: You will need to ensure the screws are long enough to sufficiently grip the wall while allowing 5mm between screw head & wall.

- 4: Hook the Sound bar into the screws. For secure mounting ensure the screw heads slide firmly into the narrow part of the brackets.

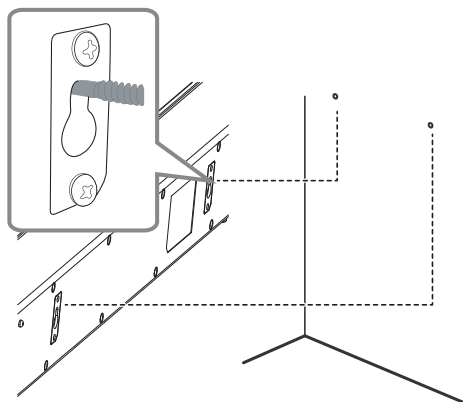

Wall mounting advice

- In order to avoid damage to the equipment and personal injury you should get a qualified person to drill the fixing surface and fit the appropriate wall fixings.
- Take care not to allow the main unit to fall while attempting to hook onto the wall mount brackets.
- Before mounting, check the wall strength, if it is not clear then consult relevant qualified personnel.
- When drilling into walls, always check that there are no hidden wires or pipes etc.
- Make sure the screws & wall plugs are suitable for supporting the unit.

Troubleshooting & Maintenance

Troubleshooting

In the unlikely event of difficulties with your appliance please follow the trouble shooting guide below. If the problem persists, contact the retailer if the machine is still under guarantee.

PROBLEM	POSSIBLE SOLUTION
No Power	<ul style="list-style-type: none">• Ensure the mains plug is connected to a power supply, and is switched ON.• Make sure there is power to the mains socket .
No Sound	<ul style="list-style-type: none">• Make sure if playing from the AUX input, the external source has the volume turned up and is playing a track .• Make sure the volume is turned up .• If using the digital coaxial or optical cable connection ensure the source DIGITAL output is set to PCM, LPCM, PCM 2Ch stereo or PCM downmix .• Bluetooth device not paired . Check 'Bluetooth operation' .
No response from the unit	<ul style="list-style-type: none">• Unplug the power cable for 1 minute then plug back in again .
Remote control does not work	<ul style="list-style-type: none">• Reduce the distance between the remote and main unit• Check the batteries are installed correctly .• Replace the batteries• Aim the remote directly at the Sound bar
Unit powers off after 20 minutes	<ul style="list-style-type: none">• This unit is designed to enter STANDBY mode automatically after 20 MINUTES of inactivity. Press the STANDBY button to wake the unit

Care & maintenance



Important: Always unplug the appliance from the power socket during cleaning and maintenance .

- Ensure the unit is switched off and unplugged from any electrical outlet
- Wipe the case with a slightly moist lint free cloth
- Do not use any cleaning fluids containing alcohol, ammonia or abrasives
- Do not spray an aerosol at or near the object
- Do not allow liquids to spill or objects to drop into any openings
- Do not insert sharp items into speaker grills or any other openings

- Always use the original packaging if it is necessary to transport the unit at any time
- If the unit is used in a dusty environment, it may be necessary to have the unit serviced at your local dealer periodically. It is not advisable to allow large deposits of dust to accumulate within the unit as it may prevent adequate cooling. Similarly dust deposits which become damp can sometimes lead to electrical problems which may cause severe damage to the delicate electronics within this unit.

Specifications

Amplifier	
Power Output	• 75W
Frequency response	• 20Hz - 20KHz \pm 3dB
Input sensitivity	• 550 mV
Main unit	
Power supply	• Input: 100-240V ~ 50-60Hz Output: 24V \pm 1.5A
Power consumption	• 25W
Standby power consumption	• \leq 0.5W
Full range speaker drivers	• Impedance: 8 Ohm, 65mm (2.5") • Frequency response: 250Hz ~ 20KHz
Subwoofer	• Impedance: 8 Ohm, 156mm (6") • Frequency response: 35~250Hz
Dimensions	• Soundbar: 900 x 90 x 60mm (35.43" x 3.54" x 2.36") • Subwoofer: 264 x 251 x 274mm (10.39" x 9.88" x 10.79")
Adaptor cable length	• 1.5m
Remote control	
Battery	• 1 x CR2025
Bluetooth	
Bluetooth compatibility	• EDR, A2DP, AVRCP
Bluetooth version	• 2.1

We apologise for any inconvenience caused by any minor inconsistencies in these instructions, which may occur as a result of product improvements and development.