

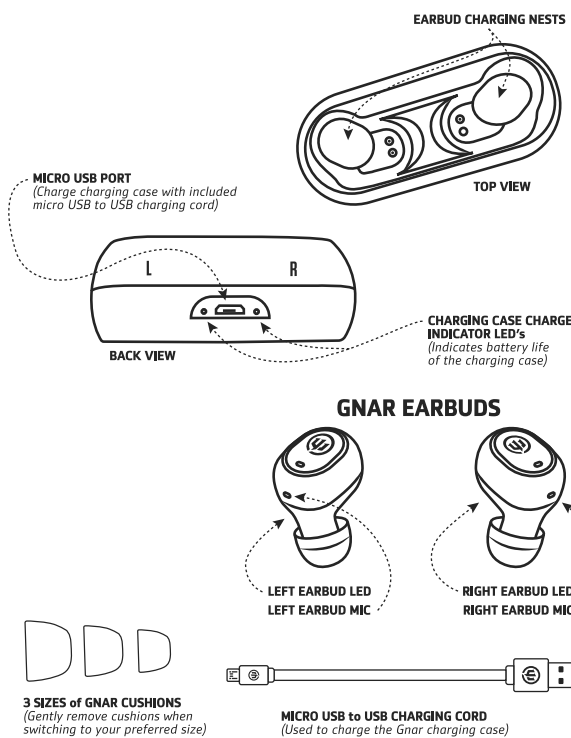

**GNAR** TRUE WIRELESS



**GNAR CHARGING CASE**



1

The charging case will shut down automatically when the Gnar earbuds both reach full charge or when both the earbuds are removed from the case.

**FIRST TIME USE FOR DUAL EARBUD MODE**  
(If you want to use a single earbud, please refer to section "Single Earbud Use" on Page 6.)

- 1 Make sure the Gnar earbuds are charged (Please refer to section "Charging the Gnar Earbuds" on page 2) and Bluetooth device (phone, computer, tablet etc.) is turned on with the Bluetooth feature enabled (this is usually found in settings).
- 2 Remove charged earbuds from charging case. They will turn on and pair together automatically.
- 3 Both earbuds will pair together; both will beep.
- 4 The right earbud, when in dual earbud mode is the "communicator." Once both earbuds are on, the right earbud will flash red and white.
- 5 Your device will detect the Gnar's pairing name "Wicked Gnar". Select "Wicked Gnar" on your device to start pairing to your device.
- 6 The right earbud will beep when paired with your device and then the LED will turn off.
- 7 You're ready to go!

**FUTURE USE AFTER INITIAL PAIRING THE GNAR TO YOUR DEVICE**  
(If this is the first time the Gnar earbuds are being paired to your Bluetooth device, or if the Gnar earbuds were "forgotten", please see "First Time Use" section on Page 3.)  
(If you want to use a single earbud, please refer to section "Single Earbud Use" on Page 6)

3

note when using BOTH earbuds, you can perform this function using EITHER earbud.)

**NEXT/PREVIOUS**

- Next – Two presses on right earbud
- Previous – Two presses on the left earbud

**ANSWER/HANGUP**

When both earbuds are connected, answer or hang up by using a short press on the center button on either the left or right earbud.

**INCOMING CALL**

When receiving an incoming call, the earbuds will detect the device's programmed ringtone (this may differ depending on your device). You can answer by using a short press on the center button on either the left or right earbud.

**LOW BATTERIES**

Please consider charging your Gnar earbuds regularly when not in use to retain ample battery life in both earbuds. When the earbuds have approximately 10% battery life the earbuds will announce "Low Battery." After around 4 minutes the earbud will repeat the announcement and then shut off. Due to right earbud being the main communicator it might lose battery life before the left. At this point you can shut off the left earbud and charge both earbuds, or choose to use the left earbud for an additional time in single earbud mode. Please follow the instructions in the section "First Time Use-For Single Earbud Use" below. Please note that when pairing the Left earbud to your device (using single earbud), you will notice that "Wicked Gnar"

5

**IMPORTANT SAFETY INSTRUCTION**  
Please read these instructions.  
1. Read the instructions.  
2. Keep the instructions.  
3. Follow all instructions.  
4. Follow all instructions.  
Attention should be drawn to the environmental aspects of battery disposal. The use of apparatus in moderate climates.  
This device complies with Industry Canada licence-exempt RSS (Intermittent) conditions. Operation is subject to the following two conditions: (1) This device must accept any interference that may cause undesired operation of the device.  
**PRECAUTIONS**  
**LISTENING TO AUDIO AT EXCESSIVE VOLUMES CAN CAUSE PERMANENT HEARING DAMAGE. USE AS LOW A VOLUME AS POSSIBLE.**  
Over exposure to excessive sound levels can damage your ears resulting in permanent noise-induced hearing loss (NIHL). Please use the following guidelines established by the Occupational Safety Health Administration (OSHA) to help you avoid noise-induced hearing loss:  
**SAFE USE & HAZARD WARNINGS**  
80 dB SPL at 16 hrs, 85 dB SPL at 8 hours, 90 dB SPL at 2 hours, 105 dB SPL at 1 hour, 100 dB SPL at 30 min, 115 dB SPL at 15 min, 120 dB SPL. Avoid as damage may occur.  
**PRECAUTIONS**  
**ÉVITE D'ÉCOUTER DE LA MUSIQUE À UN NIVEAU EXCESSIF. CAR CELA PEUT CAUSER DES DOMMAGES AUDITIFS PERMANENTS.**  
Les bruits émetteurs sonores ont été établis par la Occupational Safety Health Administration (OSHA). Elle souligne le temps maximal d'exposition à divers niveaux de pression sonore avant que des dommages auditifs soient causés. Veuillez utiliser ces lignes directrices afin de limiter votre exposition à des niveaux de bruit élevés et de vous empêcher d'être exposés à une perte auditive permanente.  
**UTILISATION SANS RISQUE ET AVERTISSEMENTS DE DANGER**  
80 dB SPL à 16 hrs, 85 dB SPL à 8 heures, 90 dB SPL à 2 heures, 105 dB SPL à 1 heure, 100 dB SPL à 30 min, 115 dB SPL à 15 min, 120 dB SPL. Évitez de dommages peuvent être causés.  
**ADVERTENCIA**  
ESCUCHAR EL AUDIO EN NIVELES EXCESIVOS DE VOLUMEN PUEDE CAUSAR DAÑOS PERMANENTES AUDITIVOS. USE COMO VOLUMEN MÁS BAJO POSIBLE.  
Durante la exposición a niveles excesivos de ruido puede sufrir los daños relacionados en ruido permanente pérdida de audición inducida (PNI). Por favor, use las siguientes pautas establecidas por la Administración de Seguridad de Salud Ocupacional (OSHA) de tiempo máximo que los niveles de presión de sonido antes de que se produzca la pérdida audición.  
**USO SEGURO DE PELIGROS Y ADVERTENCIAS**  
80 dB SPL a 16 horas, 85 dB SPL a 4 horas, 90 dB SPL a 2 horas, 105 dB SPL a 1 hora, 100 dB SPL a 30 minutos, 115 dB SPL a 15 minutos, 120 dB SPL. Evite que se puede producir daños.

**LIMITED ONE-YEAR WARRANTY**  
Keep your receipt to obtain warranty service. Go to [www.wickedaudio.com](http://www.wickedaudio.com) for more details.  
**GARANTEE LIMITÉE D'UN AN**  
Conservez votre reçu pour obtenir le service en vertu de la garantie. Consultez [www.wickedaudio.com](http://www.wickedaudio.com) pour en savoir plus.  
Developed in Utah, U.S.A.  
Made in China  
Mis au point au Utah  
États-Unis Fabriqué en Chine  
RoHS

7

**CHARGING CASE**

**CHARGING THE CASE**  
To charge the Gnar Charging Case use the included Micro USB to USB charging cord. Connect the Micro USB (smaller side) into the Charging Case and connect USB side into computer or USB wall charger (not included).

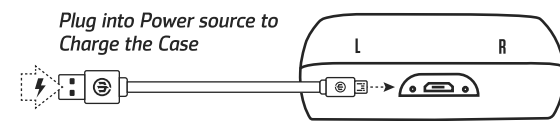

**CHARGING CASE STATUS LEADS:**

- Charging – Solid Green LEDs
- Fully Charged – LEDs off

**EARBUD STATUS LEADS:**

- Charging – Solid Red
- Fully Charged – Flash White then off

**CHARGING THE GNAR EARBUDS**

Delicately place the Gnar earbuds into the earbud charging nests. Make sure each earbud is placed in its corresponding nest. The cushions on the earbud will fall down. A small magnetic pull will help the earbuds fall into the correct position.

The Gnar earbuds will show a red LED when charging. LEDs will flash white then turn off when Gnar earbuds are fully charged.

2

**CONTINUED USE AFTER INITIAL PAIRING OF THE GNAR TO YOUR DEVICE**

Continued use after initial pairing the Gnar to your device  
1 Remove buds (they will pair to each other automatically)  
OR  
2 Earbuds will automatically pair to the last device it was paired to.

**TURNING ON EARBUDS**

There are two ways to turn on the earbuds:  
1 Remove earbuds from their charging case.  
OR  
2 Hold both center buttons for 1-2 seconds. (This is when the earbuds have shut down outside of the charging case.)

**TURNING OFF EARBUDS**

There are two ways to turn off the earbuds:  
1 Place earbuds back into their charging case. They will automatically turn off.  
2 Hold center button, on either right or left earbud for 5 seconds. You will hear a shut down beep.

**DISCONNECTED**

When out of range, or if your device becomes disconnected from the Gnar earbuds, the Gnar earbuds will automatically go into pairing mode with the right earbud's LED flashing white/red and a "beep" and disconnected announcement will play.

**PAUSE/PLAY**

When both earbuds are paired to your device you can pause and play your music by using a short press on the center button with either the left or right earbud. (Please

4

shows up a second time in your pairing name options. Please pair with the newest "Wicked Gnar" option as this will be directly connected to the LEFT earbud.

**NOTE:**  
"Wicked Gnar" might show up in your Bluetooth device's menu twice. This happens when the earbuds go into "single earbud use," or when one earbud is removed from the charging case for several seconds before its partner. Please follow the steps below to reset to one "Wicked Gnar" for future dual earbud use:  
1 Place both earbuds in the charging case to turn them off.  
2 Forget both "Wicked Gnar" devices from your device.  
3 Take both earbuds out of the charging case at the same time (within a few seconds of each other).  
4 A new "Wicked Gnar" will display on your Bluetooth menu. Connect to the new "Wicked Gnar."

**FIRST TIME USE- FOR SINGLE EARBUD USE**

- 1 – Remove one earbud, keep other earbud off and in case.
- 2a Right Side – Right earbud will automatically pair if previously connected to a device.
- 2b Left Side – A second "Wicked Gnar" will appear in Bluetooth menu. Pair to new "Wicked Gnar."

**NOTE: TO RETURN TO "DUAL EARBUD MODE"**

- 1 Place both earbuds in charging case.
- 2 Forget all "Wicked Gnar's" that appear in the Bluetooth available devices menu.
- 3 Follow steps on page 3 for "First Time Use for Dual Earbud Mode"

6

**Limitation of Liability** Any Charges or modifications not expressly approved by the party responsible for compliance with the user's authority to operate the equipment. The device has been evaluated to meet general RF exposure requirements. The device can be used in general exposure condition without restriction. It is not intended for use in any case where the user is not advised by the manufacturer, its distributor or reseller to use it. Use of this device may cause interference with other equipment. This includes, but is not limited to, any and all nature whatsoever arising out of use of or inability to use a product. This includes, without limitation, property damage, loss of data, or any other loss or damage to any product that is used in or with the Wicked Audio product, even if the Wicked Audio product has been advised of the possibility of such damages that one may encounter. Without limiting the foregoing, you understand and agree that Wicked Audio has no liability for any damages or destruction to the customer's electronic devices or other personal property, or any content or data, or any other loss or damage to any product, that is used in or with the Wicked Audio product. Notwithstanding any damages that you might incur for general damages in contract, tort (including negligence), or otherwise, the entire responsibility of Wicked Audio and any of its distributors and/or resellers shall be limited to the amount of actual loss paid by you for the Wicked Audio product giving rise to liability. Some states or jurisdictions do not allow the exclusion or limitation of incidental or consequential damages, so the above limitations or exclusions may not apply to you. The limitations of liability set forth above shall apply to the maximum extent permitted under applicable law.

**FCC Statement** This equipment has been tested and found to comply with the limits for a Class B digital device, pursuant to Part 15 of the FCC rules. These limits are designed to provide reasonable protection against harmful interference in a residential installation. This equipment generates noise and can radiate radio frequency energy. If not installed and used in accordance with the instructions, they may cause harmful interference to radio communications. However, there is no guarantee that interference will not occur in a particular installation. If the equipment does cause harmful interference to radio or television reception, which can be determined by turning the equipment off and on, the user is encouraged to try to correct the interference by one or more of the following measures:  
– Reorient or relocate the receiving antenna.  
– Increase the separation between the equipment and receiver.  
– Connect the equipment into an outlet on a circuit different from that to which the receiver is connected.  
– Consult the dealer or an experienced radio/TV technician for help.  
This device complies with part 15 of the FCC rules. Operation is subject to the following two conditions:  
(1) This device may not cause interference.  
(2) This device must accept any interference, including interference that may cause undesired operation of the device.  
Cet appareil est exempt de licence conformément aux RSS (RSS) d'Interférence. L'opération est soumise aux deux conditions suivantes:  
(1) Cet appareil ne doit pas causer d'interférences.  
(2) Cet appareil doit accepter toutes les interférences, y compris celles susceptibles de provoquer un fonctionnement indésirable de l'appareil.

**MODEL #: W-TW365X**  
**FCC ID: 2APW7W-TW365X**  
**IC: 2655-W7W365X**  
**IC Statement**  
This device contains licence-exempt transmitter(s)/receiver(s) that comply with Innovation, Science and Economic Development Canada's licence-exempt RSS(s). Operation is subject to the following two conditions:  
(1) This device may not cause interference.  
(2) This device must accept any interference, including interference that may cause undesired operation of the device.  
Cet appareil contient des émetteurs / récepteurs exempts de licence conformes aux RSS (RSS) d'Interférence. L'opération est soumise aux deux conditions suivantes:  
(1) Cet appareil ne doit pas causer d'interférences.  
(2) Cet appareil doit accepter toutes les interférences, y compris celles susceptibles de provoquer un fonctionnement indésirable de l'appareil.

8