

135 mm

IOS & ANDROID

INSTALLATION

Search App Store / Google Play for 'Scanmarker Air' app and install on your device.

CONNECTING YOUR SCANMARKER AIR

- Open the Scanmarker app.
- Make sure your device's Bluetooth is turned on.
- Turn your scanner on (see 'Turning Your Scanner On/Off' on page 1)
- Select 'Start' - It will start searching for your Scanmarker Air.
- Tap on the name of your scanner when it appears under 'Select Scanner'.

You should then receive a message that your scanner has successfully connected.

Note: First time pairing requires internet connection and can take slightly longer than usual. After the first-time connection, you will just need to open the app and turn on your scanner in order to connect.

Troubleshooting tip: If the blue light is steady, but isn't connecting to your device - check whether it is connecting to a different device (e.g. computer) that you paired it with previously. Close the Scanmarker application on the other device and try again.

QUICK SETUP

- When starting the app for the first time, the quick setup options will show. (You can always change these settings later by selecting the ⚙️ icon at the bottom right corner of every screen).
- When internet connection is available, it is recommended to connect to the Cloud to facilitate faster processing of scans.

MAIN SCREEN

- After practicing your scanning, you will arrive at the main screen. Following the first-time connection, this is the screen you will always be directed to whenever you start the app and reconnect your Scanmarker Air. It will show you a list here of all your saved documents. Tap the 📄 icon ('New' on iPhone) to start a new document.

The documents are saved as text files and can then be shared as you wish via email, Dropbox, Google Drive etc. Either tap 'share' in the options in your document or share multiple documents at once in the main screen.

5

135 mm

INSIDE YOUR DOCUMENT

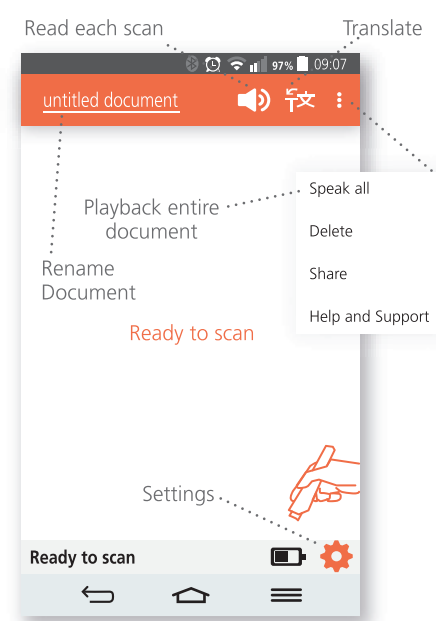

Tip: In order for the next scan to start on a new line, click the scanner down at the end of your scan.

SCANNING TIPS

- Hold your scanner at a 30-60 degree angle
- Place the clear tip of the scanner a little bit before the beginning of the line you wish to scan and end your scanning movement after the end of the line.
- Make sure the text you would like to scan is in the center of the tips when you start scanning (Scanmarker will continue following the line that it originally detected.)
- Scan in a fluid and quite quick motion.
- Avoid applying excessive pressure whilst scanning.
- Practice scanning in the 'Test Device' screen until you are happy with the results.
- When scanning several lines of text, there is no need to wait for the first line to appear on your screen before continuing on to scan the subsequent lines.

If you have any questions, please contact us at support@scanmarker.com and we are always here to help!

6

134.5 mm

scanmarker Air

WIRELESS DIGITAL HIGHLIGHTER

Scanmarker.com



135.5 mm

scanmarker



Scanmarker.com

160 mm

135.5 mm

134.5 mm

135 mm

135 mm

GETTING STARTED WITH YOUR SCANMARKER AIR

It is recommended to charge your Scanmarker Air for 3 hours before first-time use. Charge your Scanmarker Air either using provided USB cable connected to a computer or using a wall mount charger.

TURNING YOUR SCANNER ON/OFF

Note: Software has to be installed and open on your device in order to connect your Scanmarker Air (see instructions below).

To turn on:

Press the transparent tip against a surface for three seconds. The green and blue light will turn on.

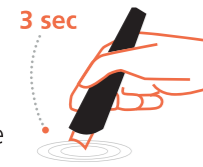

The blue light is the Bluetooth indication. The blue light will blink when scanner is turned on and then turn steady when it has connected to your device.

To turn off:

Click the tip three times (quickly and gently) against a surface.

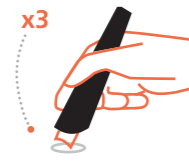

After 12 minutes of inactivity (or two minutes in disconnected mode) your Scanmarker Air will auto-power off.

MAC & WINDOWS

Refer to page 5 for Android & iOS instructions

INSTALLATION

1. Download the relevant software from www.scanmarker.com/software-download
2. Run the downloaded setup file and follow installation instructions.

CONNECTING YOUR SCANMARKER AIR

To connect via Bluetooth:

- **Windows users:** Plug in the Bluetooth dongle provided in package.
- **Mac users:** **Dongle should not be used.** Start with the following step.
- Open Scanmarker application
- Turn your Scanmarker Air on
- The blue light will blink and turn steady when connection has been established.

Alternatively, you can connect to your computer via the USB cable provided.

TOUR

When you connect your Scanmarker Air for the first time the tour will appear. You will be prompted to choose your right-left hand settings and languages. You can always change these options later in the settings.

ACTIVATION

The software requires activation (this step requires internet connection) to continue to use after your 30-day trial. Go to the Activation tab in the settings and fill in the code found on the warranty card included in the package.

SCANNING OPTIONS

You have the choice of either scanning directly to the Scanmarker application or scanning to an external application of your choice.

- Select the icon to scan into the Scanmarker application.
- Select the icon to scan directly into Word or other applications.

The selected scanning option will appear in white.

SCANNING TO DOCUMENT

Select the 'document' icon and place your cursor where you would like the scan to appear. Scanned or translated text will be typed in to your document.

- When scanning to a document, the default setting is that it adds a space after each scan and then continues the following scan on the same line.
- For the following scan to be placed on a new line, click the scanner down at the end of the scan.
- You can change these default settings by clicking on the icon > Settings ... > Scanning > Type-in to external program

Note: There is an additional requirement on Mac OS Mojave 10.14 to enable accessibility for the Scanmarker App in order for this function to work. There should be an automatic prompt asking for access when clicking on the document icon for the first time. If you don't see it, please check for it behind the other apps open on your screen.

[If needed, you can also allow this by opening System Preferences -> Privacy & Security -> click on the Privacy tab -> select Accessibility from the list-> Click the lock icon to make changes -> Check the box next to Scanmarker]

You can minimize here whilst scanning to document.

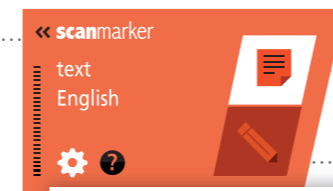

Scan to document
Scan inside Scanmarker application

Uncheck this option when connecting to a new device to ensure that it connects to the correct device (or close application).

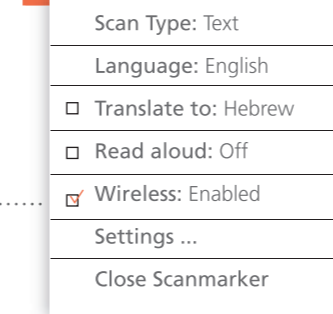

Select here for advanced settings - e.g. to change right/left-handed options, change read aloud speed, test your Scanmarker, help and support.

SCAN TYPE

Text

The default setting for scanning standard lines of text.

Single word

When scanning single words, place the scanner well in front of each word and end the scanning well after the end of the word

Image

Use to scan handwriting, signatures and formulae and they will be inserted alongside the text in your document.

Numbers

When scanning numbers only. (A combination of text and numbers should be scanned using the text option.)

Barcode

For barcode scanning. When scanning barcodes, the scanner should be held differently than usual. The tip of the scanner should be horizontal or inclined in relation to the vertical lines, not parallel to them. It should be held in an angle like this:



Please refer to the tour in the Help & Support tab that demonstrates this clearly.

SCANNING INSIDE THE SCANMARKER WINDOW

When scanning inside the Scanmarker application (with the pencil icon selected) the text will be inserted into the white pop-out window.

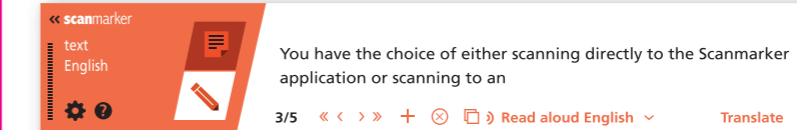

Settings
Number of scans
Insert new scan
Delete current scan (Ctrl+click to delete all)
Select to copy current scan to external application (Ctrl+click to copy all saved scans)
Change scanning language
Select to translate scanned text (It shows both the original and translated text)

160 mm

63.75 mm

63.75 mm

63.75 mm

63.75 mm

WARRANTY

scanmarker Air

TopScan warrants to the original purchaser that the following products (provided that such products were paid for in full), shall be free from defects in material and workmanship, under normal use: (a) the TopScan Scanmarker, for a period of one (1) year from and after amount of years from the date of delivery from Topscan or from the date of download from Topscan's designated website, pending changes in technology and market. TopScan shall have no obligation hereunder for defects caused by purchaser's unreasonable use or accident, immersion in water, neglect, abuse, improper maintenance, modification, mishandling, tampering with or alteration of TopScan products, or any other cause not arising out of defects in workmanship or materials of the product, including the failure to download any appropriate updates, drivers or upgrades of TopScan's products. All warranty claims are subject to: (a) purchaser notifying TopScan of warranty claim within the warranty period; (b) TopScan verifying the existence of a defect in the product and (c) receipt by TopScan of valid proof of purchaser's purchase and the date of such purchase. Upon discovery of any defect in material or workmanship of any TopScan product, pursuant to this limited warranty, the purchaser's exclusive remedies shall be, at TopScan's exclusive discretion option, to have it repaired, receive a replacement or receive a refund of the amount of the purchase price paid thereof. In the event that a product under warranty is repaired or replaced, the replacement will be covered under the original warranty or for 30 days, whichever is longer. Repair, replacement or refund, are the purchaser's exclusive remedies, and TopScan's exclusive liabilities, under this warranty. For wireless products, purchaser must ensure correct and non-interfered communication between the product and the host to which text is to be transferred.

Activation Code

Purchaser must advise and conform to the end user license agreement (eula) attached to the products for additional instructions. The limited Warranty set forth herein and/or under the eula is the only warranty Expressed or implied that topscan makes with respect to topscan Scanmarker and scanmarker software, and all implied warranties, Including any implied warranties of merchantability and/or fitness for a Particular purpose are disclaimed.

Purchaser expressly acknowledges and agrees that use of the topscan Scanmarker and scanmarker software and any of their related services Is at its sole risk and that the entire risk as to satisfactory quality, Performance, accuracy and effort is with the purchaser. Additionally, Purchaser is responsible to use the product with required care in order To prevent any bodily damages such as tennis elbow and/or to the wrist Or other joints, which may be the result of excessive or wrong use of Products similar to the product.

Except for the limited warranty set forth above and to the maximum Extent permitted by applicable law, the topscan scanmarker and the Scanmarker software and adjunct services are provided "as is", with all Faults and without warranty of any kind, and topscan hereby disclaim All other warranties and representations, either express, implied or Statutory. Topscan does not warrant against interference with the Purchaser's enjoyment of the topscan scanmarker and the scanmarker Software or services, that the functions contained in the scanmarker And the scanmarker software or services will meet the purchaser's Requirements, that the operation of the scanmarker and the scanmarker Software or services will be uninterrupted or error-free, or that Defects in the scanmarker and the scanmarker software or services Will be corrected. No oral or written information or advice given by Topscan's authorized representative shall create a warranty. Should the Scanmarker and the scanmarker software or services prove defective, Not due to defects in workmanship or materials of the product, purchaser Assumes the entire cost of all necessary servicing, repair or correction.

© Copyright 2015

Scanmarker™ is a registered Trademark of Topscan Ltd.

All software, hardware, design and implementations are copyright 2015 by Topscan Ltd. All rights reserved

160 mm

63.75 mm

63.75 mm

63.75 mm

63.75 mm



scanmarker.com

scanmarker Air
WARRANTY

160 mm

70 mm

FCC Compliance Statement

This device has been tested and found to comply with the limits for a Class B digital device, pursuant to Part 15 of the FCC Rules. These limits are designed to provide reasonable protection against harmful interference in residential installations. This equipment generates uses and can radiate radio frequency energy and, if not installed and used in accordance with the instructions, may cause harmful interference to radio and television reception. However, there is no guarantee that interference will not occur in a particular installation. If this device does cause such interference, which can be verified by turning the device off and on, the user is encouraged to eliminate the interference by one or more of the following measures:

- Re-orient or re-locate the receiving antenna.
- Increase the distance between the device and the receiver.
- Connect the device to an outlet on a circuit different from the one that supplies power to the receiver.
- Consult the dealer or an experienced radio/TV technician.

WARNING! Changes or modifications to this unit not expressly approved by the party responsible for compliance could void the user's authority to operate the equipment.

This device complies with FCC Rules Part 15). Operation is subject to two conditions:
(1) This device may not cause harmful interference, and (2) this device must accept any interference that may be received or that may cause undesired operation.

To comply with FCC Section 1.310 for human exposure to radio frequency electromagnetic fields and IC requirements, implement the following instruction:

This equipment complies with the FCC RF radiation exposure limits.

160 mm