



AZULLE®

QUICK GUIDE



ELITE

Mini Desktop PC



WHAT'S IN THE BOX?

1



Elite

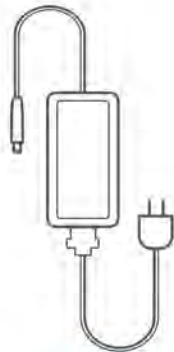

Power Adapter
19V/5A

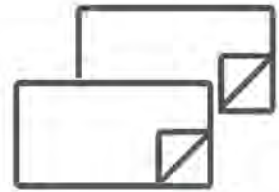

Thermal Pad

INSTALLATION INSTRUCTIONS

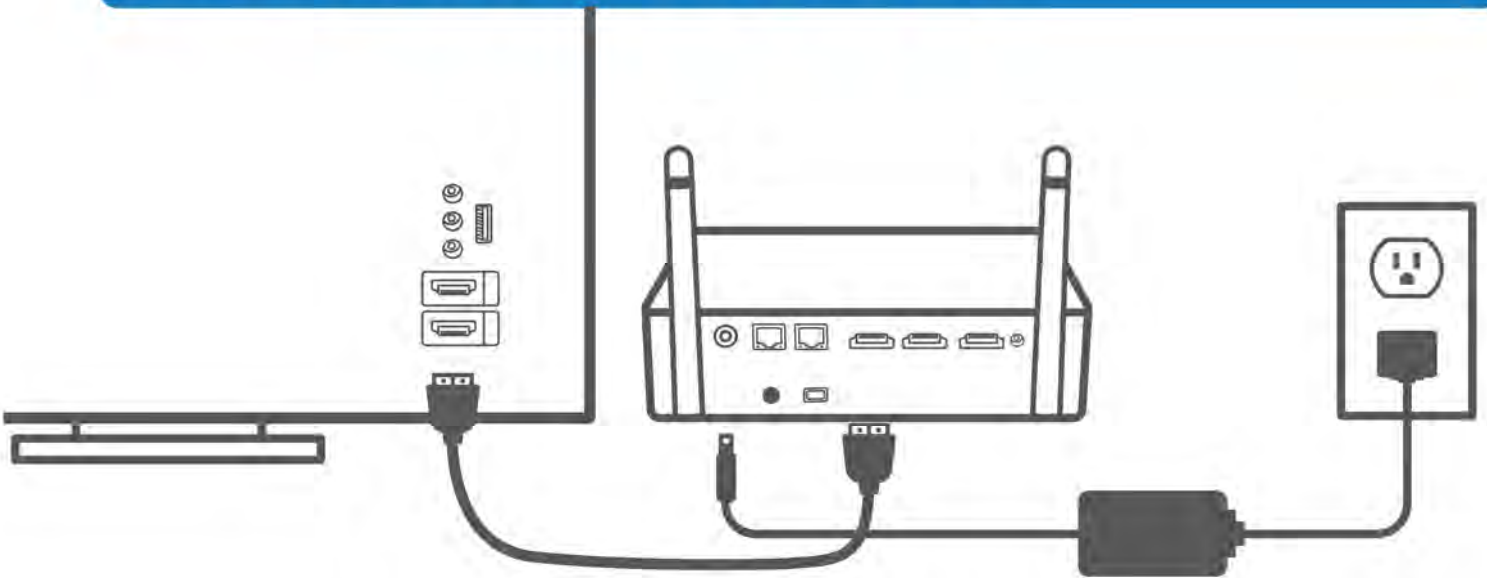

- 1 Connect to your chosen input on your monitor or TV.
- 2 Plug-in device using your desired display output.
- 3 Connect the power adapter.
- 4 Choose your input, connect your accessories and enjoy.

NEED HELP?

2

We're Here For You!



Live Chat
azulle.com



Technical Support
786.233.6769 Ext.1



E-mail
support@azulle.com

For video tutorials, visit our YouTube channel: [Youtube.com/AzulleTech](https://www.youtube.com/AzulleTech)
Learn how to get more out of your device on our blog, by visiting:
[Azulle.com/blog](https://www.azulle.com/blog)

THINK SOLUTIONS

Find the perfect match for your device. Visit our shop to browse accessories and discover how our mini PC's can power solutions for your business, from digital signage to IoT.



Digital Signage



Kiosks



IoT



Thin Client

PORT LAYOUT

3



1 USB-C 4.0

2 USB 3.1

3 USB 2.0

4 Micro SD Slot

5 Power Input

6 Ethernet

7 Kensington Lock

8 HDMI

9 3.5 mm Audio Jack

Stay In Touch

Follow us on social media to keep up with the latest news and share your #MiniMoments with us! @AzulleTech #GoMini

Sign-up for our Newsletter to receive exclusive offers and be the first to find out about releases at Azulle.com/contact-us



SPECIFICATIONS

5

PROCESSOR	Intel Raptor Lake i3-1315U(4.5GHZ) Intel Raptor Lake i5-1340P(4.6GHZ) Intel Raptor Lake i7-1360P(5.0GHZ)
PROCESSOR/CPU COUNT	6, 12, 12
PROCESSOR CACHE	10MB, 12MB, 18MB Intel Smart Cache
RAM	None/8GB/16GB/32GB/64GB DDR4
STORAGE	None/128GB/960GB SSD
OPERATING SYSTEM	No OS / Windows 11 Pro / IoT / Ubuntu / ChromeOSFLEX
WI-FI	AX201 802.11AX, 2X2 ,2.4Gbps
GPU	Intel® UHD Graphics for 13th Gen Intel® Processors (i3) Intel® Iris® XE Graphics (i5, i7)
ETHERNET	LAN - x1, 1Gbps and LAN - x1, 2.5Gbps
BLUETOOTH	5.1
HDMI	3x HDMI® 2.0
HDMI OUTPUT	4K @60FPS
USB PORTS	2x USB 3.1, 2x 2.0
TYPE-C	1x USB 4.0 Supports 8k Video
MICRO SD CARD SLOT	1x Supports largest MicroSD available
SSD SUPPORT	M2 M-KEY slot - NVME SSD 2280, Support 4X PCIE4.0 M2 B-KEY slot - SATA3 6GT/S SSD 2242 or 4G module, or RF Module
AUDIO OUTPUT	Aux/HDMI
POWER SUPPLY	19V/5A
WEIGHT	1.19 lb
DIMENSIONES	6.6 x 5.2 x 1.5 in
WEIGHT PACKAGED	3.18 lb
DIMENSIONS PACKAGED	11.2 x 7.8 x 2.9 in

EXPANDING CAPACITY

6

1. Twist and turn rubber screws. (A piece of fabric or paper is recommended for a better screw grip.)



2. Open up the bottom of the unit to expand RAM or storage.

Scan the QR code to check out a video tutorial on how to install storage or RAM to your Azulle mini PC.



*Intel, the Intel logo, and Intel Core are trademarks of Intel Corporation or its subsidiaries.

*Windows is either a registered trademark or a trademark of Microsoft Corporation in the United States and/or other countries.

*The terms HDMI, HDMI High-Definition Multimedia Interface, HDMI trade dress and the HDMI Logos are trademarks or registered trademarks of HDMI Licensing Administrator, Inc.

This device complies with Part 15 of the FCC Rules. Operation is subject to the following two conditions: (1) this device may not cause harmful interference, and (2) this device must accept any interference received, including interference that may cause undesired operation.

This equipment has been tested and found to comply with the limits for a Class B digital device, pursuant to Part 15 of the FCC Rules. These limits are designed to provide reasonable protection against harmful interference in a residential installation. This equipment generates uses and can radiate radio frequency energy and, if not installed and used in accordance with the instructions, may cause harmful interference to radio communications. However, there is no guarantee that interference will not occur in a particular installation. If this equipment does cause harmful interference to radio or television reception, which can be determined by turning the equipment off and on, the user is encouraged to try to correct the interference by one or more of the following measures:

- Reorient or relocate the receiving antenna.
- Increase the separation between the equipment and receiver.
- Connect the equipment to an outlet on a circuit different from that to which the receiver is connected.
- Consult the dealer or an experienced radio/TV technician for help.

Changes or modifications not expressly approved by the party responsible for compliance could void the user's authority to operate the equipment.

To maintain compliance with FCC's RF exposure guidelines, this equipment should be installed and operated with a minimum separation distance of 20 cm between the equipment and a person's body. Use only the supplied antenna.

FCC ID: 2AFJI-B4L0RA



AZULLE®

GUIA RAPIDA



ELITE

Mini PC



¿QUÉ HAY EN LA CAJA?

1



Elite

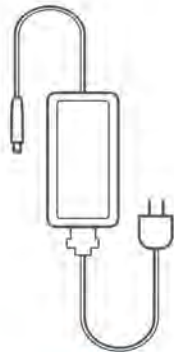

Adaptador de Corriente
19V/5A

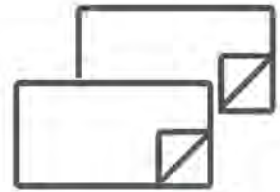

Pasta Térmica

INSTALACIÓN

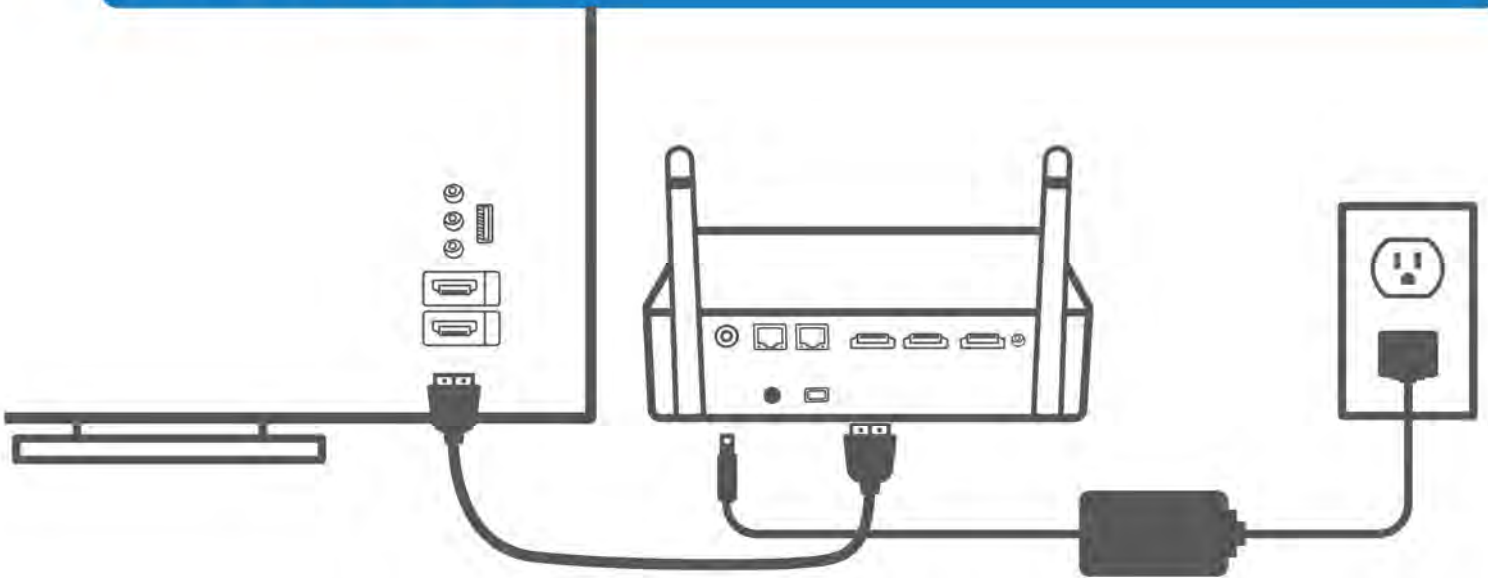

- 1 Conecte a la entrada elegida en su monitor o TV.
- 2 Conecte el dispositivo usando la salida de audio de su preferencia.
- 3 Conecte el adaptador de corriente.
- 4 Seleccione su input, conecte los accesorios que desee y disfrut.

¿NECESITA AYUDA?

2

¡Estamos aquí para usted!



Chat en Vivo

azulle.com



Soporte Técnico

786.233.6769 ext.1



E-mail

support@azulle.com

Para ver videotutoriales, visite nuestro canal de YouTube: [YouTube.com/AzulleTech](https://www.youtube.com/AzulleTech)
Aprenda a cómo sacar el máximo provecho a su dispositivo en nuestro blog,
visitando [Azulle.com/blog](https://www.azulle.com/blog)

PIENSA EN SOLUCIONES

Encuentra la combinación perfecta para tu dispositivo. Visita nuestra tienda para explorar accesorios y descubrir cómo nuestras mini PC pueden impulsar soluciones para tu negocio, desde señalización digital hasta IoT.



**Señalización
Digital**



Kioscos



IoT



Thin Client



1 USB-C 4.0

2 USB 3.1

3 USB 2.0

4 Ranura Para
Tarjeta Micro SD

5 Entrada de Corriente

6 Ethernet

7 Kensington Lock

8 Salida HD

9 3.5 mm Salida
de Audio

Manténgase en Contacto

Síguenos en nuestras redes sociales para estar al día de las últimas novedades y compartir sus #MiniMomentos con nosotros! @AzulleTech #GoMini

Suscríbese a nuestro boletín para recibir ofertas exclusivas y ser el primero en enterarse de los nuevos lanzamientos visitando Azulle.com/contact-us



PROCESADOR	Intel Raptor Lake i3-1315U(4.5GHZ) Intel Raptor Lake i5-1340P(4.6GHZ) Intel Raptor Lake i7-1360P(5.0GHZ)
NUCLEOS DEL PROCESADOR/CPU	6, 12, 12
PROCESADOR CACHÉ	10MB, 12MB, 18MB Intel Smart Cache
RAM	Ninguno/8GB/16GB/32GB/64GB DDR4
ALMACENAMIENTO	Ninguno/128GB/960GB SSD
SISTEMA OPERATIVO	Sin sistema operativo/ Windows 11 Pro / IoT / Ubuntu / ChromeOSFLEX
WI-FI	AX201 802.11AX, 2X2 ,2.4Gbps
GPU	Intel® UHD Graphics for 13th Gen Intel® Processors (i3) Intel® Iris® XE Graphics (i5, i7)
ETHERNET	LAN - x1, 1Gbps and LAN - x1, 2.5Gbps
BLUETOOTH	5.1
HDMI	3x HDMI 2.0
SALIDA HDMI	4K @60FPS
USB PORTS	2x USB 3.1, 2x 2.0
PUERTO TIPO-C	1x USB 4.0 que admite vídeo 8K
RANURA PARA TARJETA MICRO SD	1x Compatible con la tarjeta microSD más grande disponible
SOPORTE PARA SSD	Ranura M2 M-KEY - NVME SSD 2280, compatible con 4X PCIE4.0 M2 B-KEY slot - SATA3 6GT/S SSD 2242 or 4G module, or RF Module
SALIDA DE AUDIO	Aux/HDMI
FUENTE DE ALIMENTACIÓN	19V/5A
PESO	1.19 lb
DIMENSIONES	6.6 x 5.2 x 1.5 in
PESO (EMPAQUETADO)	3.18 lb
DIMENSIONES (EMPAQUETADO)	11.2 x 7.8 x 2.9 in

CÓMO EXPANDIR LA CAPACIDAD

6

1. Gire los tornillos de goma. (Se recomienda un pedazo de tela o papel para un mejor agarre.)

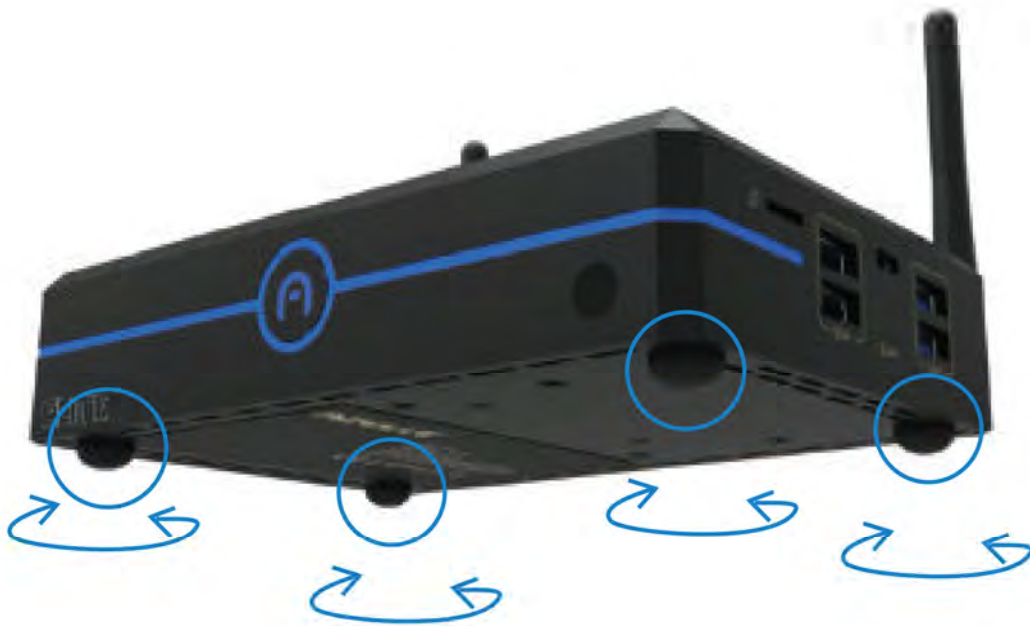

2. Abra la parte inferior de la unidad para expandir la memoria RAM o el almacenamiento.

Escanee el código QR para ver un video tutorial sobre como instalar almacenamiento o RAM en su mini PC de Azulle.

