

Product Overview

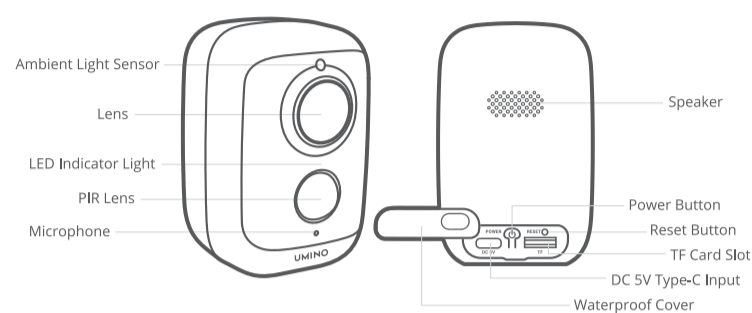

Power button:
Press and hold the power button for **5 seconds** to turn on/off the camera.

Reset button:
Use the reset pin to hold the reset button for **5 seconds** until you hear the audio notification.

LED indicator light

Light indication	Definition
Blue, blinking slowly	Turning on the camera, waiting for Wi-Fi connection
Red, solid	Camera charging (red light will turn off when fully charged)
Blue, solid	Camera connected to Wi-Fi in wireless mode
Blue, flashing quickly	Connecting to Wi-Fi
Solid green	Camera connecting in AP mode
Green and blue blinking slowly and simultaneously	Camera reset
Green and blue blinking quickly and alternatively	Firmware upgrading
Green and blue blinking quickly and simultaneously	Low battery

Technical supports

- For more detailed and updated instructions, please visit our website umino.io
- For further questions, you can get help from the following ways:
 - Email to hi@umino.io
 - Message us on our Facebook: [facebook.com/umino.io](https://www.facebook.com/umino.io)

Get the Umino App

Search and download the "Umino" app from Apple App Store or Google Play Store, or by scanning the QR code below.



① Allow the two permissions shown below after downloading the Umino app.

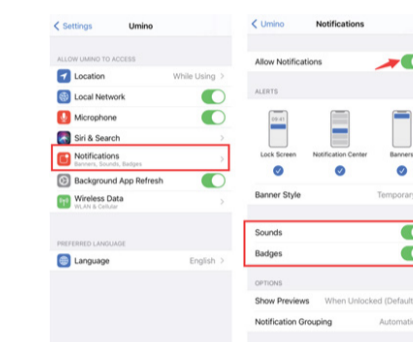

(1) To successfully add the camera, allow the Umino App to use mobile cellular data and wireless LAN.

(2) Allow Umino to show system push messages or enable sound alarms.

Set Up Camera on Umino App

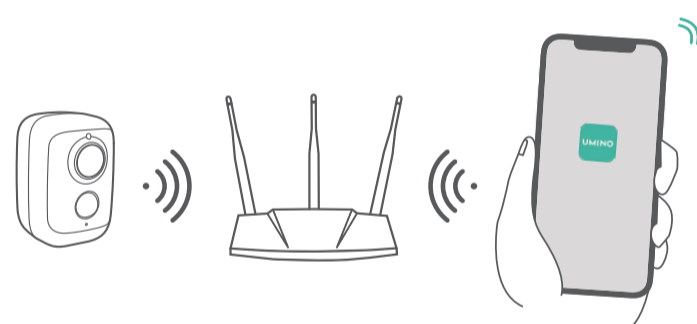

- Get your camera closer to your phone and your home router (within 3 feet or 1 meter)
- Power on the camera
- Open the Umino App on your phone
- Follow the in-app setup process to complete the configuration

① Please wait until the blue indicator light of the camera is flashing slowly and plays an audio prompt to set up the camera Wi-Fi connection. The camera only supports 2.4GHz Wi-Fi.

If you fail to connect, try using AP mode to connect the camera.

- Press reset the camera.
- Use your mobile phone to scan Wi-Fi, search for "UMC-00XXXXX".
- Connect to "UMC-00XXXXX".
- Return to the Umino app to configure Wi-Fi settings.
- Connect to your 2.4GHz home Wi-Fi in the Umino app Wi-Fi setting. (5GHz Wi-Fi is not supported).

After connecting to the router, you can monitor the camera on your mobile devices remotely with the Umino app.

① Please remember to configure your Wi-Fi settings, or you won't be able to monitor your camera outdoors under 4G LTE network.

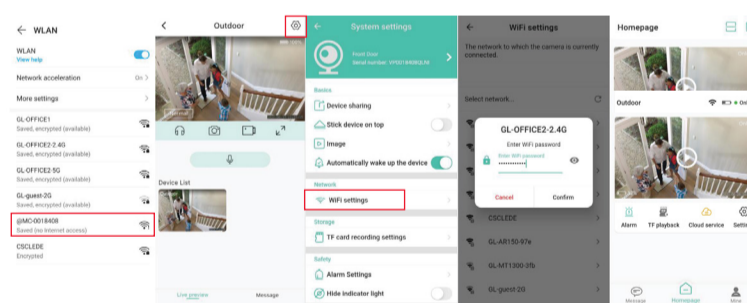

Mount the Camera

Things to prepare:

- Fully charged Umino camera x 1
- Mounting screws and anchors x 3
- Mounting bracket x 1
- Screwdriver x 1 (not included in the package)
- Impact drill x 1 (optional, not included in the package)

Installation instructions:

- Find the location where the camera can be mounted and receive a good signal from your home Wi-Fi.
- Mark the location of the three mounting holes on your wall.
- Drill three holes according to the marks on your wall, and then push the provided anchors into these holes. Using anchors is optional if you're mounting the camera on wood or siding.
- Mount the mounting bracket with screws on the wall, and tighten them by using a screwdriver.
- Attach the camera to the mounting bracket clockwise.
- Adjust the angle to max. 360° horizontally and max. 90° vertically to find a better view. Avoid rotating the camera counterclockwise to keep it fixed on the mounting bracket.
- Tighten the ball joint counterclockwise to fix your desired angle.

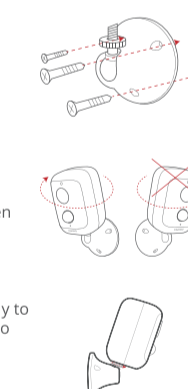

Safety

FCC Statement

- This device complies with Part 15 of the FCC Rules. Operation is subject to the following two conditions:
 - This device must not cause harmful interference, and
 - This device must accept any interference received, including interference that may cause undesired operation.
 - Changes or modifications not expressly approved by the party responsible for compliance could void the user's authority to operate the equipment.
3. Note: This equipment has been tested and found to comply with the limits for a Class B digital device, pursuant to part 15 of the FCC Rules. These limits are designed to provide reasonable protection against harmful interference in a residential installation. This equipment generates uses and can radiate radio frequency energy and, if not installed and used in accordance with the instructions, may cause harmful interference to radio communications. However, there is no guarantee that interference will not occur in a particular installation. If this equipment does cause harmful interference to radio or television reception, which can be determined by turning the equipment off and on, the user is encouraged to try to correct the interference by one or more of the following measures:
- Reorient or relocate the receiving antenna.
 - Increase the separation between the equipment and receiver.
 - Connect the equipment into an outlet on a circuit different from that to which the receiver is connected.
 - Consult the dealer or an experienced radio/TV technician for help.
- FCC Radiation Exposure Statement
This equipment complies with FCC radiation exposure limits set forth for an uncontrolled environment. This equipment should be installed and operated with minimum distance 20cm between the radiator and your body. This transmitter must not be co-located or operating in conjunction with any other antenna or transmitter.

Hereby, GL TECHNOLOGIES (HONG KONG) LIMITED declares that the radio equipment type (Battery IP Camera AE1, Battery IP Camera AE2) is in compliance with the essential requirements and other relevant provisions of Directive 2014/53/EU. The full text of the EU declaration of conformity is available at the following internet address: <https://www.umino.io/products/certificate>

Caution:
This product uses WiFi 2.4GHz Operating Frequency is 2400-2483.5MHz/20dBm
The Product comply with Directive 2011/65/EU and its amendment directive 2015/863/EU (RoHS2.0)

Ver. 20210706

要求:

- 颜色: ■ C66 M0 Y42 K0
■ C0 M0 Y0 K80

- 尺寸及材质: 440*100mm, 折叠后完成品: 110*100mm/ 128g铜版纸
- 双面 / 彩色 / 凤琴式折页 / 3折4页
- 虚线为折置位置

GL·iNet 深圳市广联智通科技有限公司		产品名称	umino说明书 (用于UMINO AE1、AE2)
		物料编码	505-0221
设计		单位/比例	mm/1:1
审核		尺寸	440*100mm
标准化		材质	128g铜版纸 / 3折4页 / 双面彩印
批准		日期	2021/07/06