

USER MANUAL



1. Contents

- 1.1. Bluetooth keyboard 1pc
- 1.2. Instruction manual 1pc
- 1.3. USB Charging cable 1pc

2. Product Features

- 2.1. Use Broadcom 20730 main control chip, have Bluetooth 3.0 interface.
- 2.2. Industry leading bluetooth solutions, WIDCOMM BTW(Microsoft officially designated software) bluetooth software
- 2.3. Built-in power management software, can be in Microsoft's Windows system automatically usable capacity.
- 2.4. With folding design, keyboard can be carried easily
- 2.5. Mute design: effectively avoid disturbing other sleeping person (especially for one room with several person)Architecture design ,provides comfortable handling feel
- 2.6. Support iPhone,Mac,Windows and Android system etc, It's more convenient for you
- 2.7. Waterproof, anti-pollution, dustproof

3. Specifications

- 3.01. Executive standard: Bluetooth V3.0
- 3.02. Maximum operating distance: 10 meters
- 3.03. Modulation mode: 2.4G straight sequence fh(FHSS)
- 3.04. Transmit power: Class 2 levels
- 3.05. Working voltage: 3.7V
- 3.06. Working current: 1.5MA
- 3.07. Standby current: 1.0MA
- 3.08. Sleep current: 40uA
- 3.09. Charging current: 150mA
- 3.10. Standby time: 150 days
- 3.11. Theoretical use time: 30 days (average 2 hours everyday)
- 3.12. continuous uninterrupted use time:60 hours
- 3.13 theoretical charging time:1.5-2 hours
- 3.14. Lithium battery capacity:110mAh
- 3.15. The key dynamics:60+10g
- 3.16. Button life:5 million times

3.17.Operation temperature:0-55℃

3.18.Storage temperature:-10-60℃

4. Pairing Procedures

4.1. Attention: please confirm the tablet system before turning on the keyboard.

4.2. Keyboard pair with ios system tablets

(1) As picture below, press the power button, keyboard blue LED indicator will flashing about 3 seconds then extinguished, indicate the keyboard is on, then press the pairing button about 5

seconds  keyboard status LED indicator flashing, indicate the keyboard is pairing status



(2) Click iPad "setting" icon, choose "Bluetooth" item ,turn on the bluetooth, then the iPad will searching bluetooth device.



(3) When iPad found "Bluetooth keyboard 3.0", click "Bluetooth keyboard 3.0", then the keyboard and iPad can connect successfully.

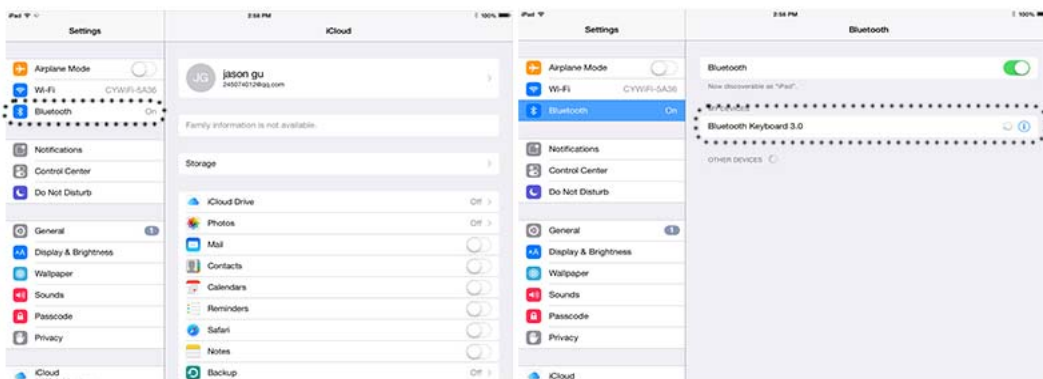

(4) When keyboard pairing successfully, press FN+S, keyboard can compatible with ios system

4.3. Keyboard pair with Android system tablets:

(1) As picture below, press the power button, keyboard blue LED indicator will flashing about 3 seconds then extinguished ,indicate the keyboard is on, then press the pairing button about 5

seconds, keyboard status LED indicator flashing, indicate the keyboard is pairing status

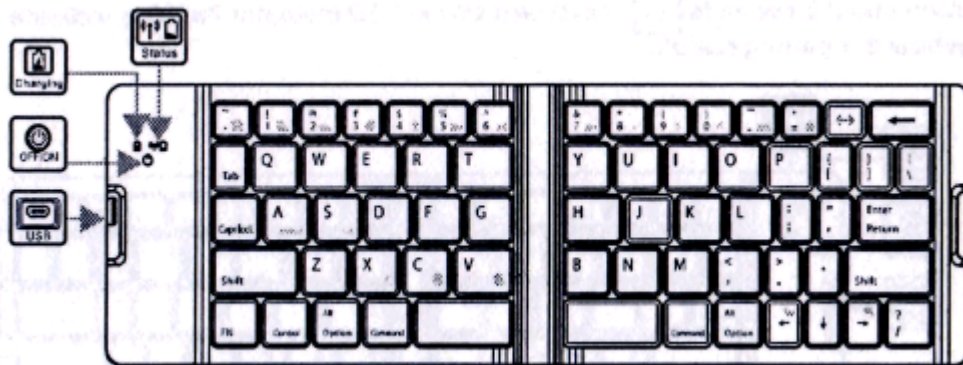

(2) Click the application button on Android device, then choose “setting” button.

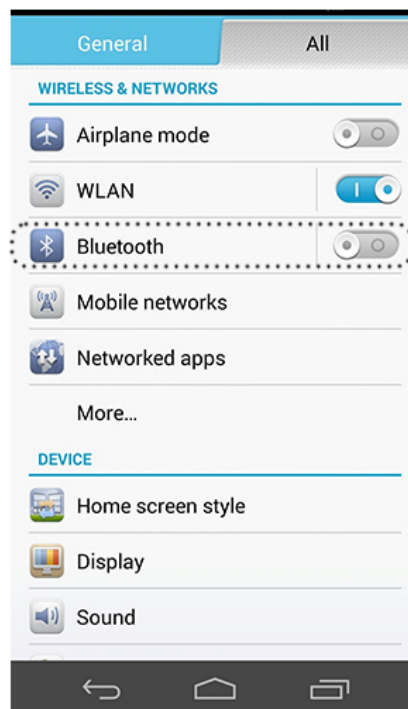

(3) Turn on the Bluetooth and search for available device, then Android tablets will search for bluetooth device, click the “bluetooth keyboard 3.0” achieve the connection between the keyboard and Android tablets.

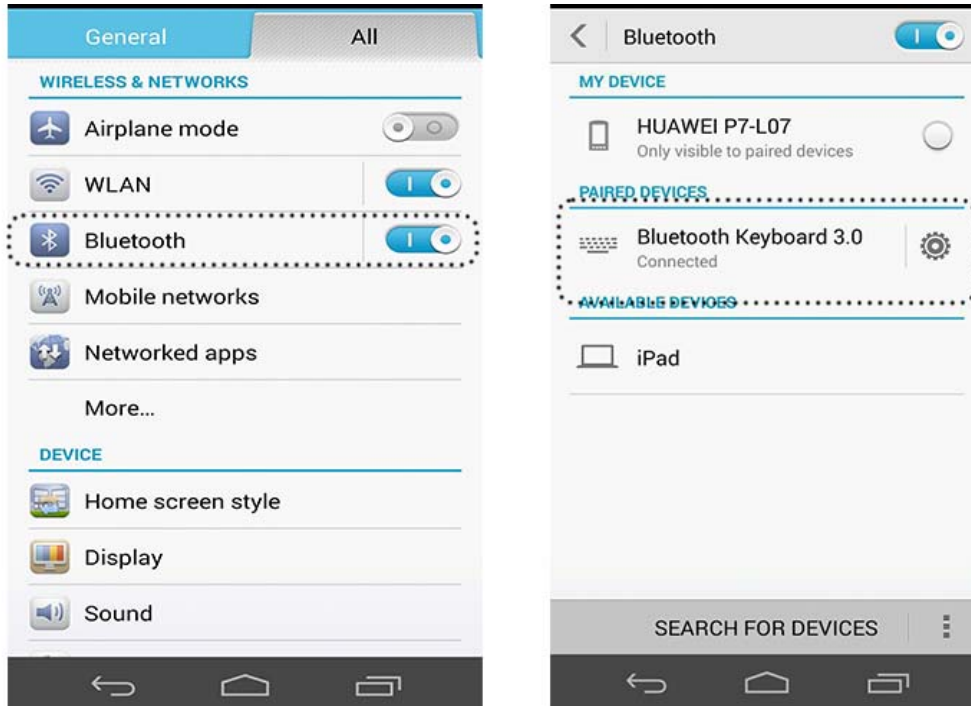

A
Android

(4) When keyboard pairing successfully, press Fn+ A, keyboard can compatible with Android system.

5. Charging

When you use keyboard in process, the status tinkle which advise you the battery is shortage, you should charging .

Charging procedure below:

(1) Separate put the USB terminal cable plug into the PC and keyboard .As follow picture.

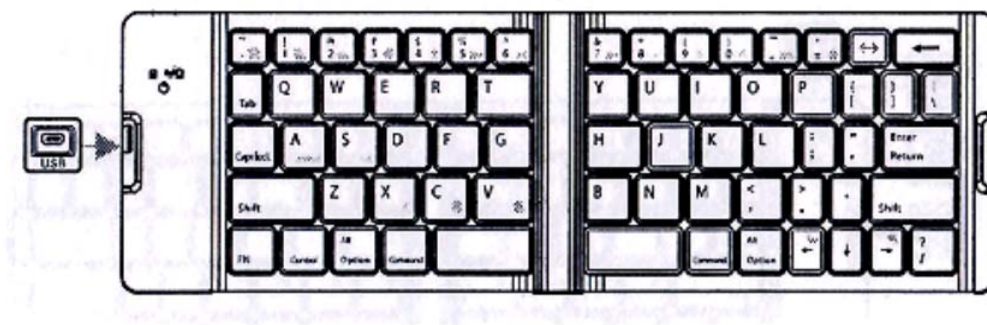

(2) When you charging ,the charging LED indicator is red, when the light off, the battery is full enough.(theoretical charging time 1.5-2 hours)

6. Hot-key specifications



Press this button can realize the function of “~”, FN + this button to realize ”return home page” function, shift + this button to realize ”~” function.



Press this button can realize the digital function of “1”,FN + this button to realize “searching “function, shift + this button to realize”!” function



Press this button can realize the digital function of “2”, FN + this button to realize “virtual keyboard” function, shift + this button to realize”@” function.



Press this button can realize the digital function of “3”, FN + this button to realize “language switch” function, shift + this button to realize ”#” function.



Press this button can realize the digital function of “4”,FN + this button to realize “siri” function, shift + this button to realize ”\$” function.



Press this button can realize the digital function of “5”, FN + this button to realize “previous song ” function, shift + this button to realize ”%” function.



Press this button can realize the digital function of “6”, FN + this button to realize “play/pause” function, shift + this button to realize ”^” function.



Press this button can realize the digital function of “7”, FN + this button to realize “next song” function, shift + this button to realize ”&” function.



Press this button can realize the digital function of “8”, FN + this button to realize “mute” function, shift + this button to realize ”*” function.



Press this button can realize the digital function of “9”, FN + this button to realize “reduce volume” function, shift + this button to realize “(” function.



Press this button can realize the digital function of “0”, FN + this button to realize “increase volume” function, shift + this button to realize “)” function.



Press this button can realize the digital function of “_”, FN + this button to realize “running from background” function, shift + this button to realize “-” function.



Press this button can realize the function of “=”, FN + this button to realize “locking” function, shift + this button to realize “+” function.



Press this button about 5 seconds to pairing status.



FN + this button to realize “cutting” function.



FN + this button to realize the “copy” function.



FN + this button to realize “Paste” function.



FN + this button to realize turn left function.



FN + this button to realize turn right function.

(1) When you don't want to use the keyboard and carry. Don't forget turn off the power switch of keyboard in order to extend your battery life span.

(3) If you want to store the keyboard long time. Don't forget charging the keyboard around 1 hour till the battery half which can extend your battery life span.

8. Troubles shooting

Keyboard and iPad cannot establish connections

- ① Please check your iPad bluetooth device is already open and went in search of state.
- ② Press and release the "connect" button of keyboard, check the Status indicator flash or not.
- ③ Keyboard and iPad connected within 10 meters from working range.
- ④ Bluetooth devices of iPad changing or not. If it is, need to match again.
- ⑤ Your iPad bluetooth device is also connected to the other bluetooth terminal and confirm iPad bluetooth device speed.
- ⑥ Checking your battery, if there is electricity shortage, please recharge.

Federal Communication Commission Interference Statement

FCC statement

This equipment has been tested and found to comply with the limits for a Class B digital device, pursuant to Part 15 of the FCC Rules; these limits are designed to provide reasonable protection against harmful interference in a residential installation. This equipment generates, uses, and can radiate radio frequency energy and, if not installed and used in accordance with the instructions, may cause harmful interference to radio communications. However, there is no guarantee that interference will not occur in a particular installation. If this equipment does cause harmful interference to radio or television reception, which can be determined by turning the equipment off and on, the user is encouraged to try to correct the interference by one or more of the following measures:

- Reorient or relocate the receiving antenna.
- Increase the separation between the equipment and receiver.
- Connect the equipment into an outlet on a circuit different from that to which the receiver is connected.
- Consult an authorized dealer or service representative for help.

To assure continued compliance, any changes or modifications not expressly approved by the party.

1). This equipment complies with FCC radiation exposure limits set forth for an uncontrolled environment. End users must follow the specific operating instructions for satisfying RF exposure compliance.

2). This transmitter must not be co-located or operating in conjunction with any other antenna or transmitter.

RF warning statement:

The device has been evaluated to meet general RF exposure requirement. The device can be used in portable exposure condition without restriction.

The Bluetooth® word mark and logos are registered trademarks owned by Bluetooth SIG, Inc. and any use of such marks by Shenzhen Gtide Technology Co., LTD is under license. Other trademarks and trade names are those of their respective owners.