

## Introduce of the Multi-function speaker charging box

### **Spec for the speaker**

Bluetooth solution: CSR64110

Speaker's size: 60x77mm

Weight: 95g

Working voltage: 3.4-4.2V

Lithium battery capacity: 550mAh

Working time: 4.5H

Charging times: about 7 times

Frequency range: 2.402-2.480GHz

Channel spacing: 2MHz

Transmitted power: CLASS 2

Frequency: call: 8kHz&16kHz

music: 44.1kHz&48kHz

Modulation mode: GFSK, ( $\pi/4$ )DQPSK, 8DPSK

Driver diameter: 40MM

Driver power: 3W

Impedance: 4 $\Omega$

Frequency response: 20Hz~26KHz

Microphone: 4015

Microphone sensitivity: 42db $\pm$ 3db

Microphone direction: Omnidirectional

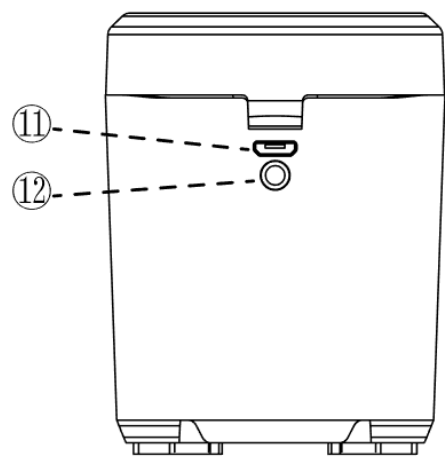
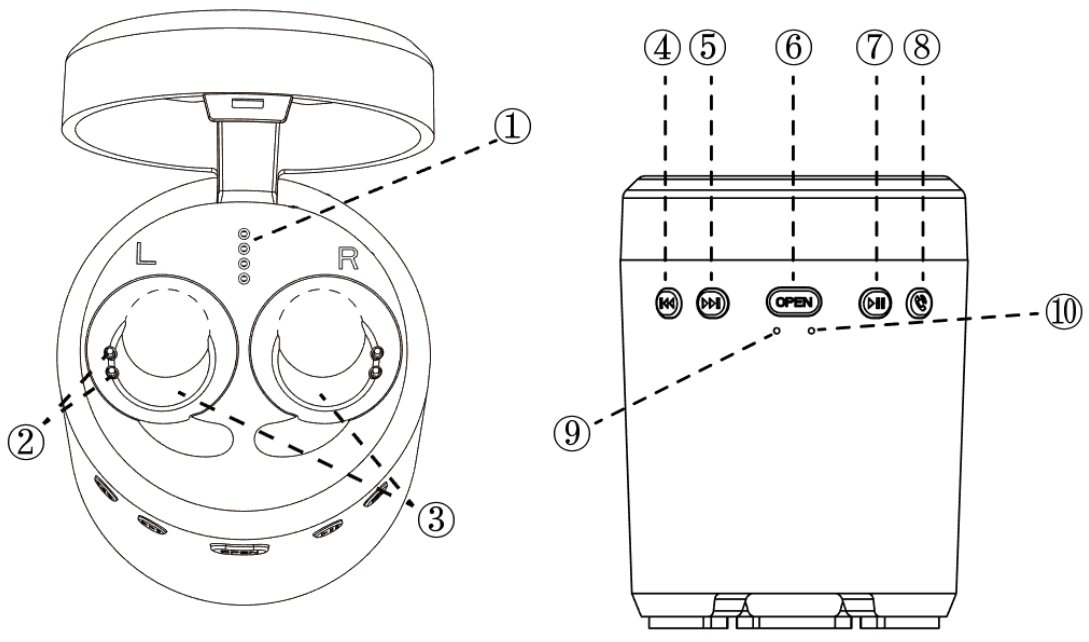

1. Speaker power indicator light
2. Speaker headset charging contact port
3. Speaker headset charging
4. Previous/+Volume key
5. Next track/-Volume key
6. Open key
7. Play/Pause/Power on/Power off
8. Talk answer/hang off
9. Red and blue light
10. MIC input port
11. USB charging port(Power input port)
12. Line in port (An external input audio source)

### Speaker pairing

1. Pairing speaking: press and hold play/stop key to turn on for 2 seconds, release when the red light and blue light flash alternatively, the bluetooth headset enters pairing state. Open the Bluetooth of your mobilephone, IPAD, or computer bluetooth and search, click the according model NO, if success pairing, will occur reminding sound.

2. Turn on and return connect: usually after first time device be connected, when turn on device next time, the speaker will try to automatically connect mobilephone which be paired lastest time.

### Speaker operating Instructions

type	Basic function	Operations and instructions
Basic function	Bluebooth name	S19 PLUS
	Press key	OPEN open cover key, play/stop key. next/reduce volume key, last/add volume, light key.
	LED	1 red light 1 blue light (pairing reminding light), 1 red 3 green light( reminding light of power storage)
	Turn on	press and hold play/stop key to start for 2 seconds, release when the red light and blue light flash alternatively and occur the reminding sound.(when start up device next time, the speaker will try to automatically connect mobile which be paired lastest time.)
	Turn off	press and hold play/stop key to turn on for 2 seconds,
	Enter paring mode	Long press Play/Pause key on the speaker to power on for 2 seconds, until red/blue double indicator lights flash anternately and match hint sound, It means the speaker enter into paring mode

	Paring overtime	After entering paring mode for 60 seconds,if without any operation,Will exit paring mode,enter disconnect
	Autamatically power off	Such as bluetooth don't reconnect with mobile after more than 10 minutes, Automatically shutdown
Call	Cancelling	Cancel calls before getting through by pressing Play/pause button on the speaker panel.
	Receiving	Get through by short-pressing Play/pause button on the speaker panel.
	Rejecting	Reject calls by long-pressing Play/pause button for 2 seconds on the speaker panel.
	Hung-up	Finish calls by pressing Play/pause button on the speaker panel.
	Volume+	Increase volume by pressing last song-button on the speaker panel.
	Volume-	Decrease volume by pressing next song-button on the speaker panel.
Music	Pause	Suspend music by pressing Play/pause button on the speaker panel.
	Playing	Replay music by pressing Play/pause button on the speaker panel.
	Volume+	Increase volume by pressing last song-button on the speaker panel.
	Volume-	Decrease volume by pressing next song-button on the speaker panel.
	Last song	Switch to the last song by long pressing the last song-button on the speaker pannel.
	Next song	Switch to the next song by long pressing the next song-button on the speaker pannel.
Reconnecti on	Startup connecting	When power off,press play/pause button for 2 second,then release,bluetooth will automatically reconnect with the last mobil phone.(If fail,short press MFB buttom for automatical connection )
	Click key connecting	When bluetooth disconnected,press play/pause button on speaker panel,which can reconnect the last equipment.If failed,it can automatically go into pairing model.
	Connecting from Mobil phone	When speaker fails to connect with mobil phone,reconnection can be done from mobil phone.
	Connecting after lost out of range	When bluetooth works beyond the normal range,it can automatically return to the normal range(If it can not,lightly press MFB button for automatical connection )

Power	Battery indicator	Can see power mentioned on the speaker after connect ISO device
	Low battery indicator	Red light will flash 1 time every 30 second when the power lower 3.3v, have notification voice when lower power
	Low power off	1,Power off when the device lower 3.0V 2,in the lower power condition
	Charging(electricity)	Can charging power for speaker when insert USB in it, the red light will keep lighting when you are charging. The red light will be close when power is full
	If charging is resetted	Yes(Note:Operate reset action when the speaker is charging,Will shutdown to reset if charging in a state of power on)

### Cautions

In mobile phone bluetooth Settings, and the machine matching options checked telephone (for mobile phone audio)condition, can be a hands-free calls.

This product has a bluetooth signal anti-jamming design, can effectively prevent the signal interference;But in the very high frequency and electromagnetic field environment still has interference to earphone, should be appropriate to avoid using earphone under such an environment.

Bluetooth for two-way transmission equipment, different users play side transmission distance will be affected.It is recommended to use comply with the regulations of relevant industry bluetooth play.

If you use the automatic reconnect function, part mobilephone or computer' s player willnot autoplay after reconnect.

If disconnect bluetooth, when you turn off the headset, there is a delay in the mobilephone.

6.This bluetooth headset for two-way transmission equipment, bluetooth devices with users to communicate with each other;When using anomalies or bluetooth signal instability, user bluetooth device when the battery voltage is low, bluetooth headset sound quality also changes with user audio quality.

7.If it is not to be used for a long time,please be sure to charge it at least once in a month,in order to prevent the damage caused by excessive consumption of lithium-ion batteries.

8.Do not use it under particularly cold,hot,dusty,wet,high frequency or strong magnetic environment.

9 Do not let the machine falling down or clash with stiff objects when using,otherwise it may cause the surface damage/battery damage/or other hardware damage.

10 You'd better avoid to operating this machine in dry environment,in order to prevent electrostatic.

11 This machine does not have waterproof function.

! Do not use it near the water,do not put it into any liquid.

! Do not use it near any heat source

! Adjust the volume to the appropriate volume in order to prevent damage to your health and equipment.

FCC Warning Statements:

1. This device complies with Part 15 of the FCC Rules.Operation is subject to the following two conditions:

(1) This device may not cause harmful interference, and

(2) This device must accept any interference received,including interference that may cause undesired operation.

2. Changes or modifications not expressly approved by the party responsible for compliance could void

the user's authority to operate the equipment.

NOTE: This equipment has been tested and found to comply with the limits for a Class B digital device, pursuant to Part 15 of the FCC Rules. These limits are designed to provide reasonable protection against harmful interference in a residential installation. This equipment generates , uses and can radiate radio frequency energy and, if not installed and used in accordance with the instructions, may cause harmful interference to radio communications. However, there is no guarantee that interference will not occur in a particular installation. If this equipment does cause harmful interference to radio or television reception, which can be determined by turning the equipment off and on, the user is encouraged to try to correct the interference by one or more of the following measures:

- - Reorient or relocate the receiving antenna.
- - Increase the separation between the equipment and receiver.
- - Connect the equipment into an outlet on a circuit different from that to which the receiver is connected.
- - Consult the dealer or an experienced radio/TV technician for help.

RWD INDUSTRIAL CO.,LTD