



TT-SK016  
USER MANUAL  
SOUND BASE SYSTEM

## Contents

---

Features .....	2
For your Attention.....	3
Panel.....	4-5
Connections.....	6-7
Remote Control.....	8-9
Basic Playback.....	10
Trouble shooting.....	11
Specifications.....	12

# Features

---

Thanks for your purchase of our product. Please read through this manual before making connections and operating this product. Retain this manual for future reference.

- Line input
- Optical input
- Bluetooth playback

## Package Contents:

**User manual**



**Remote control**



**AC adaptor**



## For Your Attention

---

### IMPORTANT NOTES:

- Please read through this manual before making connections and operating this product. Retain this manual for future reference.
- Don't open the cabinet of this unit. No user-serviceable parts inside. Refer servicing to qualified personnel only.
- Switch off the unit when you don't use it. Switch off the unit and disconnect it from the AC power supply when it is not being used for a long time.
- Don't install the unit in a place exposed to heating sources or direct sunshine.
- Don't install the unit in a place exposed to moisture or rain.
- The apparatus shall not be exposed to dripping or splashing and any object filled with liquids, such as vases shall not be placed on it.
- Install the unit on a horizontal, flat and firm surface with good ventilation. Never block the vents which will cause malfunction resulted from overheating.
- Use a soft and clean rag to clean the outside of the unit. Never clean it with chemicals or detergent.
- This book is only a guide for user's operation, not a criterion for configuration.
- 
- 



The lightning flash is intended to alert the user to the presence of dangerous voltage within the product's enclosure, and touching the internal components may result in a risk of electric shock to persons.



The exclamatory mark is intended to alert the user to the presence of important operating instructions.



To reduce the risk of electric shock or fire, do not open the cover. Refer servicing to qualified service personnel.

# Panel

---

## FRONT PANEL:

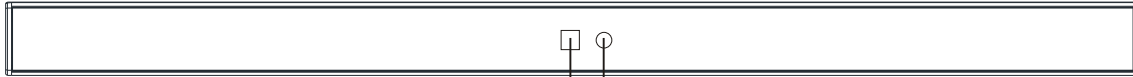

- 1 REMOTE SENSOR
- 2 MODE INDICATOR LIGHT



## TOP PANEL:

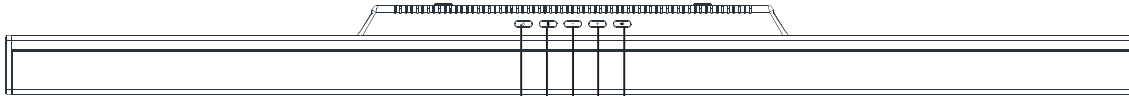

- 1 STANDBY
- 2 BLUETOOTH
- 3 VOLUME-
- 4 VOLUME+
- 5 SOURCE

## Panel

---

### REAR PANEL:

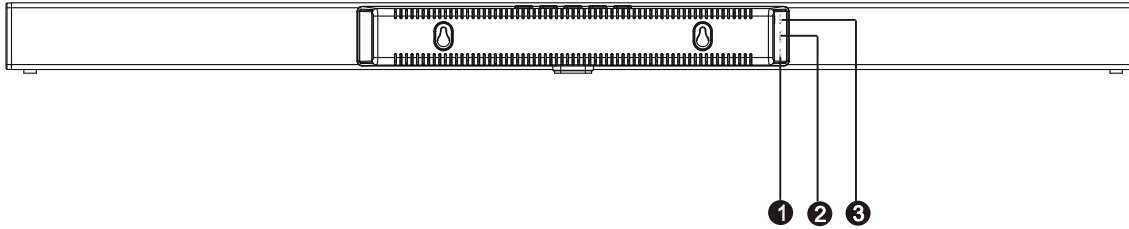

1 DC IN(DC18V/2.2A)

2 OPTICAL DIGITAL AUDIO INPUT

3 LINE IN

## Connections

---

### LINE IN

This sound base has an extra groups of audio input terminals. You can input the analogue stereo audio signals from extra devices such as VCD, CD, VCR, DVD player, etc.

Use the audio cable to connect the stereo audio output terminals of a VCD, CD, VCR, DVD player to the stereo input terminals **LINE IN** of this sound base.

Its corresponding signal source is **LINE IN** which can be available while the indicator light keep solid green by pressing [AUDIO] button on the remote control.

### Optical Input

Use the optical cable to connect the optical input of this sound base to the optical output of VCD, CD, VCR, DVD player.

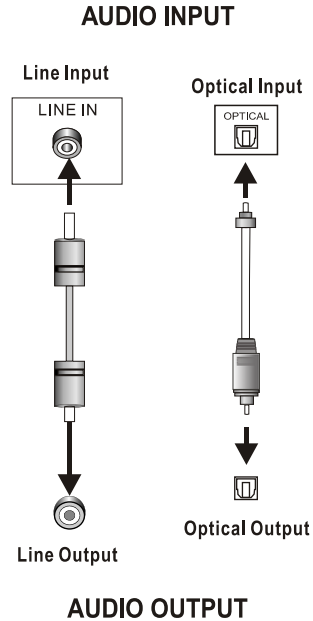

## Connections

---

### BLUETOOTH

Press **STANDBY** button on the remote control to power on the sound base, then press **BT** button on the remote control to switch the bluetooth mode, the blue bluetooth indicator will be flashing quickly, the sound base is in searching bluetooth signal status, use your smart phone to search the bluetooth signal of the sound base, select TT-SK016 on your list, input the password 0000 if need the password prompt, the sound base will synchronize to play songs on your mobile phone while the bluetooth indicator light keep solid blue light means to be connected successfully. Disconnected the bluetooth on the smartphone to switched off the bluetooth connection.

Note: ●Bluetooth connection range in 10 meters.

●The model TT-SK016 in your device was not deleted.

●In bluetooth mode, [PLAY/PAUSE], [NEXT], [PREVIOUS], [VOLUME +/-] etc. are also active.

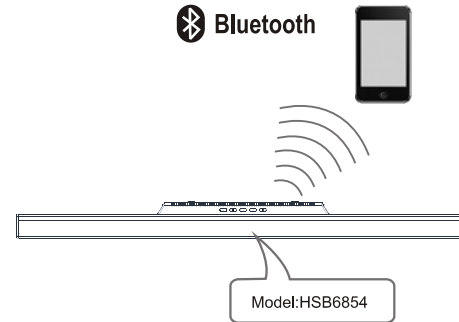



# Remote control

## Remote Control Operation

Insert the batteries into the remote control. Point the remote control at the remote sensor on the front panel. The remote control works within a distance of about 8 metres from the sensor and within an angle of about 30 degrees from the left and right side.

## Battery Installation

- 1 Remove the battery compartment cover on the back of the remote control.
- 2 Load one AAA/1.5V battery into the battery compartment making sure that the battery have been inserted with the correct polarities matching the symbols +, - as indicated inside the battery compartment.
- 3 Replace the cover.

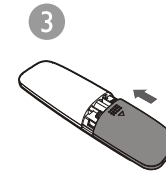
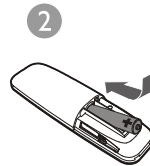
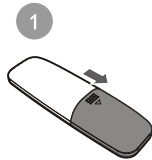

### Note:

- Remove the battery when you do not intend to use the remote control for a long time.
- Weak batteries can leak and severely damage the remote control.
- The battery must not be exposed to excessive heat source, such as sunshine, fire or any other things like that.
- Be environmentally friendly and dispose of batteries according to your government regulations.

# Remote Control

---

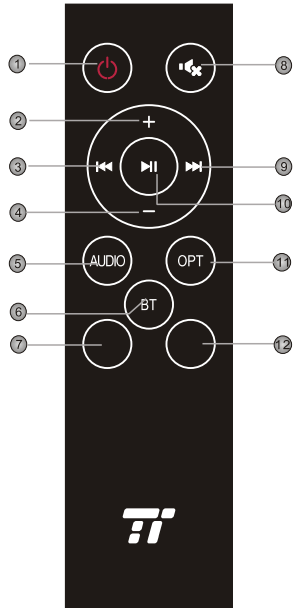

- 1 STANDBY
- 2 VOLUME+
- 3 PREVIOUS
- 4 VOLUME-
- 5 AUDIO
- 6 BT
- 7 INVALID
- 8 MUTE
- 9 NEXT
- 10 PLAY/PAUSE
- 11 OPTICAL
- 12 INVALID

# Basic Playback

---

## Operation

STANDBY



● Press to switch on the unit. Press it again to put the unit in standby mode.(STANDBY mode-red indicator)



● Press to enter to bluetooth mode.(bluetooth mode -blue indicator)



● Press to enter to OPTICAL IN mode.(OPTICAL mode-red and green indicator)



● Press to enter to LINE IN mode.(LINE IN mode-green indicator)



● Press to temporarily pause a playback. Press it again to resume the playback.  
● Hold down this button for 3seconds to disconnect bluetooth.



● Press to skip to the next track.



● Press to return to the previous track.

MUTE



● Press to temporarily switch off the sound . Press it again to switch it on.



● Press [VOLUME+] to turn up the volume.



● Press [VOLUME-] to turn down the volume.

NOTE:The BT/LINE/OPT mode indicator light will shows about twenty seconds in playing status ,then the indicator light will turn out automatically.

# Troubleshooting

Before resorting to maintenance service, please kindly check by yourself with the following chart.

Symptom	Cause(s)	Remedy
<b>No Power</b>	<ul style="list-style-type: none"> <li>● The AC power cord of the adaptor is not connected to the power supply or is not connected to a power supply</li> </ul>	<ul style="list-style-type: none"> <li>● Please check that the AC power cord of the adaptor is connected securely.</li> </ul>
<b>Sound</b> There is no sound or the sound is distorted.	<ul style="list-style-type: none"> <li>● The audio cables aren't connected securely.</li> <li>● The volume is set to the minimum level.</li> <li>● The sound is switched off.</li> </ul>	<ul style="list-style-type: none"> <li>● Connect the audio cables securely.</li> <li>● Turn up the volume.</li> <li>● Press [MUTE] on the remote control to switch on the sound.</li> <li>● Press [PLAY/PAUSE].</li> </ul>
<b>The remote control does not function.</b>	<ul style="list-style-type: none"> <li>● There is no battery in the remote control.</li> <li>● The batteries are out of charge.</li> <li>● The remote control isn't pointed to the remote sensor.</li> <li>● The remote control is out of its operating area.</li> <li>● The unit is shut down.</li> </ul>	<ul style="list-style-type: none"> <li>● Install one AAA/1.5V battery in it.</li> <li>● Replace the batteries with new ones.</li> <li>● Make sure that the remote control is pointed to the remote control sensor.</li> <li>● Make sure the remote control is within the operating area.</li> <li>● Switch off the unit and disconnect it from the AC outlet. Then power on the unit again.</li> </ul>

## Specifications

Power supply		AC ~100-240V,50/60Hz DC18V/2.2A
Working environment	Temperature	-10~+35℃
	Relative humidity	5%~90%
Power output (Max)		18WX2
Frequency response		± 3dB(20Hz~20kHz)

Caution: The user is cautioned that changes or modifications not expressly approved by the party responsible for compliance could void the user's authority to operate the equipment.

This device complies with Part 15 of the FCC Rules. Operation is subject to the following two conditions:

- (1) this device may not cause harmful interference, and
- (2) this device must accept any interference received, including interference that may cause undesired operation.

NOTE: This equipment has been tested and found to comply with the limits for a Class B digital device, pursuant to Part 15 of the FCC Rules. These limits are designed to provide reasonable protection against harmful interference in a residential installation.

This equipment generates, uses and can radiate radio frequency energy and, if not installed and used in accordance with the instructions, may cause harmful interference to radio communications. However, there is no guarantee that interference will not occur in a particular installation. If this equipment does cause harmful interference to radio or television reception, which can be determined by turning the equipment off and on, the user is encouraged to try to correct the interference by one or more of the following measures:

- Reorient or relocate the receiving antenna.
- Increase the separation between the equipment and receiver.
- Connect the equipment into an outlet on a circuit different from that to which the receiver is connected.
- Consult the dealer or an experienced radio/TV technician for help.

FCC Radiation Exposure Statement:

This equipment complies with FCC radiation exposure limits set forth for an uncontrolled environment.

This transmitter must not be co-located or operating in conjunction with any other antenna or transmitter.

