

rookie®

SMART JUMP ROPE
SYNC WITH MOBILE

USER MANUAL

TANGRAM®

INCLUDED COMPONENTS

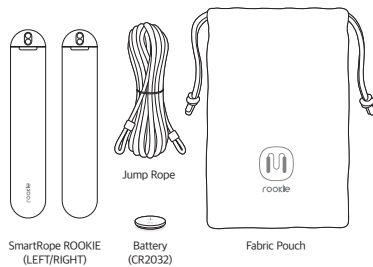

SETTING UP

Inserting the battery The battery is contained within the right handle. To take out the battery, first hold the right handle and pressing down on the areas indicated through the arrows of step 1 of the instruction images and pulling the outer case from the body. Get the battery out of the body by pulling the battery holder from the body of the right handle as indicated in step 2, and taking out the battery. After closing the battery holder and reattaching the outer casing to the body of the right handle; detach the outer casing of the left handle and open the battery holder. Insert the battery into the left handle battery holder and make sure the (+) of the battery faces up as shown in step 3. You can store an extra battery in the right handle, and it is better to hold the battery in the right handle if you are not using the rope, so as not to deplete the battery.

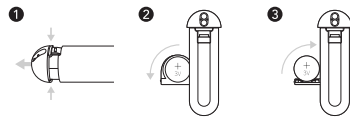

Hookup the rope First, attach the rope to the rope holder, by inserting the rope into the holes on the end of the Rookie as shown on the instruction drawings. It is better to adjust the length of the rope after inserting the rope into the holes.

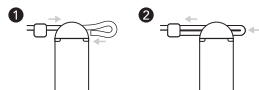

Changing the battery The left handle of the Rookie contains the electronic components. Remove the outer casing of the body by holding the left handle and pressing down on the areas indicated through the arrows of step 1 of the instruction images and pulling the outer case from the body. Use a pin or another small, thin object to open the battery holder, by applying force into the hole on the other side of the battery holder opening as indicated in step 2 of the instruction manual. This will cause the battery holder to pop open, and you can then insert the new battery. If you insert the battery correctly, it will make a noticeable sound. After inserting the battery, close the battery cover and reassemble the handle.

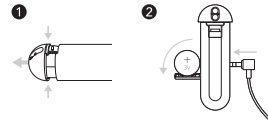

FUNCTIONS

Power The Rookie is turned on by simply turning the left handle; the Rookie will make a small sound when powered on. If there is no movement, the device turns off automatically after 10 seconds.

Recording Workout sets are automatically recorded and saved after 5 handle rotations. Sets can only be saved and checked through the Smart Rope app provided by Tangram Factory, Inc. [Rookie] memories up to 1000 sets of exercise data.

Mobile Application Search "Smart Rope" in the Play Store or App Store (depending on your mobile device) to download the exclusive application for Tangram Factory, Inc. products. Turn on the Rookie and launch the application, it will connect automatically. The maximum connection distance between a mobile device and the Rookie is 10 meters, depending on geographical features.



RESET

Removing and (re)inserting a battery will automatically reset the product. Previous data will be erased after resetting.

This product is an electronic product, in harsh environments malfunctions and device errors may occur. The communication distance between this product and the smartphone may vary depending on the performance of the smartphone device or the surrounding environment.

SAFETY MANUAL

1. The battery should be kept away from children. Please follow the correct procedures when disposing of the battery. / 2. Seek immediate medical attention if you or someone else has swallowed the battery. / 3. Please insert the battery correctly according to the (+) and (-) symbols on the battery. Do not recharge, disassemble, or heat up the battery, this may cause fire or an explosion. / 4. If the proper battery type (CR2032,3V) is not used for the Product, it may lead to problems. You should therefore use the recommended battery type. / 5. Do not use the rope if it has been damaged, because this may lead to injuries.

CAUTION

1. Any type of liquid or high degrees of moisture can lead to damage to the product and the electrical circuit. / 2. Strong electromagnetic radiation and strong magnetism can cause the Product to malfunction. / 3. Do not expose the product to prolonged periods of extreme temperature conditions. / 4. Throwing and dropping of the product can lead to breakage. / 5. Electrical discharge and spilled battery fluid can damage to the product. Please remove the battery, if you do not plan on using for a long period of time. / 6. Product tampering will lead to loss of warranty. / 7. Do not use the product for anything other than the intended purpose. / 8. When cleaning, use strong chemicals or strong detergents to can corrosion or discoloration of the product.

QUALITY GUARANTEE

Thank you for purchasing a Tangram, Inc. product.
Tangram Factory, Inc. Smart Rope products strictly follow quality assurance procedures. The warranty period is 60 days from the purchase date and during this period we offer free exchange and repair of the product. If the product has been improperly used or the quality assurance period has passed, a fee will apply.

PRODUCT SPECIFICATION

Battery Type : Lithium Battery (CR2032, 3V)
Battery usage period: About 6 months
Battery standby period: About 12 months
Bluetooth communication distance: Approximately 10 meters
Input voltage: 3.0V (Typical)
Max/Min usage Voltage: 3.3V ~ 2.0V
Min/Max usage temperature: -10°C ~ 50°C

This product is a class B electromagnetic compatibility equipment intended for household use, and can be used in all environments. There is a possibility that radio equipment is malfunctioning, and that service stability cannot be guaranteed.

PRODUCT INFORMATION

Product name : SmartRope Rookie
Model number : SR100
Company name : Tangram Factory, Inc.
Manufacturer : Tangram Factory, Inc.
Country of Origin : Republic of Korea
Manufacture date : Separately Marked

CERTIFICATIONS

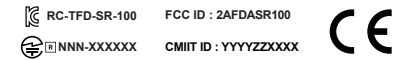

FCC Part 15.19
This device complies with part 15 of the FCC Rules. Operation is subject to the following two conditions: (1) This device may not cause harmful interference, and (2) this device must accept any interference received, including interference that may cause undesired operation.

FCC Part 15.21
Any changes or modifications (including the antennas) to this device that are not expressly approved by the manufacturer may void the user's authority to operate the equipment.

FCC RF Radiation Exposure Statement
This equipment complies with FCC RF Radiation exposure limits set forth for an uncontrolled environment. This device and its antenna must not be co-located or operating in conjunction with any other antenna or transmitter. This equipment should be installed and operated with a minimum distance of 20 cm between the radiator and your body.

CMIIT ID 号码用产品铭牌方式标识 (S/N:XXXXXX)

For more information and to contact AS
Please refer to homepage.

Homepage : tangramfactory.com
Email : cs@tangramfactory.com



TANGRAM®

DESIGNED BY TANGRAM, MADE IN KOREA.
COPYRIGHT 2018 TANGRAM, INC. ALL RIGHTS RESERVED.