

# 尺寸: 350x100mm 80g双胶纸 双面单黑印刷 风琴折

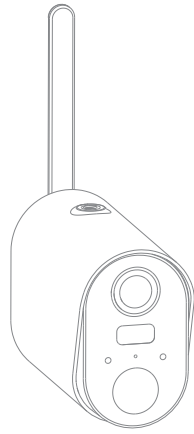

## User Manual for Battery Bullet Camera

### Package Accessories

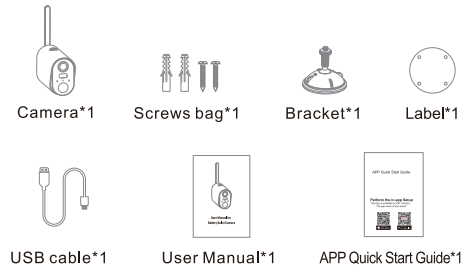

### Product Features

- Support 10,000mAh Rechargeable battery to keep it work 5-6 months.
- External antenna , enhanced WiFi Signal with longer transmission distance
- IR LED and spotlight optional, see color at night
- Support solar panel integrated
- 6-10 Meters distance of PIR motion detection

### Product Specification

Lens	Wide-angle lens DFOV 120°
IR LED	2pcs 850nm infrared Leds
Spotlights	2pcs 6500K White Leds
PIR Motion	6-10 Meters PIR distance
Storage	8~128GB Mirco-SD card TUYA Cloud Storage
WiFi	802.11b/g/n WiFi@2.4GHz
Battery	2*2600mAh or 3*2600mAh or 2*5000mAh
Charging mode	USB DC5V or Solar panel
Video Compression	H.265/H.264
Video resolution	1920*1080
Voice Intercom	Two-way audio with noise cancellation
Charging Temperature	0~45°C
Working Temperature	-10~ 55°C
Voice control	Google assistant and Amazon alexa ( Optional )

### Product Design

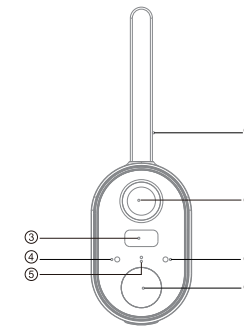

- ① Antenna
- ② Lens
- ③ IRLED&White LED
- ④ Light sensor
- ⑤ Mic
- ⑥ Status Lights
- ⑦ PIR

**Status Lights:**  
Red light: Red light is steady on, indicating WiFi connection failure  
Blue light: Blue light is steady on, indicating WiFi connection successful

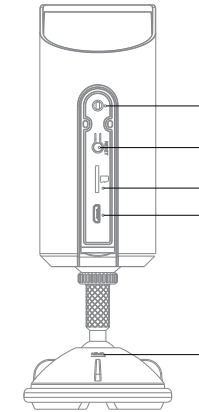

- ① Power Button
- ② Reset Button
- ③ Micro-SD
- ④ Micro USB
- ⑤ Mounting bracket

### Install your camera

Before install camera, please ensure that the camera has been added to the APP

Step 1: Drill 4 holes on the wall according to the sticker of installation, then knock 4 plastic plug inside each hole.

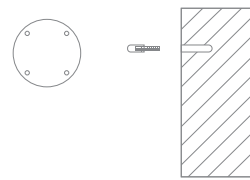

Step 2: Separate the bracket follow below diagram, fix the base plate on the wall with screws.

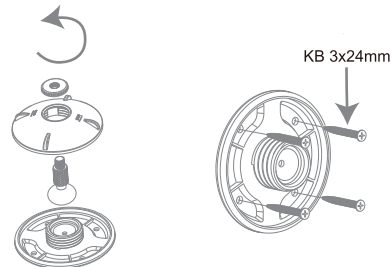

Step 3: Place the universal ball into the groove in the middle of the base plate, put the bracket cover through the universal ball and tighten it up clockwise, then twist the rotary knob to the screw column of the universal ball.

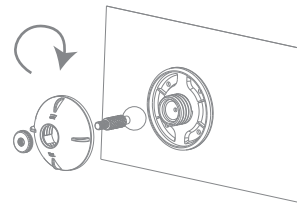

Step 4: Insert the Micro-SD card to the camera, twist the camera to the screw column of the bracket, adjust the camera to a suitable angle, then fix the cover of bracket.

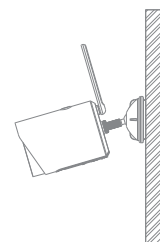

### Solar panel installation(Optional accessories)

A. Integrate with camera (make sure the install position is easy to get sunshine)

Step 1: Fix the base plate of bracket on the back of solar panel with 2 screws.

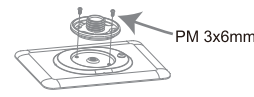

Step 2: Fix the universal ball, cover and rotary knob to the bracket.



Step 3: Rotate the screw column of universal ball to the nut on the top of the camera.

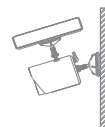

Step 4: Adjust the angle of solar panel face to the sunshine, generally 45° face to south is advisable. Connect the usb plug of solar panel to the usb connector at the bottom of the camera.



B. Separate with camera

Step 1: Install the bracket of solar panel at a position easy to get sunshine.



Step 2: Rotate the screw column of universal ball to the nut on the back of the solar panel.



Step 3: Adjust the angle of solar panel face to the sunshine, generally 45° face to south is advisable.



Step 4: Connect the usb plug of solar panel to the usb connector at the bottom of the camera.

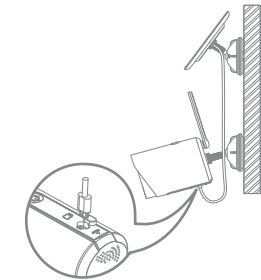

### Notes:

How to reduce the misinformation

1. Do not install the camera under any strong light environment, including direct sunshine, bright lights, etc.
2. Keep away from air vents, such as heating air vents, humidifiers, air conditioners and opened window, etc.
3. Do not install the camera face the mirror.
4. To reduce interference from wireless signals, keep the camera at least 1 meter away from the wireless device.
5. Do not install the camera at a strong wind position.
6. Do not install the camera at crowd or heavy traffic.

## **FCC warning statements:**

This equipment has been tested and found to comply with the limits for a Class B digital device, pursuant to part 15 of the FCC Rules. These limits are designed to provide reasonable protection against harmful interference in a residential installation. This equipment generates, uses and can radiate radio frequency energy and, if not installed and used in accordance with the instructions, may cause harmful interference to radio communications. However, there is no guarantee that interference will not occur in a particular installation. If this equipment does cause harmful interference to radio or television reception, which can be determined by turning the equipment off and on, the user is encouraged to try to correct the interference by one or more of the following measures:

- Reorient or relocate the receiving antenna.
- Increase the separation between the equipment and receiver.
- Connect the equipment into an outlet on a circuit different from that to which the receiver is connected.
- Consult the dealer or an experienced radio/TV technician for help.

Caution: Any changes or modifications to this device not explicitly approved by manufacturer could void your authority to operate this equipment.

This device complies with part 15 of the FCC Rules. Operation is subject to the following two conditions: (1) This device may not cause harmful interference, and (2) this device must accept any interference received, including interference that may cause undesired operation.

The device has been evaluated to meet general RF exposure requirement This equipment complies with FCC radiation exposure limits set forth for an uncontrolled environment.

This equipment should be installed and operated with minimum distance 20cm between the radiator & your body.