

T3

Owner's Manual

sudio

Sudio Help Center
 Sudio Hjálpcnter
 Sudio Hjælpecenter
 Sudio Ohjekeskus
 Sudio Hjálparmiðstöð
 Sudio Centre D'aide
 Sudio Hilfezentrum
 Sudio Centro de Ayuda
 Sudio Centro de Ajuda
 Sudio Helpcentrum

Pusat Bantuan Sudio
 ศูนย์ช่วยเหลือ SUDIO
 مركز مساعدة سودي
 Sudio 도움말 센터
 Sudio 帮助中心
 Sudio 幫助中心
 Sudio ヘルプセンター
 Справочный центр Sudio
 Trung tâm trợ giúp Sudio



www.sudio.com/helpcenter

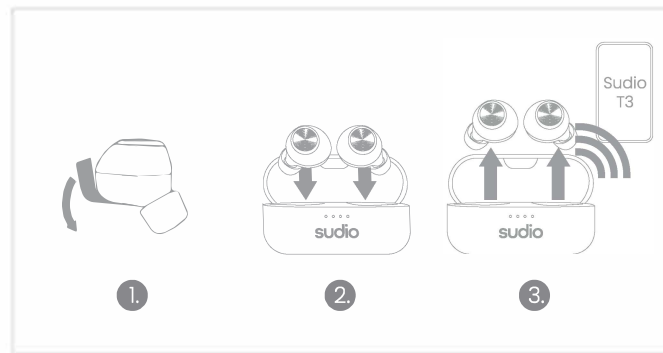
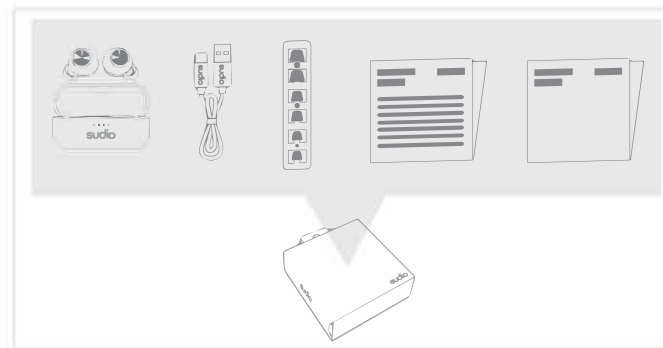
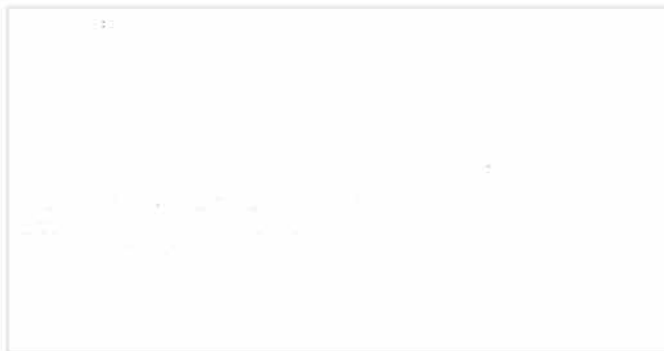

FCC Warning

This device complies with part 15 of the FCC Rules. Operation is subject to the following two conditions: (1) This device may not cause harmful interference, and (2) this device must accept any interference received, including interference that may cause undesired operation.

Any Changes or modifications not expressly approved by the party responsible for compliance could void the user's authority to operate the equipment.

Note: This equipment has been tested and found to comply with the limits for a Class B digital device, pursuant to part 15 of the FCC Rules. These limits are designed to provide reasonable protection against harmful interference in a residential installation. This equipment generates uses and can radiate radio frequency energy and, if not installed and used in accordance with the instructions, may cause harmful interference to radio communications. However, there is no guarantee that interference will not occur in a particular installation. If this equipment does cause harmful interference to radio or television reception, which can be determined by turning the equipment off and on,

the user is encouraged to try to correct the interference by one or more of the following measures:

- Reorient or relocate the receiving antenna.
- Increase the separation between the equipment and receiver.
- Connect the equipment into an outlet on a circuit different from that to which the receiver is connected.

Consult the dealer or an experienced radio/TV technician for help.

The device has been evaluated to meet general RF exposure requirement. The device can be used in portable exposure condition without restriction.

