

Charge with USB-C.  
Amber/white light = charging.  
White light = charged.  
使用 USB-C 充电。  
琥珀色/白光 = 正在充电。  
白光 = 充电。

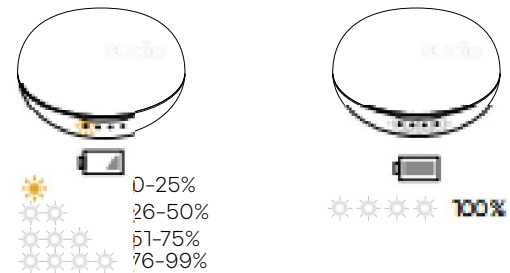

LED blinks amber light when low battery (0-25%), and white light between 26%-100%  
使用 USB-C 充电。  
琥珀色/白光 = 正在充电。白光 = 已充电。当电池电量不足 (0-25%) 时, LED 闪烁琥珀色光, 白光在 26%-100% 之间

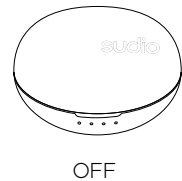

Place earphones in charging case to turn off.  
Remove from case to turn on.  
将耳机放入充电盒即可关机。  
从外壳中取出以打开。

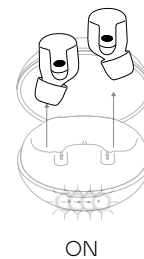

Sudio Help Center	Sudio Centro de Ayuda	ศูนย์ช่วยเหลือ SUDIO
Sudio Hjälpcenter	Sudio Centro de Ajuda	Справочный центр Sudio
Sudio Hjelpesenter	مركز مساعدة سوديو	Trung tâm trợ giúp Sudio
Sudio Hjaelpesenter	Sudio 도움말 센터	
Sudio Ohjekeskus	Sudio帮助中心	
Sudio Hjälparmiöstöd	Sudio幫助中心	
Sudio Centre D'aide	Pusat Bantuan Sudio	
Sudio Hilfezentrum	Sudioヘルプセンター	
Sudio Helpcentrum		



Bluetooth Version藍牙版本: V5.2 ;  
BDR+EDR;  
Max. Transmit Power額定發射功率: -6.20dbm  
Antenna gain天線增益: -1.9dbi

Product name產品名稱: Sudio A2  
2: Product model產品型號: Sudio A2  
: Product Rating:Input 輸入  
The input current of the earphone 55mA, Input voltage: 5.0V ;  
耳機輸入電流55mA, 輸入電壓: 5.0V  
Input current of charging box 500mA, Input voltage: 5.0V  
充電盒輸入電流500mA, 輸入電壓: 5.0V  
The output current of the charging box  
充電盒輸出電流: 160mA  
The output voltage of the charging box  
充電盒輸出電壓: 5V  
4: Built-in lithium battery Voltage and capacity  
Headset battery內置鋰電池電壓和容量  
耳機電池: 3.7V , 55mAh  
Charging box battery充電盒電池: 3.7V , 400 mAh



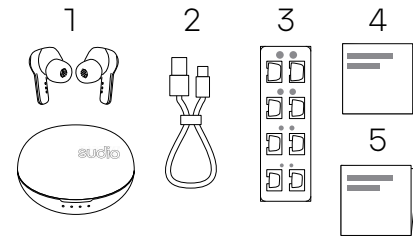

- 1: A2
- 2: Charging cable 充电线
- 3: Eartip holder 耳塞支架
- 4: Warnings 警告
- 5: Owners manual 用户手册

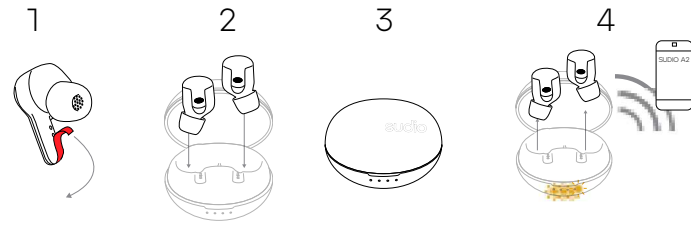

1. Remove stickers 去除贴纸
2. Place earbuds in case 放置耳塞以防万一
3. Remove from case and connect device 从外壳中取出并连接设备

- || ▶: 1 tap 1次点击
- ◀◀: Tap 2x left 向左轻按 2 次
- ▶▶: Tap 2x right 向右轻按 2 次
- Vol ↑: Tap 3x right 向右轻按 3 次
- Vol ↓: Tap 3x left 向左轻按 3 次

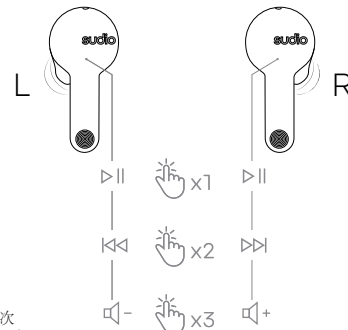

ANC  
ON/OFF

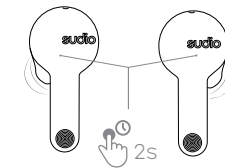

Turn ANC on/off: 打开/关闭主动降噪:  
Hold any side 2 sec. 保持任意一侧 2 秒。

**FCC STATEMENT:**

This device complies with Part 15 of the FCC Rules. Operation is subject to the following two conditions:  
(1) This device may not cause harmful interference, and  
(2) This device must accept any interference received, including interference that may cause undesired operation.

Warning: Changes or modifications not expressly approved by the party responsible for compliance could void the user's authority to operate the equipment.

NOTE: This equipment has been tested and found to comply with the limits for a Class B digital device, pursuant to Part 15 of the FCC Rules. These limits are designed to provide reasonable protection against harmful interference in a residential installation. This equipment generates uses and can radiate radio frequency energy and, if not installed and used in accordance with the instructions, may cause harmful interference to radio communications. However, there is no guarantee that interference will not occur in a particular installation. If this equipment does cause harmful interference to radio or television reception, which can be determined by turning the equipment off and on, the user is encouraged to try to correct the interference by one or more of the following measures:

- Reorient or relocate the receiving antenna.
- Increase the separation between the equipment and receiver. Connect the equipment into an outlet on a circuit different from that to which the receiver is connected.
- Consult the dealer or an experienced radio/TV technician for help.

**RF warning statement:**

The device has been evaluated to meet general RF exposure requirement. The device can be used in portable exposure condition without restriction.

Accept calls: 1 tap 接听电话: 1 次点击

Hang up or reject calls: Hold button 2 seconds 挂断或拒接电话: 按住按钮 2 秒

