

# VISION

installation:innovation

VISION SB-1900P Active Soundbar

Model: SB-1900P





USER MANUAL

# Contents

|  |           |
|--|-----------|
| <b>Important Safety Instructions .....</b>   | <b>3</b>  |
| Safety .....                                 | 3         |
| Warning .....                                | 4         |
| <b>What's in the Box .....</b>               | <b>6</b>  |
| <b>Specifications .....</b>                  | <b>6</b>  |
| <b>Identifying the Parts .....</b>           | <b>7</b>  |
| Main Unit.....                               | 7         |
| Remote Control .....                         | 7         |
| <b>Preparations .....</b>                    | <b>8</b>  |
| Prepare the Remote Control.....              | 8         |
| Replace the Remote Control Battery .....     | 8         |
| <b>Placement and Mounting .....</b>          | <b>8</b>  |
| Placement.....                               | 8         |
| Wall mounting.....                           | 9         |
| <b>Connections .....</b>                     | <b>10</b> |
| Use the HDMI socket .....                    | 10        |
| Use the AUX Socket.....                      | 11        |
| Connect to Power .....                       | 11        |
| <b>Basic Operation .....</b>                 | <b>11</b> |
| Standby/ON .....                             | 11        |
| Mode Selection.....                          | 12        |
| Adjust the Volume .....                      | 12        |
| Select equalizer (EQ) effect .....           | 12        |
| <b>AUX / HDMI Operation .....</b>            | <b>12</b> |
| <b>Bluetooth Operation.....</b>              | <b>12</b> |
| Pair Bluetooth-enabled Devices.....          | 12        |
| Listen to Music from Bluetooth Devices ..... | 13        |
| <b>Troubleshooting.....</b>                  | <b>14</b> |

# Important Safety Instructions

|   |   |   |
|---|---|---|
|    | <b>CAUTION</b><br>RISK OF ELECTRIC SHOCK<br>DO NOT OPEN |  |
| CAUTION: TO REDUCE THE RISK OF ELECTRIC SHOCK, DO NOT REMOVE COVER (OR BACK). NO USER-SERVICEABLE PARTS INSIDE. REFER SERVICING TO QUALIFIED SERVICE PERSONNEL. |   |   |





The lightning flash with arrowhead symbol, within an equilateral triangle, is intended to alert the user to the presence of uninsulated "dangerous voltage" within the product's enclosure that may be of sufficient magnitude as to constitute a risk of electric shock to persons.



The exclamation point within an equilateral triangle is intended to alert the user to the presence of important operating and maintenance (servicing) instructions in the literature accompanying the appliance.

## Safety

- 1 Read these instructions** – All the safety and operating instructions should be read before this product is operated.
- 2 Keep these instructions** – The safety and operating instructions should be retained for future reference.
- 3 Heed all warnings** – All warnings on the appliance and in the operating instructions should be adhered to.
- 4 Follow all instructions** – All operating and usage instructions should be followed.
- 5 Do not use this apparatus near water** – The appliance should not be used near water or moisture – for example, in a wet basement or near a swimming pool and the like.
- 6 Clean only with a dry cloth.**
- 7 Do not block any ventilation openings.** Install in accordance with the manufacturer's instructions.
- 8 Do not install near any heat sources** such as radiators, heaters, stoves, or other apparatus (including amplifiers) that produce heat.
- 9 Do not defeat the safety purpose of the polarized or grounding plug.** A polarized plug has two blades with one wider than the other. A grounding plug has two blades and a third grounding prong. The wide blade or the third prong is provided for your safety. If the provided plug does not fit into your outlet, consult an electrician for replacement of the obsolete outlet.
- 10 Protect the power cord from being walked on or pinched particularly at plugs, convenience receptacles, and the point where they exit from the apparatus.**
- 11 Only use attachments/accessories specified by the manufacturer.**
- 12**  Use only with the cart, stand, tripod, bracket or table specified by the manufacturer, or sold with the apparatus. When a cart or rack is used, use caution when moving the cart/apparatus combination to avoid injury from tip-over.
- 13 Unplug the apparatus during lightning storms or when unused for long periods of time.**
- 14 Refer all servicing to qualified personnel.** Servicing is required when the apparatus has been damaged in any way, such as power supply cord or plug is damaged, liquid has been spilled or objects have fallen into the apparatus, the unit has been exposed to rain or moisture, does not operate normally, or has been dropped.
- 15**  This equipment is a Class II or double insulated electrical appliance. It has been designed in such a way that it does not require a safety connection to electrical earth.
- 16 The apparatus shall not be exposed to dripping or splashing.** No objects filled with liquids, such as vases, shall be placed on the apparatus.
- 17 Minimum distance around the apparatus for sufficient ventilation is 5cm.**
- 18 The ventilation should not be impeded by covering the ventilation openings with items, such as newspapers, table-cloths, curtains, etc...**
- 19 No naked flame sources, such as lighted candles, should be placed on the apparatus.**
- 20 Batteries should be recycled or disposed of as per state and local guidelines.**

21 The use of apparatus in moderate climates.

### Caution:

- Use of controls or adjustments or performance of procedures other than those described herein, may result in hazardous radiation exposure or other unsafe operation.
- To reduce the risk of fire or electric shock, do not expose this apparatus to rain or moisture. The apparatus must not be exposed to dripping or splashing and objects filled with liquids, such as vases, must not be placed on apparatus.
- The mains plug/appliance coupler is used as the disconnect device, the disconnect device must remain readily operable.
- Danger of explosion if battery is incorrectly replaced. Replace only with the same or equivalent type.

### Warning

- The battery (batteries or battery pack) shall not be exposed to excessive heat such as sunshine, fire or the like.
- Before operating this system, check the voltage of this system to see if it is identical to the voltage of your local power supply.
- Do not place this unit close to strong magnetic fields.
- Do not place this unit on the amplifier or receiver.
- Do not place this unit close to damp areas as the moisture will affect the life of the laser head.
- If any solid object or liquid falls into the system, unplug the system and have it checked by qualified personnel before operating it any further.
- Do not attempt to clean the unit with chemical solvents as this may damage the finish. Use a clean, dry or slightly damp cloth.
- When removing the power plug from the wall outlet, always pull directly on the plug, never yank on the cord.
- Changes or modifications to this unit not expressly approved by the party responsible for compliance will void the user's authority to operate the equipment.
- The rating label is pasted on the bottom or back of the equipment.

### DO NOT INGEST BATTERY, CHEMICAL BURN HAZARD

The remote control supplied with this product contains a coin/button cell battery. If the coin/button cell battery is swallowed, it can cause severe internal burns in just 2 hours and lead to death. Keep new and used batteries away from children. If the battery compartment does not close securely, stop using the product and keep it away from children. If you think batteries might have been swallowed or placed inside any part of the body, seek immediate medical attention.



Correct Disposal of this product. This marking indicates that this product should not be disposed with other household wastes throughout the EU. To prevent possible harm to the environment or human health from uncontrolled waste disposal, recycle it responsibly to promote the sustainable reuse of material resources. To return your used device, please use the return and collection systems or contact the retailer where the product was purchased. They can take this product for environmental safe recycling.



We hereby declares that this product is in compliance with the essential requirements and other relevant provisions of Directive 2014/53/EU.



The Bluetooth® word mark and logos are registered trademarks owned by Bluetooth SIG, Inc. We are the licensee to use such marks. Other trademarks and trade names are those of their respective owners.

## FCC INFORMATION

This equipment has been tested and found to comply with the limits for a Class B digital device, pursuant to part 15 of the FCC Rules. These limits are designed to provide reasonable protection against harmful interference in a residential installation. This equipment generates, uses and can radiate radio frequency energy and, if not installed and used in accordance with the instructions, may cause harmful interference to radio communications. However, there is no guarantee that interference will not occur in a particular installation. If this equipment does cause harmful interference to radio or television reception, which can be determined by turning the equipment off and on, the user is encouraged to try to correct the interference by one or more of the following measures:

- Reorient or relocate the receiving antenna.
- Increase the separation between the equipment and receiver.
- Connect the equipment into an outlet on a circuit different from that to which the receiver is connected.
- Consult the dealer or an experienced radio/TV technician for help.

**Caution:** Any changes or modifications to this device not explicitly approved by manufacturer could void your authority to operate this equipment.

This device complies with part 15 of the FCC Rules. Operation is subject to the following two conditions: (1) This device may not cause harmful interference, and (2) this device must accept any interference received, including interference that may cause undesired operation.

### Radiation Exposure Statement

This equipment complies with radiation exposure limits set forth for an uncontrolled environment. This equipment should be installed and operated with minimum distance 20cm between the radiator & your body.

### ISED Statement

---English: This device complies with Industry Canada license exempt RSS standard(s). Operation is subject to the following two conditions: (1) This device may not cause interference, and (2) This device must accept any interference, including interference that may cause undesired operation of the device. The digital apparatus complies with Canadian CAN ICES 3 (B)/NMB 3(B).

---French: Le présent appareil est conforme aux CNR d'Industrie Canada applicables aux appareils radio exempts de licence. L'exploitation est autorisée aux deux conditions suivantes: (1) l'appareil ne doit pas produire de brouillage, et (2) l'utilisateur de l'appareil doit accepter tout brouillage radioélectrique subi, même si le brouillage est susceptible d'en compromettre le fonctionnement. Cet appareil numérique de la classe B est conforme à la norme NMB-003 du Canada.

This equipment complies with Canada radiation exposure limits set forth for an uncontrolled environment. This equipment should be installed and operated with minimum distance 20cm between the radiator & your body.

Cet équipement est conforme Canada limites d'exposition aux radiations dans un environnement non contrôlé. Cet équipement doit être installé et utilisé à distance minimum de 20cm entre le radiateur et votre corps.

## What's in the Box



Main Unit



Remote Control



Power Adapter  
(for Main Unit)



AC Power Cord  
x 4



3.5mm to 3.5mm  
Audio Cable

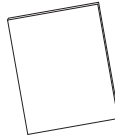

User Manual

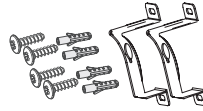

Screws x 4  
Gum cover x 4  
Wall Mount x 2

## Specifications

### Soundbar

|   |                     |
|---|---------------------|
| Power Requirements .....                | AC100-240V~ 50/60Hz |
| Adapter Power Output.....               | DC 21V, 3A          |
| Power Consumption .....                 | 30 W                |
| Power Consumption of standby mode ..... | < 0.5 W             |
| Output Power RMS.....                   | 50W x 2             |
| Total Harmonic Distortion .....         | 1% (1kHz, 1W)       |
| Audio input Sensitivity .....           | 700mV               |
| Frequency Response .....                | 40Hz - 20KHz        |
| Impedance.....                          | 4Ω x 2              |
| Dimension (W x H x D) .....             | 800 x 62 x 93 mm    |

### Bluetooth

|                                |                     |
|--------------------------------|---------------------|
| Version .....                  | V4.2                |
| Maximum Power Transmitted..... | 5 dBm               |
| Frequency Bands.....           | 2402 MHz ~ 2480 MHz |

### Remote Control

|                   |         |
|-------------------|---------|
| Distance.....     | 6m      |
| Angle .....       | 30°     |
| Battery Type..... | CR 2025 |

- Design and specifications are subject to change without notice.

# Identifying the Parts

## Main Unit

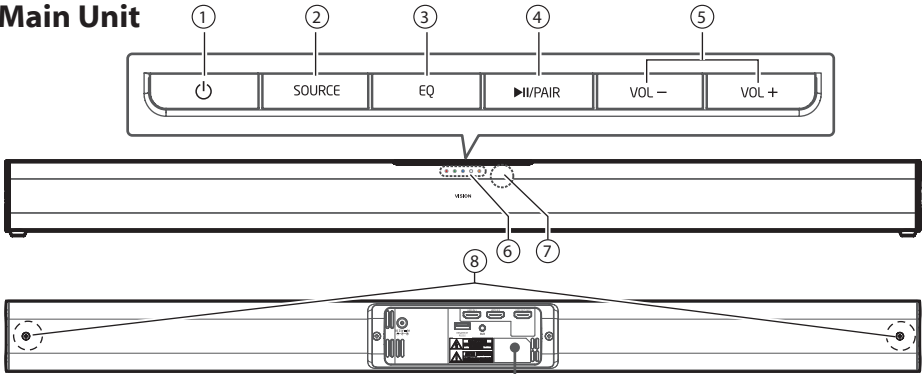

- 1 **⏻ button**  
Turn ON or turn OFF the unit.
- 2 **SOURCE button**  
Select the play function.
- 3 **EQ button**  
Select equalizer (EQ) effect.
- 4 **▶II/PAIR button**  
Play/pause/resume playback in Bluetooth mode. Press and hold to activate the pairing function in Bluetooth mode or disconnect the existing paired Bluetooth device.
- 5 **VOL+/VOL- buttons**  
Increase/decrease the volume level.
- 6 **LED Indicators**
  - Red : STANDBY mode
  - Green : AUX mode
  - Blue : Bluetooth mode
  - White : HDMI 1 mode
  - White flash : HDMI 2 mode
  - Orange : HDMI ARCmode

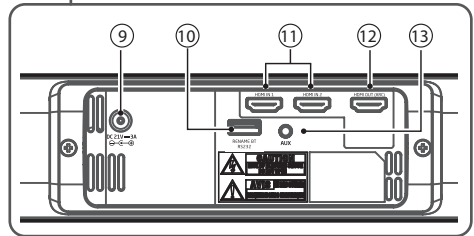

- 7 **Remote Control Sensor**
- 8 **Wall bracket screws**
- 9 **DC Socket**
- 10 **USB Socket**  
The USB socket is for service only.
- 11 **HDMI IN [⓪, ⓪] Sockets**
- 12 **HDMI OUT (ARC) Socket**
- 13 **AUX Socket**

## Remote Control

- 1 **ON** Turn ON the unit.
- 2 **OFF** Turn OFF the unit.
- 3 **Function buttons** Select the play function.
- 4 **VOL+/VOL-** Increase/decrease the volume level.  
|◀/▶| Skip to previous/next track in BT mode.  
▶II Play/pause/resume playback in BT mode.
- 5 **PAIR** Activate the pairing function in Bluetooth mode or disconnect the existing paired Bluetooth device.
- 6 **MUTE** Mute or resume the sound.
- 7 **FLAT/MOVIE/MUSIC** Select equalizer (EQ) effect.

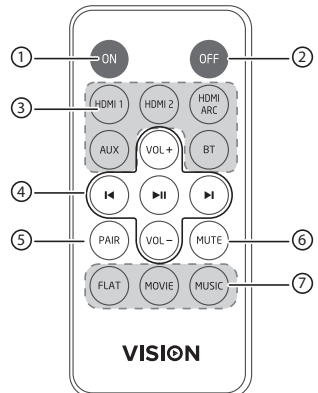

## Preparations

### Prepare the Remote Control

The provided Remote Control allows the unit to be operated from a distance.

- Even if the Remote Control is operated within the effective range 19.7 feet (6m), remote control operation may be impossible if there are any obstacles between the unit and the remote control.
- If the Remote Control is operated near other products which generate infrared rays, or if other remote control devices using infra-red rays are used near the unit, it may operate incorrectly. Conversely, the other products may operate incorrectly.

#### First-time use:

The unit has a pre-installed lithium CR2025 battery.

Remove the protective tab to activate the remote control battery.

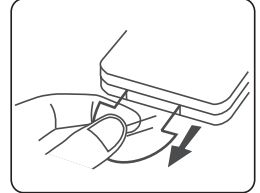

### Replace the Remote Control Battery

- The remote control requires a CR2025, 3V Lithium battery.
1. Remove the screw with a screwdriver and then remove the back cover battery compartment of the remote control.
  2. Remove the old battery.
  3. Replace with a new battery.
  4. Close the battery compartment cover and tighten the screw with the screwdriver.

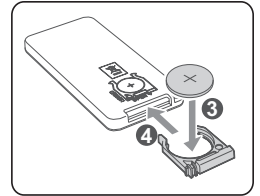
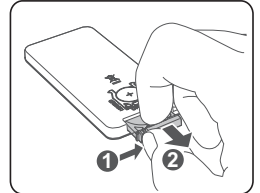

#### Precautions Concerning Batteries

- When the Remote Control is not to be used for a long time (more than a month), remove the battery from the Remote Control to prevent it from leaking.
- If the batteries leak, wipe away the leakage inside the battery compartment and replace the batteries with new ones.
- Do not use any batteries other than those specified.
- Do not heat or disassemble batteries.
- Never throw them in fire or water.
- Do not carry or store batteries with other metallic objects. Doing so could cause batteries to short circuit, leak or explode.
- Never recharge a battery unless it is confirmed to be a rechargeable type.

## Placement and Mounting

- A If your TV is placed on a table, you can place the unit on the table directly in front of the TV stand, centered with the TV screen.
- B If your TV is attached to a wall, you can mount the unit on the wall directly below the TV screen.

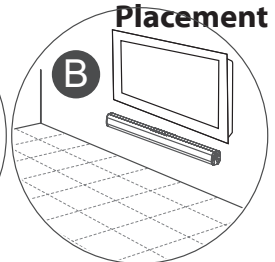
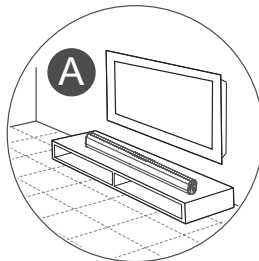



# Wall mounting

## Note:

- Installation must be carried out by qualified personnel only. Incorrect assembly can result in severe personal injury and property damage (if you intend to install this product yourself, you must check for installations such as electrical wiring and plumbing that may be buried inside the wall). It is the installer's responsibility to verify that the wall will safely support the total load of the Soundbar and wall brackets.
  - Additional tools (not included) are required for the installation.
  - Do not overtighten screws.
  - Keep this instruction manual for future reference.
1. Use an electronic stud finder to check the wall type before drilling and mounting.
  1. Drill 4 parallel holes (Ø 5.5-6 mm each according to wall type) in the wall. The distance between the holes should be **756 mm**.
  2. Firmly fix 1 dowel into each hole in the wall if necessary. Tighten the wall mount brackets on the wall with screws and screwdriver (not included). Make sure that they are securely installed.
  3. Remove the screws at the back of the unit. Install the wall mounting screws into the back of the unit.
  4. Lift the unit onto the wall mount brackets and slot into place.

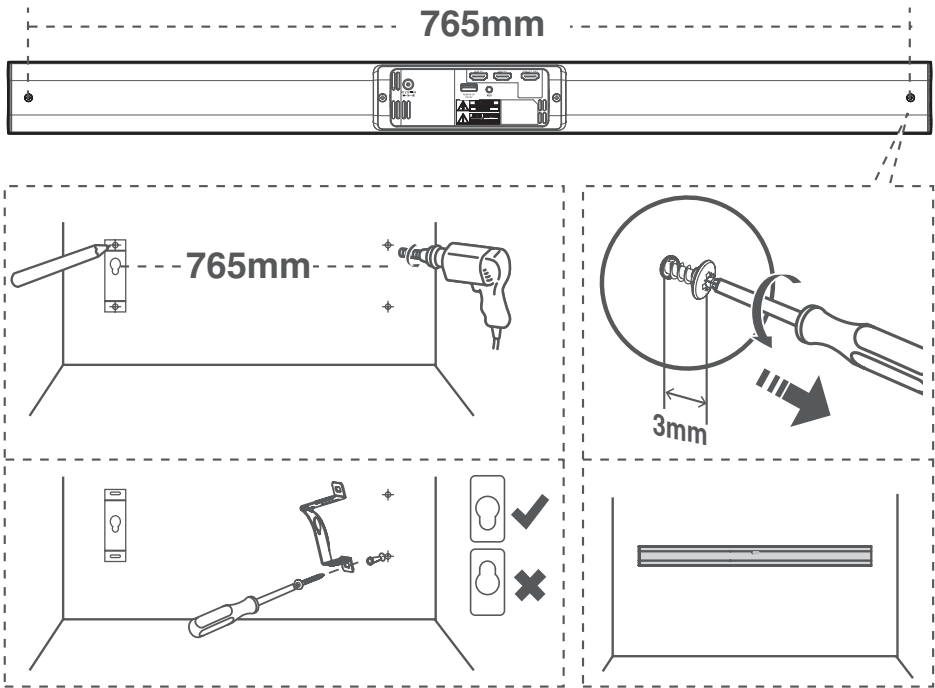

# Connections

## Use the HDMI socket

Using HDMI to connect the soundbar, AV equipment and TV:

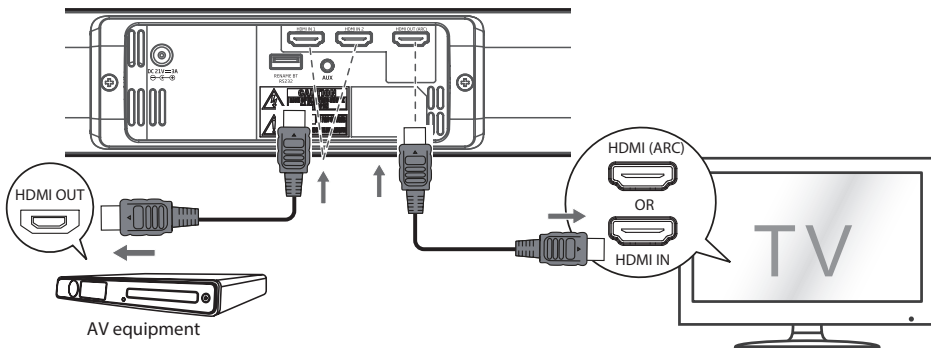

### Method 1: ARC (Audio Return Channel)

The ARC (Audio Return Channel) function allows you to send audio from your ARC-compliant TV to your sound bar through a single HDMI connection. To enjoy the ARC function, please ensure your TV is both HDMI-CEC and ARC compliant and set up accordingly. When correctly set up, you can use your TV remote control to adjust the volume output (VOL +/- and MUTE) of the sound bar.

- Connect the HDMI cable (not included) from unit's **HDMI (ARC)** socket to the HDMI (ARC) socket on your ARC compliant TV. Then press the remote control to select **HDMI ARC**.

#### Tips:

- Your TV must support the HDMI-CEC and ARC function. HDMI-CEC and ARC must be set to On.
- The setting method of HDMI-CEC and ARC may differ depending on the TV. For details about ARC function, please refer to the owner's manual.

### Method 2: Standard HDMI

- If your TV is not HDMI ARC-compliant, connect your soundbar to the TV through a standard HDMI connection.

1. Use an HDMI cable (not included) to connect the soundbar's **HDMI OUT** socket to the TV's HDMI IN socket.
2. Use an HDMI cable (not included) to connect the soundbar's **HDMI IN (1 or 2)** socket to your external devices (e.g. games consoles, DVD players and blu ray).

#### Tips:

- Your TV must support the HDMI-CEC and ARC function. HDMI-CEC and ARC must be set to On.
- The setting method of HDMI-CEC and ARC may differ depending on the TV. For details about ARC function, please refer to your TV owner's manual.
- Only HDMI 1.4 cables can support the ARC function.

**Note:** While in **HDMI 1/HDMI 2/HDMI ARC** mode, if there's no sound output from the unit and the **Status** lights flashes quickly, you may need to activate **PCM** Signal output on your source device (eg. TV, DVD or Blu-ray player).

## Use the AUX Socket

- A. Use a 3.5mm to 3.5mm audio cable (included) to connect an external audio device headphone socket to the **AUX** socket on the unit.
- B. Use an RCA to 3.5mm audio cable (not included) to connect the TV's AUDIO OUT socket to the **AUX** socket on the unit.

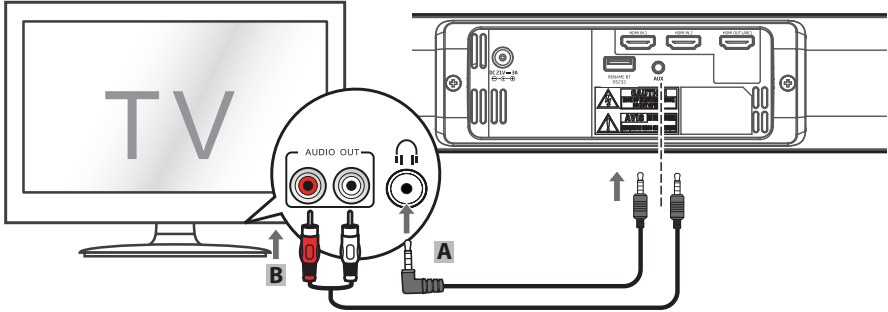

## Connect to Power

### Risk of product damage!

Ensure that the power supply voltage corresponds to the voltage printed on the back or the underside of the unit.

- Before connecting the AC power cord, ensure you have completed all other connections.
- Unwind the mains adapter cable to its full length. Connect the other end of the mains cable to the **DC 21V, 3A** socket at the rear of the soundbar then connect the mains plug to the mains socket.

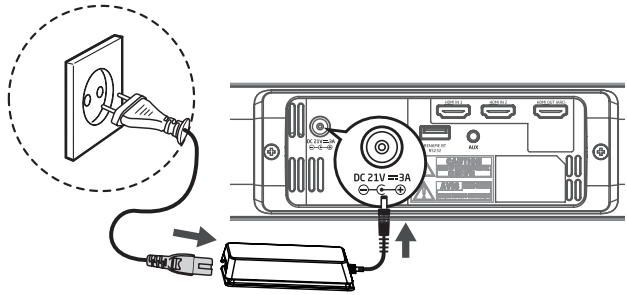

## Basic Operation

### Standby/ON

When you first connect the unit to the mains socket, the **unit** will be in Standby mode.

- Press the **⏻** button on the main unit or the **ON** button on the remote control to switch the main unit on. The status indicator of the last used mode will light up.
- Press the **⏻** button on the main unit or the **OFF** button on the remote control to switch the main unit back to Standby mode. The POWER Indicator will light up red.
- Disconnect the mains plug from the mains socket if you want to switch the unit off completely.

### Note:

- If a TV or an external device (Only for AUX socket) is connected, the main unit will switch on automatically when the TV or the external device is switched on.
- When the unit no input signal (or weak input signal) for over 15 minutes, the unit will automatically switch to Standby mode.

## Mode Selection

- Press the **SOURCE** button on the main unit or the **AUX, HDMI 1, HDMI 2, HDMI ARC** buttons on the remote control to select the desired mode.
- The indicator light on the front of the main unit will show which mode is currently in use..
  - Red : STANDBY mode
  - Green : AUX mode
  - Blue : Bluetooth mode
  - White : HDMI 1 mode
  - White flash : HDMI 2 mode
  - Orange : HDMI ARCmode

## Adjust the Volume

- Press the **VOL +/-** button to adjust the volume.
- If you wish to turn the sound off, press the **MUTE** button on the remote control. Press the **MUTE** button again or press the **VOL +** button to resume normal listening.  
**Note:** While adjusting the volume, the status LED indicator will flash quickly. When the volume has hit maximum/minimum value level, the status LED indicator will flashes once.

## Select equalizer (EQ) effect

While playing, press the **EQ** button on the unit or the **FLAT / MOVIE / MUSIC** buttons on the remote control to select the desired preset equalizers.

## AUX / HDMI Operation

- 1 Ensure that the unit is connected to the TV or audio device.
- 2 While in ON mode, press the **SOURCE** button on the main unit or the **AUX, HDMI 1, HDMI 2, HDMI ARC** buttons on the remote control to select the desired mode.
- 3 Operate your audio device directly for playback features.
- 4 Press the **VOL +/-** button to adjust the volume to your desired level.

**Note:** While in **HDMI 1 / HDMI 2 / HDMI ARC** mode, if there's no sound output from the unit and the **Status** lights flashes quickly, you may need to activate **PCM** Signal output on your source device (eg. TV, DVD or Blu-ray player).

## Bluetooth Operation

You can listen to tracks from a media device if connected to the unit via Bluetooth.

## Pair Bluetooth-enabled Devices

The first time you connect your bluetooth device to this player, you need to pair your device to this player.

### Note:

- The operational range between this player and a Bluetooth device is approximately 8 meters (without any object between the Bluetooth device and the unit).
- Before you connect a Bluetooth device to this unit, ensure you know the device's capabilities.
- Compatibility with all Bluetooth devices is not guaranteed.

- Any obstacle between this unit and a Bluetooth device can reduce the operational range.
  - If the signal strength is weak, your Bluetooth receiver may disconnect, but it will re-enter pairing mode automatically.
- 1 Press the **SOURCE** button on the main unit or on the remote control repeatedly to select **Bluetooth** mode, the **Bluetooth** Indicator will flash slowly. The unit is now in pairing mode.
  - 2 Activate your Bluetooth device and select the search mode. "**SB-1900P**" will appear on your Bluetooth device list.
    - If you cannot find the soundbar, press the "**PAIR**" button on the remote control or press and hold the **▶ ||/PAIR** button on the unit. You will hear "**Pairing**" from the unit and the **Bluetooth** Indicator will flash rapidly.
  - 3 Select "**SB-1900P**" in the pairing list. After the "**Paired**" voice prompt, the system is successfully connected and the **Bluetooth** Indicator will light up steadily.
  - 4 Play music from the connected device.

**To disconnect the Bluetooth function, you can :**

- Switch to another function on the unit.
- Disable the function from your Bluetooth device. The Bluetooth device will be disconnected from the soundbar after the "**Disconnected**" voice prompt.
- Press the "**PAIR**" button on the remote control or press and hold the **▶ ||/PAIR** button on the unit.

**Tips:**

- Enter 0000 for the password if necessary.
- If there is an existing connection, press the "BT PAIR" button on the remote control to re-activate the pairing mode, the connection will be interrupted.
- If no other Bluetooth device pairs with this player within two minutes, the player will recover its previous connection.
- The player will also be disconnected when your device is moved beyond the operational range.
- If you want to reconnect your device to this player, place it within the operational range.
- If the device is moved beyond the operational range, when it is brought back, please check if the device is still connected to the player.
- If the connection is lost, follow the instructions above to pair your device to the player again.

## Listen to Music from Bluetooth Devices

- If the connected Bluetooth device supports Advanced Audio Distribution Profile (A2DP), you can listen to the music stored on the device through the player.
  - If the device also supports Audio Video Remote Control Profile (AVRCP), you can use the player's remote control to play music stored on the device.
1. Pair your device with the player.
  2. Play music via your device (if it supports A2DP).
  3. Use supplied remote control to control play (if it supports AVRCP).
- To pause/resume play, press the **▶ ||/PAIR** button on the unit or the **▶ ||** button on the remote control.
  - To skip to a track, press the **◀/▶** buttons on the remote control.

# Troubleshooting

To keep the warranty valid, never try to repair the system yourself. If you encounter problems when using this unit, check the following points before requesting service.

## No power

- Ensure that the AC cord of the apparatus is properly connected .
- Ensure that there is power at the AC outlet.
- Press standby button to turn the unit on.

## Remote control does not work

- Before you press any playback control button, first select the correct source.
- Reduce the distance between the remote control and the unit.
- Insert the battery with its polarities (+/-) aligned as indicated.
- Replace the battery.
- Aim the remote control directly at the sensor on the front of the unit.

## No sound

- Increase the volume. Press Volume Up on the remote control or on the right side of the soundbar.
- Press MUTE on the remote control to ensure the soundbar is not muted.
- Press source buttons to select a different input source.
- When using either of the Digital inputs, if there is no audio:
  - Try setting the TV output to PCM or
  - Connect directly to your Blu-ray/other source, some TVs do not pass through digital audio.
- Your TV may be set to variable audio output. Confirm that the audio output setting is set to FIXED or STANDARD, not VARIABLE. Consult your TV's user manual for more detailed information.
- If using Bluetooth, ensure that the volume on your source device is turned up and that the device is not muted.

## I can't find the Bluetooth name of this unit on my Bluetooth device for Bluetooth pairing

- Ensure the Bluetooth function is activated on your Bluetooth device.
- Ensure you have paired the unit with your Bluetooth device.

## This is a 15 mins power off function, one of the ERPII standard requirement for saving power

- When the unit's external input signal level is too low, the unit will be turned off automatically in 15 minutes. Please increase the volume level of your external device.