



Laser Pointer

User Instruction Manual

http://en.pisen.com.cn

Thank you for purchasing the mobile power supply product of PISEN. Please read this guide carefully to assure safe and satisfactory operation and also keep it properly for future reference.
This product is used to charge mobile phones or digital products fitted with DC-5V input.

Technical specification

Name	Laser Pointer
Model	TS-D203
Input	5V=1A
Output	5V=1A
Battery Energy	9Wh(2500mAh)
Weight	85g
Dimension	135.0*24.8* 24.8*mm
Laser Power	~3mW
Transmitting Frequency	2.4GHz
Laser Range	>100m
Wave length	650nm
Working temperature	0°C~42°C
Wireless Transmission Distance	≥10m
Time for full charging of built-in battery cell	5V-1A charger, 4~5hs
Standard	Q/PISEN007

2

Warm prompt

- Since the capacity of Charging Laser pen 2500mAh is relatively big, the time marked for full charging is only for reference. Please take actual operation as the criterion.
- Since the factor of conversion efficiency exists in the mobile power supply, the actual capacity of mobile power supply product is not equal to the chargeable capacity.
- The specification and external form of this product will differ due to improvement and reinforcement.
- High-capacity Li-ion battery cell is adopted for all Charging Laser pen batteries to assure high quality. Please feel assured when using this product.
- Since electric energy will be consumed during charging/discharging, slight heating is a normal phenomenon.
- Please store this product in a cool and dry place. If it is not used for a long time, please fully charge it once every 6 months.
- One Micro USB data charging line is attached (there are many other different data charging lines selectable to satisfy the charging demands of more than 95% of branded mobile phones in the market; note: this product is not applicable for some digital products).
- In order to assure the stability of product use, it is recommended to use PISEN Charger or 5V-1A chargers from authentic brands for charging.

Warning

- Laser is harmful to the eyes, do not point the laser to the human, special do not point to eyes & face, it may cause harm.
- Keep this product away from the kids, do not let kids play with this products.
- This product is class 3R product, means visible laser.
- If don't use/control /adjust this product in the rule, it may cause harm by Radiation exposure.

3

Applicable device

Output interface	Output current	Applicable device
USB	5V-1A	Most branded mobile phones including Samsung, HTC, HUAWEI, ZTE, Nokia and MOTO, full-series Apple devices like iPhone, iPad and iPod or devices requiring DC 5V 1A~2A input. (Note: As for Samsung tablet PCs and some models, relevant external adapter is required for use.)

Instruction of indicator light status

Indicator	Indicator light status	System status
Power Indicator light	Red keeps on	Mobile power is charging
	Green keeps on	Mobile power is fully charged
	Green Flickering	the remaining battery >70%
	Orange Flickering	30% < the remaining battery <70%
	Red Flickering	the remaining battery <30%

List of standard accessories

Charging Laser pen 2500mAh	×1
Micro USB cable	×1
User instruction manual	×1

4

Troubleshooting

If the following "operations" cannot eliminate your failure(s), please stop using this product and contact the dealer where you purchase this product from or the customer service center of PISEN.

During charging		
Phenomenon	Cause	Operation
The charging indicator light is not on	Use of improper/irrelevant charger to charge Bad contact of Micro USB input interface/USB output interface	Please use charger recommended by PISEN Please recheck Micro USB input interface or USB output interface to see if the contact is favorable
Heating during charging	Use of improper/irrelevant charging line The battery itself will become hot under the service status	Please use the standard charging line of PISEN or original data charging line Pay attention to the charging environment of Laser Power or pause for a moment before charging again

During application		
Phenomenon	Cause	Operation
When the charger or loaded device is pulled out, the indicator lamp is still on	It is a normal phenomenon, for it takes a certain buffering time for the indicator to go out	After 30 seconds the LED will turn off or press the micro switch 1.5 seconds, the LED can turn off at once
The application duration is too short	The service life of the battery is to end	Charge the battery again. If there is still zero electric quantity, it means the service life of the battery ends

5

Switch control

	Switch button	Next/previous button	Full screen & exit full screen	Black screen next black screen
PPT	Long press the switch button, turn on the laser light, release the switch button, turn off the laser light	Short press next button to next page; short press previous button to previous button	Long press previous button for 1.5s	Long press next button for 1.5s
VIDEO	Double-click the switch button, video play /pause	Short press next page to video forward; short press previous button to rewind		

NOTE: video forward /rewind /pause functions only working on the Windows original video players .

Parts Name	Hazardous Substance					
	Pb	Hg	Cd	Cr ⁶⁺	PBB	PBDE
Circuit Board Assemblies	X	○	○	○	○	○
Hardware Parts	X	○	○	○	○	○
Plastic Parts	○	○	○	○	○	○
Battery	○	○	○	○	○	○
Fittings	○	○	○	○	○	○

○: Indicates that the concentration of the hazardous substance in all homogeneous materials in the parts is below the relevant threshold of the GB/T 26572 standard.
X: Indicates that the concentration of the hazardous substance of at least one of all homogeneous materials in the parts is above the relevant threshold of the GB/T 26572 standard.
Notes: The environment-friendly use period identified in this product is only applicable to the product which is working under the conditions stipulated in the user instruction manual; this product still meets requirements of EU RoHS directive 2015/863/EU

6

Attentions

- Do not put this product on carpet, heater and texture matures or expose it under direct sunlight.
- Do not throw, squeeze, disassemble or pierce this product.
- Do not put this product in a high-temperature and moist environment.
- Do not throw this product in fire, water or corrosive liquid.
- Please do not charge the battery beyond the rating.
- Please do not touch the battery under a moist status.
- Please keep the temperature at 0°C ~42°C during charging.
- Please do not put this product on combustible substances (bed and carpet) during charging.
- If you disassemble and replace the built-in battery on your own, the danger of explosion may exist.
- If product expansion or other unfavorable phenomena and failures are found out, please stop using this product immediately and contact with your dealer.
- Unless supervised, guided and safeguarded by professionals, it is not suitable for the following people (including children) to use this product: those with degraded somatic functions or mental ability and those having insufficient understanding of this device and lack of operation experience. The children must be supervised to assure safe use.

Important notice

Apple Lighting data charging line is with internal integrated circuit chip, which may lead your devices like iPhone or iPad mini not to charge normally. It will be back to normal after re-plugging the data charging line USB end or Lightning end interface.

7



FCC STATEMENT :

This device complies with Part 15 of the FCC Rules. Operation is subject to the following two conditions:
(1) This device may not cause harmful interference, and
(2) This device must accept any interference received, including interference that may cause undesired operation.
Warning: Changes or modifications not expressly approved by the party responsible for compliance could void the user's authority to operate the equipment.

NOTE: This equipment has been tested and found to comply with the limits for a Class B digital device, pursuant to Part 15 of the FCC Rules. These limits are designed to provide reasonable protection against harmful interference in a residential installation. This equipment generates uses and can radiate radio frequency energy and, if not installed and used in accordance with the instructions, may cause harmful interference to radio communications. However, there is no guarantee that interference will not occur in a particular installation. If this equipment does cause harmful interference to radio or television reception, which can be determined by turning the equipment off and on, the user is encouraged to try to correct the interference by one or more of the following measures:

- Reorient or relocate the receiving antenna.
- Increase the separation between the equipment and receiver.
- Connect the equipment into an outlet on a circuit different from that to which the receiver is connected.
- Consult the dealer or an experienced radio/TV technician for help.



CAUTION:

- Risk of explosion if battery is replaced by an incorrect type.
- Dispose of used batteries according to the instructions.
- Risk of fire and burns.
- Do not open, crush, heat above 108°F or incinerate.
- Follow manufacturer's instructions.

Made by Guangdong PISEN Electronics Co., Ltd.
Address: Jintang Industrial Park, Henggang Town, Longgang District, Shenzhen, P.R.China
Factory Telephone: 86-755-28504090

This product complies with the radio interference requirements of the European Community.

Any changes or modifications made to this device that are not expressly approved by Philips Consumer Lifestyle may void the user's authority to operate the equipment.
When this crossed-out wheeled bin symbol is attached to a product it means that the product is covered by the European Directive 2002/96/EC.
Please inform yourself about the local separate collection system for electrical and electronic products.
Please act according to your local rules and do not dispose of your old products with your normal household waste. Correct disposal of your old product helps to prevent potential negative consequences for the environment and human health.

Diagram of product interface

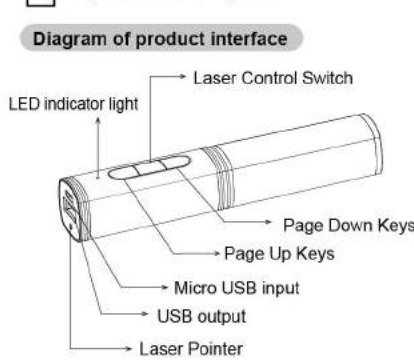

Wiring of standard configuration

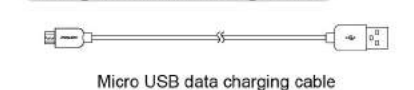

9

Access Device

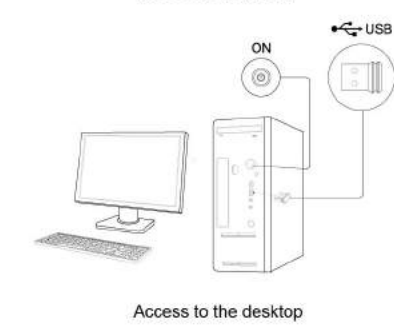
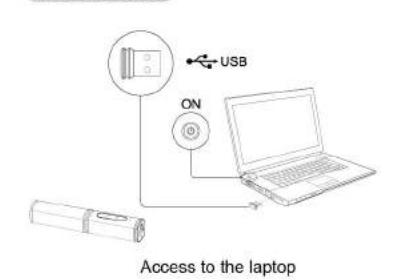

- System Requirement: Mac OS/Windows XP/Vista/Windows 7/Windows 8 and above system.
- Hardware Requirement: PC/USB interface.

10

charge for other devices

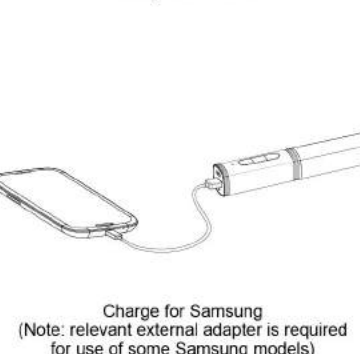
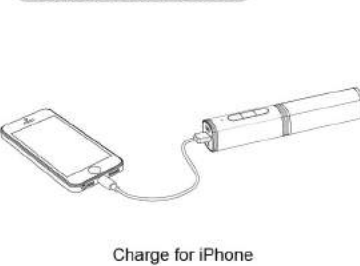

11

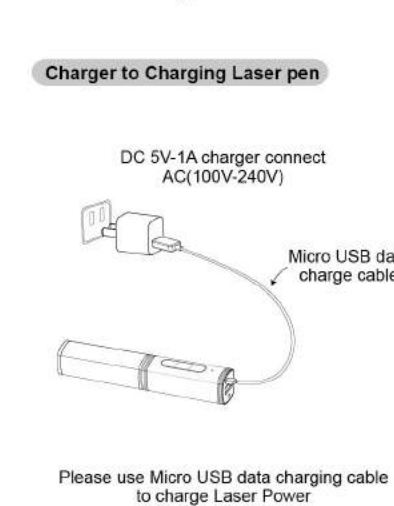

12

USE Computer USB Interface to charge Charging Laser pen

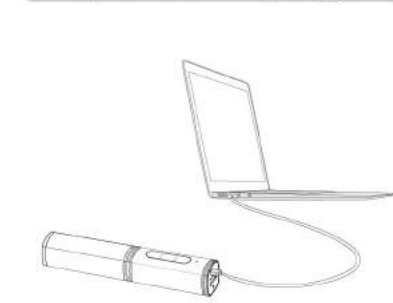

Optional Accessories

- PISEN 5V-1A charger
It is recommended to use PISEN Charger to Charging Laser pen. (Note: it shall be purchased separately.)
- Charging adapter for Samsung tablet PC/GALAXY series
(Note: partial models of this accessory are standard equipped, specific model is subject to the actual product in the package.)

13

Warranty card

Warranty period:

The quality warranty period of this product is effective within 12 months since the day when it is purchased.

Free service:

If any failure arises due to the quality of the product within the warranty period, the user may contact with the dealer and enjoy free warranty service by presenting this warranty card and purchase voucher.

We will not offer free repair service under the following circumstances:

- No warranty card is presented or the product label is damaged.
- Damage caused due to disassembly by the user.
- Failure caused due to water inlet or falling and man-made mechanical damage.
- Failure or damage caused due to force majeure.

Customer service information

Name of customer	
Address	
Tel.	
Name of product	
Model of product	
Date of purchase	
S/N	
Seller	
Repair record	

14