

## EXPLORER

### Getting Started Guide

#### How to Use the "Explorer"

Read this manual carefully before using the product.

## Love it? Share it!

 [twitter.com/echoboxaudio](https://twitter.com/echoboxaudio)

 [facebook.com/echoboxaudio](https://facebook.com/echoboxaudio)

 [instagram.com/echoboxaudio](https://instagram.com/echoboxaudio)

 [echoboxaudio](mailto:echoboxaudio)

### CONTENT

- Explorer (1)
- USB Cable (1)
- Quick Start Guide (this manual)

### ABOUT OPERATING SYSTEM

The operating system is Android 6.0 Marshmallow.

The Explorer comes preloaded with select programs such as TIDAL and USB Audio Player Pro. Apart from these programs, however, the Android OS featured with the Explorer is fully stock and open sourced. Although the Explorer is not connected to the standard Android application marketplace, users may still search for, manage, and download applications in APK form.

### SUPPORT

Advanced products require advanced support. For any questions and concerns, please email [team@echoboxaudio.com](mailto:team@echoboxaudio.com) to reach our support staff.

### LEGAL

For up to date information regarding current and pending certifications, including, but not limited to, FCC and CE, please visit [www.echoboxaudio.com/legal/certifications](http://www.echoboxaudio.com/legal/certifications).

### COMPONENTS AND CONTROL BUTTONS

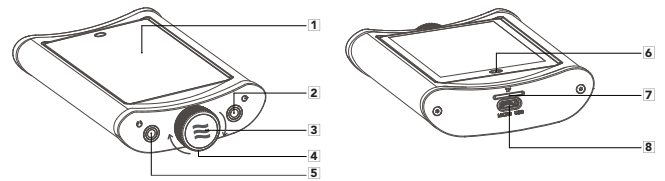

- 1 Touch screen
- 2 Toslink Mini Optical Output
- 3 Power Button  
Tap: Turn on the power or open / close the screen  
Long Press: turn off / turn on the power
- 4 Rotate button to adjust the volume "+" and "-"
- 5 3.5mm headphone port
- 6 Back button
- 7 TF / MicroSD Card Slot
- 8 MicroUSB interface

### USING THE VOLUME KNOB

Clockwise rotation of the volume (+)

Counterclockwise rotation of the volume (-)



The volume can also be adjusted using the Android Quick Settings Dropdown Menu



Be aware of the volume at which the amplifier is set whenever plugging in your headphones. Every headphone has different power requirements - plugging in headphones at a high volume may damage hearing.

### USING WI-FI AND BLUETOOTH

The Explorer features 2.4 Wi-Fi and Bluetooth 4.1 connectivity.

- 1 Open the settings window



- 2a Tap the Wi-Fi tab

 Wi-Fi

- 2a Tap the Bluetooth tab

 Bluetooth

- 3a Ensure the Wi-Fi is switched on and select the desired network

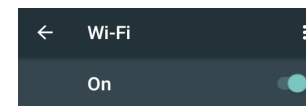

- 3a Ensure the Bluetooth is turned on and select the desired device

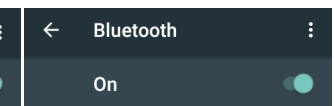

4a Enter a password if required and press connect

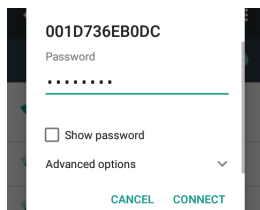

### EXPLORER POWER ON / OFF

We recommend turning the Explorer off when not in use.

- 1 Press and hold the button for 3 seconds to turn the Explorer on
- 2 Press and hold button for until the power down screen appears



(The Explorer's first boot will take longer than normal)

### SCREEN ON / OFF

If the Explorer remains unused, the screen will turn off automatically. To change the Sleep time, access the Display menu from the Settings menu.

- 1 Tap button once to turn screen off
- 2 Tap button once to turn screen on

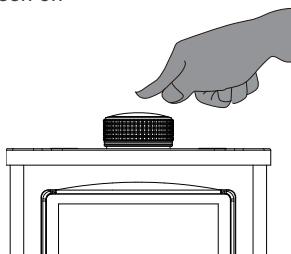

To unlock the Explorer drag the lock icon upwards



### PRECAUTIONS

#### Battery

The 4,000 mAH lithium battery is not user replaceable. If damaged, the battery needs to be replaced. In the event a battery is damaged, please contact our support team immediately by emailing [team@eboxaudio.com](mailto:team@eboxaudio.com).

For charging, the Explorer can be connected to computers and other mobile charging devices, as long as charging voltage does not exceed the current rating of 2A via DC5V.

#### About Headphones

- 1) Avoid listening at high volume for extended periods of time
- 2) Listening to music at high volumes outdoors may block out external sounds. Please maintain awareness of your surroundings at all times when listening to headphones or earphones.
- 3) Listening to music at loud volumes, especially using open-backed headphones, may cause sound to leak into the surrounding environment. Please be courteous to others in your vicinity.

### TROUBLESHOOTING

If your Explorer experiences any bugs or glitches please try the following:

1. Hold down the power button for 1 – 2 minutes until the Explorer shuts down.
2. Once the Explorer has shut down, hold the power button for 30 seconds to restore power to the device.
3. If the Explorer has been restarted and the problem is not resolved, please contact our support staff at [team@eboxaudio.com](mailto:team@eboxaudio.com).

### HOW TO USE THE TOUCH SCREEN

The Explorer features a touchscreen which enables users to navigate the device using a variety of gestures, including:

#### Tap

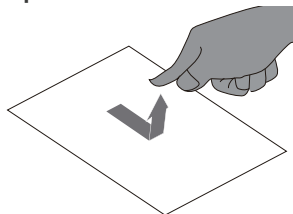

#### Press and Hold

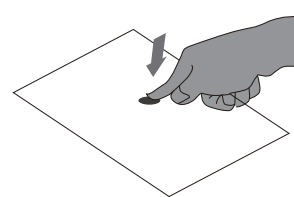

#### Flick

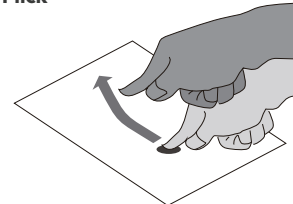

#### Drag

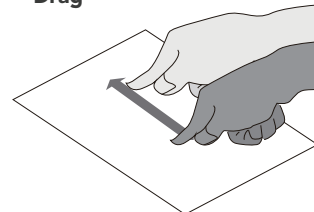

#### Merge / Separate

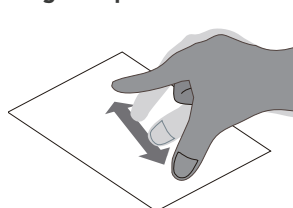

## EXPLORER SPECIFICATIONS

DAC	TEXAS INSTRUMENTS BURR BROWN PCM 1792 - 24/192K CAPABLE, ALL PCM FORMATS; DSD SUPPORT (DSD TO PCM CONVERSION)
POWER	TEXAS INSTRUMENTS TPA6120A2 300MW/CHANNEL @ 32 OHMS, SNR 128DB
OUTPUT IMPEDANCE	<1 OHM @ 16 OHMS
OUTPUT	3.5MM STEREO, MINI TOSLINK OPTICAL OUT
OS	STOCK ANDROID 6.0 MARSHMALLOW
PROCESSOR	ROCKCHIP RK3128 QUAD CORE PROCESSOR @ 1.3 GHZ
RAM	1GB DDR3
MEMORY	64GB INTERNAL, MICRO SD SLOT
BATTERY	4,000 MAH LITHIUM-ION
SCREEN	3.5" LCD
CONSTRUCTION	GENUINE WOOD (MAPLE, ZEBRA WOOD, MAHOGANY, EBONY) MACHINED ALUMINUM
CONNECTIVITY	MICRO USB 2.0, WIFI (802.11 ABGN), BLUETOOTH (4.1), DLNA

Operating temperature range: -10°C~35°C

The product shall only be connected to a USB interface of version USB2.0 or higher.

Test position and configuration Head SAR was performed with the device configured in the positions according to IEEE1528, and Body SAR was performed with the device 0mm from the phantom. Body SAR was also performed with the headset attached and without.

Specifications and design subject to modification without prior notification. Echobox and the Echobox logo are registered trademarks of Echobox Audio, LLC. TI is a trademark of Texas Instruments Inc. Android is a trademark of Google Inc. The Bluetooth word mark and logos are trademarks owned by Bluetooth SIG, Inc. and any use of such marks by Echobox Audio, LLC. is under license. Rockchip is a registered trademark of Rockchip. The product with the Hi-Res Audio Logo is conformed to Hi-Res Audio standard defined by Japan Audio Society. The logo is used under license from Japan Audio Society.

NOTE: This equipment has been tested and found to comply with the limits for a Class B digital device, pursuant to part 15 of the FCC Rules. These limits are designed to provide reasonable protection against harmful interference in a residential installation. This equipment generates uses and can radiate radio frequency energy and, if not installed and used in accordance with the instructions, may cause harmful interference to radio communications. However, there is no guarantee that interference will not occur in a particular installation. If this equipment does cause harmful interference to radio or television reception, which can be determined by turning the equipment off and on, the user is encouraged to try to correct the interference by one or more of the following measures:

- Reorient or relocate the receiving antenna.
- Increase the separation between the equipment and receiver.
- Connect the equipment into an outlet on a circuit different from that to which the receiver is connected.
- Consult the dealer or an experienced radio/TV technician for help.

Changes or modifications not expressly approved by the party responsible for compliance could void the user's authority to operate the equipment.

This device complies with Part 15 of the FCC Rules. Operation is subject to the following two conditions:

- (1) This device may not cause harmful interference, and
- (2) This device must accept any interference received, including interference that may cause undesired operation.

#### RF Exposure Information:

FCC RF Exposure requirements: The highest SAR value reported under this standard during product certification for use next to the head with the minimum separation distance of 0mm is 0.159W/Kg. This transmitter must not be collocated or operating in conjunction with any other antenna or transmitter.

This product is compliance to FCC RF Exposure requirements and refers to FCC website <https://apps.fcc.gov/oetcf/eas/reports/GenericSearch.cfm> search for FCC ID: 2AF3Z-X1

Refer to Article 10(9), shall be provided as follows: Hereby, Echobox Audio, LCC., declares that the radio equipment type Explorer is in compliance with Directive 2014/53/EU. The full text of the EU declaration of conformity is available at the following internet address: [www.echoboxaudio.com/Legal/Explorer/CE](http://www.echoboxaudio.com/Legal/Explorer/CE)

This device is acting as slave and operating in the 2.4 GHz (2412 ~2462 MHz) band in USA.

Digital Audio Player - Explorer  
FCC ID:2AF3Z-X1



Manufactured by Echobox Audio, LLC in The People's Republic of China  
Echobox Audio, LLC  
4707 51st Place SW, Suite 200  
Seattle, WA 98116  
team@echoboxaudio.com

[www.echoboxaudio.com](http://www.echoboxaudio.com) @echoboxaudio