

JOWAY

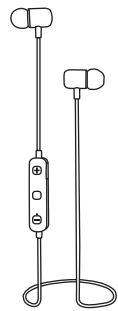

Bluetooth Stereo Earphone

USER GUIDE | H-10

How to Charge

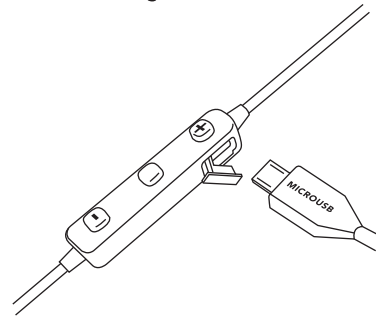

- Open the USB charging port cover
- Plug in the microUSB cable into the charging port.
- Plug the other end of the microUSB cable into PC / laptop / USB wall adapter.

How to Pair

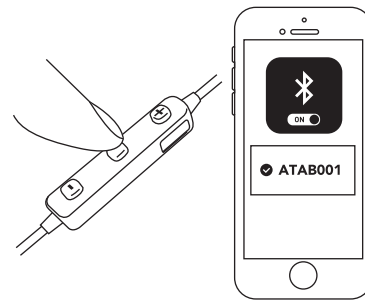

- Press middle button until the LED indicator starts flashing green and red.
- Turn on the Bluetooth settings from your phone / device.
- Find H-10 and connect it.
- Enjoy your favorite music.

How to Wear

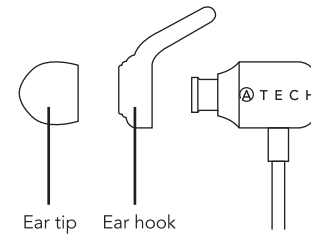

- Find the right size ear tips and ear hook that works for your ear shape.
- Ear hook can be detached based on your preference.

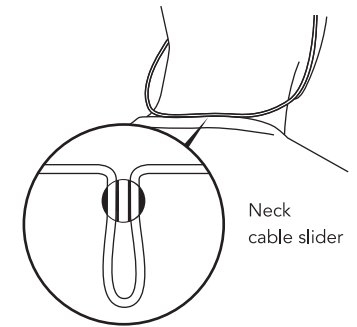

- Use the neck cable slider to tighten the fit when playing sports or working out.

How to Control

Long press and short press of each buttons controls music playback and other smartphone related functions.



- Previous track ● Volume +
- Play / pause ● Power on / off
- Answer / end call
- Next track ● Volume -

- Short press ● Long press

Specifications

Driver : 9mm dynamic driver
Frequency response : 20Hz - 20KHz
Impedance : 16ohm
Sensitivity : 90dB
Bluetooth version : V4.1
Bluetooth profile : A2DP, AVRCP, HSP, HFP
Wireless range : 10m (33ft)
Max power : 10mW
Battery capacity : 3.7V, 85mAh
Music / talk time : up to 7 hours
Charging time : 1.5 hrs
Output power : 20W (max)
Charging input : microUSB, DC4V, 500mAh
Battery cycle : up to 500

Warranty & Services

1-year limited warranty



Designed in San Francisco
Made in China

USER manual

FCC Caution.

This device complies with part 15 of the FCC Rules. Operation is subject to the following two conditions: (1) This device may not cause harmful interference, and (2) this device must accept any interference received, including interference that may cause undesired operation.

Any Changes or modifications not expressly approved by the party responsible for compliance could void the user's authority to operate the equipment.

Note: This equipment has been tested and found to comply with the limits for a Class B digital device, pursuant to part 15 of the FCC Rules. These limits are designed to provide reasonable protection against harmful interference in a residential installation. This equipment generates uses and can radiate radio frequency energy and, if not installed and used in accordance with the instructions, may cause harmful interference to radio communications. However, there is no guarantee that interference will not occur in a particular installation. If this equipment does cause harmful interference to radio or television reception, which can be determined by turning the equipment off and on, the user is encouraged to try to correct the interference by one or more of the following measures:

- Reorient or relocate the receiving antenna.
- Increase the separation between the equipment and receiver.
- Connect the equipment into an outlet on a circuit different from that to which the receiver is connected.
- Consult the dealer or an experienced radio/TV technician for help.

The device has been evaluated to meet general RF exposure requirement. The device can be used in portable exposure condition without restriction.