

2 IN 1 Bluetooth Transmitter&Receiver BR15 Manual
Thank you for choosing and purchasing our

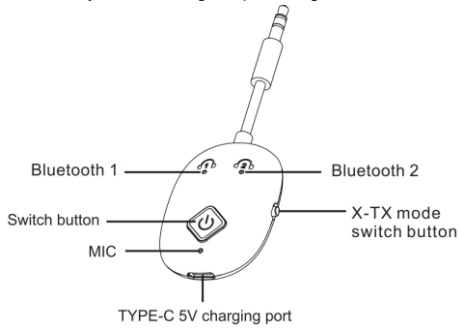

company's portable Bluetooth transceiver! Please read the manual carefully before use.

I. Schematic illustration:

II. Product features:

1. Bluetooth V5.3
- Automatically reconnect to paired Bluetooth devices after power on
3. Ten minutes without devices connection, automatic shutdown
4. Play time: about 13 hours after full charge
5. Private answering
6. Can connect two Bluetooth devices

III. Operating instructions:

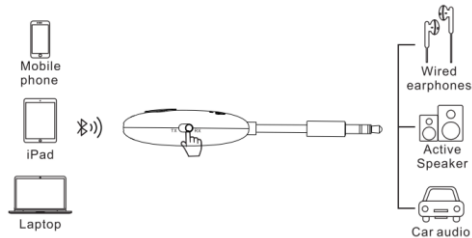

RX receiving mode

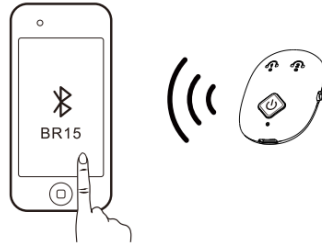

1. Long press "  " button 2 seconds to power on, select RX mode and the Bluetooth indicator light will flash.
2. Open Bluetooth on your phone and search for device "BR15", click "BR15" to pair



- Bluetooth indicator light 1 remains on when the Bluetooth connection is successful, the first device is paired. Connect the second device, open Bluetooth on your other phone and search for the device name "BR15", click to pair. Bluetooth indicator light 2 remains on when the Bluetooth connection is successful, the second device is paired.
3. Music playback
Insert the audio cable into the amplifier, speaker, AUX hole in the car, or other player, and click on your phone's music playback to enjoy the music.

4. Pause/Play: click "  " button
5. Answer/hang up calls: click "  " button.
6. Reject phone calls: long press "  " button 2 seconds
7. Private answering: when you want to answer a call using your

own phone, long press "  " button 2 seconds can switch between your phone and Bluetooth.
*Caution: When you want to play music from another phone, you need to pause the current phone's music and then click to play

music from another phone

TX transmission mode

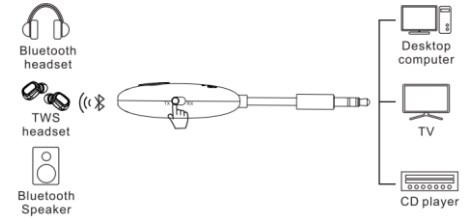

1. After power on, select TX mode
2. The product will automatically search for and connect to nearby Bluetooth devices (such as Bluetooth earphones, and Bluetooth speakers). After successful connection, Bluetooth indicator light 1 will remain on.

3. Second device connection, click "  " button and Bluetooth indicator light 2 flashes, starting to search and connect to nearby Bluetooth devices. After successful connection, Bluetooth indicator light 2 remains on
- *If the second device is not successfully connected after 2 minutes of searching, the search will automatically stop.
4. Music playback

Connect the 3.5mm connector with the sound source (mobile phone, MP3 computer, etc.) and play music

***Caution:** Playing in TX mode, "  " button unable to control music and phone calls

IV. Indicator light status:

RX mode

- * Bluetooth 1 and Bluetooth 2 indicator lights flash: waiting for Bluetooth connection
- * Bluetooth 1 indicator light remains on, Bluetooth 2 indicator light is off: a device is connected
- * The Bluetooth 1 and Bluetooth 2 indicator lights remain on: two devices are connected.

TX mode

- * Bluetooth 1 and Bluetooth 2 indicator lights flash slowly:

waiting for Bluetooth re-connection

- * Bluetooth 1 and Bluetooth 2 indicator lights flash quickly:

Bluetooth search status

* Bluetooth 1 indicator light remains on, Bluetooth 2 indicator light is off: a device is connected

* Bluetooth 1 indicator light remains on, Bluetooth 2 indicator light flashing: searching for the second device

- * Two indicator lights remain on: two devices are connected.

The red light remains on during charging, and goes off after fully charged.

V. Clear Bluetooth



Double click " " button to clear the paired Bluetooth device

VI. Low battery prompt/automatic shutdown:

1. In RX mode, when the battery level is low, the red light starts to flash, and the voice prompt for low battery level is given once every 30 seconds. After 5 consecutive prompts, the device shut down automatically.
2. In TX mode, when the battery is low, the red light starts flashing and automatically shuts down after 2 minutes.
3. If there is no device connection or other button operation for 10 minutes after the product is turned on, the product will automatically shut down.

VII. Force reset:



Long press " " button for 10 second in case of a crash, the product will be forcibly reset and shut down, then restart

VIII. Technical parameters:

Charging voltage	5V
Working current	16mA±2mA
Shutdown current	15uA±2uA
Charging times	50 minutes
Working times	RX13H / TX16H
Battery capacity	240mAh

Bluetooth version	Version 5.3
Bluetooth transmission distance	straight line10M

IX. Troubleshooting:

No response to power on	-long press the power button again -Plug in the charging cable to charge the product for 5 minutes before turning it on
Can't play	-Please ensure that the connected device is working properly -Clear Bluetooth pairing and re-pair Bluetooth -Is the audio cable plugged in properly
Can't charge	-Please unplug the charging cable and reinsert it -Try another charger

X. Warm tips:

1. Do not use this product in a dusty and humid environment with extremely high and low temperatures.
2. Do not drop the product to avoid surface damage or breakdown.
3. Do not disassemble the product, if you have any questions, please contact your dealer
4. Due to continuous improvement and enhancement of technology, changes in product performance and functionality are subject to change without notice.

XI. Packaging accessories

1. Instructions 2 Main device 3 TYPE-C charging cable

NOTE: This equipment has been tested and found to comply with the limits for a Class B digital device, pursuant to part 15 of the FCC Rules. These limits are

designed to provide reasonable protection against harmful interference in a

residential installation. This equipment generates, uses and can radiate radio

frequency energy and, if not installed and used in accordance with the

instructions, may cause harmful interference to radio communications.

However, there is no guarantee that interference will not occur in a

particular installation. If this equipment does cause harmful interference

to radio or television reception, which can be determined by turning the

equipment off and on, the user is encouraged to try to correct the

interference by one or more of the following measures:

- Reorient or relocate the receiving antenna.

- Increase the separation between the equipment and receiver.

-Connect the equipment into an outlet on a circuit different from that to

which the receiver is connected.

-Consult the dealer or an experienced radio/TV technician

for help

Changes or modifications not expressly approved by the party

responsible for compliance could void the user's authority to operate the

equipment.

This device complies with Part 15 of the FCC Rules. Operation is

subject to the following two conditions:

(1) this device may not cause harmful interference, and (2) this device

must accept any interference received, including interference that may

cause undesired operation.