

Titan-P User Manual

Bluetooth Pairing

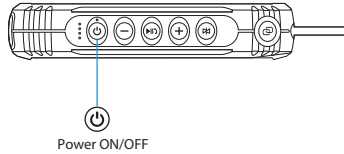

Step 1: Long press (Power ON/OFF) for 3 seconds to Power ON; The speaker goes to Bluetooth searching mode automatically. The blue LED blinks.

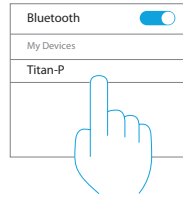

Step 2: Select the device Find "Titan-P" in the Bluetooth name list and select it.

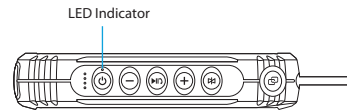

Step 3: Pairing Success
The LED stays blue once the pairing is done.

AUX-IN Connection

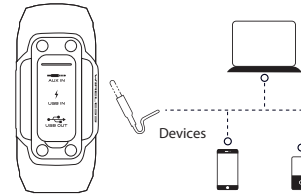

The speaker also features 1*AUX audio in port, simply connect the speaker with your mobile phone/MP3 player/PC/Laptop with the 3.5mm jack audio cable. The green light will be on and you can play music via wired connection.

Power Bank Function

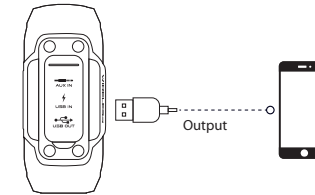

FCC Statement

This device complies with Part 15 of the FCC rules. Operation is subject to the following two conditions: 1) this device may not cause harmful interference, and 2) this device must accept any interference received, including interference that may cause undesired operation.

Note: This equipment has been tested and found to comply with the limits for a Class B digital device, pursuant to part 15 of the FCC Rules. These limits are designed to provide reasonable protection against harmful interference in a residential installation. This equipment generates uses and can radiate radio-frequency energy and, if not installed and used in accordance with the instructions, may cause harmful interference to radio communications. However, there is no guarantee that interference will not occur in particular installation. If this equipment does cause harmful interference to radio or television reception, which can be determined by turning the equipment off and on, the user is encouraged to try to correct the interference by one or more of the following measures:
-Reorient or relocate the receiving antenna.
-Increase the separation between the equipment and receiver.
-Connect the equipment into an outlet on a circuit different from that to which the receiver is connected.
-Consult the dealer or an experienced radio/TV technician for help.

Changes or modifications not expressly approved by the party responsible for compliance could void the user's authority to operate the equipment.

FCC Radiation Exposure Statement
This device complies with FCC RF radiation exposure limits set forth for an uncontrolled environment. This transmitter must not be co-located or operating in conjunction with any other antenna or transmitter.

TWS FEATURE

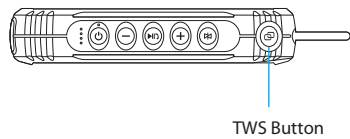

TWS Pairing:

If you purchase an additional Bluetooth Speaker (Titan-P), you may pair them together for optimal stereo sound by following steps. Firstly, make sure your device is not connected to either speaker. Turn on both speakers and short press the TWS button, the white LED indicator flashes, then the two speakers will pair automatically and the white LED indicator stays lit.

Note: If your device is already connected with one speaker, please disconnect the speaker first and then short press TWS button to enter TWS mode.

Disconnect TWS Pairing:
In TWS status, long press the TWS button on either speaker to enter into standalone mode.

Buttons Definition

Bluetooth Mode

- 1. Long press it for 3 seconds to Power ON/OFF;
- 2. Short press it to check the rest battery volume;
- 1. Short press it to Play/Pause;
- 2. For an incoming call/calling, short press it to pick up/hang up;
- 3. Long press it to reject the incoming call.

- 1. Short press it for volume up;
- 2. Long press it for the next track.

- 1. Short press it for volume down;
- 2. Long press it for the previous track.

- 1. Short press it to disconnect the current pairing
- 2. back to Bluetooth searching mode.

AUX-IN Mode

- 1. Long press it for 3 seconds to Power ON/OFF;
- 2. Short press it to check the rest battery volume.

- Short press it for volume up.

- Short press it for volume down.

LED Definition

| Description | LED Definition |
|---------------------|--|
| Power ON | 1. When power ON, the default is Bluetooth mode. The blue LED flashes quickly under Bluetooth searching mode. Once the AUX cable is inserted, it goes to AUX mode automatically. 2. Short press the power button to check the battery status. The white lights will be OFF after 5 seconds. |
| Charging | When charging the speaker with Micro USB cable, the 4 white LED illuminates to show the current battery life, 1 light indicates 25% battery life, 2 lights 50%, 3 lights 75%, 4 lights 100%. The current battery life LED blinks (0.5s per time). The 4 lights stay lit once charging completed. |
| Output | When the speaker acts as a power bank, the white LED lights indicate the current battery life. One light indicates 25% battery life, 25% battery consumption, 1 light OFF. |
| Bluetooth | Blue light stays lit for Play/Pause. When the phone is beyond the Bluetooth range, the blue LED flashes quickly back to searching mode. It powers OFF after 10 minutes without any connection. |
| AUX IN | Green LED stays lit. |
| Bluetooth Searching | Blue LED flashes quickly. |
| Pairing Successful | Blue LED stays lit. |
| TWS Mode | Short press TWS button, the white light flashes, and when 2 speakers are paired together successfully, the white light stays lit. Long press the TWS button to exit TWS mode and white light will be off. |

Specifications

| | |
|-----------------------|----------------------------|
| Product Name | Titan-P |
| Bluetooth Version | Bluetooth 4.2 |
| Transmission Distance | 10m / 33 feet |
| Driver Units | 4Ω 10Wx2=20W |
| Battery Capacity | 4400mAh |
| Audio Input | 3.5mm AUX-IN/Bluetooth |
| Play Time | 7-8 hours (70% volume) |
| Charge Time | 6-7 hours (Input: 5V=1.5A) |
| S/N ratio | ≥75dB |
| Handsfree | Support |
| TWS | Support |
| Product Size | 223 x 100 x 43 mm |

Frequently Asked Questions

Q: What kind of charger should we use for the speaker?

A: All common USB chargers can be used, while we suggest the ones above 5V/1.5A.

Q: What if there is noise or discontinuous sound when playing?

A: The speaker can be normally used within 10m under no obstruction environment. If it is over 10m or with obstruction, there might be noise or discontinuous sound.

Q: Why will the speaker shut down automatically when it is working?

A: When there is no bluetooth pairing or AUX IN within 10 minutes, the speaker will shut down automatically to reduce power consumption.

Q: The speaker cannot connect the once-paired cellphone.

A: First, remove the speaker's pairing name from the cellphone's Bluetooth list and then short press the Bluetooth Disconnection Button to restart pairing mode.

Q: What is the working sequence of the speaker?

A: The priority is AUX IN input, phone call in Bluetooth mode and then playing music Bluetooth mode.

Q: The speaker cannot be started up in a normal situation.

A: Please plug in the charger and try in a few minutes.

* This speaker supports mobile phones and tablet PCs etc. Here this User Manual is illustrated based on mobile phones.