

# 128g双铜4C 尺寸80\*80mm

trendwoo®  
Follow Your Passion

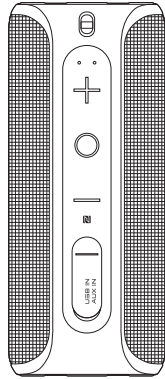

## User Manual

### Bluetooth Pairing

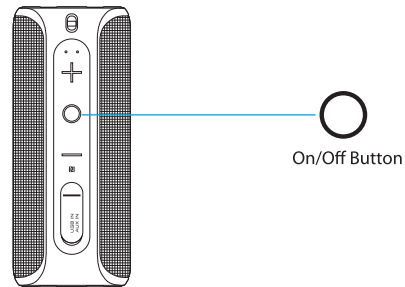

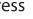
Step 1: Long press  button 3 seconds to power on. Then the speaker will enter into Bluetooth pairing mode with the blue indicator blinking.

Step 2: Open the setting and find "SoundCup-X" on the Bluetooth name list in the phone

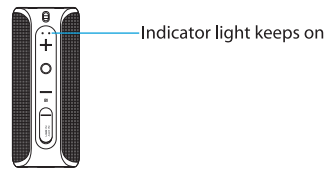
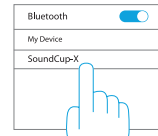

Step 3: Clicking "SoundCup-X" on the list, with two "DongDong" sound and light keeping on, which means connection succeeded and can start to play music.

### AUX IN Connection

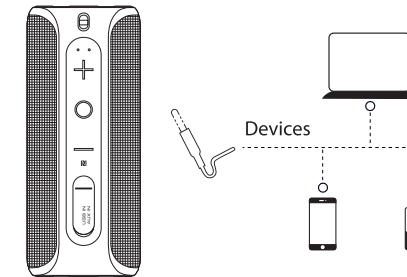

The speaker also features 1\*AUX audio in port, simply connect the speaker with your mobile phone/MP3 player/PC/Laptop with the 3.5mm jack audio cable. The green light will be on and you can play music via wired connection.  
Note: In AUX mode, the stereo sound will be invalid.

### TWS Pairing Operations

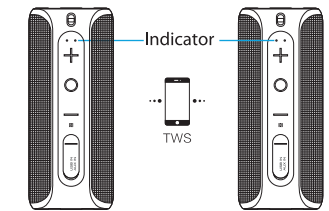



1. Turn on the two speakers.
  2. Pick up one speaker, long press "+" & "-" buttons around 1~2 seconds at the same time, which will come into TWS pairing mode with sound notification.
  3. Make the same operation for the other speaker.
  4. Then after 1~2 seconds, they will pair automatically. And once paired successfully, there will be "du" sound notification, the slave speaker's LED will stay lit, while the master speaker still blinking for pairing.
  5. Open the setting and find "SoundCup-X" on the Bluetooth name list in the phone, click it, then the smartphone can pair with the two speakers together with sound notification, and you can enjoy left and right channel.
  6. Long press "+" & "-" buttons to disconnect the Bluetooth.
- Notice:** For TWS pairing, pls let the two speakers connected first, then use smartphone to connect with the master speaker.

### Basic Operation

#### Bluetooth Mode

-  1.Short press either of the speaker when playing music for Play/Pause
- 2.When a call is coming, short press the master speaker to answer
- 3. When a call is coming, double press the master speaker to refuse
- 4. During a call conversation, short press the master speaker to hang off

-  1. Short press either of the speaker for volume up
- 2. Long press either of the speaker for next track

-  1. Short press either of the speaker for volume down
- 2. Long press either of the speaker for previous track

long press "+" & "-" buttons at the same time around 1~2 seconds to turn on/off TWS function

#### AUX IN Mode

-  Short press for volume up

-  Short press for volume down

### LED Operation

Status Description	LED Definition
Power On	The default mode is Bluetooth pairing mode, with Blue light flashing. If plug 3.5mm AUX IN cable, it will enter AUX IN mode, the green light is on.
Bluetooth Mode	Play/Pause: Blue light is normally on. When it is over the bluetooth connection range, the blue light flashes(back to pairing status). When the speaker is in pairing mode for over 10 minutes, it will power off automatically.
AUX IN Mode	Green light is normally on
Wait for Pairing	Blue light flashes
Bluetooth Connected	Blue light is normally on
Charging Status	Red light is on when charging; Red light will be off once fully charged

### Product Specifications

Product Name	SoundCup-X
Bluetooth Version	4.2
Bluetooth range	10m (TWS Distance around 2~5m)
Driver Unit	4Ω 12W=6Wx2
Battery Capacity	2200mAh
Audio Input	Bluetooth / 3.5mm AUX IN
Working time	7~8Hrs (70% volume)
Charging time	4~4.5Hrs (Input: 5V=1A)
S/N	≥75dB
NFC	Support
Handsfree function	Support
Dimension	71 x 73.6 x 169.6mm

### Frequently Asked Questions

**Q: What kind of charger should we use for the speaker?**  
A: All common USB chargers can be used, while we suggest the ones above 5V/1A.

**Q: What if there is noise or discontinuous sound when playing?**  
A: The speaker can be normally used within 10m under no obstruction environment. If it is over 10m or with obstruction, there might be noise or discontinuous sound.

**Q: Why will the speaker shut down automatically when it is working?**

A: When there is no bluetooth pairing or AUX IN within 10 minutes, the speaker will shut down automatically to reduce power consumption.

**Q: The speaker cannot connect the once-paired cellphone.**

A: First, remove the speaker's pairing name from the cellphone's Bluetooth list and then short press the Bluetooth Disconnection Button to restart pairing mode.

**Q: What is the working sequence of the speaker?**

A: The priority is AUX IN input, phone call in Bluetooth mode and then playing music Bluetooth mode.

**Q: The speaker cannot be started up in a normal situation.**

A: Please plug in the charger and try in a few minutes.

\* This speaker supports mobile phones and tablet PCs etc. Here this User Manual is illustrated based on mobile phones.

www.trendwoo.com

f/trendwoo t/trendwoo p/trendwoo

RoHS CE FC  
MADE IN CHINA

Any questions, please send an email to support@trendwoo.com for inquiry or website visit.

Note: NFC is only used to remember bluetooth addresses and does not need to be tested.

Federal Communications Commission (FCC) Statement. This device complies with part 15 of the FCC Rules. Operation is subject to the following two conditions:

- (1) This device may not cause harmful interference, and
- (2) this device must accept any interference received,

including interference that may cause undesired operation. Note: This equipment has been tested and found to comply with the limits for a Class B digital device, pursuant to part 15 of the FCC Rules. These limits are designed to provide Reasonable protection against harmful interference in a residential installation. This equipment generates, uses and can radiate radio frequency energy and, if not installed and used in accordance with the instructions, may cause harmful interference to radio communications. However, there is no guarantee that interference will not occur in a particular installation. If this equipment does cause harmful interference to radio or television reception, which can be determined by turning the equipment off and on, the user is encouraged to try to correct the interference by one or more of the following measures:

- Reorient or relocate the receiving antenna.
- Increase the separation between the equipment and receiver.
- Connect the equipment into an outlet on a circuit different from that to which the receiver is connected.
- Consult the dealer or an experienced radio/TV technician for help.

Warning: Changes or modifications made to this device not expressly approved by **Shenzhen Trendwo Tech. Co., Ltd.** may void the FCC authorization to operate this device. Note: The manufacturer is not responsible for any radio or TV interference caused by unauthorized modifications to this equipment. Such modifications could void the user's authority to operate the equipment.

**RF exposure statement:**

The device complies RF exposure requirement and can be installed and used without restriction