

成品尺寸：90*120mm
 材质：128g双铜单色双面印刷(折页)



TURN1 User Manual

www.alpine-usa.com

BLUETOOTH PAIRING

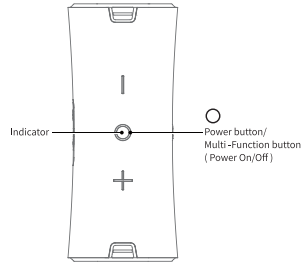

Step 1 Power on

Long press "O" button 2-3 seconds to power on, you will hear a prompt tone of power on. Then the speaker will enter into Bluetooth pairing mode with the blue indicator blinking.

01

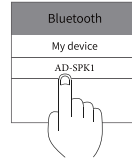

Step 2 Choose the device

Find "AD-SPK1" in your Bluetooth list and select it.

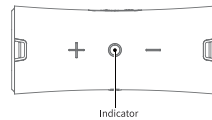

Step 3 Pairing success

The LED indicator on speaker will keep blue once Bluetooth is paired and a beep sound will be heard. You can play music now.

02

TWS PAIRING OPERATIONS

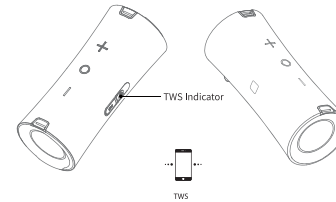

There are two speakers

Operation Instruction

Turn on the two speakers, short press "+" buttons on each speaker, which will come into TWS pairing mode with sound notification and white TWS indicator will blink. They will pair automatically. And once paired successfully, there will be "du" sound notification and white TWS indicator will stay on. Open the setting and select "AD-SPK1" on the Bluetooth name list in the phone, click it, then the smartphone can pair with the two speakers together. Short press "-" button of any speaker to disconnect TWS pairing, the white TWS indicator goes off.

Notice: For TWS pairing, pls let the two speakers connected firstly, then use smartphone to connect with the master speaker.

03

BASIC OPERATION

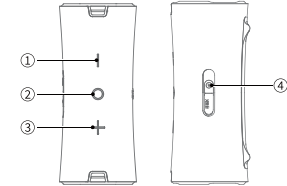

② Power button/ Multi-Function button

Long press ② 2-3S, power on/off
 When a call is coming, short press ② to answer
 When a call is coming, double press ② to refuse
 During a call conversation, short press ② to hang off
 Short press ② when playing music for Play/Pause

①③ Volume button

Short press ① for volume down, Long press ① for previous track
 Short press ③ for volume up, Long press ③ for next track

④ TWS button

Short press ④ to turn on/off TWS function
 Long press ④ 2-3S to disconnect Bluetooth

04

FCC STATEMENT :

This device complies with Part 15 of the FCC Rules. Operation is subject to the following two conditions:
 (1) This device may not cause harmful interference, and
 (2) This device must accept any interference received, including interference that may cause undesired operation.

Warning: Changes or modifications not expressly approved by the party responsible for compliance could void the user's authority to operate the equipment.

NOTE: This equipment has been tested and found to comply with the limits for a Class B digital device, pursuant to Part 15 of the FCC Rules. These limits are designed to provide reasonable protection against harmful interference in a residential installation. This equipment generates uses and can radiate radio frequency energy and, if not installed and used in accordance with the instructions, may cause harmful interference to radio communications. However, there is no guarantee that interference will not occur in a particular installation. If this equipment does cause harmful interference to radio or television reception, which can be determined by turning the equipment off and on, the user is encouraged to try to correct the interference by one or more of the following measures:

Reorient or relocate the receiving antenna.
 Increase the separation between the equipment and receiver.
 Connect the equipment into an outlet on a circuit different from that to which the receiver is connected.
 Consult the dealer or an experienced radio/TV technician for help.

FCC Radiation Exposure Statement:
 This equipment complies with FCC radiation exposure limits set forth for an uncontrolled environment. This equipment should be installed and operated with minimum distance 20cm between the radiator & your body.

WARNING contains lithium ion battery
 DO NOT LEAVE IN VEHICLE FOR EXTENDED AMOUNT OF TIME
 Recommended Storage Temp (14F-104F)



MADE IN CHINA

LED INSTRUCTION

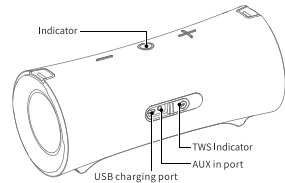

POWER ON	Blue light flashes
	Play/Pause: Blue light is on.
BLUETOOTH MODE	When it is over the Bluetooth connection range, the Blue light flashes (back to pairing status). When the speaker is left in pairing mode for over 10 minutes without any activity, it will power off automatically.
AUX IN MODE	Green light is on
CHARGING STATUS	Red light is on when charging; Red light will be off once fully charged
LOW BATTERY INDICATOR	Red light flashes when battery is running low
TWS	The TWS indicators of speakers keep white on after TWS paired successfully

05

STRAP INSTALLATION

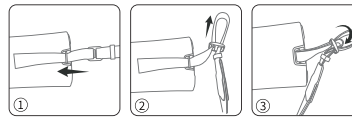

1. Make one end of strap through metal part as the direction of arrow
2. Pull a length of strap out as the direction of arrow
3. Make one end of strap through the buckle as the direction of arrow

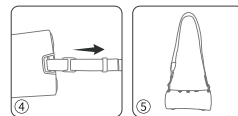

4. Tighten straps
5. Fix the other side strap as above steps

06

PRODUCT SPECIFICATION

Product Name	TURN 1
Model Name	AD-SPK1
Bluetooth Version	5.0
Battery Capacity	36 00mAh
Working Time	12-14 hours (50 % Volume)
Charging Time	4-6 hours
Charging Current	5V ≈1.7A
Driver Unit	40W = 20Wx2
Dimension	280*118*120mm
Weight	1730g ±10

07

FREQUENTLY ASKED QUESTIONS

Q: What kind of charger should we use for the speaker?
 A: All common USB chargers can be used, while we suggest the ones 5V/1.7A.

Q: What is the working sequence of the speaker?
 A: The priority is AUX IN input, phone call in Bluetooth mode and then playing music Bluetooth mode.

Q: The speaker cannot be started up in a normal situation.
 A: Please plug in the charger and try in a few minutes.

Q: What if there is noise or discontinuous sound when playing?
 A: The speaker can be normally used within 10m under no obstruction environment. If it is over 10m or with obstruction, there might be noise or discontinuous sound.

Q: Why will the speaker shut down automatically when it is working?
 A: When there is no Bluetooth pairing or AUX IN within 10 minutes, the speaker will shut down automatically to reduce power consumption.

Q: The speaker cannot connect the once-paired cellphone.
 A: First, remove the speaker's pairing name from the cellphone's Bluetooth list and then short press the Bluetooth Disconnection Button to restart pairing mode.

* This speaker supports mobile phones and tablet PCs etc. Here this User Manual is illustrated based on mobile phones.

08