

Blueair Classic

User Manual

A photograph of a white, empty room with a blue sky and white clouds on the ceiling, creating a clean and bright atmosphere.

400 series

Contents

4 Getting started with your Blueair 405/480i air purifier unit

5 Safety information

6 Starting up the air purifier unit

Adjusting speed

7 Control panels

8 Connecting Classic 405 with Blueair Aware™

Connect Classic 480i wirelessly to your smartphone

9 Controlling air purifier settings with Blueair App

10 Filters

11 Changing the filters

12 Care and maintenance

13 Specifications

Getting started with your Blueair 405/480i air purifier unit

Blueair 405

The Blueair 405 air purifier unit is **manually** controlled via the touch buttons located on the panel under the hidden display. However, since Wi-Fi is already integrated into the air purifying unit, the Blueair 405 can, alternatively, be used with **Blueair Aware™** which measures indoor air quality, sending updates and alerts in real time to your smartphone. If necessary, adjustments are either made manually via these touch buttons, or wirelessly via the **Blueair App**. The app is downloaded to your smart phone and synchronised with **Blueair Aware™** allowing you to view air quality data and control your Blueair air purifier.

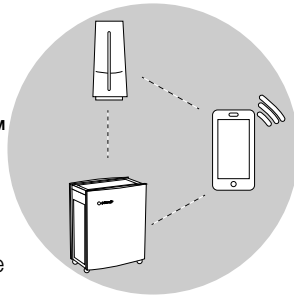

Blueair 480i

The Blueair 480i model already has three integrated sensors - PM2.5, VOC and temp/humidity (same as for **Blueair Aware™**) which monitor and regulate air quality. Adjustments to the air purifier can be made anywhere and at any time either via the touch buttons under the hidden display or via the **Blueair App**.

Read the **Blueair Aware™** and **Blueair App** user manuals for more information.

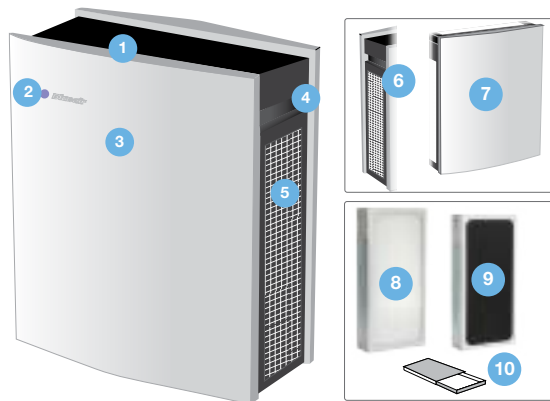

1. Hidden display
2. Blue LED
3. Front cover
4. Handle
5. Air inlet
6. Air outlet (left side)
7. Back cover
8. Particle filter
9. Smokestop™ filter
10. Kit box
 - welcome card
 - user manual
 - cleaning cloth

Safety information

The Blueair 405 and 480i air purifiers are electrical appliances. Please read the safety instructions before use and take the necessary precautions to reduce the risk of fire, electric shock or injury. **The Blueair Limited Warranty applies only if the unit is used according to these instructions.**



WARNING: Indicates a hazardous situation that, if not avoided, could result in death or serious injury.



CAUTION: Indicates a hazardous situation that, if not avoided, could result in minor or moderate injury.

General



WARNING: To avoid a hazard, a damaged supply cable must always be replaced by the manufacturer, service agent or similarly qualified person.

- Use the grounded power cable provided with your Blueair air purifier unit to plug directly into an appropriate, grounded electrical outlet. (*Refer to the voltage label on your unit*)
- Do not alter the plug in any way.

Intended use



CAUTION: Supervise children to ensure that they do not play with the appliance.

- This appliance is not intended for use by persons (including children) with reduced physical, sensory or mental capabilities, or lack of experience and knowledge, unless they have been given supervision or instruction concerning use of the appliance by a person responsible for their safety.

Placing the unit



Do place the unit in a location where air can circulate freely in, out and around the unit.



Do not place the unit closer than 4" (10 cm) from another object.



Do not place the unit directly on or against soft furnishings such as bedding or linen.



Do not place the unit near sources of heat, such as radiators, fireplaces or ovens.



Do not place the unit near wet areas, such as bathrooms or laundry rooms where it may come into contact with water.



Do not place the unit outdoors.

Starting up the air purifier unit

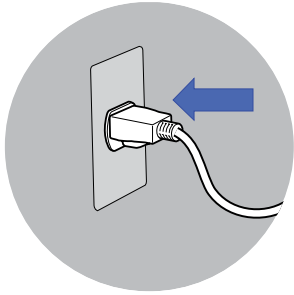

Step 1

Plug the fixed power cable into a grounded wall outlet.

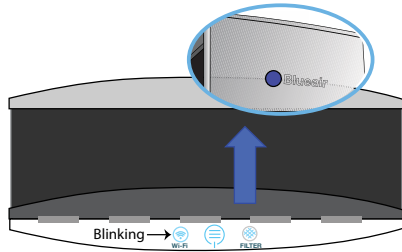

Step 2

Open the hidden display to access the touch buttons on the control panel and press the airflow speed touch button. A blue LED on the front indicates that the unit is working.

Adjusting speed

Classic 405 - manually

For maximum speed press the airflow speed touch button so that 3 blue bars are shown. After a few minutes adjust to required speed by pressing the touch button again to start the speed adjustment cycle again.

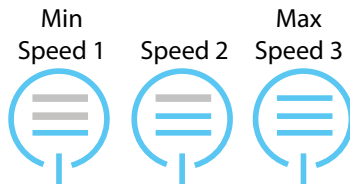

Maximum speed is recommended for fast initial cleaning, daytime use or very polluted air.

Minimum speed is recommended for nighttime use.

Classic 480i - via remote control

Refer to pg. 9 "Controlling air purifier settings with Blueair App"

Control panel and touch buttons

The control panel and touch buttons are located under the hidden display.

Classic 405



Classic 480i

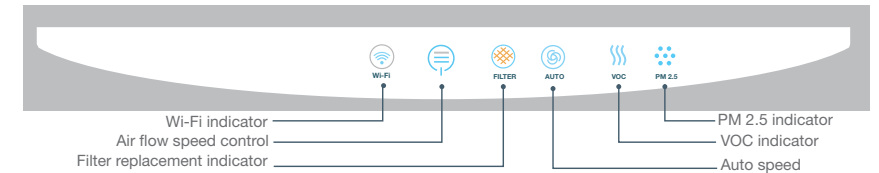

Wi-Fi indicator Status - OFF	Speed control Status - 1 blue bar (minimum speed)	Filter Status - Orange. Replace filter and reset by pressing down for 5 seconds
Wi-Fi indicator Status - "blinking" no connection	Speed control Status - 2 blue bars (medium speed)	Auto speed Status: Blue - active Grey - inactive. Always blue when unit is on
Wi-Fi indicator Status - grey and blue - Wi-Fi connected	Speed control Status - 3 blue bars (maximum speed)	VOC indicator Status: Orange - high levels. Blue - low levels.
Air flow speed control Status - OFF	Filter Status - Blue - No replacement filter currently needed.	PM2.5 indicator Status: Orange - high levels. Blue - low levels.

Connecting the Classic 405 to Blueair Aware™

Step 1

Connect **Blueair Aware™** to an electrical outlet with the supplied power adapter.

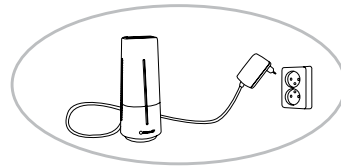

Step 2

Activate the Classic 405 by opening the hidden display and when the Wi-Fi symbol starts to blink the air purifier can be paired with the **Blueair App**.

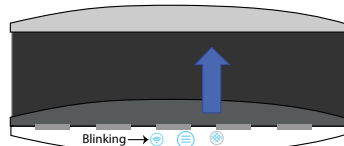

Step 3

Download the **Blueair App** to your smartphone (available for Iphone and Android).

Step 4

Make sure you are connected to the Wi-Fi network you want **Blueair Aware™** to be linked to. (For more details refer to the **Blueair Aware™ User Manual**).

Step 5

Start the app and follow set up instructions. (For more details refer to the **Blueair App User Manual**).

Connect the 480i wirelessly to your smartphone

Step 1

Activate the Classic 480i by opening the hidden display, and when the Wi-Fi symbol starts to blink the air purifier can be paired with the **Blueair App**.

Follow steps 3 and 5 above as described for Classic 405.

Note that the Classic 480i already has 3 integrated Aware sensors with the auto speed function on the unit instead.

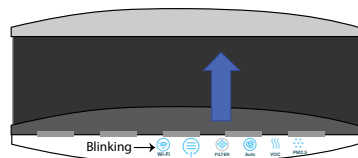

Your air purifier unit is now paired with your smartphone and can be controlled wirelessly

Controlling air purifier settings with Blueair App

The settings on your Blueair air purifier unit 405 or 480i can be controlled wirelessly via the **Blueair App** (see Blueair App User Manual for more information). The following quick guide describes the settings that can be changed remotely.

Adjust airflow speed



Off = all circles are grey

Tap in larger outer circle to activate airflow speed control. Tap inner circle once to adjust speed from min. (1) to max. (3)



Adjust LED intensity



Tap in circle to change intensity. Off = all bars are grey.

Child lock



Tap in circle to switch child lock on/off. When off, you can only control Classic 405 and 480i with the app, not manually on the control panel.

Auto mode



Enabled only if you have a Classic 480i (with integrated Aware sensors) connected to the app. In Auto mode these sensors control the unit automatically, based on real time indoor air quality analyses.

- Tap in circle to switch Auto mode on/off.

Night mode



Change airflow speed and LED intensity during selected hours and weekdays.

- Tap in circle to switch night mode on/off.
- Tap in circle to change airflow speed. Off = all circles are grey. This speed will only apply during the times and on the days set for night mode.
- Tap in circle to change LED intensity. Off = all bars are grey. This intensity will only apply during the times and on the days set for night mode.
- Drag/tap in outer circle to set start and end time.
- Tap to select days.

(Default night mode settings are airflow speed 1 and LED off during all weekdays between XX.XX and YY.YY.)

Choosing another setting



By pressing this icon you can swipe through the settings.

Filters

General information

The unit is delivered with one HEPASilent™ filter already installed - (refer to the HEPASilent® Technology data sheet for more information)

For optimal performance Blueair recommends replacing the filter every six months.

IMPORTANT! Use only genuine Blueair filters to ensure proper function of your unit and to qualify for full warranty coverage.



Particle filters

- Particle filters remove dust, pollen, bacteria, pet dander, mold spores and other airborne particles.
- The particle filter is made of polypropylene, which help mechanically filter out airborne particles.
- To maximize filter effectiveness, particles are negatively charged by the Blueair unit before reaching the filters.



Smokestop™ filters

- Smokestop™ filters use activated carbon to remove gaseous pollutants such as cigarette and cigar smoke or other VOCs (volatile organic compounds, including household paints and other chemicals).
- Adding activated carbon to a filter may affect airflow and CADR.
- You may also notice a slight odor from the carbon when the filter is first used; this will quickly dissipate.

Filter Subscription Program

We offer a convenient Filter Subscription Program in some countries. Contact your local dealer or Blueair to find out whether the program is available to you.

Customer's record

The model number and serial number of this product can be found on the bottom of the unit. Please note them in the space provided below and keep for future reference.

Model number

Dealer's name

Serial number

Dealer's address

Date of purchase

Telephone number

Changing the filters

IMPORTANT!

Always turn off and disconnect the unit from the supply mains before changing filters, cleaning or carrying out maintenance procedures.

Step 1

Unplug the unit and open the back door.

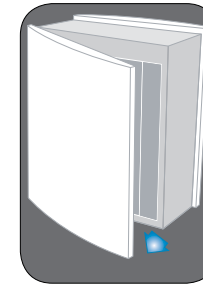

Step 2

Slide out the filter.

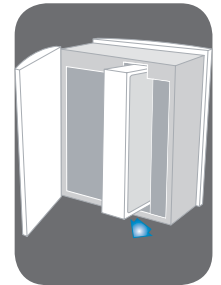

Step 3

Vacuum inside the unit with a soft brush attachment.

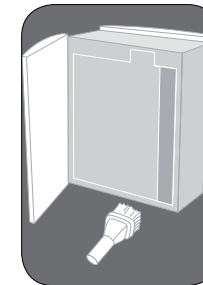

Step 4

Slide the replacement Blueair filter back into the unit.

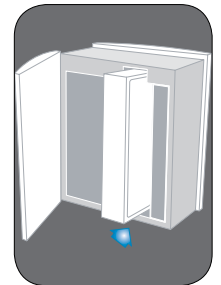

Step 5

Close the back door and plug the unit into the mains.

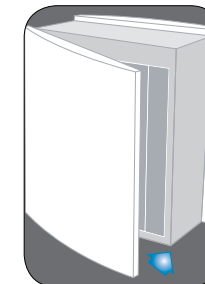

The unit is now ready for use.

Care and maintenance

We recommend routine cleaning in order to keep your unit in top condition.

When changing filters

1. Wipe the underside of the lid clean after removal.
2. Vacuum the air inlet grille from the inside using a soft brush and/or other suitable attachment.
3. Vacuum the small air inlets with a soft brush attachment.

General

1. Wipe the exterior of the unit with a soft, clean, damp cloth.
2. Never clean with gasoline, chemical solvents or corrosive material as these agents may damage the surface.
3. Do not allow foreign objects to enter the ventilation or exhaust openings. This may cause electric shock or damage the unit.
4. Do not try to repair or adjust any of the electrical or mechanical functions on your Blueair unit yourself. Contact your local dealer or Blueair for warranty information.

Help and support

If you have questions about **Blueair Classic series**, please visit www.blueair.com or contact your local Blueair retailer.

Warranty information

The Blueair Limited Warranty applies only if the unit is used according to the instructions in this manual.

Specifications

* **Prestanda:** Certified ratings are based on US version models (120VAC, 60Hz) with particle filter. Ratings may be affected by use of SmokeStop™ filter.

** **CADR:** The CADR indicates how much filtered air is delivered (airflow) by the air purifier and how well the system removes tobacco smoke, dust and pollen pollutants from the air (efficiency). Tests are performed in accordance with ANSI/AHAM AC-1. The maximum possible CADR ratings according to this standard are: Tobacco smoke: 450 cfm/Dust: 400 cfm/Pollen: 450 cfm.

*** **ACH:** Air changes per hour are calculated on the recommended room size, assuming 8 ft (2.4 m) ceilings. For smaller rooms the air changes per hour will increase.

Prestanda*	Model 405/480i
Room size:	410 sq.ft. (37 m ²)
CADR (highest) cfm** - smoke - dust - pollen:	260 cfm (>450 m ³ /h) 260 cfm (>450 m ³ /h) 260 cfm (>450 m ³ /h)
Air changes/hour (ACH)***:	5
Airflow rate at speed:	high: 280 cfm (>475 m ³ /h), med: no data, low: 75 cfm (>127 m ³ /h)
Power at speed:	high: 80 W, med: no data, low: 35 W
Noise level at speed:	high: 52 dB, med: no data, low: 32 dB
Filters: Particle filter: SmokeStop filter: Filter replacement indicator:	1 filter (HEPASilent) - recommended filter life - 6 months Yes Yes Yes
Air outlet:	Side
Air inlet:	Side
Wi-Fi - Integrated air quality sensor - Blueair Aware compatible - Electronic air sensors - Motion sensors	Yes 405: No, 480i: Yes 405: Yes, 480i: No No No, touch
Casters:	No - Handles
Dimensions (HxWxD):	23 x 20 x 11 in. (590 x 500 x 275 mm)
Weight incl. filter	33 lbs (15 kg)
Accessories:	Optional casters 405: Blueair Aware™

FCC WARNING:

This device complies with Part 15 of the FCC Rules. Operation is subject to the following two conditions: (1) this device may not cause harmful interference, and (2) this device must accept any interference received, including interference that may cause undesired operation.

Changes or modifications not expressly approved by the party responsible for compliance could void the user's authority to operate the equipment.

NOTE: This equipment has been tested and found to comply with the limits for a Class B digital device, pursuant to Part 15 of the FCC Rules. These limits are designed to provide reasonable protection against harmful interference in a residential installation. This equipment generates, uses and can radiate radio frequency energy and, if not installed and used in accordance with the instructions, may cause harmful interference to radio communications. However, there is no guarantee that interference will not occur in a particular installation. If this equipment does cause harmful interference to radio or television reception, which can be determined by turning the equipment off and on, the user is encouraged to try to correct the interference by one or more of the following measures:

- Reorient or relocate the receiving antenna.
- Increase the separation between the equipment and receiver.
- Connect the equipment into an outlet on a circuit different from that to which the receiver is connected.
- Consult the dealer or an experienced radio/TV technician for help.

RF Exposure Statement: To maintain compliance with FCC's RF Exposure guidelines, This equipment should be installed and operated with minimum distance between 20cm the radiator your body: Use only the supplied antenna.

IC WARNING:

This device complies with Industry Canada licence-exempt RSS standard(s). Operation is subject to the following two conditions: (1) this device may not cause interference, and (2) this device must accept any interference, including interference that may cause undesired operation of the device.

Le présent appareil est conforme aux CNR d'Industrie Canada applicables aux appareils radio RSS-247. L'exploitation est autorisée aux deux conditions suivantes : (1) l'appareil ne doit pas produire de brouillage, et (2) l'utilisateur de l'appareil doit accepter tout brouillage radioélectrique subi, même si le brouillage est susceptible d'en compromettre le fonctionnement.

The device meets the exemption from the routine evaluation limits in section 2.5 of RSS 102 and compliance with RSS-102 RF exposure, users can obtain Canadian information on RF exposure and compliance.

Le dispositif rencontre l'exemption des limites courantes d'évaluation dans la section 2.5 de RSS 102 et la conformité à l'exposition de RSS-102 rf, utilisateurs peuvent obtenir l'information canadienne sur l'exposition et la conformité de rf.

www.blueair.com



Blueair AB
Danderydsgatan 11
SE-114 26 Stockholm
Sweden
Tel: +46 8 679 45 00
Fax: +46 8 679 45 45
info@blueair.se

Blueair (Shanghai)
Trading Co. Ltd.
Rm 1005 City Gateway
No. 398 North Caoxi Road
Xuhui Distr, Shanghai
Tel: +86 21 6091 0981
Fax: +86 21 6091 0989
info@blueair.cn

Blueair Inc.
Suite 1900
100 N LaSalle Street
Chicago
IL 60602
Tel: +1 888 258 3247
Fax: +1 312 727 1153
info@blueair.com

Blueair India
Embassy of Sweden
Nyaya Marg
Chanakyapuri
New Dehli – 110021
Tel: +91 11 4606 7121
Fax: +91 11 4606 7120
india@blueair.se