

**Aircraft Parameters**

Aircraft: 195 X 45 X 110 mm  
 Fuselage weight: 48 g  
 Aircraft battery: 3.7V 550 mAh  
 Remote battery: 3 x 1.5V AAA  
 Aircraft charging time: 60 mins  
 Flight time: 22 mins  
 Control frequency: 2.4G  
 Main motor: 2 x 716  
 Rear motor: 1 x 612

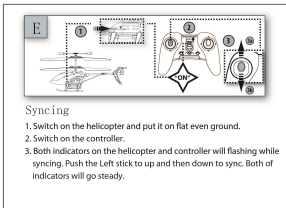

**Ready to Fly**

**Take Off**

1. Push the Left stick to up and release to go into Idle mode.
2. Press the take off button, the helicopter will hover a few feet of the ground. Then gently advance the Left stick to a desired height and release. The helicopter will hover at that height.

**OR**

3. From idle mode, gently advance the Left stick up to a desired height and release. The helicopter will hover at that height.

**Landing**

1. Press the landing button to lower the helicopter to the ground.
2. Push down on the Left stick until the helicopter is on the ground.

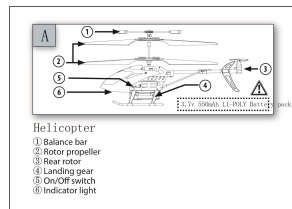

**Helicopter**

- ① Balance bar
- ② Motor propeller
- ③ Rear rotor
- ④ Landing gear
- ⑤ On/Off switch
- ⑥ Indicator light

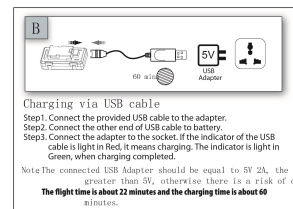

**Charging via USB cable**

Step1. Connect the provided USB cable to the adapter.  
 Step2. Connect the other end of USB cable to battery.  
 Step3. Connect the adapter to the socket. If the indicator of the USB cable is light in Red, it means charging. The indicator is light in Green, when charging completed.

Note: The connected USB Adapter should be equal to 5V 2A, the voltage not be greater than 5V, otherwise there is a risk of overloading the USB cable.

**The flight time is about 22 minutes and the charging time is about 60 minutes.**

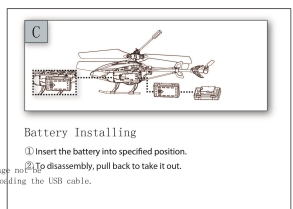

**Battery Installing**

- ① Insert the battery into specified position.
- ② To disassemble, pull back to take it out.

the range is too short?

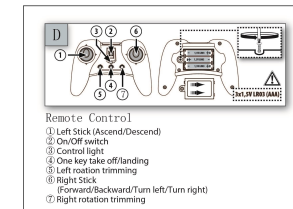

**Remote Control**

- ① Left Stick (Ascend/Descend)
- ② On/Off switch
- ③ Control light
- ④ One key take off/landing
- ⑤ Left rotation trimming
- ⑥ Right Stick
- ⑦ Forward/Backward/Turn left/Turn right
- ⑧ Right rotation trimming

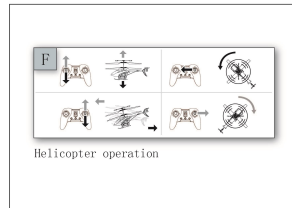

**Speed Adjustment**

Press the Left stick vertically to adjust the speed mode. When unlocking the helicopter the default speed is low speed mode. Press up vertically and hear 2 beeps to fast speed mode. Repeat the operation to adjust the speed mode.

**Tips: Beginners would be suggested to use the default speed firstly to play until skillful.**

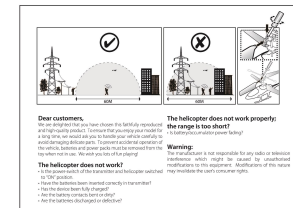

**Dear customers,**

For the safety of you, please observe the following instructions when you use the remote control. To ensure that the remote control works properly, please observe the following instructions:

1. Please do not use the remote control in the rain or in a humid environment.
2. Please do not use the remote control near high-voltage power lines or other electrical equipment.
3. Please do not use the remote control near other people's property.
4. Please do not use the remote control near other people's property.
5. Please do not use the remote control near other people's property.
6. Please do not use the remote control near other people's property.
7. Please do not use the remote control near other people's property.
8. Please do not use the remote control near other people's property.
9. Please do not use the remote control near other people's property.
10. Please do not use the remote control near other people's property.
11. Please do not use the remote control near other people's property.
12. Please do not use the remote control near other people's property.
13. Please do not use the remote control near other people's property.
14. Please do not use the remote control near other people's property.
15. Please do not use the remote control near other people's property.
16. Please do not use the remote control near other people's property.
17. Please do not use the remote control near other people's property.
18. Please do not use the remote control near other people's property.
19. Please do not use the remote control near other people's property.
20. Please do not use the remote control near other people's property.

**The helicopter does not work properly:**

If the helicopter does not work properly, please check the following items:

1. Check if the battery is fully charged.
2. Check if the battery is inserted correctly.
3. Check if the remote control is turned on.
4. Check if the remote control is within the range.
5. Check if the remote control is not blocked.
6. Check if the remote control is not too close.
7. Check if the remote control is not too far.
8. Check if the remote control is not too high.
9. Check if the remote control is not too low.
10. Check if the remote control is not too fast.
11. Check if the remote control is not too slow.
12. Check if the remote control is not too loud.
13. Check if the remote control is not too quiet.
14. Check if the remote control is not too bright.
15. Check if the remote control is not too dark.
16. Check if the remote control is not too hot.
17. Check if the remote control is not too cold.
18. Check if the remote control is not too wet.
19. Check if the remote control is not too dry.
20. Check if the remote control is not too old.

**Warning:**

The remote control is not responsible for any damage caused by the user's misuse of the remote control. Please use the remote control responsibly and do not use it for any illegal or dangerous activities.

Note: This equipment has been tested and found to comply with the limits of Class B digital device, pursuant to part 15 of the FCC Rules. These limits are designed to provide reasonable protection against harmful interference in a residential installation. This equipment generates noise and can receive noise, including energy and, if not installed and used in accordance with the instructions, may cause harmful interference to radio communications. However, there is no guarantee that interference will not occur in a particular installation. If this equipment does cause harmful interference to radio or television reception, which can be determined by turning the equipment off and on, the user is encouraged to try to correct the interference by one or more of the following measures:

- Reorient or relocate the receiving antenna.
- Increase the separation between the equipment and receiver.
- Connect the equipment into a circuit in a different part of the building.
- Consult the dealer or an experienced radio/television technician for help.

Changes or modifications not expressly approved by the party responsible for compliance may void the user's authority to operate the equipment.

This device complies with Part 15 of the FCC Rules. Operation is subject to the following two conditions:

1. This device may not cause harmful interference.
2. This device must accept any interference received, including interference that may cause undesired operation.