

# Bluetooth® Grill Thermometer

**DOWNLOADING THE GRILL ALERT APP:**  
On your mobile device, go to the iTunes App Store (Apple devices) or Google Play (Android devices) to download the Grill Thermometer app.



**PAIRING WITH THE THERMOMETER**

1. Enable Bluetooth(R) on your device.
2. While within 5 feet of the base station, launch the Grill Thermometer app.
3. Press the power button on the base station to turn it on.
4. Push and hold the power button on the base station to turn on pairing mode.
5. In the app, press the Bluetooth(R) icon. (Fig. 1).
6. Tap SCAN and then select Grill Thermometer when it appears. (Fig. 2)
7. Congratulations! Your device should now be paired with the Grill Thermometer.

**Status Lights**  
LED Flashing Blue: Searching for Bluetooth device.  
LED Solid Blue: Bluetooth device paired.  
LED Off: No device paired.  
LED Flashing Red: Low battery.

**SETTINGS AND GUIDANCE**

Once the Grill Alert has been paired, the app will switch to the Home screen (Fig. 3).

The **More** (⋮) button (Fig. 4) gives access to the Countdown Timer, Probe Placement Guidance and Bluetooth® and Temperature Mode Settings. Tap the < button to go back to the Home screen at any time.

**Timer** (Fig. 5) – Set the length of time (hours and minutes) to count down along with the type of alert (Sound/Vibrate/Pop-Up) to occur when time is up.

**Probe Placement** – Please see the next section, GRILLING, Settings (Fig. 6) – Select between temperature readings in Fahrenheit or Celsius.

Reconnect to the base station if the Bluetooth® connection is lost. See **“Pairing with the Thermometer”**, above.

Please note that on-screen images may differ from those shown in this manual due to ongoing development and differences in mobile devices.

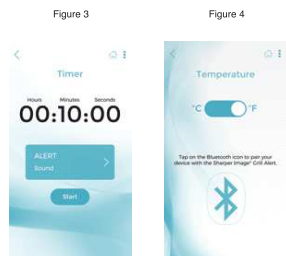
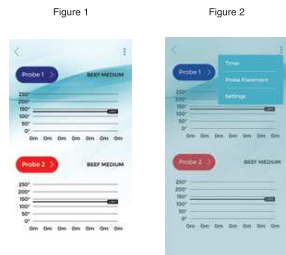
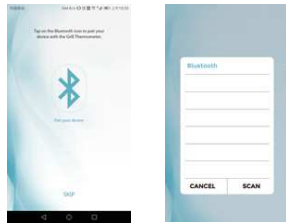

# Bluetooth® Grill Thermometer

## GRILLING

**PROBE SETTINGS**

It's important to make sure you have the right settings before putting the meat on the grill. The Grill Thermometer app has many pre-selected meats and settings pre-loaded for your convenience. You can also add a custom setting. When in any of the submenus, tap the < button to go back to the previous window.

You can use the Grill Thermometer to simultaneously monitor two items. The process for configuring both probes is identical.

1. Tap **Probe 1** on the screen (Fig. 7) to open the Probe 1 Settings window (Fig. 8).
2. Tap on **Entrée** and select the meat (Fig. 9).
3. Tap on **Doneness** to select the level of cooking (Fig. 10). USDA-recommended doneness levels are shown for your convenience.
4. Tap **Temperature Pre-Alert** and choose how close to the target temperature you want to receive a warning (Fig. 11).
5. Lastly, tap **Alert Sound** to choose an audible, pop-up or vibrating alert, or none at all. (Fig. 12).

**NOTE:** If “None” is selected in the Alert Sound setting then no alert will occur for either the Temperature Pre-Alert or when the entrée reaches its target temperature.

**ADDING A CUSTOM ENTRÉE**

1. Tap the + button at the bottom of the Entrée window (Fig. 9).
2. Enter the name and doneness temperature.
3. Tap Add to save.

Tap to edit your entrée or to delete it.

**PROBE PLACEMENT**

Located in the **More** (⋮) menu (Fig. 4, previous page) the Probe Placement window offers guidance on where to place the probe for the most accurate temperature readings on various meats.

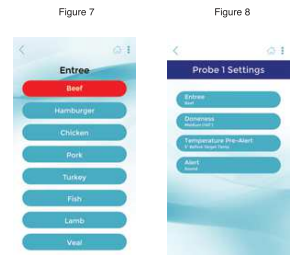

# Bluetooth® Grill Thermometer

**OPERATING**

1. Insert the probe jack into the correct probe port. Looking at the face of the Grill Thermometer, Probe 1 is on the left and Probe 2 is on the right. (Fig. 13)
2. Insert the probe into the entrée at the recommended point. This is generally the thickest portion of the meat, avoiding bone and fat which will conduct heat differently. Insert it from the side to allow the entrée to be flipped. (Fig. 14)

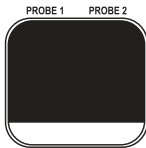

Figure 13

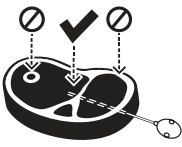

Figure 14

The probes, the cables and the colored silicone cord wraps are heat resistant and can withstand use in a grill or oven. The Grill Thermometer should be kept away from direct heat and never placed on a hot grill. The magnetic mount can hold the base station in place except on stainless steel. It should not be placed on the lid or firebox of a barbecue, smoker or other grill.  
**CAUTION:** Probes will be hot during and after use. The display will automatically flip if the base station is inverted. Pressing the power button will turn off the base station and end the temperature monitoring.

**SPECIFICATIONS**

Power Supply: 2AAA 1.5V batteries  
Range from base station to paired device: 150 ft  
Dimensions:  
Base Station 2.75" wide x 2.75" tall x 1.75" deep  
Probes: 9.25" long 40"  
Probe Cables: 6 oz  
Weight: 6 oz  
OS / App compatibility: Apple® iOS 6.0 and Later  
Android 4.3 and later w/ CPU: 800MHz & 512MB RAM  
Bluetooth®: 4.0 & Bluetooth® Smart Ready devices

**TROUBLESHOOTING**

Cannot connect via Bluetooth®  
• Device is only compatible with and Bluetooth® Smart Ready or devices capable of supporting Bluetooth 4.0  
• Device may be already paired with another device. Restart base station.

Loss of Bluetooth® connection.  
• Device may be out of range.  
• Base station batteries may be weak.

Alert does not activate or sound  
• Device may be set to Vibrate or Do Not Disturb  
• Alert Type may be set for "None" or "Pop-Up Only."

**PROPER CARE**

- Clean probes after each use. They are not dishwasher safe. Hand wash probes with mild detergent and water. Do not submerge in water.
- Wipe base station with damp cloth. Do not submerge in water.
- Wrap probe cords around silicone (Fig. 15).
- Cord wraps at the end of the probe.
- Probes clip into the slots in the magnetic mount on the back of the base station.
- To maximize the service life of your thermometer, store it indoors.

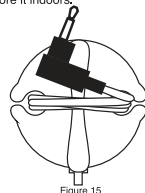
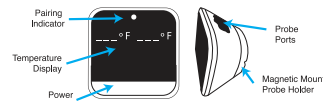

Figure 15

# Bluetooth® Grill Thermometer

**CONTENTS:**

- 1 Bluetooth Grill Thermometer
- 2 Meat Probes



**INSTALLING BATTERIES:**

The base station requires 2 "AAA" 1.5V alkaline batteries (not included). The battery compartment is on the back of the base station, beneath the magnetic probe holder.

Remove the probes and gently twist the holder counterclockwise to expose the battery compartment.

Remove the cover and insert the batteries, being sure to properly align them with the diagram inside the compartment. Replace the cover and reattach the holder.

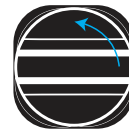

**BATTERY WARNING:**

- Do not mix old and new batteries
- Do not mix alkaline, standard (carbon-zinc), or rechargeable batteries
- Alkaline batteries are recommended. Use only the specified voltage.
- Insert batteries using the correct polarity. Always use, replace, and recharge (if applicable) batteries under adult supervision
- Do not charge with non-rechargeable batteries
- Do not short-circuit the battery supply terminals
- Do not dispose of batteries in fire, batteries may explode or leak.
- Remove batteries before storing.
- Recycle or dispose of batteries according to federal, state, and local laws.
- Keep these instructions for future reference.

**SAFETY WARNING:**

**Please read all safety warnings before use.**

- This is not a children's product. Keep out of reach of children.
- Remove protective film from the screen and silicone pads prior to first use.
- Use this product only for its intended use.
- Not for use in microwaves.
- Product is not designed for all weather use.
- Keep away from moisture and extreme temperatures.
- Do not submerge device or prongs in water or liquids.
- This item has no user serviceable components. Do not disassemble.
- For maximum product life, do not drop or throw this device. Do not expose to humidity, dust or operating temperatures outside of 32°-113°F (0°-45°C)
- Inspect the product before every use. If the product appears worn, frayed, cracked, or broken in any manner, discontinue use and discard immediately.
- The Grill Thermometer base station should be kept away from direct heat and never placed on a hot grill.
- **CAUTION!** Probes will be hot after use

The Bluetooth® word mark and logos are registered trademarks owned by Bluetooth SIG. Smart Phones, must have built-in Bluetooth® wireless technology to connect.

**WARNING:** Any changes or modifications not expressly approved by the party responsible for compliance could void the user's authority to operate this equipment.

This device complies with Part 15 of the FCC Rules. Operation is subject to the following two conditions: (1) this device may not cause harmful interference, and (2) this device must accept any interference received, including interference that may cause undesired operation.

**NOTE:** This equipment has been tested and found to comply with the limits for a Class B digital device, pursuant to Part 15 of the FCC Rules. These limits are designed to provide reasonable protection against harmful interference in a residential installation. This equipment generates, uses and can radiate radio frequency energy and, if not installed and used in accordance with the instructions, may cause harmful interference to radio communications. However, there is no guarantee that interference will not occur in a particular installation. If this equipment does cause harmful interference to radio or television reception, which can be determined by turning the equipment off and on, the user is encouraged to try to correct the interference by one or more of the following measures:

- Reorient or relocate the receiving antenna.
- Increase the separation between the equipment and receiver.
- Connect the equipment into an outlet on a circuit different from that to which the receiver is connected.
- Consult the dealer or an experienced radio/TV technician for help.

**KEEP THIS INSTRUCTIONAL MANUAL AS IT CONTAINS IMPORTANT INFORMATION FOR FUTURE REFERENCE.** Due to continuous product improvements, the pictures on the manual may differ slightly from the actual product. © 2019 MerchSource, LLC, Irvine, CA 92618. All rights reserved.

For technical support, please call 1-800-374-2744.